



Georgia-Pacific Monticello LLC
604 N. A. Sandifer Highway
Monticello, MS 39654
(601) 587-7711

February 29th, 2024

Chief, Environmental Permits Division
Mississippi Department of Environmental Quality, Office of Pollution Control
P. O. Box 2261
Jackson, MS 39225

RECEIVED
MAR - 1 2024
MDEQ

Re: Large Construction Stormwater Pollution Prevention Plan
Georgia Pacific Monticello LLC

Dear Mr. Griffith:

Georgia Pacific Monticello LLC (GP Monticello) is submitting the attached Large Construction Stormwater Pollution Prevention Plan associated with planned construction activities at the Monticello Mill located at 604 N.A. Sandifer Highway, Monticello MS 39654.

If you have any questions, please contact Heather Owens at (601) 455-1731.

Heather Owens
Environmental Leader, GP Monticello

For record keeping purposes, please sign and date below to acknowledge a representative of MDEQ have received the attached SWPPP:

Received By: _____
Title: _____
Date: _____
RECEIVED
FEB 28 2024
Dept. of Environmental Quality

Stormwater Pollution Prevention Plan

For Construction Activities At:

Georgia-Pacific
604 N.A. Sandifler Hwy
Monticello, MS 39654
(601) 587-7570

SWPPP Operator:

GA West & Co. Inc.
Cole Smith
1200 Radcliff Road
Creola, AL 36525
(251) 586-2790
Cole.Smith@GAWest.com

SWPPP Prepared By:

Wood.
(Doing business as Wood Group USA, Inc.)
Ken Vogel, PE
30 Patewood Dr., Suite 200
Greenville, SC 29615
(864) 458-3600
Ken.vogel@woodplc.com

SWPPP Preparation Date:

01/19/2024

Estimated Project Dates:

Project Start Date: 02 / 26 / 2024
Project Completion Date: 06 / 20 / 2025

Contents

SECTION 1: SITE EVALUATION, ASSESSMENT, AND PLANNING	1
1.1 Project/Site Information.....	1
1.2 Contact Information/Responsible Parties	2
1.3 Nature and Sequence of Construction Activity	3
1.4 Soils, Slopes, Vegetation, and Current Drainage Patterns.....	3
1.5 Construction Site Estimates	4
1.6 Receiving Waters	4
1.7 Site Features and Sensitive Areas to be Protected	4
1.8 Potential Sources of Pollution.....	5
1.9 Endangered Species Certification	6
1.10 Historic Preservation.....	6
1.11 Applicable Federal, Tribal, State or Local Programs	6
1.12 Maps.....	6
SECTION 2: EROSION AND SEDIMENT CONTROL BMPs.....	7
2.1 Natural Buffers or Equivalent Sediment Controls	7
2.2 Perimeter Controls	8
2.3 Sediment Track-Out.....	8
2.4 Stockpiled Sediment or Soil.....	9
2.5 Minimize Dust	10
2.6 Minimize the Disturbance of Steep Slopes	10
2.7 Topsoil	11
2.8 Soil Compaction.....	12
2.9 Storm Drain Inlets.....	12
2.10 Constructed Stormwater Conveyance Channels	14
2.11 Sediment Basins.....	15
2.12 Chemical Treatment.....	16
2.13 Dewatering Practices	17
2.14 Other Stormwater Controls	18
2.15 Site Stabilization	18
SECTION 3: GOOD HOUSEKEEPING BMPs.....	21
3.1 Spill Prevention and Response.....	21
3.2 Fueling and Maintenance of Equipment or Vehicles.....	22
3.3 Washing of Equipment and Vehicles.....	22
3.4 Storage, Handling, and Disposal of Construction Products, Materials, and Wastes	23
3.5 Washing of Applicators and Containers used for Paint, Concrete or Other Materials	25
3.6 Fertilizers	26
3.7 Other Pollution Prevention Practices	26
SECTION 4: SELECTING POST-CONSTRUCTION BMPs	27
SECTION 5: INSPECTIONS	28
5.1 Inspections	28
5.2 Delegation of Authority	29
5.3 Corrective Action Log	29

SECTION 6: RECORDKEEPING AND TRAINING	30
6.1 Recordkeeping	30
6.2 Log of Changes to the SWPPP	30
6.3 Training.....	30
SECTION 7: FINAL STABILIZATION.....	31
SECTION 8: CERTIFICATION AND NOTIFICATION.....	32
SWPPP APPENDICES	i
Appendix A – General Location Map	
Appendix B – Site Maps	
Appendix C – Construction General Permit	
Appendix D – NOI and Acknowledgement Letter from EPA/State	
Appendix E – Inspection Reports	
Appendix F – Corrective Action Log	
Appendix G – SWPPP Amendment Log	
Appendix H – Subcontractor Certifications/Agreements	
Appendix I – Grading and Stabilization Activities Log	
Appendix J – Training Log	
Appendix K – Delegation of Authority	
Appendix L – Additional Information (i.e., Endangered Species and Historic Preservation Documentation)	

SECTION 1: SITE EVALUATION, ASSESSMENT, AND PLANNING

1.1 Project/Site Information

Project/Site Name: GP Monticello New Logline

Project Street/Location: 604 NA Sandifier Hwy

City: Monticello State: MS ZIP Code: 39654

County or Similar Subdivision: Lawrence

Latitude/Longitude (Use one of three possible formats, and specify method)

Latitude:

1. 31° 37' 26.97" N (degrees, minutes, seconds)

2. ___° ___' ___" N (degrees, minutes, decimal)

3. ___° N (decimal)

Longitude:

1. 90° 4' 44.10" W (degrees, minutes, seconds)

2. ___° ___' ___" W (degrees, minutes, decimal)

3. ___° W (decimal)

Method for determining latitude/longitude:

USGS topographic map (specify scale: _____)

EPA Web site GPS

Other (please specify): Google Earth Pro

Is the project located in Indian country? Yes No

If yes, name of Reservation, or if not part of a Reservation, indicate "not applicable." _____

Is this project considered a federal facility? Yes No

NPDES project or permit tracking number*: MSR110077

**(This is the unique identifying number assigned to your project by your permitting authority after you have applied for coverage under the appropriate National Pollutant Discharge Elimination System (NPDES) construction general permit.)*

1.2 Contact Information/Responsible Parties

Operator(s):

Insert Company or Organization Name: GA West & Co. Inc.
Insert Name: Cole Smith
Insert Address: 1200 Radcliff Road
Insert City, State, Zip Code: Creola, AL 36525
Insert Telephone Number: (251) 679-1965
Insert Fax/Email: Cole.Smith@GAWest.com
Insert area of control (if more than one operator at site):

Project Manager(s) or Site Supervisor(s):

Insert Company or Organization Name: GA West & Co. Inc.
Insert Name: Daniel Fisher
Insert Address: 1200 Radcliff Road
Insert City, State, Zip Code: Creola, AL 36525
Insert Telephone Number: (251) 679-1965
Insert Fax/Email: Daniel.fisher@GAWest.com
Insert area of control (if more than one operator at site) :
Repeat as necessary

SWPPP Contact(s):

Insert Company or Organization Name: GA West & Co. Inc.
Insert Name: Daniel Fisher
Insert Address: 1200 Radcliff Road
Insert City, State, Zip Code: Creola, AL 36525
Insert Telephone Number: (251) 679-1965
Insert Fax/Email: Daniel.fisher@GAWest.com
Insert area of control (if more than one operator at site) :
Repeat as necessary

This SWPPP was Prepared by:

Insert Company or Organization Name: Wood (Doing business as Wood Group USA, Inc.)
Insert Name: Ken Vogel
Insert Address: 30 Patewood Dr., Suite 200
Insert City, State, Zip Code: Greenville, SC 29615
Insert Telephone Number: (864) 458-3600
Insert Fax/Email: ken.vogel@woodplc.com

Subcontractor(s):

Insert Company or Organization Name: N/A
Insert Name: N/A
Insert Address: N/A
Insert City, State, Zip Code: N/A
Insert Telephone Number: N/A
Insert Fax/Email: N/A
Repeat as necessary

Emergency 24-Hour Contact:

Insert Company or Organization Name: GA West & Co. Inc.
Insert Name: Cole Smith
Insert Telephone Number: (251) 586-2790

1.3 Nature and Sequence of Construction Activity

Describe the general scope of the work for the project, major phases of construction, etc:

The Woodyard addition will consist of new logline, two new radial log boom cranes, disc screen and sizer, and associated chip conveyors. It also includes a new bark hog and bark conveyors, renovation of an existing operations storage room to a control room, two new inbound and two new outbound scales, three unbinding racks, and all associated roadway modifications.

What is the function of the construction activity?

Residential Commercial Industrial Road Construction Linear Utility
 Other (please specify):

Estimated Project Start Date: 02 / 26 / 2024

Estimated Project Completion Date: 06 / 20 / 2025

1.4 Soils, Slopes, Vegetation, and Current Drainage Patterns

Soil type(s): The general soil types within the project site are Wanilla Silt Loam according to the USGS Web Soil Survey. According to the Project Specific Geotechnical Report, from the existing ground surface and extending to an approximate depth of 7 to 28 feet, loose to medium dense Clayey Sand (SC) and/or medium stiff sandy clays (CL) were typically encountered.

Description of unique features that are to be preserved: Stream shall be protected during construction of box culvert.

Slopes: Slopes in the project area generally consist of 0-2% slope.

Drainage Patterns: Drainage within the project area consists of surface drainage with minor amount of storm drainage to various discharge points through a combination of storm pipes, box culverts, and ditches. Construction will keep existing drainage patterns as much as possible.

Vegetation: Surface conditions consist mostly of aggregate pavement with existing pavements. Construction will clear and grub a small portion of the site.

1.5 Construction Site Estimates

The following are estimates of the construction site.

Total project area:	16.2	acres
Construction site area to be disturbed:	16.2	acres
Percentage impervious area before construction:		51 %
Runoff coefficient before construction:		85
Percentage impervious area after construction:		82 %
Runoff coefficient after construction		90

1.6 Receiving Waters

Description of receiving waters: Final receiving water of the project will be the Pearl River.

Description of storm sewer systems: The final discharge from the majority of the project site area will convey through a double box culvert crossing NA Sandifer Memorial Hwy.

Description of impaired waters or waters subject to TMDLs: Pearl River is subject to TMDLs, but there is no section of Pearl River within Lawrence County that is on the 303(d) List of Impaired Water Bodies.

1.7 Site Features and Sensitive Areas to be Protected

There are is a small stream feature that a box culvert will be constructed through. There are no other unique site features including stream buffers, wetlands, specimen trees, natural vegetation, steep slopes, or highly erodible soils that are to be preserved within the project site.

1.8 Potential Sources of Pollution

Potential sources of sediment to stormwater runoff:

See Table Below

Potential pollutants and sources, other than sediment, to stormwater runoff:

See Table Below

Trade Name Material	Stormwater Pollutants	Location
Fueling	Diesel, Gasoline	See Construction Drawing
Paving Operations	Volatile Organic Compounds	Throughout Project (See Construction Drawing)
Concrete Washout	Slurry containing toxic metals that is caustic and corrosive.	See Construction Drawing
Paint	Water or Solvent based paints	Site Wide
Solid Waste Dumpsters	General Waste	At appropriate site locations
Equipment Outdoor Storage (laydown areas)	General Waste	See Construction Drawing
Generators	Diesel, Gasoline	At appropriate site locations
Loading / unloading operations	General Waste	Site Wide
Construction Equipment	Diesel, Oil	Site Wide

Prohibited Non-Storm Water Discharges:

- Wastewater from washout of concrete (unless managed by an appropriate control)
- Wastewater from washout and cleanout of stucco, paint, form release oils, curing compounds and other construction materials
- Fuels, oils, or other pollutants used in vehicle and equipment operation and maintenance
- Soaps or solvents used in vehicle and equipment washing
- Wastewater from sanitary facilities, including portable toilets
- Contaminated discharge waters from dewatering activities
- Toxic or hazardous substances from a spill or other release.

1.9 Endangered Species Certification

Are endangered or threatened species and critical habitats on or near the project area?

Yes No

Describe how this determination was made:

USFWS Threatened & Endangered Species Active Critical Habitat Report

<https://fws.maps.arcgis.com/home/webmap/viewer.html?webmap=9d8de5e265ad4fe09893cf75b8dbfb77>

If yes, describe the species and/or critical habitat:

N/A

If yes, describe or refer to documentation that determines the likelihood of an impact on identified species and/or habitat and the steps taken to address that impact. (Note, if species are on or near your project site, EPA strongly recommends that the site operator work closely with the appropriate field office of the U.S. Fish and Wildlife Service or National Marine Fisheries Service. For concerns related to state or tribal listing of species, please contact a state or tribal official.)

1.10 Historic Preservation

Are there any historic sites on or near the construction site?

Yes No

Describe how this determination was made:

Existing facility with existing historic site outside of project limits. A Mississippi Department of Archives and History Letter stating the sites to be potential eligible under Criterion D of National Register of Historic Places.

If yes, describe or refer to documentation that determines the likelihood of an impact on this historic site and the steps taken to address that impact.

This area is outside of the project limits and will not be impacted by any construction or downstream runoff.

1.11 Applicable Federal, Tribal, State or Local Programs

There are no other applicable federal, tribal, state or local soil and erosion control and stormwater management requirements that apply to the construction site.

1.12 Maps

See SWPPP Appendix B.

SECTION 2: EROSION AND SEDIMENT CONTROL BMPs

2.1 Natural Buffers or Equivalent Sediment Controls

Buffer Compliance Alternatives

Are there any surface waters within 50 feet of your project's earth disturbances? YES NO

Check the compliance alternative that you have chosen:

- I will provide and maintain a 50-foot undisturbed natural buffer.
- I will provide and maintain an undisturbed natural buffer that is less than 50 feet and is supplemented by additional erosion and sediment controls, which in combination achieves the sediment load reduction equivalent to a 50-foot undisturbed natural buffer.
- It is infeasible to provide and maintain an undisturbed natural buffer of any size, therefore I will implement erosion and sediment controls that achieve the sediment load reduction equivalent to a 50-foot undisturbed natural buffer.
- I qualify for one of the exceptions in Part 2.1.2.1.e. (If you have checked this box, provide information on the applicable buffer exception that applies, below.)

Buffer Exceptions

Which of the following exceptions to the buffer requirements applies to your site?

- There is no discharge of stormwater to the surface water that is located 50 feet from my construction disturbances.
- No natural buffer exists due to preexisting development disturbances that occurred prior to the initiation of planning for this project.
- For a "linear project" (defined in Appendix A), site constraints (e.g., limited right-of-way) make it infeasible for me to meet any of the CGP Part 2.1.2.1.a compliance alternatives. This will be for a road tying into the N A Sandifer Hwy with limited right-of-way access and space to tie into the highway.
- The project qualifies as "small residential lot" construction (defined in Part 2.1.2.1.e.iv and in Appendix A).
 - For Alternative 1 (see Appendix G, Part G.2.3.2.a):
 - For Alternative 2 (see Appendix G, Part G.2.3.2.b):
- Buffer disturbances are authorized under a CWA Section 404 permit.
- Buffer disturbances will occur for the construction of a water-dependent structure or water access area (e.g., pier, boat ramp, and trail).

2.2 Perimeter Controls

General

- Perimeter control structures shall be functional throughout the course of earth disturbing activity. Perimeter controls shall be implemented prior to land disturbance activities. They shall continue to function until the upslope development area is stabilized with permanent cover. As construction progresses, perimeter controls shall be maintained throughout the duration by removing sediment before it has accumulated to one-half of the above ground height.

Specific Perimeter Controls

SILT FENCE	
Description: Silt fence is a sediment-trapping practice utilizing a geotextile fence, topography and sometimes vegetation to cause sediment deposition. Silt fence reduces runoff's ability to transport sediment by ponding runoff and dissipating small rills of concentrated flow into uniform sheet flow.	
Installation	DATE OF INSTALLATION: Silt Fence shall be installed before any land disturbance activities.
Maintenance Requirements	Silt Fence requires regular inspection and maintenance to ensure its effectiveness. Silt fences must be inspected after each rainfall and at least daily during prolonged rainfall. Silt fence found damaged or improperly installed shall be replaced or repaired immediately. Sediment deposits shall be routinely removed when they reach approximately one-half the height of the silt fence.
Design Specifications	See Construction Drawings and Details

2.3 Sediment Track-Out

General

- Sediment track-out control structures shall be functional throughout the course of earth disturbing activity. Sediment track-out controls shall be implemented prior to grading and within seven days from the start of grubbing/stripping topsoil. They shall continue to function until the development area is stabilized with permanent cover. Where sediment has been tracked-out from the site onto paved roads, sidewalks, or other paved areas outside of the site, the deposited sediment shall be removed by the end of the same business day in which the track-out occurs or by the end of the next business day if track-out occurs on a non-business day. The track-out shall be removed by sweeping, shoveling, or vacuuming these surfaces, or by using other similarly effective means of sediment removal. It shall be prohibited from hosing or sweeping tracked-out sediment into any stormwater conveyance, storm drain inlet, or water of the U.S.

Specific Track-Out Controls

STABILIZED CONSTRUCTION EXIT PAD
Description: A stabilized construction exit pad is a stabilized pad of stone underlain with a geotextile and is used to reduce the amount of mud tracked off-site with construction traffic. Located at points of ingress/egress, the practice is used to reduce the amount of mud tracked off-site with construction traffic.

Installation	DATE OF INSTALLATION: Stabilized Construction Exit Pads shall be installed before any major earthmoving activities begin.
Maintenance Requirements	The exit pads shall be maintained in a condition that will prevent tracking or flow of mud onto public rights-of-way. This may require periodic top dressing with additional stone or the washing and reworking of existing stone as conditions demand and repair and/or cleanout of any structures used to trap sediment. Where sediment has been tracked-out from the site onto paved roads, sidewalks, or other paved areas outside of the site, remove the deposited sediment by the end of the same business day in which the track-out occurs or by the end of the next business day if track-out occurs on a non-business day. Remove the track-out by sweeping, shoveling, or vacuuming these surfaces, or by using other similarly effective means of sediment removal. It is prohibited from hosing or sweeping tracked-out sediment into any stormwater conveyance, storm drain inlet, or water of the U.S.
Design Specifications	See Construction Drawings and Details

2.4 Stockpiled Sediment or Soil

General

- Stockpile perimeter controls shall be implemented around all stockpiled sediment and soil. Stockpiles shall be located outside of any natural buffers and away from any stormwater conveyances, drain inlets, and areas where stormwater flow is concentrated. For piles that will be unused for 14 or more days, stockpiles shall be temporarily seeded. It is prohibited from hosing down or sweeping soil or sediment accumulated on pavement or other impervious surfaces into any stormwater conveyance, storm drain inlet, or water of the U.S.

Specific Stockpile Controls

TEMPORARY SEEDING	
Description: Temporary seedings establish temporary cover on disturbed areas by planting appropriate rapidly growing annual grasses or small grains. Temporary seeding provides erosion control on areas in between construction operations. Grasses, which are quick growing, are seeded and usually mulched to provide prompt, temporary soil stabilization. It effectively minimizes the area of a construction site prone to erosion and should be used everywhere the sequence of construction operations allows vegetation to be established.	
Installation	DATE OF INSTALLATION: Temporary Seeding shall be installed if pile will be unused for 14 or more days.
Maintenance Requirements	Areas failing to establish vegetative cover adequate to prevent erosion shall be reseeded as soon as such areas are identified. Seeding performed during hot and dry summer months shall be watered at a rate of 1 inch per week.
Design Specifications	See Construction Drawings and Details

SILT FENCE	
Description: Silt fence is a sediment-trapping practice utilizing a geotextile fence, topography and sometimes vegetation to cause sediment deposition. Silt fence reduces runoff's ability to transport sediment by ponding runoff and dissipating small rills of concentrated flow into uniform sheet flow.	
Installation	DATE OF INSTALLATION: Silt Fence shall be installed around the entire perimeter of each stockpile immediately after it is placed.
Maintenance Requirements	Silt Fence requires regular inspection and maintenance to ensure its effectiveness. Silt fences must be inspected after each rainfall and at least daily during prolonged rainfall. Silt fence found damaged or improperly installed shall be replaced or repaired immediately. Sediment deposits shall be routinely removed when they reach approximately one-half the height of the silt fence.
Design Specifications	See Construction Drawings and Details

2.5 Minimize Dust

General

- On areas of exposed soil, dust shall be minimized through appropriate application of water or other dust suppression techniques to control the generation of pollutants that could be discharged in stormwater from the site.

Specific Dust Controls

DUST CONTROLS	
Description: Dust control involves preventing or reducing dust from exposed soils or other sources during land disturbing, demolition and construction activities to reduce the presence of airborne substances which may present health hazards, traffic safety problems or harm animal or plant life.	
Installation	DATE OF INSTALLATION: As needed to minimize dust
Maintenance Requirements	Most dust control measures, such as applications of water will require monitoring and repeat applications as needed to accomplish good control.
Design Specifications	See Construction Drawings and Details

2.6 Minimize the Disturbance of Steep Slopes

General

- Steep Slope Controls consists of surface roughening and rolled erosion control product. Using these controls will minimize the disturbance of steep slopes.

Specific Steep Slope Controls

SURFACE ROUGHENING	
Description: Grade Treatment or surface roughening creates horizontal depressions in the soil surface that help to reduce erosion by reducing runoff velocity and increasing infiltration. These depressions aid in the establishment of vegetative cover and provide localized trapping of sediments. Grade Treatment is typically created by operating tillage implements on the contour or by running tracked equipment up and down a slope without fine grading the surface.	
Installation	DATE OF INSTALLATION: As needed to minimize Steep Slope Disturbances
Maintenance Requirements	Roughened areas shall be seeded and mulched within seven (7) days of last disturbance to obtain optimum seed germination and seedling growth.
Design Specifications	See Construction Drawings and Details

ROLLED EROSION CONTROL PRODUCT	
Description: A Temporary Rolled Erosion Control Product (TRECP) is a degradable manufactured material used to stabilize easily eroded areas while vegetation becomes established. Temporary Rolled Erosion Control Products are degradable products composed of biologically, photo chemically or otherwise degradable materials. Temporary RECPs consist of erosion control netting, open weave textiles, and erosion control blankets and matings. These products reduce soil erosion and assist vegetative growth by providing temporary cover from the erosive action of rainfall and runoff while providing soil-seed contact.	
Installation	DATE OF INSTALLATION: As needed to minimize Steep Slope Disturbances
Maintenance Requirements	Roughened areas shall be seeded and mulched within seven (7) days of last disturbance to obtain optimum seed germination and seedling growth.
Design Specifications	See Construction Drawings and Details

2.7 Topsoil

General

- Topsoiling is when the upper most organic layer of soil is stripped and stockpiled from areas being graded and subsequently replaced on the newly graded areas. The native topsoil shall be preserved, if feasible.

Specific Topsoil Controls

TOPSOILING	
Description: Topsoiling occurs during grading operations as the upper most organic layer of soil is stripped and stockpiled from areas being graded and subsequently replaced on the newly graded areas. Topsoil provides a more suitable growing medium than subsoil or on areas with poor moisture, low nutrient levels, undesirable pH, or in the presence of other materials that would inhibit establishment of vegetation. Replacing topsoil helps plant growth by improving the water holding capacity and nutrient content and consistency of the soils.	
Installation	DATE OF INSTALLATION: As stripping of the topsoil occurs.
Maintenance Requirements	Topsoil stockpiles shall be protected to minimize any erosion. Temporary cover BMPs include temporary seeding, mulches, blankets, or mats.

Design Specifications	See Construction Drawings and Details
------------------------------	---------------------------------------

2.8 Soil Compaction

General

- Soil Compaction shall be implemented in areas where final vegetative stabilization will occur or where infiltration practices will be installed.

Specific Soil Compaction Controls

PERMANENT SEEDING	
<p>Description: Permanent vegetation is used to stabilize soil, reduce erosion, prevent sediment pollution, reduce runoff by promoting infiltration, and provide stormwater quality benefits offered by dense grass cover.</p> <p>Storm water quality and the amount of runoff both vary significantly with soil compaction. Non-compacted soils improve stormwater infiltration by promoting:</p> <ul style="list-style-type: none"> dense vegetative growth; high soil infiltration & lower runoff rates; pollutant filtration, deposition & absorption; and beneficial biologic activity in the soil. <p>Construction activity creates highly compacted soils that restrict water infiltration and root growth. The best time for improving soil condition is during the establishment of permanent vegetation. It is highly recommended that subsoilers, plows, or other implements are specified as part of final seedbed preparation. Use discretion in slip-prone areas.</p>	
Installation	<p>DATE OF INSTALLATION: Applied within 14 days of completion of work in areas set to final grade and topsoiling has been completed.</p>
Maintenance Requirements	<p>Permanent seeding shall not be considered established for at least 1 full year from the time of planting. Inspect the seeding for soil erosion or plant loss during this first year. Repair bare and sparse areas. Fill gullies. Re-fertilize, re-seed, and re-mulch if required. Consider no-till planting. A minimum of 70% growth density, based on a visual inspection, must exist for an adequate permanent vegetative planting.</p>
Design Specifications	See Construction Drawings and Details

2.9 Storm Drain Inlets

General

- Inlet protection measures shall be installed to remove sediment from discharges prior to entry into any storm drain inlet. Inlet protection measures shall be cleaned, or removed and replaced as sediment accumulates, the filter becomes clogged, and/or performance is compromised. Where there is evidence of sediment accumulation adjacent to the inlet protection measure, remove the deposited sediment by the end of the same business day in which it is found or by the end of the following business day if removal by the same business day is not feasible.

Specific Storm Drain Inlet Controls

STORM DRAIN INLET PROTECTION	
<p>Description: Storm drain inlet protection devices remove sediment from storm water before it enters storm sewers and downstream areas. Inlet protection devices are sediment barriers that may be constructed of washed gravel or crushed stone, geotextile fabrics and other materials that are supported around or across storm drain inlets. Inlet protection is installed to capture some sediment and reduce the maintenance of storm sewers and other underground piping systems prior to the site being stabilized. Due to their poorer effectiveness, inlet protection is considered a secondary sediment control to be used in conjunction with other more effective controls.</p>	
Installation	<p>DATE OF INSTALLATION: Before grading activities begin for existing inlets and after inlets have been installed for proposed inlets</p>
Maintenance Requirements	<p>Effective storm drain inlet protection collects sediment and therefore must be cleaned regularly to prevent clogging and subsequent flooding conditions, piping, or overtopping of the control structures. Sediment barriers that sag, fall over, or are not properly secured, must be promptly repaired or replaced. Inlet protection shall be inspected weekly and after each rainfall event. Areas where there is active traffic shall be inspected daily. Repairs shall be made as needed to assure the practice is performing as intended. Sediment shall be removed when accumulation is one-half the height of the trap. Sediment shall not be washed into the inlet. Sediment shall be removed and placed in a location where it is stable and not subject to erosion. Once the contributing drainage area has been properly stabilized, all filter material and collected sediment shall be removed and properly disposed. Clean, or remove and replace the protection measures as sediment accumulates, the filter becomes clogged, and/or performance is compromised. Where there is evidence of sediment accumulation adjacent to the inlet protection measure, remove the deposited sediment by the end of the same business day in which it is found or by the end of the following business day if removal by the same business day is not feasible.</p>
Design Specifications	See Construction Drawings and Details

BLOCK AND GRAVEL	
<p>Description: Block and gravel inlet protection devices use block and gravel filters installed over the storm water inlet to remove sediment from storm water before it enters storm sewers and downstream areas.</p>	
Installation	<p>DATE OF INSTALLATION: Before grading activities begin for existing inlets and after inlets have been installed for proposed inlets</p>
Maintenance Requirements	<p>Effective storm drain inlet protection collects sediment and therefore must be cleaned regularly to prevent clogging and subsequent flooding conditions, piping, or overtopping of the control structures. Sediment barriers that sag, fall over, or are not properly secured, must be promptly repaired or replaced. Inlet protection shall be inspected weekly and after each rainfall event. Areas where there is active traffic shall be inspected daily. Repairs shall be made as needed to assure the practice is performing as intended. Sediment shall be removed when accumulation is one-half the height of the trap. Sediment shall not be washed into the inlet. Sediment shall be removed and placed in a</p>

	location where it is stable and not subject to erosion. Once the contributing drainage area has been properly stabilized, all filter material and collected sediment shall be removed and properly disposed. Clean, or remove and replace the protection measures as sediment accumulates, the filter becomes clogged, and/or performance is compromised. Where there is evidence of sediment accumulation adjacent to the inlet protection measure, remove the deposited sediment by the end of the same business day in which it is found or by the end of the following business day if removal by the same business day is not feasible.
Design Specifications	See Construction Drawings and Details

2.10. Constructed Stormwater Conveyance Channels

General

- Stormwater conveyance channels controls shall be installed to control stormwater discharges, including both peak flowrates and total stormwater volume, to minimize channel and streambank erosion and scour in the immediate vicinity of discharge points.

Specific Conveyance Channel Controls

ROCK FILTER DAMS	
Description: Rock Filter dams are shaped rock dams constructed in swales, grassed waterways or diversions. They reduce the velocity of concentrated flows, thereby reducing erosion within the swale or waterway.	
Installation	DATE OF INSTALLATION: Rock Filter dams shall be installed before any land disturbance activities in existing conveyance, and immediately following installation of proposed conveyances.
Maintenance Requirements	Sediment shall be removed from behind rock filter dam once it accumulates to one-half the original height of the rock filter dam.
Design Specifications	See Construction Drawings and Details

ROCK OUTLET PROTECTION	
Description: A rock or riprap apron typically needed at the outlet of storm drains, culverts, or open channels. Rock Outlet Protection provides an erosion resistant transition area where concentrated or high velocity flows enter less modified channels or natural streams.	
Installation	DATE OF INSTALLATION: After storm drainage conveyances have been installed.
Maintenance Requirements	A maintenance program shall be established to maintain riprap and associated structural components such as pipe outlets, and tile lines. Items to consider in the maintenance program include: <ul style="list-style-type: none"> Determine responsible party to inspect and maintain the outlet protection after construction. Missing riprap should be replaced as soon as possible. Protect the outlet protection from damage by equipment and traffic. Remove sediment and debris that have accumulated.

Design Specifications	See Construction Drawings and Details
------------------------------	---------------------------------------

TEMPORARY DIVERSION	
Description: A temporary diversion is used to redirect sheet flow runoff from denuded areas. Runoff shall be intercepted by diversions to protect adjacent properties and water resources from sediment transported	
Installation	DATE OF INSTALLATION: Install at the beginning of earth disturbing operations to protect adjacent areas from damaging sheet and shallow concentrated flow.
Maintenance Requirements	A maintenance program shall be established to remove sediment and debris that have accumulated.
Design Specifications	See Construction Drawings and Details

2.11 Sediment Basins

General

- Sediment basins shall be installed outside of any waters of the US and any natural buffers. Basins shall be installed to avoid collecting water from wetlands. They shall be designed to provide storage for the 2-year, 24-hour design storm or 3,600 cubic feet per drained acre. Basins shall utilize outlet structures that withdraw water from the surface of the sediment basin. Basins shall use erosion control and velocity dissipation devices to prevent erosion at inlets and outlets.

Specific Sediment Basin Controls

SEDIMENT TRAP	
Description: A sediment trap is a temporary settling pond formed by construction of an embankment and/or excavated basin and having a simple outlet structure that is typically stabilized with geotextile and rip-rap. Sediment traps are constructed to detain sediment-laden runoff from small, disturbed areas for a sufficient period of time to allow the majority of the sediment to settle out. They are established early in the construction process using natural drainage patterns and favorable topography where possible to minimize grading.	
Installation	DATE OF INSTALLATION: Before disturbing more than 5 acres
Maintenance Requirements	The capacity and function of the sediment trap shall be maintained by inspecting on a weekly basis and after each runoff event, and by performing the necessary activities below. <ul style="list-style-type: none"> • Establish vegetative cover and fertilize as necessary to maintain a vigorous cover around the sediment trap. • Inspect the pool area, embankment and spillway area for burrowing rodents, slope failure, seepage, excess settlement, and displaced stone. The area should be inspected for structural soundness and repaired as needed. • Regularly inspect water discharged from trap for excess suspended sediments. Identify and perform necessary repairs to improve water quality. Excessive suspended sediments may require design modifications or treatment with flocculants.

	<ul style="list-style-type: none"> • Remove woody vegetated growth on the embankment and spillway areas. • Remove trash and debris that accumulate in the pond and have potential to block spill-ways. • Dewatering outlets shall be regularly checked to ensure that performance is maintained. Filter stone choked with sediment shall be removed and replaced to restore its flow capacity. • Remove sediment and restore the sediment trap to its original dimensions when sediment has accumulated to the top of the sediment storage or wet storage zone. This elevation shall be signified by the top of a stake near the center of the trap. Removing sediment by hand may be necessary adjacent to the outlet section of the embankment to prevent equipment damage. Place the removed sediment and stabilize with vegetation in a designated area where it will not easily erode again. Restore trap to its original dimensions and replace stone as needed on the outlet. <p>After the entire construction project is completed, temporary sediment traps should be dewatered and regraded so as to conform to the contours of the area. All temporary structures shall be removed and the area seeded, mulched and stabilized as necessary.</p>
Design Specifications	See Construction Drawings and Details

2.12 Chemical Treatment

Soil Types

List all the soil types (including soil types expected to be found in fill material) that are expected to be exposed during construction in areas of the project that will drain to chemical treatment systems: The general soil profile can be divided into four strata:

- o Fill material;
- o Clay Residuum.

Treatment Chemicals

List all treatment chemicals that will be used at the site and explain why these chemicals are suited to the soil characteristics: No Fertilization or pesticide applications are planned for this project. All concrete and asphalt will be delivered to the site in trucks and immediately placed. A concrete washout area will be used for cleaning of the concrete trucks. No onsite batch plants will be used. The equipment/vehicle fueling and maintenance practice that will be implemented to eliminate the discharge of spilled or leaked fuel will be a Fuel Containment Area. Contractor will have a designated area for fuel storage and handling that is equipped with spill response tools for containment and fast clean up. All vehicle maintenance to be performed off site in an approved location. Refer to Construction Drawings (Site Maps and Details) for information and details corresponding to the selected BMPs.

Describe the dosage of all treatment chemicals you will use at the site or the methodology you will use to determine dosage: N/A

Provide information from any applicable Safety Data Sheets (SDS): N/A

Describe how each of the chemicals will be stored: No chemicals will be stored within the laydown area.

Include references to applicable state or local requirements affecting the use of treatment chemicals, and copies of applicable manufacturer's specifications regarding the use of your specific treatment chemicals and/or chemical treatment systems: N/A

Special Controls for Cationic Treatment Chemicals (if applicable)

If the applicable EPA Regional Office authorized you to use cationic treatment chemicals, include the official EPA authorization letter or other communication, and identify the specific controls and implementation procedures designed to ensure that your use of cationic treatment chemicals will not lead to an exceedance of water quality standards: N/A

Schematic Drawings of Stormwater Controls/Chemical Treatment Systems

Provide schematic drawings of any chemically-enhanced stormwater controls or chemical treatment systems to be used for application of treatment chemicals: N/A

Training

Describe the training that personnel who handle and apply chemicals have received prior to permit coverage, or will receive prior to the use of treatment chemicals: N/A

2.13 Dewatering Practices

General

- Contractor shall treat dewatering discharges with controls to minimize discharges of pollutants. Contractor shall not discharge dewatering discharges if visible solids or foam are present. Dewatering activities shall utilize a suitable filtration device that is designed to remove suspended solids. Contractor shall replace and clean the filter media used in dewatering devices when the pressure differential equals or exceeds the manufacturer's specifications.

Specific Dewatering Practices

DEWATERING MEASURES	
<p>Description: Dewatering measures provide a stable area for receiving and treating water pumped from excavation or work areas prior to being released off the site. These practices reduce sediment impacts to downstream water resources.</p> <p>Geotextile Filter Bags: Commonly discharge is pumped into a filter bag chosen for the predominant sediment size. Filter bags are manufactured products made typically from woven monofilament polypropylene textile (coarse materials, e.g. sands) or non-woven geotextile (silts/clays). While they may be useful, they are generally high flow products, which have limited ability to treat fine-grained sediments. Gravity drained filter bags should apply the following:</p> <ul style="list-style-type: none"> • They should be placed outside of a vegetated filter area and not in close proximity to site storm water controls. • They must sit on a relatively flat grade so that water leaving the bag does not cause additional erosion. Placing the bag on a flat bed of aggregate will maximize the flow and useful surface area of the bag. 	
Installation	<p>DATE OF INSTALLATION: Before dewatering activities occur.</p>
Maintenance Requirements	<p>Filter Bags are single use products that must be replaced when they become clogged or half full of sediment. Trapped sediment to be removed shall be spread on the project site at an appropriate location away from storm water controls and stabilized with permanent seeding. With backwash water, either</p>

	haul it away for disposal or return it to the beginning of the treatment process; and replace and clean the filter media used in dewatering devices when the pressure differential equals or exceeds the manufacturer's specifications.
Design Specifications	See Construction Drawings and Details

2.14 Other Stormwater Controls

General

- N/A

Specific Stormwater Control Practices

- N/A

2.15 Site Stabilization

Total Amount of Land Disturbance Occurring at Any One Time

- Five Acres or less
 More than Five Acres

TEMPORARY SEEDING	
<input checked="" type="checkbox"/> Vegetative <input type="checkbox"/> Non-Vegetative <input checked="" type="checkbox"/> Temporary <input type="checkbox"/> Permanent	
Description: <ul style="list-style-type: none"> ▪ Temporary seedings establish temporary cover on disturbed areas by planting appropriate rapidly growing annual grasses or small grains. Temporary seeding provides erosion control on areas in between construction operations. Grasses, which are quick growing, are seeded and usually mulched to provide prompt, temporary soil stabilization. ▪ Temporary seeding should be applied on exposed soil where additional work is not scheduled for more than 14 days. 	
Installation	DATE OF INSTALLATION: Temporary seeding shall be installed if site is unused for more than 14 days.
Completion	COMPLETION DATE: Once site is permanently stabilized
Maintenance Requirements	Areas failing to establish vegetative cover adequate to prevent erosion shall be reseeded as soon as such areas are identified.
Design Specifications	See Construction Drawings and Details

TEMPORARY AGGREGATE SURFACING	
<input type="checkbox"/> Vegetative <input checked="" type="checkbox"/> Non-Vegetative <input checked="" type="checkbox"/> Temporary <input type="checkbox"/> Permanent	
Description: <ul style="list-style-type: none"> Temporary aggregate is a temporary cover on disturbed areas by placing and compacting aggregate. Temporary aggregate surfacing provides a laydown area for construction operations. Temporary Aggregate Surfacing should be applied on exposed soil where additional work is not scheduled for more than 14 days. 	
Installation	DATE OF INSTALLATION:
Completion	COMPLETION DATE:
Maintenance Requirements	This may require periodic top dressing with additional stone or the washing and reworking of existing stone as conditions demand.
Design Specifications	See Construction Drawings and Details

PERMANENT SEEDING	
<input checked="" type="checkbox"/> Vegetative <input type="checkbox"/> Non-Vegetative <input type="checkbox"/> Temporary <input checked="" type="checkbox"/> Permanent	
Description: <ul style="list-style-type: none"> Permanent vegetation is used to stabilize soil, reduce erosion, prevent sediment pollution, reduce runoff by promoting infiltration, and provide stormwater quality benefits offered by dense grass cover. Any disturbed areas or portions of construction sites at final grade. Permanent seeding should not be delayed on any one portion of the site at final grade while construction on another portion of the site is being completed. Permanent seeding shall be completed in phases, if necessary. 	
Installation	DATE OF INSTALLATION:
Completion	COMPLETION DATE:
Maintenance Requirements	Permanent seeding shall not be considered established for at least 1 full year from the time of planting. Inspect the seeding for soil erosion or plant loss during this first year. Repair bare and sparse areas. Fill gullies. Re-seed and re-mulch if required. Consider no-till planting. A minimum of 70% growth density, based on a visual inspection, must exist for an adequate permanent vegetative planting.
Design Specifications	See Construction Drawings and Details

PERMANENT AGGREGATE SURFACING	
<input type="checkbox"/> Vegetative <input checked="" type="checkbox"/> Non-Vegetative <input type="checkbox"/> Temporary <input checked="" type="checkbox"/> Permanent	
Description: <ul style="list-style-type: none"> ▪ Permanent aggregate is a permanent cover on disturbed areas by placing and compacting aggregate. 	
Installation	DATE OF INSTALLATION:
Completion	COMPLETION DATE:
Maintenance Requirements	This may require periodic top dressing with additional stone or the washing and reworking of existing stone as conditions demand.
Design Specifications	See Construction Drawings and Details

SECTION 3: GOOD HOUSEKEEPING BMPS

3.1 Spill Prevention and Response

Any hazardous or potentially hazardous material that is brought onto the construction site shall be handled properly to reduce the potential for stormwater pollution. All materials used on this construction site shall be properly stored, handled, dispensed and disposed of following all applicable label directions. Flammable and combustible liquids shall be stored and handled according to applicable regulations. Only approved containers and portable tanks shall be used for storage and handling of flammable and combustible liquids.

Safety Data Sheets (SDS) information shall be kept on site for all hazardous or potentially hazardous materials. Alternately, SDS may also be accessed via telephone or other electronic means or apparatus.

In the event of an accidental spill, immediate action shall be taken by the Contractor to contain and remove the spilled material. The spill shall be reported to the appropriate agencies in the required time frames. As required under the provisions of the Clean Water Act, any spill or discharge entering waters of the United States shall be properly reported.

Any spills of petroleum products or hazardous materials in excess of reportable quantities as defined by the EPA, state or local agency regulations, shall be immediately reported and documented.

To minimize the potential for spills to come into contact with stormwater, the following steps shall be taken:

1. All materials with hazardous properties, including but not necessarily limited to, pesticides, petroleum products, fertilizers, soaps, detergents, construction chemicals, acids, bases, paints, paint solvents, additives for soil stabilization, concrete, curing compounds and additives, shall be stored in a secure location, under cover and in appropriate, tightly sealed containers when not in use.
2. The minimum practical quantity of all such materials shall be kept on the job site and scheduled for delivery as close to time of use as practical.
3. A spill control and containment kit (containing for example, absorbent material such as kitty litter or sawdust, acid, base, neutralizing agent, brooms, dust pans, mops, rags, gloves, goggles, plastic and metal trash containers, etc.) shall be provided at the construction site and its location(s) shall be identified with legible signage and annotated by the Contractor on the Construction Drawings.
 - a. The spill control and containment kit supplies shall be of sufficient quantities and appropriate content to contain a spill from the largest anticipated piece of equipment and from the largest anticipated quantities of products stored on the site at any given time.
 - b. Contents shall be inspected regularly.
4. All products shall be stored in and used from the original container with the original product label. Containers must be stored in a manner to protect them from the elements and incidental damage.

5. All products shall be used in strict compliance with instructions on the product label. The disposal of excess or used products shall be in strict compliance with instructions on the product label and regulations.

3.2 Fueling and Maintenance of Equipment or Vehicles

General

- The equipment/vehicle fueling and maintenance practice that will be implemented to eliminate the discharge of spilled or leaked chemicals will be a Fuel Containment Area. Refer to Construction Drawings for information and details corresponding to the selected BMPs. Contractor will have a designated area for fuel storage and handling that is equipped with spill response tools for containment and fast clean up. All vehicle maintenance to be performed off site in an approved location.

Specific Pollution Prevention Practices

FUEL CONTAINMENT AREA	
Description: Above grade area created using straw bales and 10 mil plastic lining. Operator is required to be present during any fueling operation - if spill occurs then clean-up procedures will be initiated.	
Installation	DATE OF INSTALLATION: Before any fueling activities on site occur.
Maintenance Requirements	Avoid mobile fueling of mobile construction equipment around the site; rather, transport the equipment to designated fueling areas. Train employees and subcontractors in proper fueling and cleanup procedures. Dedicated fueling areas should be protected from stormwater runoff and runoff and should be located at least 50 feet away from downstream drainage facilities and watercourses. Fueling must be performed on level-grade areas. Vehicles and equipment should be inspected each day of use for leaks. Leaks should be repaired immediately or problem vehicles or equipment should be removed from the project site.
Design Specifications	See Construction Drawings and Details

3.3 Washing of Equipment and Vehicles

General

- Washing of equipment and vehicles is not expected as part of this project but if needed:
- The washing of equipment and vehicles practice that will be implemented to minimize the discharge of pollutants from equipment and vehicle washing, wheel wash water, and other types of wash waters will be a Washing Area

Specific Pollution Prevention Practices

WASHING AREA	
Description: Above grade area created for washing vehicles with water only.	
Installation	DATE OF INSTALLATION: Before any washing of vehicles occurs.
Maintenance	Equipment and vehicles contaminated with fuel, oil, and/or other hazardous

Requirements	materials shall not be washed on site. Detergents/Solvents are not to be used on site.
Design Specifications	See Construction Drawings and Details

3.4 Storage, Handling, and Disposal of Construction Products, Materials, and Wastes

3.4.1 Building Products

General

- All building products shall be stored in appropriate laydown areas out of pedestrian and vehicle pathways. Building materials and products shall be covered to minimize exposure to precipitation and stormwater.

Specific Pollution Prevention Practices

STORAGE, HANDLING, AND DISPOSAL OF BUILDING PRODUCTS, MATERIALS, AND WASTES	
Description: All building materials to be stored, handled, and disposed of in a manner to prevent pollutants from reaching storm water. All waste material will be placed in appropriate waste containers and managed per applicable state and federal requirements. Materials are outdoor ready and do not require cover. There will be some electrical and non-weather ready compartments covered.	
Installation	DATE OF INSTALLATION:
Maintenance Requirements	All storage areas to be inspected on a regular basis to ensure proper function and housekeeping.
Design Specifications	As determined by contractor.

3.4.2 Pesticides, Herbicides, Insecticides, Fertilizers, and Landscape Materials

General

- No pesticides, herbicides, insecticides, or fertilizers are planned for this project.

Specific Pollution Prevention Practices

N/A

3.4.3 Diesel Fuel, Oil, Hydraulic Fluids, Other Petroleum Products, and Other Chemicals

General

- Diesel fuel, oil, hydraulic fluids, other petroleum products, and other chemicals shall be stored in water-tight containers and provided with cover to minimize the exposure of the containers to precipitation and stormwater. All spills shall be cleaned up immediately, using dry clean-up methods where possible. Dispose of used and waste materials properly. The contractor is prohibited from hosing down the area to clean surfaces or spills.

Specific Pollution Prevention Practices

FUEL CONTAINMENT AREA	
Description: Above grade area created using straw bales and 10 mil plastic lining. Operator is required to be present during any fueling operation - if spill occurs then clean-up procedures will be initiated.	
Installation	DATE OF INSTALLATION: Before any fueling activities on site occur.
Maintenance Requirements	Avoid mobile fueling of mobile construction equipment around the site; rather, transport the equipment to designated fueling areas. Train employees and subcontractors in proper fueling and cleanup procedures. Dedicated fueling areas should be protected from stormwater runoff and should be located at least 50 feet away from downstream drainage facilities and watercourses. Fueling must be performed on level-grade areas. Vehicles and equipment should be inspected each day of use for leaks. Leaks should be repaired immediately, or problem vehicles or equipment should be removed from the project site.
Design Specifications	See Construction Drawings and Details

3.4.4 Hazardous or Toxic Waste

General

- Construction contractors shall provide means and methods for storing and handling hazardous materials on site. These methods are intended to prevent accidental spills from contaminating storm water and area soils and to facilitate prompt clean out. These methods may include double containment, impervious surfaces, absorbing mats and / or perimeter berms. Contractor will notify the site spill response team in the event that a leak is detected to ensure proper clean out or remediation is implemented immediately. A very minimum amount of hazardous or toxic waste is expected. Contractor shall handle and dispose of all toxic or hazardous substances in strict compliance with EPA and applicable local jurisdiction regulations. Covered and leak-proof containers are planned for disposal of hazardous or petroleum wastes.

Specific Pollution Prevention Practices

- As determined by the Contractor.

3.4.5 Construction and Domestic Waste

General

- Waste bin will be available on site to dispose of general construction waste. Contractor will be responsible for providing and emptying the waste bin. Whenever possible, covered and leak-proof containers are planned for disposal of debris and trash. The site best management practice is that disposal of chemical liquids into general construction waste bins is not allowed. All liquid disposal will be coordinated through the site waste coordinator to ensure proper disposal.

Specific Pollution Prevention Practices

SOLID WASTE CONTAINERS	
Description: All waste material will be placed in appropriate waste containers and managed per state and federal requirements.	
Installation	DATE OF INSTALLATION: Before waste materials accumulate.
Maintenance Requirements	All waste containers to be inspected on a regular basis to ensure proper function and housekeeping.
Design Specifications	As determined by Contractor

3.4.6 Sanitary Waste

General

- Portable toilets will be installed so that they are secure and will not be tipped or knocked over. They will be located away from waters of the US and stormwater inlets or conveyances.

Specific Pollution Prevention Practices

PORTABLE SANITARY WASTE CONTAINERS	
Description: Contract a service to pump out porta-potties and manage waste per state and federal regulatory requirements.	
Installation	DATE OF INSTALLATION: Prior to deployment of Contractor's employees to the project site.
Maintenance Requirements	All sanitary portable toilets and collection tanks to be inspected and emptied on a contract basis to ensure proper function and maintenance.
Design Specifications	As determined by Contractor

3.5 Washing of Applicators and Containers used for Paint, Concrete or Other Materials

General

- All washing of applicators and containers used for paint, concrete, or other materials shall direct wash waters into a leak-proof container or leak-proof and lined pit designed so that no overflows can occur due to inadequate sizing or precipitation. Contractor shall not dump liquid wastes in storm sewers or waters of the US and shall remove and dispose of hardened concrete waste consistent of waste disposal.

Specific Pollution Prevention Practices

CONCRETE WASHOUT AREA	
Description: Above grade area created using straw bales and 10 mil plastic lining. Operator is required to be present during washout operation.	
Installation	DATE OF INSTALLATION: Before concrete operations begin.
Maintenance Requirements	Inspect at least once per seven calendar days, or within a reasonable time period (not to exceed 48 hours) of a rainfall event which causes stormwater runoff to occur onsite. Remove and disposed of hardened concrete and return

	the facility to a functional condition. Washout facilities must be cleaned, or new facilities must be constructed and ready for use once the washout is 75% full.
Design Specifications	See Construction Drawings.

3.6 Fertilizers

General

- No fertilizers are planned for this project.

Specific Pollution Prevention Practices

N/A

3.7 Other Pollution Prevention Practices

General

- N/A

Specific Pollution Prevention Practices

- N/A

SECTION 4: SELECTING POST-CONSTRUCTION BMPs

N/A

SECTION 5: INSPECTIONS

5.1 Inspections

Personnel Responsible for Inspections

Cole Smith

Note: All personnel conducting inspections must be considered a "qualified person." CGP Part 4.1.1 clarifies that a "qualified person" is a person knowledgeable in the principles and practices of erosion and sediment controls and pollution prevention, who possesses the skills to assess conditions at the construction site that could impact stormwater quality, and the skills to assess the effectiveness of any stormwater controls selected and installed to meet the requirements of this permit.

Inspection Schedule

Specific Inspection Frequency

Standard frequency:
<input type="checkbox"/> Every 7 days <input checked="" type="checkbox"/> Every 14 days and within 24 hours of a 0.25" rain or the occurrence of runoff from snowmelt sufficient enough to cause a discharge
Increased Frequency (if applicable): N/A
For areas of sites discharging to sediment or nutrient-impaired waters or to waters designated as Tier 2, Tier 2.5, or Tier 3 <input type="checkbox"/> Every 7 days and within 24 hours of a 0.25" rain
Reduced Frequency (if applicable) N/A
For stabilized areas <input type="checkbox"/> Twice during first month, no more than 14 calendar days apart; then once per month after first month; <ul style="list-style-type: none"> ▪ Stabilized Areas: ▪ Date That They Were Completed:
For stabilized areas on "linear construction sites" <input type="checkbox"/> Twice during first month, no more than 14 calendar days apart; then once more within 24 hours of a 0.25" rain <ul style="list-style-type: none"> ▪ N/A
For arid, semi-arid, or drought-stricken areas during seasonally dry periods or during drought <input type="checkbox"/> Once per month and within 24 hours of a 0.25" rain <ul style="list-style-type: none"> ▪ N/A
For frozen conditions where earth-disturbing activities are being conducted <input type="checkbox"/> Once per month <ul style="list-style-type: none"> ▪ N/A

SECTION 6: RECORDKEEPING AND TRAINING

6.1 Recordkeeping

Records will be retained for a minimum period of at least 3 years after the permit is terminated.

Date(s) when major grading activities occur:

Date(s) when construction activities temporarily or permanently cease on a portion of the site:

Date(s) when an area is either temporarily or permanently stabilized:

6.2 Log of Changes to the SWPPP

Log of changes and updates to the SWPPP
See Appendix G

6.3 Training

Individual(s) Responsible for Training:
See Appendix J

Describe Training Conducted:

- General stormwater and BMP awareness training for staff and subcontractors:
- Detailed training for staff and subcontractors with specific stormwater responsibilities:

SECTION 7: FINAL STABILIZATION

See Site Stabilization

SECTION 8: CERTIFICATION AND NOTIFICATION

I certify under penalty of law that this document and all attachments were prepared under my direction or supervision in accordance with a system designed to assure that qualified personnel properly gathered and evaluated the information submitted. Based on my inquiry of the person or persons who manage the system, or those persons directly responsible for gathering the information, the information submitted is, to the best of my knowledge and belief, true, accurate, and complete. I am aware that there are significant penalties for submitting false information, including the possibility of fine and imprisonment for knowing violations.

Name: Ken Vogel Title: Civil Engineer
Signature:  Date: 02-07-2024

Repeat as needed for multiple construction operators at the site

SWPPP APPENDICES

Appendix A – General Location Map

Appendix B – Site Maps

Appendix C – Construction General Permit

Appendix D – NOI and Acknowledgement Letter from EPA/State

Appendix E – Inspection Reports

Appendix F – Corrective Action Log

Appendix G – SWPPP Amendment Log

Appendix H – Subcontractor Certifications/Agreements

Appendix I – Grading and Stabilization Activities Log

Appendix J – Training Log

Appendix K – Delegation of Authority

Appendix L – Additional Information (i.e., Endangered Species and Historic Preservation Documentation)

Appendix A – General Location Map

Appendix B – Site Maps



NOTES:

1. THE PERMITTEE SHALL BE RESPONSIBLE FOR OBTAINING ALL NECESSARY PERMITS FROM THE LOCAL, STATE AND FEDERAL AGENCIES.
2. THE PERMITTEE SHALL BE RESPONSIBLE FOR OBTAINING ALL NECESSARY EASEMENTS FROM THE ADJACENT PROPERTY OWNERS.
3. THE PERMITTEE SHALL BE RESPONSIBLE FOR OBTAINING ALL NECESSARY CONVEYANCES FROM THE ADJACENT PROPERTY OWNERS.
4. THE PERMITTEE SHALL BE RESPONSIBLE FOR OBTAINING ALL NECESSARY RECORDS FROM THE ADJACENT PROPERTY OWNERS.
5. THE PERMITTEE SHALL BE RESPONSIBLE FOR OBTAINING ALL NECESSARY RECORDS FROM THE ADJACENT PROPERTY OWNERS.
6. THE PERMITTEE SHALL BE RESPONSIBLE FOR OBTAINING ALL NECESSARY RECORDS FROM THE ADJACENT PROPERTY OWNERS.
7. THE PERMITTEE SHALL BE RESPONSIBLE FOR OBTAINING ALL NECESSARY RECORDS FROM THE ADJACENT PROPERTY OWNERS.
8. THE PERMITTEE SHALL BE RESPONSIBLE FOR OBTAINING ALL NECESSARY RECORDS FROM THE ADJACENT PROPERTY OWNERS.
9. THE PERMITTEE SHALL BE RESPONSIBLE FOR OBTAINING ALL NECESSARY RECORDS FROM THE ADJACENT PROPERTY OWNERS.
10. THE PERMITTEE SHALL BE RESPONSIBLE FOR OBTAINING ALL NECESSARY RECORDS FROM THE ADJACENT PROPERTY OWNERS.

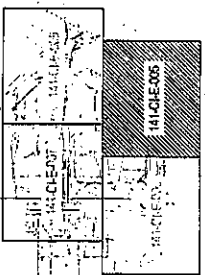

KEY PLAN

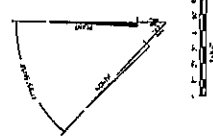

REV.	DATE	DESCRIPTION	BY	APP.
0	01/24	ISSUED FOR CONSTRUCTION	SS	SS
A	11/23	ISSUED FOR APPROVAL	SS	SS

GP
Georgia-Pacific
Monticello LLC

CONTRACT NO.: 1001-GP-USA, INC.
 SCALE: AS SHOWN DATE: 11/19/2023
 DRAWN BY: C. BROWN
 CHECKED BY: J. BROWN
 APPROVED BY: J. BROWN
 PAPER TAG NO.: 141-CI-E-005-049
 TITLE: NEW LEACHERY INITIAL EROSION AND SEDIMENT CONTROL AND ROUGH GRADING PLAN SHEET 1
 DRAWING NO.: 141-CI-E-005
 REV: 0

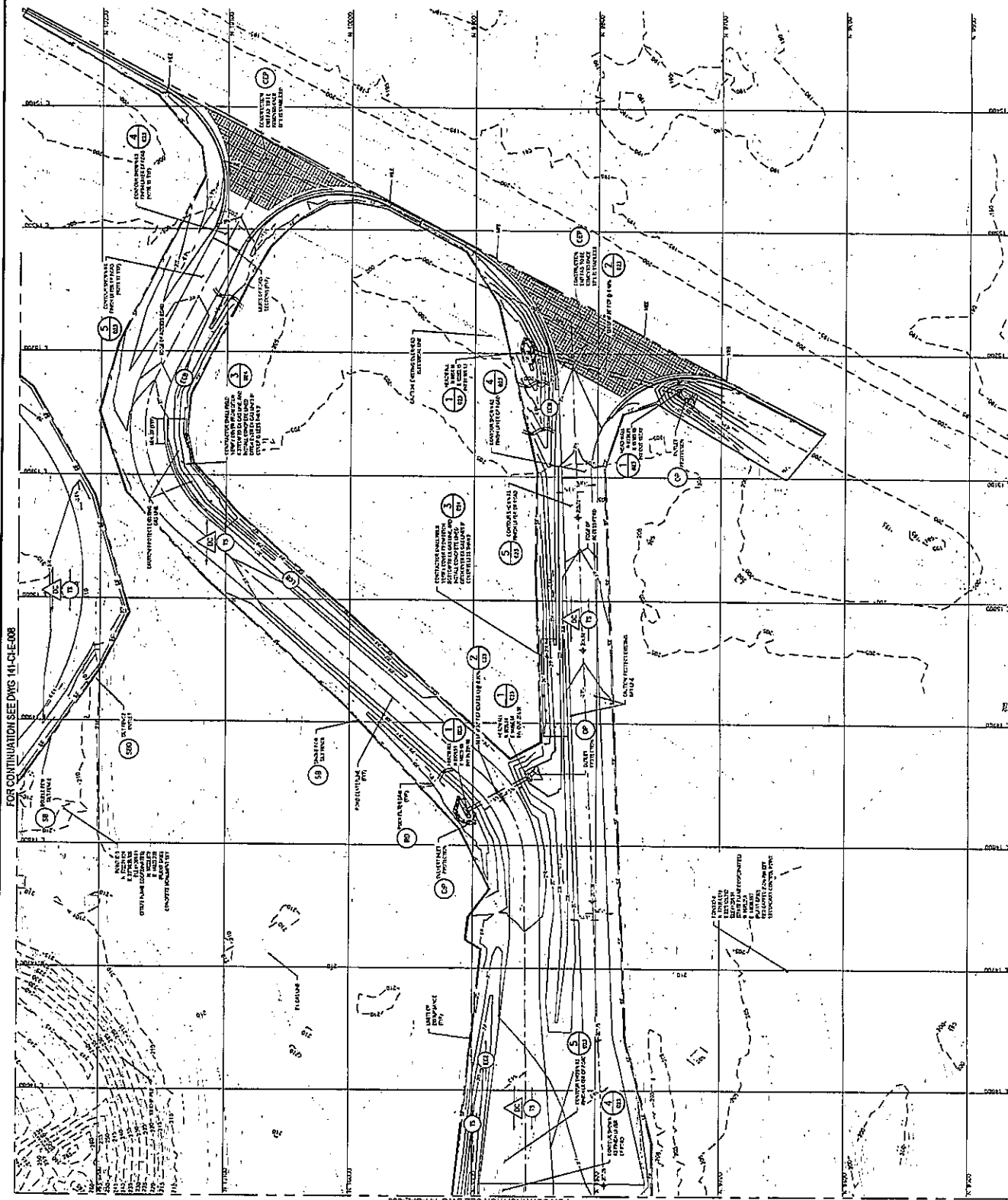

FOR CONTINUATION SEE DWG 141-CI-E-008

FOR CONTINUATION SEE DWG 141-CI-E-008

WORK SAFELY

ALL REQUIRED PERMITS FOR THE SITE SHALL BE IN PLACE PRIOR TO THE START OF CONSTRUCTION. THE PERMITTEE SHALL BE RESPONSIBLE FOR OBTAINING ALL NECESSARY PERMITS FROM THE LOCAL, STATE AND FEDERAL AGENCIES. THE PERMITTEE SHALL BE RESPONSIBLE FOR OBTAINING ALL NECESSARY EASEMENTS FROM THE ADJACENT PROPERTY OWNERS. THE PERMITTEE SHALL BE RESPONSIBLE FOR OBTAINING ALL NECESSARY CONVEYANCES FROM THE ADJACENT PROPERTY OWNERS. THE PERMITTEE SHALL BE RESPONSIBLE FOR OBTAINING ALL NECESSARY RECORDS FROM THE ADJACENT PROPERTY OWNERS.



REFERENCES

DRAWING NO.	DESCRIPTION

- NOTES:**
1. ALL DIMENSIONS ARE TO CENTERLINE UNLESS OTHERWISE NOTED.
 2. ALL CONSTRUCTION SHALL BE IN ACCORDANCE WITH THE LATEST EDITIONS OF THE MISSISSIPPI AND ALABAMA COUNTY FOR LAID DISTURBANCE, FLOODPLAIN, BUILDING, AND ANY OTHER APPLICABLE PERMITS SHALL BE IN HAND PRIOR TO THE START OF CONSTRUCTION. ALL WORK SHALL BE IN ACCORDANCE WITH THE LATEST EDITIONS OF THE MISSISSIPPI AND ALABAMA COUNTY FOR LAID DISTURBANCE, FLOODPLAIN, BUILDING, AND ANY OTHER APPLICABLE PERMITS SHALL BE IN HAND PRIOR TO THE START OF CONSTRUCTION.
 3. THE CONTRACTOR SHALL BE RESPONSIBLE FOR OBTAINING ALL NECESSARY PERMITS AND FOR THE PROTECTION OF ALL EXISTING UTILITIES AND STRUCTURES.
 4. THE CONTRACTOR SHALL MAINTAIN ACCESS TO ALL ADJACENT PROPERTIES AT ALL TIMES.
 5. THE CONTRACTOR SHALL BE RESPONSIBLE FOR THE PROTECTION OF ALL EXISTING UTILITIES AND STRUCTURES.
 6. THE CONTRACTOR SHALL MAINTAIN ACCESS TO ALL ADJACENT PROPERTIES AT ALL TIMES.
 7. THE CONTRACTOR SHALL BE RESPONSIBLE FOR THE PROTECTION OF ALL EXISTING UTILITIES AND STRUCTURES.
 8. THE CONTRACTOR SHALL MAINTAIN ACCESS TO ALL ADJACENT PROPERTIES AT ALL TIMES.
 9. THE CONTRACTOR SHALL BE RESPONSIBLE FOR THE PROTECTION OF ALL EXISTING UTILITIES AND STRUCTURES.
 10. THE CONTRACTOR SHALL MAINTAIN ACCESS TO ALL ADJACENT PROPERTIES AT ALL TIMES.

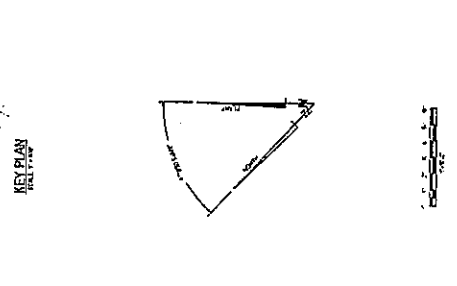
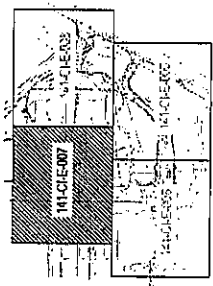

REV.	DATE	EXTENSION DESCRIPTION	BY	APP'D
0	01/24	ISSUED FOR CONSTRUCTION	J. S.	SS
1	11/23	ISSUED FOR APPROVAL	J. S.	SS

Georgia-Pacific
Monticello LLC

CONSULTANT: WOOD GROUP USA, INC.
SCALE AS NOTED DATE 11/20/2023
DRAWN BY: J. S. CHECKED BY: J. S.
APPROVED BY: J. S. CUD PREPARED BY: J. S.
PAPER NO. 141-CI-E-007
TITLE: NEW IDENTIFICATION CONTROL AND BOUNDARY SURVEY PLAN SHEET 3
DRAWING NO.: 141-CI-E-007
REF: 0

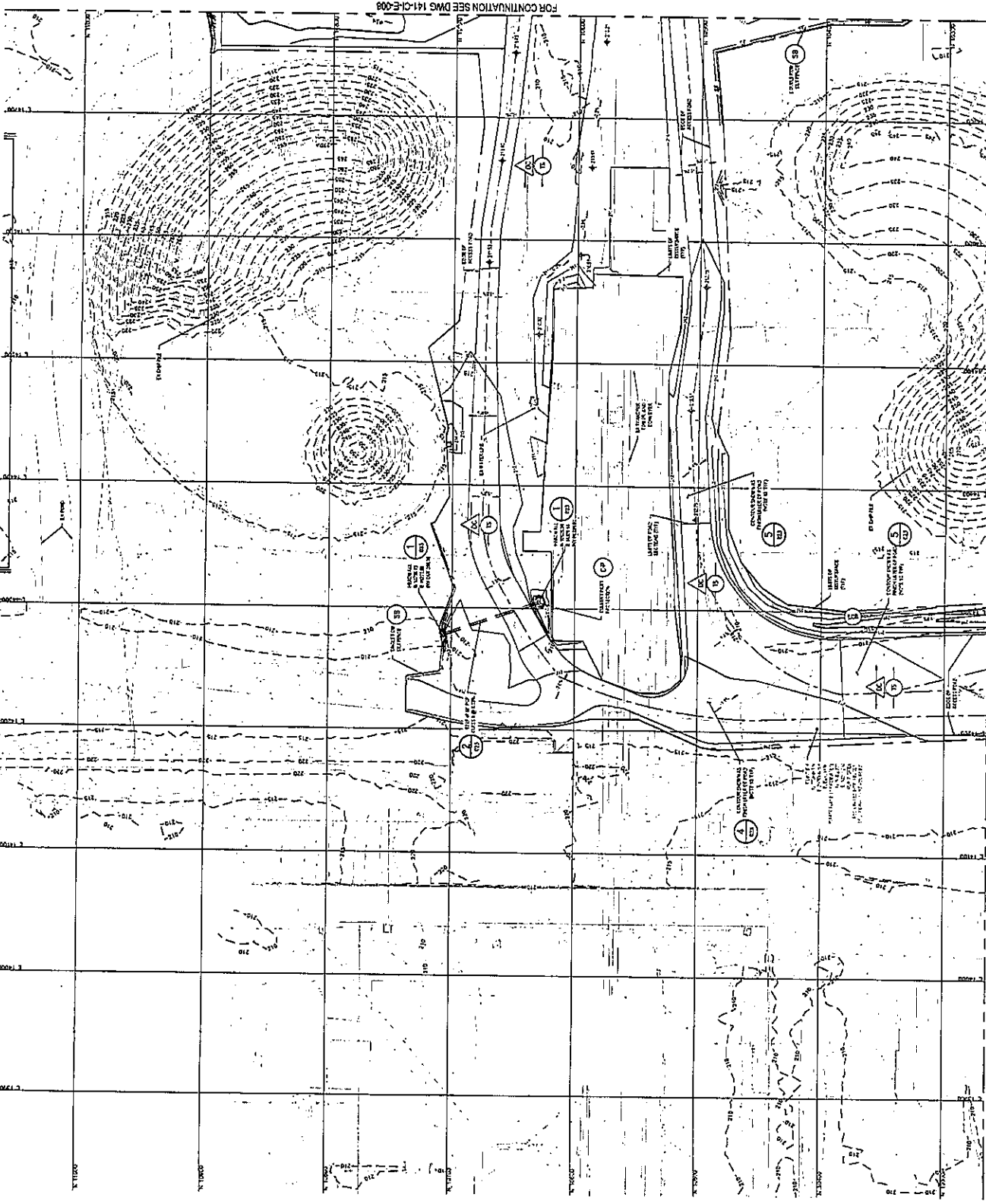

FOR CONTINUATION SEE DWG 141-CI-E-008

WORK SAFETY

RECORDED PERMITS FOR THE SITE SHALL BE IN PLACE PRIOR TO THE START OF ALL LAND DISTURBANCE ACTIVITIES PERMITTED AS REQUIRED BY THE STATE OF MISSISSIPPI AND ALABAMA COUNTY FOR LAID DISTURBANCE, FLOODPLAIN, BUILDING, AND ANY OTHER APPLICABLE PERMITS SHALL BE IN HAND PRIOR TO THE START OF CONSTRUCTION. ALL WORK SHALL BE IN ACCORDANCE WITH THE LATEST EDITIONS OF THE MISSISSIPPI AND ALABAMA COUNTY FOR LAID DISTURBANCE, FLOODPLAIN, BUILDING, AND ANY OTHER APPLICABLE PERMITS SHALL BE IN HAND PRIOR TO THE START OF CONSTRUCTION.



FOR CONTINUATION SEE DWG 141-CI-E-008

RECORDED PERMITS FOR THE SITE SHALL BE IN PLACE PRIOR TO THE START OF ALL LAND DISTURBANCE ACTIVITIES PERMITTED AS REQUIRED BY THE STATE OF MISSISSIPPI AND ALABAMA COUNTY FOR LAID DISTURBANCE, FLOODPLAIN, BUILDING, AND ANY OTHER APPLICABLE PERMITS SHALL BE IN HAND PRIOR TO THE START OF CONSTRUCTION. ALL WORK SHALL BE IN ACCORDANCE WITH THE LATEST EDITIONS OF THE MISSISSIPPI AND ALABAMA COUNTY FOR LAID DISTURBANCE, FLOODPLAIN, BUILDING, AND ANY OTHER APPLICABLE PERMITS SHALL BE IN HAND PRIOR TO THE START OF CONSTRUCTION.

NOTES:

1. THE CONTRACTOR SHALL BE RESPONSIBLE FOR OBTAINING ALL NECESSARY PERMITS FROM THE MISSISSIPPI DEPARTMENT OF TRANSPORTATION AND CONSTRUCTION (MDOT&C) AND THE MISSISSIPPI DEPARTMENT OF REVENUE AND TAXATION (MDRT) PRIOR TO THE START OF CONSTRUCTION.
2. THE CONTRACTOR SHALL MAINTAIN ACCESS TO ALL ADJACENT PROPERTIES AND PUBLIC ROADS AT ALL TIMES.
3. THE CONTRACTOR SHALL BE RESPONSIBLE FOR OBTAINING ALL NECESSARY PERMITS FROM THE MISSISSIPPI DEPARTMENT OF TRANSPORTATION AND CONSTRUCTION (MDOT&C) AND THE MISSISSIPPI DEPARTMENT OF REVENUE AND TAXATION (MDRT) PRIOR TO THE START OF CONSTRUCTION.
4. THE CONTRACTOR SHALL MAINTAIN ACCESS TO ALL ADJACENT PROPERTIES AND PUBLIC ROADS AT ALL TIMES.
5. THE CONTRACTOR SHALL BE RESPONSIBLE FOR OBTAINING ALL NECESSARY PERMITS FROM THE MISSISSIPPI DEPARTMENT OF TRANSPORTATION AND CONSTRUCTION (MDOT&C) AND THE MISSISSIPPI DEPARTMENT OF REVENUE AND TAXATION (MDRT) PRIOR TO THE START OF CONSTRUCTION.
6. THE CONTRACTOR SHALL MAINTAIN ACCESS TO ALL ADJACENT PROPERTIES AND PUBLIC ROADS AT ALL TIMES.
7. THE CONTRACTOR SHALL BE RESPONSIBLE FOR OBTAINING ALL NECESSARY PERMITS FROM THE MISSISSIPPI DEPARTMENT OF TRANSPORTATION AND CONSTRUCTION (MDOT&C) AND THE MISSISSIPPI DEPARTMENT OF REVENUE AND TAXATION (MDRT) PRIOR TO THE START OF CONSTRUCTION.
8. THE CONTRACTOR SHALL MAINTAIN ACCESS TO ALL ADJACENT PROPERTIES AND PUBLIC ROADS AT ALL TIMES.
9. THE CONTRACTOR SHALL BE RESPONSIBLE FOR OBTAINING ALL NECESSARY PERMITS FROM THE MISSISSIPPI DEPARTMENT OF TRANSPORTATION AND CONSTRUCTION (MDOT&C) AND THE MISSISSIPPI DEPARTMENT OF REVENUE AND TAXATION (MDRT) PRIOR TO THE START OF CONSTRUCTION.
10. THE CONTRACTOR SHALL MAINTAIN ACCESS TO ALL ADJACENT PROPERTIES AND PUBLIC ROADS AT ALL TIMES.
11. THE CONTRACTOR SHALL BE RESPONSIBLE FOR OBTAINING ALL NECESSARY PERMITS FROM THE MISSISSIPPI DEPARTMENT OF TRANSPORTATION AND CONSTRUCTION (MDOT&C) AND THE MISSISSIPPI DEPARTMENT OF REVENUE AND TAXATION (MDRT) PRIOR TO THE START OF CONSTRUCTION.
12. THE CONTRACTOR SHALL MAINTAIN ACCESS TO ALL ADJACENT PROPERTIES AND PUBLIC ROADS AT ALL TIMES.
13. THE CONTRACTOR SHALL BE RESPONSIBLE FOR OBTAINING ALL NECESSARY PERMITS FROM THE MISSISSIPPI DEPARTMENT OF TRANSPORTATION AND CONSTRUCTION (MDOT&C) AND THE MISSISSIPPI DEPARTMENT OF REVENUE AND TAXATION (MDRT) PRIOR TO THE START OF CONSTRUCTION.
14. THE CONTRACTOR SHALL MAINTAIN ACCESS TO ALL ADJACENT PROPERTIES AND PUBLIC ROADS AT ALL TIMES.
15. THE CONTRACTOR SHALL BE RESPONSIBLE FOR OBTAINING ALL NECESSARY PERMITS FROM THE MISSISSIPPI DEPARTMENT OF TRANSPORTATION AND CONSTRUCTION (MDOT&C) AND THE MISSISSIPPI DEPARTMENT OF REVENUE AND TAXATION (MDRT) PRIOR TO THE START OF CONSTRUCTION.
16. THE CONTRACTOR SHALL MAINTAIN ACCESS TO ALL ADJACENT PROPERTIES AND PUBLIC ROADS AT ALL TIMES.
17. THE CONTRACTOR SHALL BE RESPONSIBLE FOR OBTAINING ALL NECESSARY PERMITS FROM THE MISSISSIPPI DEPARTMENT OF TRANSPORTATION AND CONSTRUCTION (MDOT&C) AND THE MISSISSIPPI DEPARTMENT OF REVENUE AND TAXATION (MDRT) PRIOR TO THE START OF CONSTRUCTION.
18. THE CONTRACTOR SHALL MAINTAIN ACCESS TO ALL ADJACENT PROPERTIES AND PUBLIC ROADS AT ALL TIMES.
19. THE CONTRACTOR SHALL BE RESPONSIBLE FOR OBTAINING ALL NECESSARY PERMITS FROM THE MISSISSIPPI DEPARTMENT OF TRANSPORTATION AND CONSTRUCTION (MDOT&C) AND THE MISSISSIPPI DEPARTMENT OF REVENUE AND TAXATION (MDRT) PRIOR TO THE START OF CONSTRUCTION.
20. THE CONTRACTOR SHALL MAINTAIN ACCESS TO ALL ADJACENT PROPERTIES AND PUBLIC ROADS AT ALL TIMES.

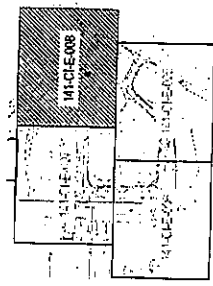

KEY PLAN
SCALE 1"=100'

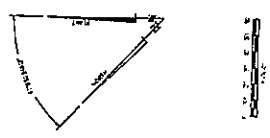

REV.	DATE	REVISION DESCRIPTION
0	08/24	ISSUED FOR CONSTRUCTION
A	11/23	ISSUED FOR APPROVAL
B		
C		
D		
E		
F		
G		
H		
I		
J		
K		
L		
M		
N		
O		
P		
Q		
R		
S		
T		
U		
V		
W		
X		
Y		
Z		

GP
Georgia-Pacific
Monticello LLC

CONSULTANT:	WOOD GROUP USA, INC.
SCALE: AS SHOWN	DATE: 11/02/2023
DRAWN BY:	CHECKED BY:
APPROVED BY:	APPROVED BY:
PAPER ORG. NO.:	CAD FILENAME:
TITLE:	141-CI-E-008.dwg
INITIALS:	NEW JOBLINE
PROJECT NO.:	AND ROUGH GRADING PLAN SHEET 4
DRAWING NO.:	141-CI-E-008
REV.:	0

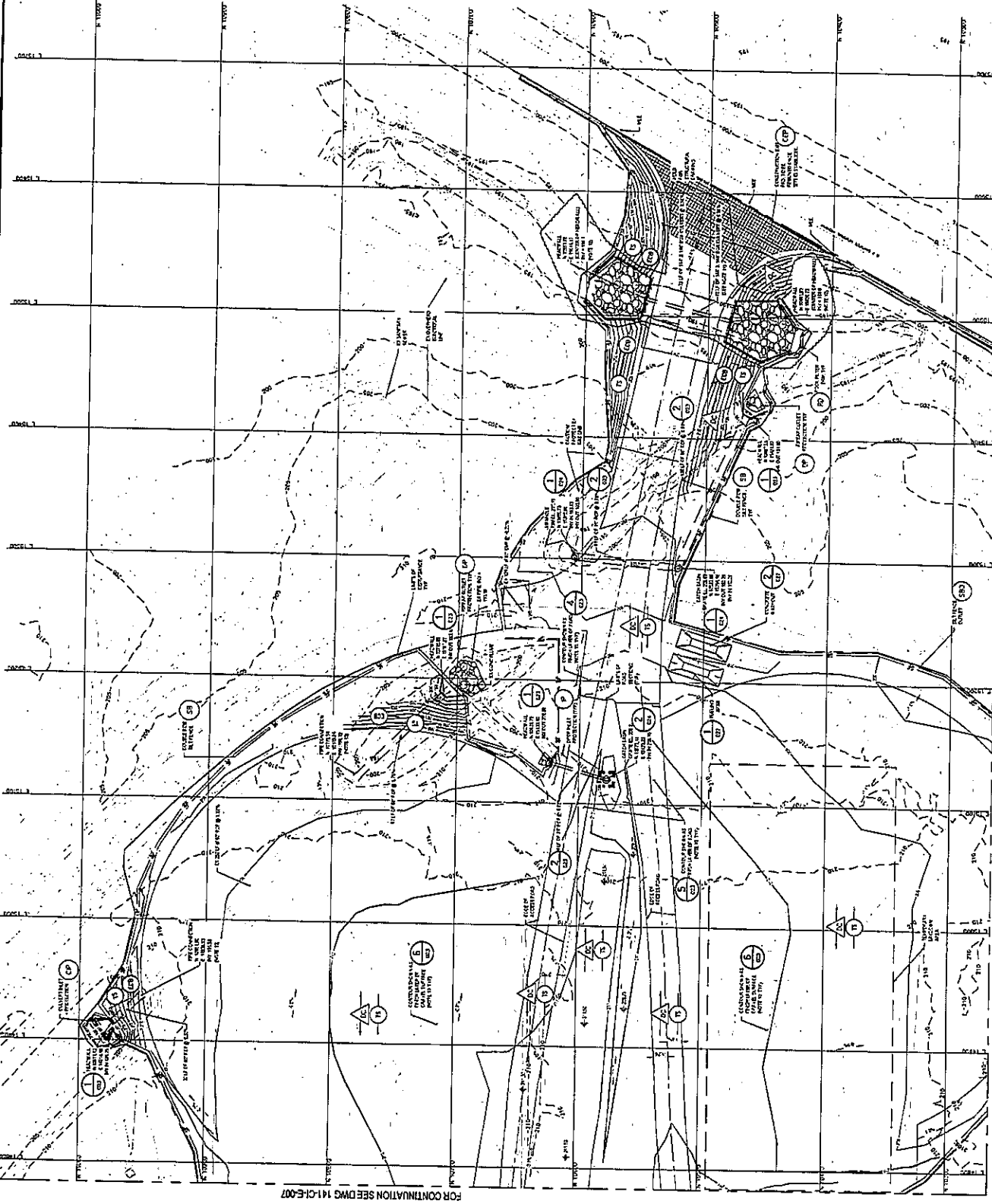

WORK SAFELY



FOR CONTINUATION SEE DWG 141-CI-E-005

ALL REQUIRED PERMITS FOR THE SITE SHALL BE IN PLACE PRIOR TO THE START OF CONSTRUCTION. THE CONTRACTOR SHALL MAINTAIN ACCESS TO ALL ADJACENT PROPERTIES AND PUBLIC ROADS AT ALL TIMES. THE CONTRACTOR SHALL BE RESPONSIBLE FOR OBTAINING ALL NECESSARY PERMITS FROM THE MISSISSIPPI DEPARTMENT OF TRANSPORTATION AND CONSTRUCTION (MDOT&C) AND THE MISSISSIPPI DEPARTMENT OF REVENUE AND TAXATION (MDRT) PRIOR TO THE START OF CONSTRUCTION.

FOR CONTINUATION SEE DWG 141-CI-E-007

NOTES:

1. IN GENERAL, WITH THE EXCEPTED AREAS, THE CONTRACTOR SHALL MAINTAIN EXISTING UTILITIES AND STRUCTURES AS SHOWN ON THIS PLAN.
2. THE CONTRACTOR SHALL BE RESPONSIBLE FOR OBTAINING ALL NECESSARY PERMITS AND APPROVALS FROM THE APPROPRIATE AGENCIES.
3. THE CONTRACTOR SHALL BE RESPONSIBLE FOR OBTAINING ALL NECESSARY PERMITS AND APPROVALS FROM THE APPROPRIATE AGENCIES.
4. THE CONTRACTOR SHALL BE RESPONSIBLE FOR OBTAINING ALL NECESSARY PERMITS AND APPROVALS FROM THE APPROPRIATE AGENCIES.
5. THE CONTRACTOR SHALL BE RESPONSIBLE FOR OBTAINING ALL NECESSARY PERMITS AND APPROVALS FROM THE APPROPRIATE AGENCIES.
6. THE CONTRACTOR SHALL BE RESPONSIBLE FOR OBTAINING ALL NECESSARY PERMITS AND APPROVALS FROM THE APPROPRIATE AGENCIES.
7. THE CONTRACTOR SHALL BE RESPONSIBLE FOR OBTAINING ALL NECESSARY PERMITS AND APPROVALS FROM THE APPROPRIATE AGENCIES.
8. THE CONTRACTOR SHALL BE RESPONSIBLE FOR OBTAINING ALL NECESSARY PERMITS AND APPROVALS FROM THE APPROPRIATE AGENCIES.
9. THE CONTRACTOR SHALL BE RESPONSIBLE FOR OBTAINING ALL NECESSARY PERMITS AND APPROVALS FROM THE APPROPRIATE AGENCIES.
10. THE CONTRACTOR SHALL BE RESPONSIBLE FOR OBTAINING ALL NECESSARY PERMITS AND APPROVALS FROM THE APPROPRIATE AGENCIES.

141-CH-002

KEY PLAN
DATE: 11/24/24

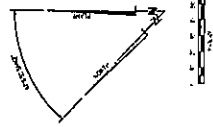

CONSTANT:	NOOR GROUP USA, INC.
SCALE: AS SHOWN	DATE: 11/20/23
DRAWN BY:	CHECKED BY:
DESIGNED BY:	APPROVED BY:
FILED BY:	DATE: 11/24/24
TITLE:	NEW LOGSITE
	INITIAL EROSION AND SEDIMENT CONTROL
	TEMPORARY LAYOUT AREA
DRAWING NO.:	141-CI-B-022
REV.:	0

REV.	DATE	REVISION DESCRIPTION
0	01/24	ISSUED FOR CONSTRUCTION
1		
2		
3		
4		
5		
6		
7		
8		
9		
10		

WORK SAFELY

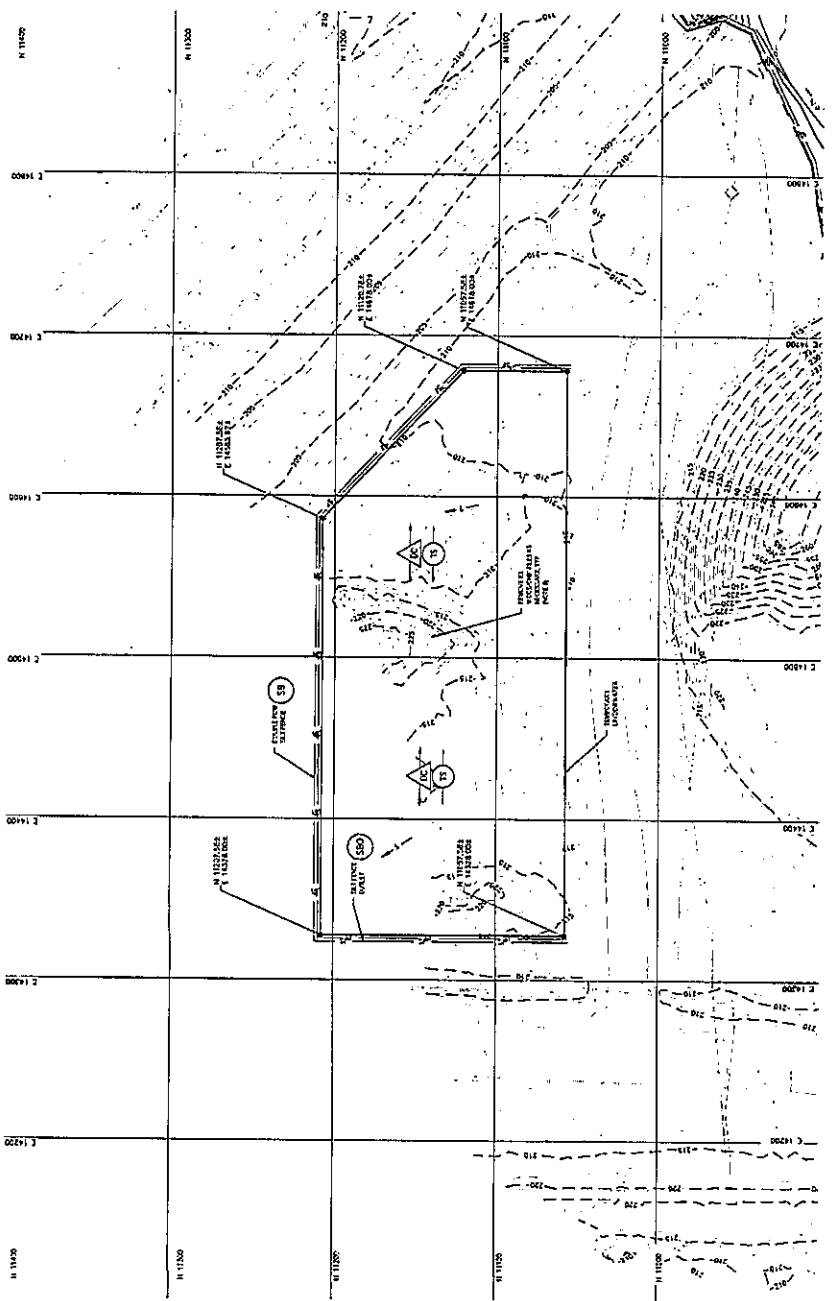

ALL REQUIRED PERMITS FOR THE SITE SHALL BE IN PLACE PRIOR TO THE START OF CONSTRUCTION. THE CONTRACTOR SHALL BE RESPONSIBLE FOR OBTAINING ALL NECESSARY PERMITS AND APPROVALS FROM THE APPROPRIATE AGENCIES. THE CONTRACTOR SHALL BE RESPONSIBLE FOR OBTAINING ALL NECESSARY PERMITS AND APPROVALS FROM THE APPROPRIATE AGENCIES. THE CONTRACTOR SHALL BE RESPONSIBLE FOR OBTAINING ALL NECESSARY PERMITS AND APPROVALS FROM THE APPROPRIATE AGENCIES.

DRAWING NO. 141-CI-B-022

REV. 0

NOTES:
1. IN CONSULT WITH THE DESIGNER, THE CONTRACTOR SHALL VERIFY THE

ALL DIMENSIONS SHOWN IN UNITS OF INCHES UNLESS OTHERWISE NOTED.
DIMENSIONS IN PARENTHESES ARE FOR INFORMATION ONLY.
THE CONTRACTOR SHALL VERIFY ALL DIMENSIONS AND MATERIAL QUANTITIES IN THE FIELD.

1	2	3	4	5	6	7	8	9	10
11	12	13	14	15	16	17	18	19	20
21	22	23	24	25	26	27	28	29	30
31	32	33	34	35	36	37	38	39	40
41	42	43	44	45	46	47	48	49	50
51	52	53	54	55	56	57	58	59	60
61	62	63	64	65	66	67	68	69	70
71	72	73	74	75	76	77	78	79	80
81	82	83	84	85	86	87	88	89	90
91	92	93	94	95	96	97	98	99	100

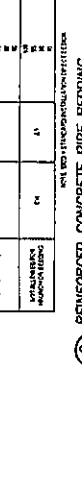
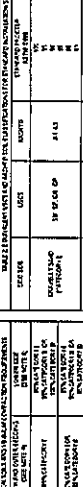
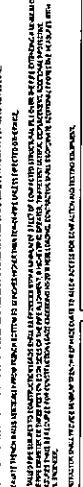
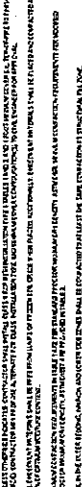
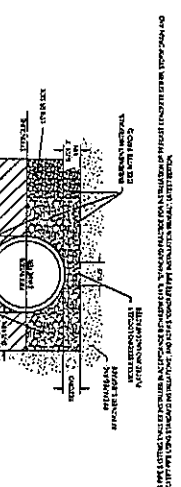
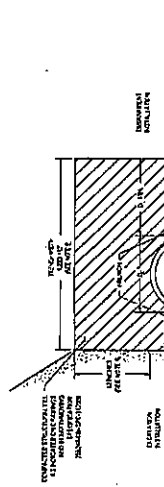
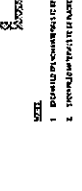
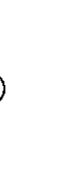
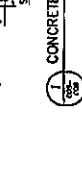
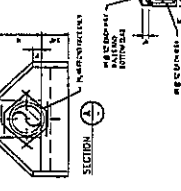
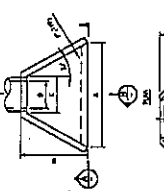

1	2	3	4	5	6	7	8	9	10
11	12	13	14	15	16	17	18	19	20
21	22	23	24	25	26	27	28	29	30
31	32	33	34	35	36	37	38	39	40
41	42	43	44	45	46	47	48	49	50
51	52	53	54	55	56	57	58	59	60
61	62	63	64	65	66	67	68	69	70
71	72	73	74	75	76	77	78	79	80
81	82	83	84	85	86	87	88	89	90
91	92	93	94	95	96	97	98	99	100

1	2	3	4	5	6	7	8	9	10
11	12	13	14	15	16	17	18	19	20
21	22	23	24	25	26	27	28	29	30
31	32	33	34	35	36	37	38	39	40
41	42	43	44	45	46	47	48	49	50
51	52	53	54	55	56	57	58	59	60
61	62	63	64	65	66	67	68	69	70
71	72	73	74	75	76	77	78	79	80
81	82	83	84	85	86	87	88	89	90
91	92	93	94	95	96	97	98	99	100

1	2	3	4	5	6	7	8	9	10
11	12	13	14	15	16	17	18	19	20
21	22	23	24	25	26	27	28	29	30
31	32	33	34	35	36	37	38	39	40
41	42	43	44	45	46	47	48	49	50
51	52	53	54	55	56	57	58	59	60
61	62	63	64	65	66	67	68	69	70
71	72	73	74	75	76	77	78	79	80
81	82	83	84	85	86	87	88	89	90
91	92	93	94	95	96	97	98	99	100

1	2	3	4	5	6	7	8	9	10
11	12	13	14	15	16	17	18	19	20
21	22	23	24	25	26	27	28	29	30
31	32	33	34	35	36	37	38	39	40
41	42	43	44	45	46	47	48	49	50
51	52	53	54	55	56	57	58	59	60
61	62	63	64	65	66	67	68	69	70
71	72	73	74	75	76	77	78	79	80
81	82	83	84	85	86	87	88	89	90
91	92	93	94	95	96	97	98	99	100

1	2	3	4	5	6	7	8	9	10
11	12	13	14	15	16	17	18	19	20
21	22	23	24	25	26	27	28	29	30
31	32	33	34	35	36	37	38	39	40
41	42	43	44	45	46	47	48	49	50
51	52	53	54	55	56	57	58	59	60
61	62	63	64	65	66	67	68	69	70
71	72	73	74	75	76	77	78	79	80
81	82	83	84	85	86	87	88	89	90
91	92	93	94	95	96	97	98	99	100

1	2	3	4	5	6	7	8	9	10
11	12	13	14	15	16	17	18	19	20
21	22	23	24	25	26	27	28	29	30
31	32	33	34	35	36	37	38	39	40
41	42	43	44	45	46	47	48	49	50
51	52	53	54	55	56	57	58	59	60
61	62	63	64	65	66	67	68	69	70
71	72	73	74	75	76	77	78	79	80
81	82	83	84	85	86	87	88	89	90
91	92	93	94	95	96	97	98	99	100

1	2	3	4	5	6	7	8	9	10
11	12	13	14	15	16	17	18	19	20
21	22	23	24	25	26	27	28	29	30
31	32	33	34	35	36	37	38	39	40
41	42	43	44	45	46	47	48	49	50
51	52	53	54	55	56	57	58	59	60
61	62	63	64	65	66	67	68	69	70
71	72	73	74	75	76	77	78	79	80
81	82	83	84	85	86	87	88	89	90
91	92	93	94	95	96	97	98	99	100

1	2	3	4	5	6	7	8	9	10
11	12	13	14	15	16	17	18	19	20
21	22	23	24	25	26	27	28	29	30
31	32	33	34	35	36	37	38	39	40
41	42	43	44	45	46	47	48	49	50
51	52	53	54	55	56	57	58	59	60
61	62	63	64	65	66	67	68	69	70
71	72	73	74	75	76	77	78	79	80
81	82	83	84	85	86	87	88	89	90
91	92	93	94	95	96	97	98	99	100

1	2	3	4	5	6	7	8	9	10
11	12	13	14	15	16	17	18	19	20
21	22	23	24	25	26	27	28	29	30
31	32	33	34	35	36	37	38	39	40
41	42	43	44	45	46	47	48	49	50
51	52	53	54	55	56	57	58	59	60
61	62	63	64	65	66	67	68	69	70
71	72	73	74	75	76	77	78	79	80
81	82	83	84	85	86	87	88	89	90
91	92	93	94	95	96	97	98	99	100

CONSULTANT: MDC GROUP USA, INC.
 SCALE AS NOTED DATE 11/20/2023
 DRAWN BY: CS
 CHECKED BY: JG
 PROJECT NO.: 141-CJ-E-023
 TITLE: NEW LOGJUM
 GRADING AND DRAINAGE DETAIL SHEET 1
 DRAWING NO.: 141-CJ-E-023
 REV: 0

Georgia-Pacific
 Monticello LLC

WORK SAFELY

1 ROAD SECTION 1 (EARLY EARTHWORK)
 ITS

2 ROAD SECTION 2 (EARLY EARTHWORK)
 ITS

3 ROAD SECTION 3 (EARLY EARTHWORK)
 ITS

4 REINFORCED CONCRETE PIPE BEDDING
 ITS

5 SHELL

6 TRENCH PROTECTION
 ITS

7 CONCRETE HEADWALL
 ITS

8 AGGREGATE SURFACING SECTION 3 (EARLY EARTHWORK)
 ITS

9 SHELL

10 REINFORCED CONCRETE PIPE BEDDING
 ITS

11 SHELL

Appendix C – Construction General Permit



State of Mississippi
Mississippi Department of Environmental Quality (MDEQ)



LARGE CONSTRUCTION GENERAL PERMIT

FOR LAND DISTURBING ACTIVITIES OF FIVE (5) OR MORE ACRES

THIS CERTIFIES THAT

PROJECTS ISSUED A CERTIFICATE OF COVERAGE UNDER THIS PERMIT ARE GRANTED PERMISSION TO DISCHARGE STORM WATER FROM REGULATED CONSTRUCTION ACTIVITIES INTO STATE WATERS

in accordance with effluent limitations, inspection requirements and other conditions set forth in herein. This permit is issued in accordance with the provisions of the Mississippi Water Pollution Control Law (Section 49-17-1 et seq., Mississippi Code of 1972), and the regulations and standards adopted and promulgated thereunder, and under authority granted pursuant to Section 402(b) of the Federal Water Pollution Control Act.

Mississippi Environmental Quality Permit Board

Kristal Rudolph
Authorized Signature

Mississippi Department of Environmental Quality

Issued: February 4, 2022

Permit No. MSR10

Expires: January 31, 2027

AJ# 24066

Large Construction Storm Water General Permit

THIS PAGE WAS INTENTIONALLY LEFT BLANK

Large Construction Storm Water General Permit
Table of Contents

ACT1 (Large Construction) Introduction: Narrative Requirements Introduction.....	1
ACT2 (Large Construction) Permit Applicability and Coverage: Narrative Requirements Permit Area.....	2
Eligibility.....	2
Allowable Non-Storm Water Discharges.....	2
Prohibited Non-Storm Water Discharges.....	3
This Permit Does Not Authorize (storm water discharges not eligible for coverage)	4
ACT3 (Large Construction) Obtaining Coverage: Submittal/Action Requirements Obtaining Authorization	5
Requiring an Individual Permit or Alternative General Permit.....	6
How to Obtain Recoverage Under the Reissued Permit.....	6
Commercial Development-Individual Lots and Parcels.....	7
Residential Subdivision-Individual Lots.....	7
Residential Subdivision-Expansions.....	7
Residential Subdivision-New Phases and New Owner	8
Applicability of Requirements for Individual Lots and Parcels in a Larger Common Plan of Development or Sale.....	8
ACT4 (Large Construction) Notice of Intent (LCNOI): Submittal/Action Requirements Notification Requirements.....	9
Required Submittals with the LCNOI.....	9
Additional Required Submittals May Include.....	9
Additional Notification	9
Modification Notification	10
Major Modification Notification.....	10
Narrative Requirements Where to Obtain LCNOI Forms.....	11
Where to Submit the LCNOI	11
Failure to Notify.....	11
ACT5 (Large Construction) Storm Water Pollution Prevention Plan (SWPPP) Requirements and Content: Narrative Requirements SWPPP Development	12
SWPPP Content.....	12
Erosion and Sediment Controls and Soil Stabilization Requirements.....	12
Vegetative Practices.....	14
Structural Practices.....	15
Discharge into an Impaired Receiving Water	16
Description of Post Control Measures	16
Responsible Parties for Larger Common Plan of Development or Sale.....	16

Large Construction Storm Water General Permit
Table of Contents

Housekeeping Practices	17
Construction Deviating Activities.....	18
Flocculant Application.....	19
Sealed Site Map	20
Implementation Sequence	20
Implementation of Controls	21
Maintenance and Weekly Inspections.....	21
Non-Storm Water Discharge Management.....	21
Final Stabilization.....	21
Example SWPPPs	22
Training Requirements	22
ACT6 (Large Construction) Implementation and Inspection Requirements: Submittal/Action Requirements	
Implementation Requirements	24
Compliance with Local Storm Water Ordinances.....	25
Inspection Requirements.....	26
ACT7 (Large Construction) Storm Water Limitation Requirements: Limitation Requirements	
Non-Numeric Limitation Requirements.....	27
ACT8 (Large Construction) Application of Flocculants: Narrative Requirements	
Narrative Requirements	28
ACT9 (Large Construction) Record Keeping and Reporting Requirements: Record Keeping Requirements	
Retention of Records.....	29
Submittal/Action Requirements	29
Suspension of Weekly Inspections and Monthly Record Keeping	30
ACT10 (Large Construction) Termination of Permit Coverage: Submittal/Action Requirements	
Submittal/Action Requirements	31
ACT11 (Large Construction) Standard Requirements Applicable To All Water Permits Narrative Requirements	
Duty to Comply	32
Duty to Mitigate.....	32
Duty to Provide Information	32
Property Rights	32
Severability	32
Oil and Hazardous Substance Liability.....	32
Signatory Requirements.....	33
Duty Authorized Representative.....	34
Changes to Authorization.....	34
Certification	34

Large Construction Storm Water General Permit

Proper Operation and Maintenance..... 35

Table of Contents

Monitoring and Records 35
Bypass Prohibition..... 36
Upset Conditions..... 36
Inspection and Entry 37
Permit Actions 37
Noncompliance Reporting 38
Reopener Clause 38
Permit Modification 38
Transfers 38
Continuation of Expired General Permit..... 39
Falsifying Reports..... 39
Civil and Criminal Liability 39

ACT12 (Large Construction) Definitions:..... 40

Large Construction Storm Water General Permit

THIS PAGE WAS INTENTIONALLY LEFT BLANK

Large Construction Storm Water General Permit

ACT1 (LCGP) Introduction:

Narrative Requirements:

Condition No.	Condition
T-1	The Large Construction General Permit (LCGP) authorizes storm water discharges from construction activities five (5) acres or greater or less than five (5) acres if part of a "larger common plan of development or sale" (see Definitions). Storm water discharges that enter waters of the State or storm water conveyance systems leading to waters of the State are subject to regulation and compliance with the conditions set forth in this permit. This permit also authorizes storm water discharges from any other construction activity designated by the Executive Director based on the potential for contribution to an excursion of a water quality standard or for significant contribution of pollutants to waters of the State. This permit replaces the previous Large Construction General Permit that expired on December 31, 2021. [11 Miss. Admin. Code Pt. 6, R. 1]

ACT2 (LCGP) Permit Applicability and Coverage:

Narrative Requirements:

Condition No.	Condition
T-1	<p>PERMIT AREA:</p> <p>The Large Construction General Permit covers all areas of the State of Mississippi. [11 Miss. Admin. Code Pt. 6, R. 1]</p>
T-2	<p>ELIGIBILITY:</p> <p>(1) Discharges composed entirely of storm water and allowable non-storm water discharges (see ACT5, T-14 for additional requirements) from construction activity, including clearing, grading, grubbing, excavating and other land disturbing activities of five (5) or more acres or less than five (5) acres if part of a "larger common plan of development or sale" (see Definitions).</p> <p>(2) Allowable Non-Storm Water Discharges:</p> <p>(A) Discharges from actual fire-fighting activities (B) Fire hydrant flushing (C) Water used to control dust (D) Potable water sources including uncontaminated water line flushing (E) Routine external building wash down that does not use detergents (F) Pavement wash waters where spills or leaks of toxic or hazardous materials have not occurred (unless all spilled material has been removed) and where detergents are not used (G) Uncontaminated air conditioning or compressor condensate (H) Uncontaminated ground water or spring water (I) Foundation or footing drains where flows are not contaminated with process materials such as solvents (J) Landscape irrigation (K) Water used to wash vehicles, wheel wash water and other wash waters where detergents are not used. (L) Construction dewatering water discharged in accordance with ACT5, T-11. [11 Miss. Admin. Code Pt. 6, R. 1]</p>

ACT2 (continued):

Narrative Requirements:

Condition No.	Condition
---------------	-----------

T-3 ELIGIBILITY (continued):

(3) Prohibited Non-Storm Water Discharges:

- (A) Wastewater from washout of concrete (unless managed by an appropriate control)
- (B) Wastewater from washout and cleanout of stucco, paint, form release oils, curing compounds and other construction materials
- (C) Fuels, oils, or other pollutants used in vehicle and equipment operation and maintenance
- (D) Soaps or solvents used in vehicle and equipment washing
- (E) Wastewater from sanitary facilities, including portable toilets
- (F) Contaminated discharge waters from dewatering activities
- (G) Toxic or hazardous substances from a spill or other release.

(4) A project is eligible for coverage under this general permit for discharges of pollutants of concern to water bodies for which there is a Total Maximum Daily Load (TMDL) established or approved by the Environmental Protection Agency (EPA) if measures and controls are incorporated that are consistent with the assumptions and requirements of such TMDL. To be eligible for coverage under this general permit, the project must incorporate in the Storm Water Pollution Prevention Plan (SWPPP) and/or effluent limitation any conditions applicable to any discharge(s) necessary for consistency with the assumptions and requirements of such TMDL. If, after coverage issuance, a specific wasteload allocation is established that would apply to the project's discharge, the project owner/operator must determine and implement all of the steps necessary to meet that allocation within three (3) months from the final TMDL approval date. MDEQ's approved TMDL list may be found at the link listed in paragraph (5) below. In addition, MDEQ's Planning & Design Manual for the Control of Erosion, Sediment and Storm Water identifies specific controls that may be used to address consistency with any applicable TMDLs. The manual can be found at: www.indeq.ms.gov/construction-stormwater/

(5) A project is eligible for coverage under this general permit for discharges of storm water to impaired water bodies on MDEQ's 303(d) list, provided best management practices (BMPs) are employed that prohibit further impairment of the designated and/or existing beneficial uses in the receiving water body. To be eligible for coverage under this general permit, the owner/operator must indicate on the LCNOL that the project discharges to a 303(d) listed receiving water and incorporate appropriate BMPs in its SWPPP. MDEQ's 303(d) list of impaired water bodies may be found on MDEQ's website at: <https://opcgis.deq.state.ms.us/tmdlsl/>. [1] Miss. Admin. Code Pt. 6, R. 1]

ACT2 (continued):

Narrative Requirements:

Condition No.	Condition
---------------	-----------

T-4 THIS PERMIT DOES NOT AUTHORIZE:

(1) Discharges which result in violation of State Water Quality Standards. Whenever a discharge authorized under this permit is later determined to cause or have the reasonable potential to cause or contribute to the violation of an applicable water quality standard, MDEQ will notify the regulated entity of such water quality violation(s) in writing and will provide the information used by MDEQ to make this determination. The regulated entity must take all necessary actions required to ensure future discharges do not cause or contribute to the violation of a water quality standard. If such violations remain or re-occur, then additional measures, such as the addition of Best Management Practices (BMPs) and modification of the SWPPP will be submitted to MDEQ for approval or the requirement to obtain an individual permit, may be required by the Permit Board. Compliance with this requirement does not preclude any enforcement activity as provided by the Clean Water Act for the underlying violation.

(2) Activities that affect waters of the U.S., including wetlands, without obtaining the necessary U.S. Army Corps of Engineers (COE) approval. This may include a COE individual Section 404 permit or coverage under a COE nationwide or general permit. Appropriate documentation must be submitted with the Large Construction Notice of Intent (LCNOI). [11 Miss. Admin. Code Pt. 6, R. 1]

T-5

(3) Discharges or discharge-related activities that are likely to jeopardize the continued existence of any species that is listed as endangered or threatened under the Endangered Species Act (ESA) or result in the adverse modification or destruction of habitat that is designated as critical under the ESA. Coverage under this permit is available only if the regulated entity's storm water discharges, allowable non-storm water discharges, and discharge-related activities are not likely to jeopardize the continued existence of any species that is listed as endangered or threatened ("listed") under the ESA or result in the adverse modification or destruction of habitat that is designated as critical under the ESA ("critical habitat"). Submission of a signed LCNOI, or County Utility Authority approval, if applicable, will be deemed to constitute the regulated entity's certification of eligibility. [11 Miss. Admin. Code Pt. 6, R. 1]

ACT3 (LCGP) Obtaining Coverage:

Submittal/Action Requirements:

Condition No.	Condition
---------------	-----------

S-1	OBTAINING AUTHORIZATION:
-----	--------------------------

(1) Owners and/or operators (see Definitions) desiring coverage associated with large construction activity under this permit must submit a Large Construction Notice of Intent (LCNOI) and other required submittals in accordance with the requirements of this permit. For construction activities, the operator is typically the Prime Contractor. However, if the prime contractor does not meet the definition of operator, then the owner must apply. The owner may submit the LCNOI and later, prior to actual construction, the operator may submit the Prime Contractor Certification accepting joint and severable responsibility for applicable permit conditions.

Where there are multiple operators associated with the same project, all operators must obtain permit coverage. Subcontractors generally are not considered operators for the purposes of this permit. The applicant shall identify the construction support activities for their project in the SWPPP. If the operator of a construction support activity is different than the operator of the main site, that operator must abide by the approved SWPPP. If a SWPPP was prepared under a previous version of this permit, the operator must review and update the SWPPP to ensure that this permit's requirements are addressed prior to submitting separate approved MDEQ authorization forms for coverage under this permit. Unless receiving prior MDEQ approval, projects with multiply operators shall submit a group SWPPP covering all aspects of construction activities in accordance to ACT5 of this permit. Regardless of whether there is a group SWPPP or multiple individual SWPPPs, each operator is responsible for compliance with the permit's terms and conditions.

Owners, developers and prime contractors that meet the definition of the operator shall apply for permit coverage on the same NOI, if possible. The division may accept separate NOI forms from different operators for the same construction site when warranted.

The owner(s) of the property and the operator(s) associated with the regulated construction activity on the property have joint and severable responsibility for compliance with the permit. Notwithstanding any permit condition to the contrary, the coverage recipient and any person who causes pollution of waters of the state or places waste in a location where they are likely to cause pollution, shall remain responsible under applicable federal and state laws and regulations, and applicable permits.

(2) Upon review of the LCNOI, the MDEQ staff may require additional information (including modification of the SWPPP, which could require the implementation

ACT3 (LCGP) Obtaining Coverage:

Submittal/Action Requirements:

Condition No.	Condition
---------------	-----------

of additional controls), recommend that coverage not be granted and/or that an alternate permit would be more appropriate. The MDEQ staff recommendations may be brought before the Mississippi Environmental Quality Permit Board (Permit Board) for review and consideration at a regularly scheduled meeting or at a special meeting at its discretion.

(3) Coverage under this permit will not be granted until all other required MDEQ permits, certifications and approvals are satisfactorily addressed.

(4) Owners or operators are authorized to discharge storm water associated with large construction activity under the terms and conditions of this permit only upon receipt of written notification of approval of coverage by the Permit Board staff. Discharge of storm water without written notification of coverage under this permit or issuance of an individual National Pollutant Discharge Elimination System (NPDES) Storm Water Permit is a violation of the Mississippi Air and Water Pollution Control Law 49-17-29(2)(b). [11 Miss. Admin. Code Pt. 6, R. 1]

S-2 REQUIRING AN INDIVIDUAL PERMIT OR ALTERNATIVE GENERAL PERMIT:

(1) The Permit Board may require any coverage recipient to apply for and obtain either an individual or an alternative general NPDES permit. Any interested person may petition the Permit Board to take action under this paragraph. The Permit Board may require any coverage recipient to apply for an individual NPDES permit only if the owner or operator has been notified in writing. Such notice shall include reasons for this decision, an application form and a filing deadline. The Permit Board may grant additional time at its discretion, upon request. If a coverage recipient fails to submit a requested application in a timely manner, coverage under this permit will automatically terminate at the end of the day specified for application submittal.

(2) Any coverage recipient may request to be excluded from permit coverage by applying for an individual permit or coverage under another general permit. The applicant shall submit an individual application (EPA Forms 1 and 2F along with the narrative requirements of 40 CFR 122.26(c)(1)(ii)) or the appropriate Notice of Intent.

(3) Coverage under this permit is automatically terminated on the issuance date of the respective alternative individual permit or general permit coverage. When the request for an alternative individual permit or general permit coverage is denied, coverage under this permit continues unless terminated by the Permit Board. [11 Miss. Admin. Code Pt. 6, R. 1]

S-3 HOW TO OBTAIN RECOVERY UNDER THE REISSUED PERMIT:

If reissuance of this permit does not occur before its expiration date, continued coverage under this permit will be allowed until the effective date of the reissued general permit coverage. Once the Large Construction General Permit is reissued, active coverage recipients will receive a Recovery Form with a Letter of Instruction. If a coverage recipient wishes to be covered by the reissued Large Construction General Permit, the Recovery Form must be completed and returned to the MDEQ in accordance with the provisions of the Letter of Instruction. Resubmittal of the Storm Water Pollution Prevention Plan (SWPPP) is not required if

ACT3 (LCGP) Obtaining Coverage:

Submittal/Action Requirements:

Condition No.	Condition
---------------	-----------

the SWPPP is on-site or locally available, current and adequately addresses the sources of pollution at the facility. Some SWPPP's may require amendment to meet the conditions of the reissued general permit (e.g., deadline for initiating vegetative stabilization measures). [11 Miss. Admin. Code Pt. 6, R. 1]

S-4 COMMERCIAL DEVELOPMENT - INDIVIDUAL LOTS OR PARCELS:

Individual lots or parcels within a commercial development that are part of the "larger common plan of development or sale" (see Definitions) are regulated regardless of size or owner. If the owner or developer obtains construction permit coverage for a development then sells lots or parcels within that development, permit coverage must continue on those areas under new ownership. The original coverage recipient is responsible for all construction activities until individual lots or parcels within the development are sold to others and the new owner submits a LCN01 (regardless of size) and obtains coverage under Mississippi's Large Construction General Permit or applies for an individual permit. [11 Miss. Admin. Code Pt. 6, R. 1]

S-5 RESIDENTIAL SUBDIVISION - INDIVIDUAL LOTS:

Individual lots within a residential subdivision that are part of the "larger common plan of development or sale" (see Definitions) are regulated regardless of size or ownership. If the owner or developer obtains construction permit coverage for a residential development, then sells individual lots within that development, permit coverage shall continue on those lots under new ownership. The original coverage recipient may retain responsibility for permit compliance, or the new owner (purchaser) or operator shall satisfy authorization requirements by:

- (1) Completing and submitting the MDEQ Registration Form (see Large Construction Forms Package) and developing and implementing a sediment and erosion control plan for the specific lot(s), or
- (2) Completing and submitting for approval from the MDEQ, a LCN01 and required documents, or
- (3) Applying for an individual storm water permit.

The owner or developer (seller) is responsible for providing the new owner or operator (purchaser) with a copy of the MDEQ Registration Form and a copy of the Large Construction General Permit. These documents, as well as the individual application, may be found on MDEQ's website at www.mdeq.ms.gov/construction-stormwater/ or by calling 601-961-5171. [11 Miss. Admin. Code Pt. 6, R. 1]

S-6 RESIDENTIAL SUBDIVISION - EXPANSIONS:

For subsequent phases, expansions and major modifications of subdivision development that are proposed but were not included in the original SWPPP, the

ACT3 (continued):

Submittal/Action Requirements:

Condition No.	Condition
---------------	-----------

S-7 coverage recipient shall submit to MDEQ the Major Modification Form (see Large Construction Forms Package). [11 Miss. Admin. Code Pt. 6, R. 1]

S-7 RESIDENTIAL SUBDIVISION - NEW PHASES AND NEW OWNER:

If an individual, other than the original developer (coverage recipient), proposes construction of a new phase of an existing subdivision and the proposed phase was not included in the initial submittal of the LCN01, the new owner or operator must apply for separate permit coverage. [11 Miss. Admin. Code Pt. 6, R. 1]

S-8 APPLICABILITY OF REQUIREMENTS FOR INDIVIDUAL LOTS AND PARCELS IN A LARGER COMMON PLAN OF DEVELOPMENT OR SALE:

The original coverage recipient remains responsible for compliance with this general permit until a new owner or operator satisfies the requirements of S-4 and S-5 of this ACT. [11 Miss. Admin. Code Pt. 6, R. 1]

ACT4 (LCGP) Large Construction Notice of Intent (LCNOI):

Submittal/Action Requirements:

Condition No.	Condition
S-1	<p>NOTIFICATION REQUIREMENTS:</p> <p>Persons desiring coverage for a storm water discharge associated with construction activity under this general permit must submit a LCNOI Form with the required submittals. Discharge of storm water without written notification of coverage under this permit or issuance of an individual National Pollutant Discharge Elimination System (NPDES) Storm Water Permit is a violation of the Mississippi Air and Water Pollution Control Law 49-17-29(2)(b). [11 Miss. Admin. Code Pt. 6, R. 1]</p>
S-2	<p>REQUIRED SUBMITTALS WITH THE LCNOI:</p> <p>Submittals required with a completed LCNOI include a site-specific SWPPP associated with the construction activities, a United States Geological Survey (USGS) quad map, or color photocopy of the quad map, extending at least 1/2 mile beyond the facility property boundaries with the site location outlined or highlighted. [11 Miss. Admin. Code Pt. 6, R. 1]</p>
S-3	<p>ADDITIONAL SUBMITTALS MAY INCLUDE THE FOLLOWING:</p> <ol style="list-style-type: none">(1) Appropriate Section 404 documentation from U.S. Army Corps of Engineers,(2) Appropriate documentation concerning future disposal of sanitary sewage and sewage collection system construction,(3) Appropriate documentation from the MDEQ Office of Land & Water concerning dam construction and low flow requirements, and/or(4) Approval for wastewater for all residential and commercial subdivisions in the form of a signed certification by the official responsible for the wastewater treatment facility that will serve the proposed project.(5) Appropriate plans for affecting waters of the State of Mississippi. [11 Miss. Admin. Code Pt. 6, R. 1]
S-4	<p>ADDITIONAL NOTIFICATION:</p>

The covered owner or operator must notify the Permit Board at least 30 days before any planned changes of ownership or whenever there are any changes in

ACT4 (continued):

Submittal/Action Requirements:

Condition No.	Condition
---------------	-----------

information previously submitted in the LCN01 Form. [11 Miss. Admin. Code Pt. 6, R. 1]

S-5 MODIFICATION NOTIFICATION:

The coverage recipient must notify the Permit Board at least 30 days before:

- (1) Any planned changes in project operations that may affect storm water discharges,
- (2) Any planned changes of ownership, or
- (3) Any changes in information previously submitted in the LCN01. [11 Miss. Admin. Code Pt. 6, R. 1]

S-6 MAJOR MODIFICATION NOTIFICATION:

(1) The following activities require the submittal of a Major Modification Form. This form can be found in the Large Construction Forms Package, which can be obtained from MDEQ at the address given in T-2 of this ACT or from the MDEQ website at www.mdeg.ms.gov/construction-stormwater/.

(A) SWPPP details have been developed and are ready for MDEQ review for subsequent phases of an existing, covered project.

(B) Footprint identified in the original LCN01 is proposed to be enlarged (a modified SWPPP and an updated USGS topographic map must be submitted with the Major Modification Form).

(2) Coverage recipients are authorized to implement the proposed modifications, under the conditions of the General Permit, only upon receipt of written notification of approval by the MDEQ.

(3) Proposed changes may require termination of the General Permit coverage and/or application for an individual or alternative general permit. [11 Miss. Admin. Code Pt. 6, R. 1]

ACT4 (continued):

Narrative Requirements:

Condition No.	Condition
T-1	<p>WHERE TO OBTAIN LCNOI FORMS:</p> <p>LCNOI Forms may be obtained from the MDEQ at the address shown below or by calling 601-961-5171. LCNOI Forms, as well as the general permit and guidance manual, may be found on the MDEQ web site at www.mdeq.ms.gov/construction-stormwater/. Coverage under this permit will not be granted until all other required MDEQ permits, certifications and approvals are satisfactorily addressed. [11 Miss. Admin. Code Pt. 6, R. 1]</p>
T-2	<p>WHERE TO SUBMIT THE LCNOI:</p> <p>Complete and appropriately signed LCNOI Forms must be submitted to:</p> <p>Chief, Environmental Permits Division Mississippi Department of Environmental Quality Office of Pollution Control P.O. Box 2261 Jackson, Mississippi 39225</p> <p>For priority or overnight deliveries, the physical address is:</p> <p>515 East Amite Street Jackson, Mississippi 39201.</p> <p>In addition to mailing paper, electronic submittals are also recommended. Until December 21, 2025, a courtesy copy may be submitted electronically by: https://www.mdeq.ms.gov/construction-stormwater/. After December 21, 2025, these forms shall be submitted electronically using the above web address. [11 Miss. Admin. Code Pt. 6, R. 1]</p>
T-3	<p>FAILURE TO NOTIFY:</p> <p>Persons who discharge storm water associated with Large Construction activity to waters of the State without an NPDES permit are in violation of the Mississippi Air and Water Pollution Control Law 49-17-29(2)(b). [11 Miss. Admin. Code Pt. 6, R. 1]</p>

ACT5 (LCGP) Storm Water Pollution Prevention Plan (SWPPP):

Narrative Requirements:

Condition No.	Condition
T-1	SWPPP DEVELOPMENT:

A site-specific SWPPP shall be developed requiring the design, installation, implementation and maintenance of effective pollution prevention measures by each owner or operator subject to this permit. A SWPPP shall be prepared in accordance with sound engineering practices and shall identify potential sources of pollution, which may reasonably be expected to affect the quality of storm water discharges associated with construction activity. The SWPPP shall describe and ensure the implementation of specific best management practices for the project site, which will reduce pollutants in storm water discharges and assure compliance with the terms and conditions of this permit. [11 Miss. Admin. Code Pt. 6, R. 1]

T-2 SWPPP CONTENT:

Erosion and Sediment Controls and Soil Stabilization Requirements:

The SWPPP shall list and describe site-specific controls appropriate for the construction activities as well as the procedures for implementing such controls. Controls shall be designed to retain sediment on-site and to minimize the discharge of pollutants. If any of the below controls cannot be implemented on the project site, the SWPPP must include written justification as to why site-specific constraints and/or costs make the control(s) infeasible. At a minimum, such controls must be designed, installed and maintained to:

- (1) Control storm water volume and velocity within the site to minimize soil erosion;
- (2) Control storm water discharges, including both peak flow rates and total storm water volume, to minimize channel and stream bank erosion and scour in the immediate vicinity of discharge points;
- (3) Minimize the amount of soil exposed during construction activity;
- (4) Minimize the disturbance of steep slopes. [11 Miss. Admin. Code Pt. 6, R. 1]

ACT5 (continued):

Narrative Requirements:

Condition No.	Condition
T-3	<p data-bbox="511 1491 544 1837">SWPPP CONTENT (continued):</p> <p data-bbox="568 199 657 1837">(5) Minimize sediment discharges from the site. The design, installation and maintenance of erosion and sediment controls must address factors such as the amount, frequency, intensity and duration of precipitation, the nature of resulting storm water runoff, and soil characteristics, including the range of soil particle sizes expected to be present on the site;</p> <p data-bbox="682 189 771 1837">(6) Provide and maintain a 50-foot undisturbed natural buffer around waters of the United States; or provide and maintain an undisturbed natural buffer that is less than 50 feet and is supplemented by additional erosion and sediment controls which in combination achieves the sediment load reduction equivalent to a 50-foot undisturbed natural buffer. Direct storm water to vegetated areas and maximize storm water infiltration to reduce pollutant discharges, unless infeasible; and</p> <p data-bbox="795 1123 828 1837">(7) Minimize soil compaction and, unless infeasible, preserve topsoil;</p> <p data-bbox="852 220 917 1837">(8) Direct storm water to vegetated areas, brush barriers, silt fences, check dams, etc. to aid in the filtration, infiltration, velocity reduction and diffusion of the discharge;</p> <p data-bbox="941 1081 974 1837">(9) Transport runoff down steep slopes through lined channels or piping;</p> <p data-bbox="998 1417 1031 1837">(10) Minimize the amount of cut and fill;</p> <p data-bbox="1055 1249 1088 1837">(11) Minimize off-site vehicle tracking of sediments; and</p> <p data-bbox="1112 231 1177 1837">(12) Minimize the discharge of pollutants from equipment and vehicle washing, wheel wash water, concrete wash water, and other wash waters. Wash waters must be treated in a sediment basin or alternative control that provides equivalent or better treatment prior to discharge.</p> <p data-bbox="1201 147 1266 1837">(13) Provide a description of any discharge associated with industrial activity other than construction stormwater that originates on site and the location of that activity and its permit number.</p> <p data-bbox="1291 147 1323 1837">(14) Provide a description of stormwater sources from areas other than construction and a description of controls and measures that will be implemented at those sites.</p>

ACT5 (continued):

Narrative Requirements:

Condition No.	Condition
---------------	-----------

(15) When permanent or temporary structures will be placed in Waters of the State, MDEQ may require the applicant to address any issues related to Mississippi Antidegradation Plan in the SWPPP during the review of the LCNOI rather than requiring a separate LCNOI or other state required permits. This provision will only apply to activities that will not require a 404 permit or a 401 certification. [11 Miss. Admin. Code Pt. 6, R. 1]

T-4 The number and type of BMPs included in the SWPPP must reflect the specific conditions of the construction site. An effective SWPPP includes a combination of BMPs that are designed to work together. A combination of BMPs is listed below and must be included as minimum components of a SWPPP. These controls must be in accordance with the design standards set forth in the most current edition of Mississippi's "Erosion Control, Sediment Control and Stormwater Management on Construction Sites and Urban Areas" found at www.mdeq.ms.gov/construction-stormwater/ or other accredited and approved manual of design.

(1) Vegetative Practices shall be designed to preserve existing vegetation where feasible and initiate vegetative stabilization measures after land disturbing activities. Such practices may include, but not limited to, temporary seeding, permanent seeding, mulching, sod stabilization, vegetative buffer strips, tree protection and topsoil preservation.

Soil stabilization-vegetative stabilization measures must be initiated whenever any clearing, grading, grubbing, excavating or other land disturbing activities have temporarily or permanently ceased on any portion of the site and will not resume for a period of fourteen (14) calendar days or more. The appropriate temporary or permanent vegetative practices shall be initiated immediately. For purposes of this permit, "immediately" is interpreted to mean no later than the next work day.

If you are unable to meet the deadlines in the previous paragraph due to circumstances beyond your control, and you are using vegetative cover for temporary or permanent stabilization, you may comply with the following stabilization deadlines instead:

- (A) Immediately initiate, and within 14 calendar days complete, the installation of temporary non-vegetative stabilization measures to prevent erosion;
- (B) Complete all soil conditioning, seeding, watering or irrigation installation, mulching, and other required activities related to the planting and initial establishment of vegetation as soon as conditions or circumstances allow it on the site; and,

(C) Document the circumstances that prevent you from meeting the deadlines required and the schedule you will follow for initiating and completing stabilization. [11 Miss. Admin. Code Pt. 6, R. 1]

ACT5 (continued):

Narrative Requirements:

Condition No.	Condition
T-5	<p>Specific BMPs that must be included, unless infeasible (see Definitions) are:</p> <p>(A) Buffer zones (see Definitions) shall be maintained between land-disturbing activities and perennial water bodies. A minimum 150-foot buffer zone is recommended; however, if a 150-foot buffer zone cannot be met, the requirements outlined in ACT5, T-3(6) shall be followed.</p> <p>(B) Topsoil should be stockpiled and used in areas that will be re-vegetated. When final grade is reached it should be distributed to a minimum depth of 2 inches on 3:1 slopes and 4 inches on flatter slopes. The permittee shall locate the piles outside of any natural buffers established and away from any stormwater conveyances, drain inlets, and areas where stormwater flow is concentrated. The permittee shall install a sediment barrier along all downgradient perimeter areas. The permittee is prohibited from hosing down or sweeping soil or sediment accumulated on pavement or other impervious surfaces into any stormwater conveyance, storm drain inlet, or Waters of the State.</p> <p>(C) Heavy equipment use in areas to be re-vegetated should be avoided. If compaction cannot be avoided, the top 4 inches of the soil bed should be tilled before re-vegetation. Any necessary fertilizer or other soil amendments should be added during the tilling process.</p>
T-6	<p>The SWPPP must contain written justification as to why any of these specific controls were not deemed feasible. [11 Miss. Admin. Code Pt. 6, R. 1]</p> <p>(2) Structural practices shall divert flows from exposed soils, store flows or otherwise limit runoff from exposed areas. Such practices may include, but are not limited to, construction entrance/exit, silt fences, earth dikes, brush barriers, drainage swales, check dams, subsurface drains, pipe slope drains, level spreaders, drain inlet protection, outlet protection, detention/retention basins, sediment traps, temporary sediment basins or equivalent sediment controls.</p> <p>Specific practices that must be included, unless infeasible, are:</p> <p>Sediment basins are to be situated outside waters of the State and any natural buffers to be established. Design the basin to avoid collecting water from wetlands. Use erosion controls and velocity dissipation devices to prevent erosion at the inlets and outlets.</p> <p>(A) For drainage locations (a drainage point at boundary of land disturbing activity) that serve an area with ten (10) or more disturbed acres at one time, a temporary (or permanent) sediment basin providing at least 3,600 cubic feet (133 cubic yards) of storage per acre drained shall be provided until final stabilization of the site. Sediment basins must be installed before initial site grading and utilize outlet structures that withdraw water from the surface and that are designed for a minimum 2-year, 24-hour storm event. If flocculants are being introduced, sediment basins must be downstream of the point of introduction and include baffles to increase sediment removal efficiency and turbidity reduction. The capacity of the sediment basin, acreage draining to sediment basin, location on the plan, as well as the diagram of outflow structure shall be provided.</p> <p>(B) Due to the unique characteristics of linear projects (see Definitions), such as the lack of space within project rights of way and having multiple, distributed</p>

ACT5 (continued):
Narrative Requirements:

Condition No.	Condition
	<p>discharge points, sedimentation basins are not common practices. Therefore, MDEQ will not require the use of sedimentation basins for linear projects disturbing ten (10) or more acres at one time. Appropriate alternate structural practices, such as sediment traps and check dams, must be included in the SWPPP if sediment basins are deemed infeasible.</p>
(C)	<p>Design of temporary (or permanent) sediment basins, if used, shall provide at least 3600 cubic feet (133 cubic yards) of storage per acre drained and shall be provided until final stabilization of the site. Sediment basins must be installed before major site grading and utilize outlet structures that withdraw water from the surface. The capacity of the sediment basin, acreage draining to sediment basin, acreage draining to sediment basin, location on the plan, as well as the diagram of outflow structure shall be provided. [11 Miss. Admin. Code Pt. 6, R. 1]</p>
T-7	<p>(D) Steep Slopes (see Definition) that cannot be avoided must have, at a minimum, silt fences or equivalent sediment controls for all down slope boundaries (and for those side slope boundaries deemed appropriate by individual site conditions), unless a sediment basin providing storage for a calculated volume of runoff from a 2-year, 24-hour storm or 3,600 cubic feet of storage per acre drained is provided.</p> <p>(E) Construction entrances/exits shall be installed wherever traffic will be leaving a construction site and moving directly onto a paved public road. Restrict vehicle to properly designed exit points. Use appropriate stabilization techniques at all points that exit onto paved roads. Implement additional track-out controls as necessary to ensure that sediment removal occurs prior to vehicle exit. Where sediment has been tracked-out from the site onto paved roads, sidewalks, or other paved areas outside the site, remove deposited sediment "immediately" by the end of the next work day. Remove the track-out by sweeping, shoveling, or vacuuming these surfaces, or by similarly effective means of sediment removal. Hosing or sweeping track-out sediment into any stormwater conveyance, storm drain inlet, of Waters of the State is prohibited.</p> <p>(F) Storm Drain Inlets-Inlets that could receive storm water from construction activities shall be protected by surrounding or covering with a filter material until final stabilization has been achieved. Clean, or remove and replace, the protection measure as sediment accumulates, the filter becomes clogged, and/or performance is compromised. Where there is evidence of sediment accumulation adjacent to inlet protection measure, remove the deposited sediment "immediately" by the end of the next work day. [11 Miss. Admin. Code Pt. 6, R. 1]</p>
T-8	<p>(G) Perimeter Controls-Natural areas shall be maintained and supplemented with silt fence and fiber rolls around project perimeter. If not feasible to maintain natural areas, a silt fence or similar controls, such as fiber rolls, are sufficient.</p> <p>(H) Phasing-Schedule or sequence construction activities to concentrate work in certain areas to minimize the amount of soil that is exposed at one time. Construction shall be phased to keep the total disturbed area less than fifty (50) acres at one time, in order to minimize erosion and limit sedimentation. The permittee can have additional disturbance with provided justification and additional controls to minimize erosion and sedimentation. With written justification of demonstrating why the project requires fifty (50) acres or more of disturbed area and additional controls to minimize erosion and sedimentation, the permittee may be allowed to disturb additional areas.</p>

ACT5 (continued):
Narrative Requirements:

Condition No.	Condition
---------------	-----------

The SWPPP must contain written justification as to why any of these specific controls were not deemed feasible. [11 Miss. Admin. Code Pt. 6, R. 1]

T-9 (3) Facilities discharging into impaired receiving waters (i.e., receiving stream segments, which are listed on MDEQ's 303(d) List of Impaired Waters, or segments for which a Total Daily Maximum Load (TMDL) has been approved) must identify the pollutant of concern(s) for the receiving stream in the SWPPP. If applicable, the SWPPP shall describe how the selected BMPs will ensure that discharges from the site (if applicable) will not cause or contribute to exceedances of the water quality standards in the receiving stream. Additional controls may be required.

(4) A description of any post-construction control measures. Post-construction control measures should be installed as necessary, to control pollutants in storm water after construction is complete. Post-construction controls must be in accordance with the design standards set forth in the most current edition of Mississippi's "Erosion Control, Sediment Control and Stormwater Management on Construction Sites and Urban Areas" found at: www.mdeq.ms.gov/construction-stormwater/. These controls include, but are not limited to, one or more of the following: on-site infiltration of runoff, flow attenuation using open vegetated swales, exfiltration trenches and natural depressions, constructed wetlands and retention/detention structures. Where needed, velocity dissipation devices shall be placed at detention or retention pond outfalls and along the outfall channel to provide for a non-erosive flow. Restrict vehicle and equipment use in these locations to avoid soil compaction. Before seeding or planting areas of exposed soil that have been compacted, use techniques that rehabilitate and condition the soils as necessary to support vegetative growth. The permittee is encouraged to design the site, the erosion prevention measures, sediment control measures, and other site management practices with consideration of minimizing stormwater runoff, both during and following construction, including facilitating the use of low-impact development (LID) and green infrastructure.

(5) Proposed responsible parties (original coverage recipient or new owner or operator) for individual lots or out-parcels that are part of a larger common plan of development or sale. If permit responsibility is retained by the original coverage recipient, a narrative description of sediment and erosion controls for subdivision lots is acceptable. Out-parcels in commercial developments must be included in the scaled site map referenced below. [11 Miss. Admin. Code Pt. 6, R. 1]

T-10 Housekeeping Practices:

The owner or operator shall design, install, implement and maintain practices appropriate to prevent pollutants from entering storm water from construction sites because of poor housekeeping. These practices must be listed in the SWPPP and located on the site map.

The owner or operator shall: (1) minimize the exposure of building materials, building products, construction wastes, trash, landscape materials, fertilizers, pesticides, herbicides, detergents, sanitary waste and other materials present on the site to precipitation and to stormwater; (2) minimization of exposure is not required in cases where the exposure to precipitation and to stormwater will not result in a discharge of pollutants, or where exposure of a specific material or product poses little risk of

ACT5 (continued):

Narrative Requirements:

Condition No.	Condition
---------------	-----------

stormwater contamination (such as final products and materials intended for outdoor use); (3) minimize the discharge of pollutants from spills and leaks and implement chemical spill and leak prevention and response procedures.

The owner or operator shall designate and report in the SWPPP areas for equipment maintenance and repair and concrete chute wash off; provide waste receptacles and regular collection of waste; provide adequately maintained sanitary facilities; provide protected storage areas for chemicals, paints, solvents, fertilizers, pesticides, herbicides, detergents and other potentially toxic materials; and implement spill and leak prevention practices and response procedures if spills and leaks do occur; minimize the exposure of building materials, building products, construction wastes, trash and landscape materials. These areas and specific potential pollutants shall be addressed in the SWPPP and located on the scaled site map.

The owner or operator shall provide a description of procedures for:

- (A) Sweeping or removal of sediment and other debris that has been tracked from the site or deposited from the site onto streets and other paved surfaces;
- (B) Removal of sediment or other pollutants that have accumulated in or near any sediment control measures, storm water conveyance channels, storm drain inlets, or water course conveyance within the construction site, and;
- (C) Removal of accumulated sediment that has been trapped by sediment control measures at the site, in accordance with applicable maintenance requirements covered under this permit.

The owner or operator shall also provide a description of the procedures for handling and disposing of wastes generated at the site, including, but not limited to, clearing and demolition debris, sediment removed from the site, construction and domestic waste, hazardous or toxic waste, and sanitary waste. [11 Miss. Admin. Code Pt. 6, R. 1]

T-11 CONSTRUCTION DEWATERING REQUIREMENTS

Comply with the following requirements to minimize the discharge of pollutants in ground water or accumulated stormwater that is removed from excavations, trenches, foundations, vaults, or other similar points of accumulation. Dewatering discharge shall be managed by BMPs.

- (A) Treat dewatering discharges with controls to minimize discharges of pollutants with controls designed to prevent discharges with visual turbidity to minimize discharges of pollutants. (Appropriate controls include sediment basins or sediment traps, sediment socks, dewatering tanks, tube settlers, weir tanks, filtration systems (e.g., bag or sand filters), other appropriate approval controls, and passive treatment systems that are designed to remove sediment. Appropriate controls to use downstream of dewatering controls to minimize erosion include vegetated buffers, check dams, riprap, and grouted riprap at outlets or other appropriate approval controls.);
- (B) Do not discharge visible floating solids or foam;
- (C) Use an oil-water separator or suitable filtration device (such as a cartridge filter) that is designed to remove oil, grease, or other products if dewatering water

ACT5 (continued):

Narrative Requirements:

Condition No.	Condition
	<p>is found to contain these materials; The discharge must not cause the formation of a visible sheen or visible hydrocarbon deposits on the bottom or shoreline of the receiving water.</p> <p>(D) To the extent feasible, use vegetated, upland areas of the site to infiltrate dewatering water before discharge. Using waters of the State as part of the treatment area is prohibited;</p> <p>(E) To prevent sediment discharge from causing erosion: (1) Use stable, erosion-resistant surfaces (e.g., well-vegetated grassy areas, clean filter stone, geotextile underlayment) for the discharge from dewatering controls; (2) Do not place dewatering controls, such as pumped water filter bags, on steep slopes.</p> <p>(F) At all points where dewatering water is discharged, velocity dissipation BMPs must be implemented. The discharge must not cause re-suspension;</p> <p>(G) With backwash water, either haul it away for disposal or return it to the beginning of the treatment process; and</p> <p>(H) Replace and/or clean the filter media used in dewatering devices when the pressure differential equals or exceeds the manufacturer's specifications. [11 Miss. Admin. Code Pt. 6, R. 1]</p>
T-12	<p>Flocculant Application:</p> <p>Flocculants, meeting the criteria contained in ACT8 and used in accordance with manufacturer's instructions, may be incorporated as part of an overall storm water management system. If flocculant application is proposed, the SWPPP must list the proposed flocculants to be used, describe the method, frequency and location of introduction, and identify the location of BMPs where flocculated material will settle. [11 Miss. Admin. Code Pt. 6, R. 1]</p>

ACT5 (continued):

Narrative Requirements:

Condition No.	Condition
T-13	<p>Prepare Scaled Site Map(s):</p> <p>The owner or operator shall prepare a scaled site map showing:</p> <ol style="list-style-type: none"> (1) Boundaries of property and proposed construction activities, noting any phasing of construction activities, (2) Original and proposed contours (if feasible), with steep slopes identified, (3) North arrow, (4) Drainage pattern arrows, (5) Location of sensitive areas, such as wetlands, perennial streams and adjacent receiving water bodies (if the receiving waterbody is not depicted on the map, the name and direction shall be listed in text form on the map), (6) Location of any storm drain inlets and any receiving MS4, (7) All erosion and sediment controls (vegetative and structural), (8) Any post-construction control measures, and (9) Location of housekeeping practices. (10) Location of construction entrance, equipment maintenance and repair areas, concrete washout area, waste management area, laydown area, and material and chemical storage areas. (11) Location and size of the buffer zones.
	<p>If flocculant application is proposed, the location(s) of the following items shall be marked and labeled on the site map.</p> <ol style="list-style-type: none"> (1) Flocculant introduction point(s), and (2) BMPs where flocculated material will settle.
T-14	<p>Implementation Sequence:</p> <p>If the construction project is a linear construction project (see Definitions), a scaled site map is not required, however standard diagrams (e.g., cross-sections showing dimensions and labeled components) of erosion and sediment controls to be used must be submitted. [11 Miss. Admin. Code Pt. 6, R. 1]</p> <p>The SWPPP shall outline an implementation sequence (including any phasing of construction activities), which coordinates the timing of all land-disturbing activities together with the necessary erosion and sedimentation control measures planned for the project. [11 Miss. Admin. Code Pt. 6, R. 1]</p>

ACT5 (continued):

Narrative Requirements:

Condition No.	Condition
T-15	<p>Implementation of Controls:</p> <p>The SWPPP shall require the owner or operator, in disturbing an area, to implement controls as needed to prevent erosion and adverse impacts to waters of the State. [11 Miss. Admin. Code Pt. 6, R. 1]</p>
T-16	<p>Maintenance and Weekly Inspections:</p> <p>The SWPPP shall describe procedures to maintain vegetation, erosion and sediment controls and other protective measures. Procedures shall provide that all controls and outfalls/discharge points are inspected after rain events that produce a discharge and at least weekly for a minimum of four inspections per month in accordance with ACT6, S-5.</p> <p>Any poorly functioning erosion controls or sediment controls, non-compliant discharges, or any other deficiencies observed during the inspections required under this permit shall be corrected as soon as possible, but not to exceed 24 hours of the inspection unless prevented by unsafe weather conditions as documented on the inspection form.</p> <p>In the event of an unanticipated breach of a sediment basin/pond, temporary containment measures shall be taken within 24 hours after the inspection. Permanent corrective measures shall be implemented within five (5) days of the inspection; however, if permanent corrective measures cannot be implemented within the timeframes provided herein the owner or operator shall contact MDEQ. [11 Miss. Admin. Code Pt. 6, R. 1]</p>
T-17	<p>Non-Storm Water Discharge Management:</p> <p>The SWPPP must identify all allowable sources of non-storm water discharges listed in ACT2, T-2, except for flows from actual fire-fighting activities, which are combined with storm water discharges associated with large construction activity. Non-storm water discharges should be eliminated or reduced to the extent feasible. Wash waters must be treated in a sediment basin or alternate control that provides equivalent or better treatment prior to discharge. The SWPPP must identify and ensure the implementation of appropriate Best Management Practices (BMPs) for the non-storm water component of the discharge.</p> <p>The Permit Board staff will review the above discharges on a case-by-case basis and may require the coverage recipient to apply for and obtain either an individual or an alternative general NPDES permit as provided in ACT3, S-2. [11 Miss. Admin. Code Pt. 6, R. 1]</p>
T-18	<p>Final Stabilization:</p> <p>The SWPPP shall describe procedures to achieve final stabilization (See Definitions) of all disturbed areas of the project site. [11 Miss. Admin. Code Pt. 6, R. 1]</p>

ACT5 (continued):

Narrative Requirements:

Condition No.	Condition
T-19	<p>Example Storm Water Pollution Prevention Plans (SWPPPs):</p> <p>Example SWPPPs are included in the Mississippi Storm Water Pollution Prevention Plan Guidance Manual for Construction Activities as well as the MDEQ Registration Form for Individual Residential Lots</p> <p>The Mississippi Storm Water Pollution Prevention Plan Guidance Manual for Construction Activities is also available online at: www.mdeq.ms.gov/construction-stormwater/</p> <p>The MDEQ Registration Form for Individual Residential Lots is in the Large Construction Forms Package, which is available online at: www.mdeq.ms.gov/construction-stormwater/</p> <p>US EPA also lists example SWPPPs on their website at: http://cfpub.epa.gov/npdes/stormwater/swppp.cfm#model. [1 Miss. Admin. Code Pt. 6, R. 1]</p>

T-20

STAFF TRAINING REQUIREMENTS

Each operator, or group of multiple operators, must assemble a “stormwater team” to carry out compliance activities associated with the requirements in this permit. Prior to the commencement of construction activities, the permittee must ensure that the following personnel on the stormwater team understand the requirements of this permit and their specific responsibilities with respect to those requirements:

- (1) Personnel who are responsible for the design, installation, maintenance, and/or repair of stormwater controls (including pollution prevention controls);
- (2) Personnel responsible for the application and storage of treatment chemicals (if applicable)
- (3) Personnel who are responsible for conducting inspections as required in ACT6, S-5; and
- (4) Personnel who are responsible for taking corrective actions as required in ACT6, S-2.

The permittee is responsible for ensuring that all activities on the site comply with the requirements of this permit. The permittee is not required to provide or document formal training for subcontractors or other outside service providers, but the permittee must ensure that such personnel understand any requirements of this permit that may be affected by the work they are subcontracted to perform.

At a minimum, members of the stormwater team must be trained to understand the following if related to the scope of their job duties (e.g., only personnel responsible for conducting inspections need to understand how to conduct inspections):

The permit deadlines associated with installation, maintenance, and removal of stormwater controls and with stabilization;

ACT5 (continued):

Narrative Requirements:

Condition No.	Condition
	<p>The location of all stormwater controls on the site required by this permit and how they are to be maintained; The proper procedures to follow with respect to the permit's pollution prevention requirements; and When and how to conduct inspections, record applicable findings, and take corrective actions.</p>
	<p>Each member of the stormwater team must have easy access to an electronic or paper copy of applicable portions of this permit, the most updated copy of the SWPPPP, and other relevant documents or information that must be kept with the SWPPPP.</p>
T-21	<p>STAFF TRAINING DOCUMENTATION</p> <p>Staff Training conducted to meet the requirements of this ACT shall be documented. Training records shall include employee's name, date of training, brief content/nature of training, and the employee's signature acknowledging training was received. Staff training associated with this permit may be documented on the Employee Training Log that is provided on the MDEQ website at www.mdeq.ms.gov/construction-stormwater/. The permittee may use an alternative form to record this information, so long as it includes all of the information on the above referenced form. Employee training documentation shall be maintained on-site with the SWPPPP and made available to MDEQ personnel for inspection upon request.</p>

ACT6 (LCGP) Implementation and Inspection Requirements:

Submittal/Action Requirements:

Condition No.	Condition
S-1	<p data-bbox="511 1386 544 1837">IMPLEMENTATION REQUIREMENTS:</p> <p data-bbox="560 1533 592 1837">The coverage recipient shall:</p> <ol data-bbox="625 157 1286 1837" style="list-style-type: none"><li data-bbox="625 682 657 1837">(1) Implement the site-specific SWPPP. Failure to implement the SWPPP is a violation of permit requirements.<li data-bbox="673 798 706 1837">(2) Install structural practices as described in ACT5, T-6 in accordance with the site-specific SWPPP.<li data-bbox="738 157 852 1837">(3) Retain a copy of the SWPPP at the permitted site, and, if feasible, post a copy of the NOI onsite in a location available to the public (e.g., construction entrance, trailer, or model home). A copy of the SWPPP shall be made available to state or local inspectors upon request for review at the time of an on-site inspection. In cases where there is no office or shelter to maintain documents onsite, the SWPPP can be kept locally available (i.e., able to be produced within an hour of being requested by a state or local inspector).<li data-bbox="885 1270 917 1837">(4) Implement the following pre-construction activities:<ol data-bbox="941 157 1286 1837" style="list-style-type: none"><li data-bbox="941 189 998 1837">(A) Mark off areas of "disturbance", "no disturbance", "sensitive areas" (e.g., delineate and clearly flag of mark off areas such as steep slopes, highly erodible soils or other sensitive areas),<li data-bbox="1023 1186 1055 1837">(B) Preserve native topsoil on the site to the extent feasible, and<li data-bbox="1079 693 1112 1837">(C) Limit construction stream crossings to the minimum necessary to provide access for the construction project.<li data-bbox="1144 409 1177 1837">(5) Ensure that appropriate Best Management Practices (BMPs) are in place upon commencement of construction activities (see Definitions).<li data-bbox="1201 189 1286 1837">(6) Amend the SWPPP if notified at any time by the Executive Director of the MDEQ that the SWPPP does not meet the minimum requirements. Coverage recipient shall certify in writing to the Executive Director that the requested changes have been made. Unless otherwise provided, the requested changes shall be made within fifteen (15) days. [11 Miss. Admin. Code Pt. 6, R. 1]

ACT6 (continued):

Submittal/Action Requirements:

Condition No.	Condition
S-2	<p>IMPLEMENTATION REQUIREMENTS (continued):</p> <p>(7) Amend the SWPPP whenever there is a change in design, construction, operation, or maintenance that may potentially affect the discharge of pollutants to waters of the State; or the SWPPP proves to be ineffective in controlling storm water pollutants. The amended SWPPP shall be submitted within thirty (30) days of amendment. Coverage recipients shall submit to MDEQ the Major Modification Form (see Large Construction Forms Package) for subsequent phases, expansions and modifications of subdivision development that are proposed but were not included in the original SWPPP.</p> <p>(8) Install needed erosion controls even if they may be located in the way of subsequent activities, such as utility installation, grading or construction. It shall not be an acceptable defense that controls were not installed because subsequent activities would require their replacement or cause their destruction.</p> <p>(9) Install additional and/or alternative erosion and sediment controls when existing controls prove to be ineffective in preventing sediment from leaving the site.</p> <p>(10) Comply with applicable State or local waste disposal, sanitary sewer or septic system regulations. [11 Miss. Admin. Code Pt. 6, R. 1]</p>
S-3	<p>IMPLEMENTATION REQUIREMENTS (continued):</p> <p>(11) Erosion and sediment controls shall be maintained at all times. Except for sediment basins, all accumulated sediment shall be removed from structural controls when sediment deposits reach one-third to one-half the height of the control. For sediment basins, accumulated sediment shall be removed when the capacity has been reduced by 50%. All removed sediment deposits shall be properly disposed of in accordance with the approved SWPPP. Non-functioning controls shall be repaired, replaced or supplemented with functional controls within twenty-four (24) hours of discovery or as soon as field conditions allow.</p> <p>(12) If, after coverage issuance, a specific wasteload allocation is established that would apply to the facility's discharge, the facility must implement steps necessary to meet that allocation. [11 Miss. Admin. Code Pt. 6, R. 1]</p>
S-4	<p>COMPLIANCE WITH LOCAL STORM WATER ORDINANCES:</p> <p>(1) The SWPPP shall be in compliance with all local storm water ordinances.</p> <p>(2) When storm water discharges into an MS4 (municipal separate storm sewer system), the owner or operator shall make the SWPPP available to the local authority and/or allow site access, upon request. [11 Miss. Admin. Code Pt. 6, R. 1]</p>

ACT6 (continued):

Submittal/Action Requirements:

Condition No.	Condition
S-5	<p data-bbox="506 1461 532 1822">INSPECTION REQUIREMENTS:</p> <p data-bbox="565 140 651 1822">Inspection of all receiving streams (if feasible), outfalls, erosion and sediment controls and other SWPPP requirements shall be performed during permit coverage using a copy of the form provided in the Large Construction Forms Package (or equivalent form), and inspections shall be performed by qualified personnel (see Definitions):</p> <ul data-bbox="678 140 797 1822" style="list-style-type: none"><li data-bbox="678 1108 709 1822">(1) At least weekly for a minimum of four inspections per month; and<li data-bbox="737 140 797 1822">(2) As often as is necessary to ensure that appropriate erosion and sediment controls have been properly constructed and maintained and to determine if additional or alternative control measures are required. <p data-bbox="824 140 885 1822">Before conducting the site inspection, the inspector should review Chapter 4, Inspector's Checklist and Troubleshooting Chart found in MDEQ's Field Manual for Erosion and Sediment Control on Construction Sites in Mississippi.</p> <p data-bbox="912 140 966 1822">MDEQ strongly recommends that coverage recipients perform a "walk through" inspection of the construction site daily to ensure controls are in place and will function properly. [1 Miss. Admin. Code Pt. 6, R. 1]</p>

ACT7 (LCGP) Limitation Requirements:

Limitation Requirements:

Condition No.	Parameter	Condition
L-1		NON-NUMERIC LIMITATION REQUIREMENTS Storm water discharge shall be free from: (1) Debris, oil, scum, and other floating materials other than in trace amounts, (2) Eroded soils and other materials that will settle to form objectionable deposits in receiving waters, (3) Suspended solids, turbidity and color at levels inconsistent with the receiving waters, (4) Chemicals in concentrations that would cause violation of State Water Quality Criteria in the receiving waters. [11 Miss. Admin. Code Pt. 6, Ch. 2, R. 1]

ACT8 (LCGP) Application of Flocculants:

Narrative Requirements:

Condition No.	Condition
T-1	<p>Coverage recipients may need to supplement conventional storm water management systems with flocculants to meet state water quality standards. Flocculants meeting the criteria listed in (1) and (2) below and used in accordance with manufacturer's instructions are approved by this general permit.</p> <p>Any flocculant application, which deviates from the criteria specified below, must receive written approval from MDEQ prior to being implemented. Requests for approval must be in writing and shall describe the deviation, explain the justification for the deviation and provide supporting documentation demonstrating that such deviation will achieve equivalent performance to the criteria listed below. A SDS (Safety Data Sheet) of the flocculant shall be included with the request. The request shall include the dosage of the flocculant that will be used. Such requests may be submitted with the LCNOI or under separate cover to the address listed on the LCNOI.</p> <p>(1) Polymer flocculants for treating turbidity in construction site storm water discharges must meet the following minimum criteria.</p> <ul style="list-style-type: none"> (A) Only anionic Polyacrylamide (PAM) polymer, (B) Polymer shall contain less than 0.05% free acrylamide, (C) Polymer shall be non-toxic to fish and other aquatic organisms, and (D) Polymer shall be selected for site-specific soil conditions (i.e., jar test). <p>(2) Systems utilizing polymer flocculants to treat turbidity from construction site storm water discharges must meet the following minimum criteria.</p> <ul style="list-style-type: none"> (A) Polymer shall be introduced through turbulent mixing into the storm water upstream of sedimentation BMPs, (B) Sedimentation basin shall be constructed in accordance with the criteria specified in ACT5, T-5 (2)(A), (C) Polymer shall be applied in accordance with manufacturer's instructions, and (D) There shall be no discharge of un-dissolved polymer, clumps of polymer and/or unsettled flocculant material. [11 Miss. Admin. Code Pt. 6, R. 1]

ACT9 (LCGP) Record Keeping and Reporting Requirements:

Record-Keeping Requirements:

Condition No.	Condition
---------------	-----------

R-1 RETENTION OF RECORDS:

All records, reports, forms and information resulting from activities required by this permit shall be retained for a period of at least three (3) years from the date that the document(s) was generated. Any documents required by this permit may be kept electronically but must be readily available during site inspection or upon request. [11 Miss. Admin. Code Pt. 6, R. 1]

ACT9 (continued):

Submittal/Action Requirements:

Condition No.	Condition
---------------	-----------

Submittal/Action Requirements:

- S-1 **SUSPENSION OF WEEKLY INSPECTIONS AND MONTHLY RECORD KEEPING:**
Coverage recipients under this general permit may suspend weekly inspection and monthly record keeping requirements, if the coverage recipient certifies that:
- (1) Land-disturbing activities have temporarily ceased,
 - (2) No further land-disturbing activities are planned for a period of at least six (6) months,
 - (3) Areas that have been disturbed meet the definition of "final stabilization" (see Definitions), with no active erosion, and
 - (4) Vegetative cover has been established.

Color photographs representative of the site must be submitted with the Inspection Suspension Form provided in the Large Construction Forms Package. The coverage recipient shall notify the MDEQ once construction activities are resumed and the weekly inspections shall commence immediately and as required in ACT6, S-5. The coverage recipient is still responsible for all permit conditions during the suspension period and nothing in this condition shall limit the rights of the MDEQ to take enforcement or other actions against the coverage recipient. [11 Miss. Admin. Code Pt. 6, R. 1]

- S-2 The inspections described in ACT7, S-5 must be documented on copies of the Monthly Inspection Report and Certification Form provided in the Large Construction Forms Package (or equivalent form) and be kept with the SWPPP.
- Submittals of the MDEQ Registration Form for residential lots are required. It is the responsibility of both the owner or developer (seller) and the new owner or operator (purchaser) to maintain a copy of the MDEQ Registration Form. The new owner or operator must maintain a copy of the MDEQ Registration Form at the site. In cases where there is no office or shelter to maintain documents onsite, the Registration Form can be kept locally available (i.e., able to be produced within an hour of being requested by state or local inspectors). [11 Miss. Admin. Code Pt. 6, R. 1]

ACT10 (LCGP) Termination of Permit Coverage:

Submittal/Action Requirements:

Condition No.	Condition
S-1	<p>Within thirty (30) days of final stabilization (see Definition of Final Stabilization (1)) for a covered project, a completed Request for Termination (RFT) of Coverage form (provided in the Large Construction Forms Package) and colored photographs of the stabilized site shall be submitted to the Permit Board. Upon receiving the completed RFT, the MDEQ staff may inspect the site. If no sediment and erosion control problems are identified and adequate permanent controls are established, the owner or operator will receive a termination letter. Coverage is not terminated until notified in writing by MDEQ. Failing to submit a RFT is a violation of permit conditions.</p> <p>The coverage recipient of a "larger common plan of development or sale" must submit a RFT within thirty (30) days after the following conditions are met:</p> <ul style="list-style-type: none">(1) Final stabilization (see Definition of Final Stabilization (2)) has been achieved on all portions of the site for which the coverage recipient is responsible, and(2) Other owner(s) or operator(s) have assumed control (by completing a LCNOI or MDEQ Registration Form) over all areas of the site that have not achieved final stabilization. <p>The coverage recipient of a residential "larger common plan of development or sale" must submit a copy of the MDEQ Registration Form for each lot sold with the RFT.</p> <p>Residential lot owners or operators that have completed the MDEQ Registration Forms are not required to submit a RFT, unless specifically requested by the MDEQ staff. The lot permit coverage is considered terminated upon "successful completion of all permanent erosion and sediment controls" (see Definitions).</p> <p>Beginning December 21, 2025, the RFT must be submitted electronically as required by 40 CFR 127.16. [11 Miss. Admin. Code Pt. 6, R. 1]</p>

ACT11 (LCGP) Standard Requirements Applicable To All Water Permits:

Narrative Requirements:

Condition No.	Condition
T-1	DUTY TO COMPLY: The coverage recipient must comply with all conditions of this permit. Any permit noncompliance constitutes a violation and is grounds for enforcement action; for coverage termination, revocation and reissuance, or modifications; or denial of a renewal application. [11 Miss. Admin. Code Pt. 6, R. 1]
T-2	DUTY TO MITIGATE: The owner or operator shall take all reasonable steps to minimize or prevent any discharge in violation of this permit, which is likely to adversely affect human health or the environment. [11 Miss. Admin. Code Pt. 6, R. 1]
T-3	DUTY TO PROVIDE INFORMATION: The owner or operator shall furnish to the Permit Board, within a reasonable time, any information that the Permit Board may request to determine compliance with this permit. [11 Miss. Admin. Code Pt. 6, R. 1]
T-4	PROPERTY RIGHTS: The issuance of this permit does not convey any property rights of any sort, nor any exclusive privileges, nor does it authorize any injury to private property nor any invasion of personal rights, nor any infringement of Federal, State or local laws or regulations. [11 Miss. Admin. Code Pt. 6, R. 1]
T-5	SEVERABILITY: The provisions of this permit are severable. If any provision of this permit, or the application of any provision of this permit to any circumstances, is challenged or held invalid, the validity of the remaining permit provisions and/or portions thereof or their application to other persons or sets of circumstances, shall not be affected thereby. [11 Miss. Admin. Code Pt. 6, R. 1]
T-6	OIL AND HAZARDOUS SUBSTANCE LIABILITY: Nothing in this permit shall relieve the owner or operator from responsibilities, liabilities, or penalties under Section 311 of the CWA (33 U.S.C. Section 1321). [11 Miss. Admin. Code Pt. 6, R. 1]

ACT11 (continued):

Narrative Requirements:

Condition No.	Condition
T-7	<p data-bbox="503 1470 527 1827">SIGNATORY REQUIREMENTS:</p> <p data-bbox="560 1134 584 1827">All LCNOIs and requests for recovery shall be signed as follows:</p> <p data-bbox="617 703 641 1827">(1) For a corporation by a responsible corporate officer. For this permit, a responsible corporate officer means:</p> <p data-bbox="673 157 730 1827">(A) A president, secretary, treasurer, or vice-president of the corporation in charge of a principal business function, or any other person who performs similar policy or decision-making functions for the corporation; or</p> <p data-bbox="763 157 901 1827">(B) The manager of one or more manufacturing, production or operating facilities, provided, the manager is authorized to make management decisions which govern the operation of the regulated facility including having the explicit or implicit duty of making major capital investment recommendations, and initiating and directing other comprehensive measures to assure long term environmental compliance with environmental laws and regulations; the manager can ensure that the necessary systems are established or actions taken to gather complete and accurate information for permit application requirements; and where authority to sign documents has been assigned or delegated to the manager in accordance with corporate procedures;</p> <p data-bbox="933 157 1047 1827">Note: MDEQ does not require specific assignments or delegations of authority to responsible corporate officers identified in paragraph (1)(A) above. The Department will presume that these responsible corporate officers have the requisite authority to sign permit applications unless the corporation has notified the Permit Board to the contrary. Corporate procedures governing authority to sign permit applications may provide for assignment or delegation to applicable corporate positions under paragraph (1)(B) above rather than to specific individuals.</p> <p data-bbox="1079 840 1104 1827">(2) For a partnership or sole proprietorship by a general partner or the proprietor, respectively; or</p> <p data-bbox="1136 157 1193 1827">(3) For a municipal, State, Federal, or other public agency by either a principal executive officer or ranking elected official. For purposes of this section, a principal executive officer of a Federal agency includes:</p> <p data-bbox="1226 1333 1250 1827">(A) The chief executive officer of the agency, or</p> <p data-bbox="1282 220 1307 1827">(B) A senior executive officer having responsibility for the overall operations of a principal geographic unit of the agency. [11 Miss. Admin. Code Pt. 6, R. 1]</p>

ACT11 (continued):

Narrative Requirements:

Condition No.	Condition
T-8	<p data-bbox="505 1356 529 1824">DULY AUTHORIZED REPRESENTATIVE:</p> <p data-bbox="565 170 618 1824">All SWPPPs, reports required by this permit, certifications and other information requested by the Permit Board shall be signed by a person described in T-7 above, or by a duly authorized representative of that person. A person is a duly authorized representative when:</p> <ul data-bbox="651 170 792 1824" style="list-style-type: none"><li data-bbox="651 701 675 1824">(1) The authorization is made in writing and submitted to the Permit Board by a person described in T-7 above.<li data-bbox="708 170 792 1824">(2) The authorization specifies either an individual or a position having responsibility for the overall operation of the regulated activity, such as: manager, operator of a well or well field, superintendent, person of equivalent responsibility, or an individual or position having overall responsibility for environmental matters for the company. (A duly authorized representative may be either a specified individual or position). [11 Miss. Admin. Code Pt. 6, R. 1]
T-9	<p data-bbox="816 1446 841 1824">CHANGES TO AUTHORIZATION:</p> <p data-bbox="873 170 954 1824">If an authorization is no longer accurate because a different individual or position has permit responsibility, a new authorization satisfying the requirements of T-7 and T-8 above, must be submitted to the Permit Board prior to or together with any reports, information or applications signed by the representative. [11 Miss. Admin. Code Pt. 6, R. 1]</p>
T-10	<p data-bbox="979 1629 1003 1824">CERTIFICATION:</p> <p data-bbox="1036 936 1060 1824">Any person signing documents under this section shall make the following certification:</p> <p data-bbox="1092 170 1237 1824">"I certify under penalty of law that this document and all attachments were prepared under my direction or supervision in accordance with a system designed to assure that qualified personnel properly gathered and evaluated the information submitted. Based on my inquiry of the person or persons who manage the system, or those persons directly responsible for gathering the information, the information submitted is, to the best of my knowledge and belief, true, accurate and complete. I am aware that there are significant penalties for submitting false information, including the possibility of fine and imprisonment for knowing violations." [11 Miss. Admin. Code Pt. 6, R. 1]</p>

ACT11 (continued):

Narrative Requirements:

Condition No.	Condition
T-11	<p>PROPER OPERATION AND MAINTENANCE:</p> <p>The coverage recipient shall at all times properly operate and maintain all facilities and systems of treatment and control (and related appurtenances) which are installed or used by the coverage recipient to achieve compliance with the conditions of this permit including the Storm Water Pollution Prevention Plan. Proper operation and maintenance includes adequate laboratory controls with appropriate quality assurance procedures and requires the operation of backup or auxiliary facilities when necessary to achieve compliance with permit conditions. [11 Miss. Admin. Code Pt. 6, R. 1]</p>
T-12	<p>MONITORING AND RECORDS:</p> <p>(1) Monitoring. Samples and measurements shall be representative of the monitored activity and must be conducted according to test procedures approved under 40 CFR Part 136.</p> <p>(2) Retention of Records. The owner or operator shall retain records of all required monitoring information for a period of at least three years from the date of the measurement, report, or application. This information includes all calibration and maintenance records, all original strip chart recordings for continuous monitoring instrumentation, copies of all reports required by this permit, and records of all data used to complete the Notice of Intent to be covered by this permit. This period may be extended by request of the Permit Board or its designee. Any documents required by this permit may be kept electronically but must be readily available during site inspection or upon request.</p> <p>(3) Record Contents. Records of monitoring information shall include:</p> <ul style="list-style-type: none"> (A) The date, exact location, and time of sampling or measurements, (B) The initials or names of the individuals who performed the sampling or measurements, (C) The date(s) and time(s) analyses were performed, (D) The initials or names of the individuals who performed the analyses, (E) References and written procedures, when available, for the analytical techniques or methods used, and (F) The results of such analyses, including the bench sheets, instrument readouts, computer disks or tapes, etc., used to determine these results. [11 Miss. Admin. Code Pt. 6, R. 1]

ACT11 (continued):

Narrative Requirements:

Condition No.	Condition
T-13	<p>BYPASS PROHIBITION:</p> <p>Bypass (see 40 CFR 122.41(m)) is prohibited and enforcement action may be taken against an coverage recipient for a bypass, unless: a) the bypass was unavoidable to prevent loss of life, personal injury, or severe property damage; b) There were no feasible alternatives to the bypass, such as the use of auxiliary treatment facilities, retention of untreated wastes, or maintenance during normal periods of equipment downtime (this condition is not satisfied if the coverage recipient should, in the exercise of reasonable engineering judgment, have installed adequate backup equipment to prevent a bypass which occurred during normal periods of equipment downtime or preventive maintenance); and c) The owner or operator submitted notices per T-17 of this ACT. [11 Miss. Admin. Code Pt. 6, R. 1]</p>
T-14	<p>UPSET CONDITIONS:</p> <p>An upset (see 40 CFR 122.41(n)) constitutes an affirmative defense to an action brought for noncompliance with technology-based permit limitations if a coverage recipient shall demonstrate, through properly signed, contemporaneous operating logs, or other relevant evidence, that:</p> <ol style="list-style-type: none"><li data-bbox="873 856 904 1829">(1) An upset occurred and the coverage recipient can identify the specific cause(s) of the upset,<li data-bbox="932 1031 963 1829">(2) The permitted facility was at the time of the upset being properly operated,<li data-bbox="990 1104 1021 1829">(3) The coverage recipient submitted notices per T-17 of this ACT, and<li data-bbox="1049 201 1136 1829">(4) The coverage recipient took remedial measures as required under T-2 of this ACT. In any enforcement proceeding, the coverage recipient has the burden of proof that an upset occurred. No determination made during administrative review of claims that noncompliance was caused by upset, and before an action for noncompliance is initiated, will be considered a final administrative action subject to judicial review. [11 Miss. Admin. Code Pt. 6, R. 1]

ACT11 (continued):

Narrative Requirements:

Condition No.	Condition
T-15	INSPECTION AND ENTRY: The coverage recipient shall allow the Permit Board staff or an authorized representative, upon the presentation of credentials and other documents as may be required by law, to: (1) Enter upon the owner or operator's premises where a regulated activity is located or conducted or where records must be kept under the conditions of this permit; (2) Have access to and copy at reasonable times any records that must be kept under the conditions of this permit; (3) Inspect at reasonable times any facilities or equipment (including monitoring and control equipment), practices, or operations regulated or required under this permit; and (4) Sample or monitor at reasonable times, for the purposes of assuring permit compliance or as otherwise authorized by the Clean Water Act, any substances or parameters at any location. [11 Miss. Admin. Code Pt. 6, R. 1]
T-16	PERMIT ACTIONS: This permit may be modified, revoked and reissued, or terminated for cause. A request by the coverage recipient for permit or coverage modification, revocation and reissuance, or termination, or a certification of planned changes or anticipated noncompliance does not stay any permit condition. [11 Miss. Admin. Code Pt. 6, R. 1]

ACT11 (continued):

Narrative Requirements:

Condition No.	Condition
T-17	<p>NONCOMPLIANCE REPORTING:</p> <p>(1) Anticipated Noncompliance. The coverage recipient shall give at least ten (10) days advance notice, if possible, before any planned noncompliance with permit requirements. Giving notice of planned or anticipated noncompliance does not immunize the coverage recipient from enforcement action for that noncompliance.</p> <p>(2) Unanticipated Noncompliance. The coverage recipient shall notify the MDEQ orally within twenty-four (24) hours from the time he or she becomes aware of unanticipated noncompliance, which may endanger health or the environment. A written report shall be provided to the MDEQ within five (5) working days of the time he or she becomes aware of the circumstances leading to the unanticipated noncompliance. The report shall describe the cause, the exact dates and times, steps taken or planned to reduce, eliminate, or prevent reoccurrence and, if the noncompliance has not ceased, the anticipated time for correction. MDEQ may waive the written report on a case-by-case basis, if the oral report is received within 24 hours. [11 Miss. Admin. Code Pt. 6, R. 1]</p>
T-18	<p>REOPENER CLAUSE:</p> <p>If there is evidence indicating potential or realized impacts on water quality due to large construction activities covered by this permit, the coverage recipient may be required to obtain individual permit or an alternative general permit in accordance with ACT3, S-2 or the permit may be modified to include different limitations and/or requirements. [11 Miss. Admin. Code Pt. 6, R. 1]</p>
T-19	<p>PERMIT MODIFICATION:</p> <p>Permit modification or revocation will be conducted according to 40 CFR 122.62, 122.63, 122.64 and 124.5. [11 Miss. Admin. Code Pt. 6, R. 1]</p>
T-20	<p>TRANSFERS:</p> <p>Coverage under this permit is not transferable to any person except after notice to and approval by the Permit Board. The Permit Board may require the coverage recipient to obtain another NPDES permit as stated in ACT3, S-2. Transfer of coverage requests shall be submitted to the Permit Board using the form provided in the Large Construction Forms Package. [11 Miss. Admin. Code Pt. 6, R. 1]</p>

ACT11 (continued):

Narrative Requirements:

Condition No.	Condition
T-21	CONTINUATION OF EXPIRED GENERAL PERMIT:

If this permit is not reissued prior to the expiration date, it will be administratively continued and remain in force and effect. Permit coverage will remain until the earliest of:

- (1) Recovery under the reissued general permit;
- (2) Submittal of a Request for Termination and receipt of written concurrence;
- (3) Issuance of an individual permit for the project's discharge; or
- (4) A formal permit decision by the Permit Board to not reissue the general permit, at which time the coverage recipient must seek coverage under an alternative general permit or an individual permit. [11 Miss. Admin. Code Pt. 6, R. 1]

T-22 FALSIFYING REPORTS:

Any coverage recipient who falsifies any written report required by or in response to a permit condition shall be deemed to have violated a permit condition and shall be subject to the penalties provided for a violation of a permit condition pursuant to Section 49-17-43 of the Mississippi Water Pollution Control Law (Mississippi Code Ann. Sections 49-17-1 et seq.). [11 Miss. Admin. Code Pt. 6, R. 1]

T-23 CIVIL AND CRIMINAL LIABILITY:

- (1) Any person who violates a term, condition or schedule of compliance contained within this permit or the Mississippi Air and Water Pollution Control Law is subject to the actions defined by the Mississippi Air and Water Pollution Control Law.
- (2) Except as provided in permit conditions on "Bypassing" and "Upsets", nothing in this permit shall be construed to relieve the coverage recipient from civil or criminal penalties for noncompliance.
- (3) It shall not be the defense of the coverage recipient in an enforcement action that it would have been necessary to halt or reduce the permitted activity in order to maintain compliance with the conditions of this permit. [11 Miss. Admin. Code Pt. 6, R. 1]

ACT12 (LCGP) Definitions:

Narrative Requirements:

Condition No.	Condition
T-1	<p>BEST MANAGEMENT PRACTICES (BMPs) means schedules of activities, prohibitions of practices, maintenance procedures, and other management practices to prevent or reduce the discharge of pollutants to waters of the United States. BMPs also include treatment requirements, operating procedures, and practices to control plant site runoff, spillage or leaks, sludge or waste disposal, or drainage from raw material storage. [11 Miss. Admin. Code Pt. 6, R. 1]</p>
T-2	<p>BUFFER ZONE, as used in this permit, means a strip of dense undisturbed perennial vegetation, either original or reestablished, that borders perennial streams and rivers, ponds and lakes and wetlands. Buffer zones are established for the purposes of slowing water runoff, enhancing water infiltration, and minimizing the risk of any potential nutrients or pollutants from leaving the upland area and reaching surface waters. Buffer zones are most effective when storm water runoff is flowing into and through the buffer zone as shallow sheet flow, rather than in concentrated form such as in channels, gullies, or wet weather conveyances. Therefore, it is critical that the design of any development include management practices, to the maximum extent practical, that will result in storm water runoff flowing into and through the buffer zone as shallow sheet flow. [11 Miss. Admin. Code Pt. 6, R. 1]</p>
T-3	<p>CFR means the Code of Federal Regulations. [11 Miss. Admin. Code Pt. 6, R. 1]</p>
T-4	<p>CLEAN WATER ACT (CWA) refers to the Federal Water Pollution Control Act, 33 U.S.C. section 1251 et seq. [11 Miss. Admin. Code Pt. 6, R. 1]</p>
T-5	<p>COMMENCEMENT OF CONSTRUCTION ACTIVITIES means the initial disturbance of soils associated with clearing, grading, grubbing, or excavating activities or other construction-related activities. [11 Miss. Admin. Code Pt. 6, R. 1]</p>
T-6	<p>COMMISSION means the Mississippi Commission on Environmental Quality. [11 Miss. Admin. Code Pt. 6, R. 1]</p>
T-7	<p>COMPACTION means the process by which the soil grains are rearranged to decrease void space and bring the grains into closer contact with one another and thereby increase the weight of solid material per cubic foot. [11 Miss. Admin. Code Pt. 6, R. 1]</p>
T-8	<p>CONSTRUCTION ACTIVITY as used in this permit, includes construction activity as defined in 40 CFR part 122.26(b)(14)(x). This includes a disturbance to the land that results in the change in topography, existing soil cover (both vegetative and non-vegetative), or the existing topography that may result in accelerated storm water runoff, leading to soil erosion and movement of sediment into surface waters or drainage systems. Examples of construction activity may include clearing, grading, grubbing, filling and excavating. Construction activity does not include routine maintenance that is performed to maintain the original line and grade, hydraulic capacity, or original purpose of the site. [11 Miss. Admin. Code Pt. 6, R. 1]</p>
T-9	<p>CONSTRUCTION SUPPORT ACTIVITY a construction-related activity that specifically supports the construction activity and involves earth disturbance or pollutant-generating activities of its own, and can include activities associated with concrete or asphalt batch plants, equipment staging yards, materials storage areas, excavated material disposal areas, and borrow areas. [11 Miss. Admin. Code Pt. 6, R. 1]</p>

**ACT12 (LCGP) Definitions:
Narrative Requirements:**

Condition No.	Condition
T-10	CONTROL MEASURE as used in this permit, refers to any Best Management Practice or other method used to prevent or reduce the discharge of pollutants to waters of the United States. [11 Miss. Admin. Code Pt. 6, R. 1]
T-11	DAILY DISCHARGE means the "discharge of a pollutant" measured during a calendar day or any 24-hour period that reasonably represents the calendar day for purposes of sampling. For pollutants with limitations expressed in units of mass, the "daily discharge" is calculated as the total mass of the pollutant discharged over the day. For pollutants with limitations expressed in other units of measurements, the "daily average" is calculated as the average measurement of the discharge of the pollutant over the day. [11 Miss. Admin. Code Pt. 6, R. 1]
T-12	DEWATERING means the act of draining rainwater and/or ground water from building foundations, vaults, and trenches. [11 Miss. Admin. Code Pt. 6, R. 1]
T-13	DROUGHT-STRICKEN AREA means for the purposes of this permit an area in which the National Oceanic and Atmospheric Administration's U.S. Seasonal Drought Outlook indicates for the period during which the construction will occur that any of the following conditions are likely: (1) "Drought to persist or intensify", (2) "Drought ongoing, some improvement", (3) "Drought likely to improve, impacts ease", or (4) "Drought development likely". See http://www.cpc.ncep.noaa.gov/products/expert_assessment/season_drought.gif . [11 Miss. Admin. Code Pt. 6, R. 1]
T-14	EXECUTIVE DIRECTOR means the Executive Director of the Department of Environmental Quality. [11 Miss. Admin. Code Pt. 6, R. 1]
T-15	FACILITY or ACTIVITY means any NPDES "point source" or any other facility or activity (including land or appurtenances thereto) that is subject to regulation under the NPDES program. [11 Miss. Admin. Code Pt. 6, R. 1]
T-16	FINAL STABILIZATION means that either: (1) All soil disturbing activities at the site have been completed, and that a uniform perennial vegetative cover with a density of at least 70% for the area has been established or equivalent measures (e.g., concrete or asphalt paving, rip rap, etc.) have been employed, or (2) For individual lots part of a larger common plan of development or sale in residential or commercial developments, that either: (A) The coverage recipient has completed final stabilization as specified in (1) above, or (B) The coverage recipient has established temporary stabilization before another property owner assumes operational control for the property AND the coverage recipient for the larger common plan of development has provided the appropriate Notice of Intent or Registration form, the appropriate Construction General Permit, and guidance documents to the new property owner and the new owner assumes control by completing the appropriate NOI or Registration Form.

ACT12 (continued):

Narrative Requirements:

Condition No.	Condition
T-17	In arid, semiarid, and drought-stricken areas where initiating vegetative stabilization measures immediately is infeasible, alternative stabilization measures must be employed if specified by the permitting authority. [11 Miss. Admin. Code Pt. 6, R. 1]
T-18	INFEASIBLE means not technologically possible, or not economically practicable and achievable in light of best industry practices. [11 Miss. Admin. Code Pt. 6, R. 1]
T-19	LARGE CONSTRUCTION ACTIVITY includes clearing, grading, grubbing, and excavating resulting in a land disturbance that will disturb equal to or greater than five (5) acres of land or will disturb less than five (5) acres of total land area but is part of a larger common plan of development or sale that will ultimately disturb equal to or greater than five (5) acres. [11 Miss. Admin. Code Pt. 6, R. 1]
T-20	LARGER COMMON PLAN OF DEVELOPMENT OR SALE means a contiguous area where multiple separate and distinct construction activities are occurring under one plan. The plan in a common plan of development or sale is broadly defined as any announcement or piece of documentation (including a sign, public notice or hearing, sales pitch, advertisement, drawing, permit application, zoning request, computer design, etc.) or physical demarcation (including boundary signs, lot stakes, surveyor markings, etc.), indicating that construction activities may occur on a specific plot. [11 Miss. Admin. Code Pt. 6, R. 1]
T-21	LINEAR PROJECT includes the construction of roads, bridges, conduits, substructures, pipelines, sewer lines, towers, poles, cables, wires, connectors, switching, regulating and transforming equipment and associated ancillary facilities in a long, narrow area. [11 Miss. Admin. Code Pt. 6, R. 1]
T-22	MUNICIPAL SEPARATE STORM SEWER SYSTEM (MS4) means a conveyance or system of conveyances (including roads with drainage systems, municipal streets, catch basins, curbs, gutters, ditches, man-made channels, or storm drains): (i) Owned or operated by a State, city, town, borough, county, parish, district, association, or other public body (created by or pursuant to State law) having jurisdiction over disposal of sewage, industrial wastes, storm water, or other wastes, including special districts under State law such as a sewer district, flood control district or drainage district, or similar entity, or an Indian tribe or an authorized Indian tribal organization, or a designated and approved management agency under section 208 of the CWA that discharges to waters of the United States, (ii) Designed or used for collecting or conveying storm water, (iii) Which is not a combined sewer, and (iv) Which is not part of a Publicly Owned Treatment Works (POTW). [11 Miss. Admin. Code Pt. 6, R. 1]
T-23	NATIONAL POLLUTANT DISCHARGE ELIMINATION SYSTEM (NPDES) means the regulations under the Clean Water Act that prohibits discharge of pollutants into waters of the United States unless a special permit is issued. [11 Miss. Admin. Code Pt. 6, R. 1]
T-24	NOI is an acronym for "Notice of Intent" to be covered by this permit and is the mechanism used to apply for coverage under a general permit. [11 Miss. Admin. Code Pt. 6, R. 1]
T-25	NORMAL WORKING HOURS, for the purpose of this permit, means the hours that personnel are typically working at the project site (e.g., daylight hours, Monday through Friday, except recognized holidays). [11 Miss. Admin. Code Pt. 6, R. 1]

ACT12 (continued):

Narrative Requirements:

Condition No.	Condition
T-25	OWNER or OPERATOR for the purpose of this permit and in the context of storm water associated with construction activity, means any party associated with a construction project that meets either of the following two criteria:
	(1) The party has operational control over construction plans, specifications, and installation of BMPs including the ability to make modifications to those plans and specifications; or
	(2) The party has day to day operational control of those activities at a project which are necessary to ensure compliance with a storm water pollution prevention plan for the site or other permit conditions (e.g., they are authorized to direct workers at a site to carry out activities required by the SWPPP or comply with other permit conditions). This definition is provided to inform coverage recipients of MDEQ's interpretation of how the regulatory definitions of "owner or operator" and "facility or activity" are applied to discharges of storm water associated with construction activity. [11 Miss. Admin. Code Pt. 6, R. 1]
T-26	PERMIT BOARD means the Mississippi Environmental Quality Permit Board established pursuant to Miss. Code Ann. 49-17-28. [11 Miss. Admin. Code Pt. 6, R. 1]
T-27	POLLUTANT is defined at 40 CFR 122.2. A partial listing from this definition includes: dredged spoil, solid waste, sewage, garbage, sewage sludge, chemical wastes, biological materials, heat, wrecked or discarded equipment, rock, sand, sediment, silt, cellar dirt, and industrial or municipal waste. [11 Miss. Admin. Code Pt. 6, R. 1]
T-28	POLYMER FLOCCULANT, for the purpose of this permit, is a chemical that when added to storm water containing small suspended particles (e.g., fine silts and clays) causes the particles to stick together and fall out of suspension, reducing the overall turbidity of the storm water discharge. [11 Miss. Admin. Code Pt. 6, R. 1]
T-29	QUALIFIED PERSONNEL means a person knowledgeable in the principles and practice of erosion and sediment controls who possesses the skills to assess conditions at the construction site that could impact storm water quality and to assess the effectiveness of any sediment and erosion control measures selected to control the quality of storm water discharges from the construction activity. [11 Miss. Admin. Code Pt. 6, R. 1]
T-30	STATE LAW means The Mississippi Air and Water Pollution Control Law, specifically, Miss. Code Ann 49-17-1 through 49-17-43, and any subsequent amendments. [11 Miss. Admin. Code Pt. 6, R. 1]
T-31	STEEP SLOPES, as used in this permit, means slopes or grades steeper than (3:1). [11 Miss. Admin. Code Pt. 6, R. 1]

ACT12 (continued):

Narrative Requirements:

Condition No.	Condition
T-32	STORM WATER means rainfall runoff, snowmelt runoff, and surface runoff. [11 Miss. Admin. Code Pt. 6, R. 1]
T-33	STORM WATER ASSOCIATED WITH CONSTRUCTION ACTIVITY as used in this permit, refers to a discharge of pollutants in storm water from areas where soil disturbing activities (e.g., clearing, grading, grubbing, or excavation), construction materials or equipment storage or maintenance (e.g., stock piles, borrow area, concrete truck chute wash down, fueling) are located. [11 Miss. Admin. Code Pt. 6, R. 1]
T-34	STORM WATER POLLUTION PREVENTION PLAN (SWPPP) means a plan that includes site map(s), an identification of construction/contractor activities that could cause pollutants in the storm water, and a description of measures or practices to control these pollutants. [11 Miss. Admin. Code Pt. 6, R. 1]
T-35	SUBMITTED means the document is postmarked on or before the applicable deadline, except as otherwise specified. [11 Miss. Admin. Code Pt. 6, R. 1]
T-36	SUCCESSFUL COMPLETION OF ALL PERMANENT EROSION AND SEDIMENT CONTROLS means when land disturbing construction activities have been completed and disturbed areas have been stabilized with no significant erosion occurring. [11 Miss. Admin. Code Pt. 6, R. 1]
T-37	TEMPORARY STABILIZATION means practices such as seeding, mulching and erosion control blankets or mats that are used to stabilize exposed areas in which construction activity has been temporarily suspended. [11 Miss. Admin. Code Pt. 6, R. 1]
T-38	TOPSOIL means the top layer of undisturbed soil, consisting of a high percentage of organic matter, which is conducive to plant growth. [11 Miss. Admin. Code Pt. 6, R. 1]
T-39	TOTAL MAXIMUM DAILY LOAD (TMDL) means the maximum daily amount of a pollutant that can enter a water body so that the water body will meet and continue to meet state water quality standards. [11 Miss. Admin. Code Pt. 6, R. 1]
T-40	TURBIDITY is an expression of the optical property that causes light to be scattered and absorbed rather than transmitted with no change in direction of flux level through the sample caused by suspended and colloidal matter such as clay, silt, finely divided organic and inorganic matter and plankton and other microscopic organisms. [11 Miss. Admin. Code Pt. 6, R. 1]
T-41	UPSET means an exceptional incident in which there is unintentional and temporary noncompliance with technology based permit effluent limitations because of factors beyond the reasonable control of the coverage recipient. An upset does not include noncompliance to the extent caused by operational error, improperly

ACT12 (continued):

Narrative Requirements:

Condition No.	Condition
T-42	<p>designed treatment facilities, inadequate treatment facilities, lack of preventive maintenance, or careless or improper operation. [11 Miss. Admin. Code Pt. 6, R. 1]</p> <p>WATERS OF THE STATE means all waters within the jurisdiction of this State, including all streams, lakes, ponds, wetlands, impounding reservoirs, marshes, watercourses, waterways, wells, springs, irrigation systems, drainage systems, and all other bodies or accumulations of water, surface and underground, natural or artificial, situated wholly or partly within or bordering upon the State, and such coastal waters as are within the jurisdiction of the State, except lakes, ponds, or other surface waters which are wholly landlocked and privately owned, and which are not regulated under the Federal Clean Water Act (33 U.S.C.1251 et seq.). [11 Miss. Admin. Code Pt. 6, R. 1]</p>
T-43	<p>11 Miss. Admin. Code Pt. 6, R.1 means the State of Mississippi's Wastewater Regulations for National Pollutant Discharge Elimination System (NPDES) Permits, Underground Injection Control (UIC) Permits, State Permits, Water Quality Based Effluent Limitations and Water Quality Certifications. [11 Miss. Admin. Code Pt. 6, R. 1]</p>

Appendix D – NOI and Acknowledgement Letter from EPA/State

AI: 1631

Rec'd via hard copy:
03/01/2024

MSR10 9219

(NUMBER TO BE ASSIGNED BY STATE)

APPLICANT IS THE: OWNER PRIME CONTRACTOR

OWNER CONTACT INFORMATION

OWNER CONTACT PERSON: Heather Jackson Owens

OWNER COMPANY LEGAL NAME: Georgia Pacific

OWNER STREET OR P.O. BOX: 604 N A Sandifer Hwy

OWNER CITY: Monticello STATE: MS ZIP: 39654

OWNER PHONE #: (706) 468-2701 OWNER EMAIL: heather.owens@gapac.com

PREPARER CONTACT INFORMATION

IF NOI WAS PREPARED BY SOMEONE OTHER THAN THE APPLICANT

CONTACT PERSON: Ken Vogel

COMPANY LEGAL NAME: Wood

STREET OR P.O. BOX: 30 Patewood Drive, Suite 200

CITY: Greenville STATE: SC ZIP: 29615

PHONE # () (843) 458-3600 EMAIL: ken.vogel@woodplc.com

PRIME CONTRACTOR CONTACT INFORMATION

PRIME CONTRACTOR CONTACT PERSON: Cole Smith

PRIME CONTRACTOR COMPANY LEGAL NAME: G.A. West & Co. Inc.

PRIME CONTRACTOR STREET OR P.O. BOX: 1200 Radcliff Road

PRIME CONTRACTOR CITY: Creola STATE: AL ZIP: 36525

PRIME CONTRACTOR PHONE #: (251) 679-1965 PRIME CONTRACTOR EMAIL: cole.smith@gawest.com

FACILITY SITE INFORMATION

FACILITY SITE NAME: GP Monticello

FACILITY SITE ADDRESS (If the physical address is not available, please indicate the nearest named road. For linear projects indicate the beginning of the project and identify all counties the project traverses.)

STREET: 604 N A Sandifer Hwy

CITY: Monticello STATE: MS COUNTY: Lawrence ZIP: 39654

FACILITY SITE TRIBAL LAND ID (N/A If not applicable): N/A

LATITUDE: 31 degrees 37 minutes 27 seconds LONGITUDE: 90 degrees 4 minutes 44 seconds

LAT & LONG DATA SOURCE (GPS (Please GPS Project Entrance/Start Point) or Map Interpolation): Google Earth Pro

TOTAL ACREAGE THAT WILL BE DISTURBED ¹: 16.2

IS THIS PART OF A LARGER COMMON PLAN OF DEVELOPMENT?

YES

NO

IF YES, NAME OF LARGER COMMON PLAN OF DEVELOPMENT:
AND PERMIT COVERAGE NUMBER: MSR10_____

ESTIMATED CONSTRUCTION PROJECT START DATE:

2024-02-28

YYYY-MM-DD

ESTIMATED CONSTRUCTION PROJECT END DATE:

2025-08-20

YYYY-MM-DD

DESCRIPTION OF CONSTRUCTION ACTIVITY: Civil construction with earthwork and paving, installation of a new logline with foundations.

PROPOSED DESCRIPTION OF PROPERTY USE AFTER CONSTRUCTION HAS BEEN COMPLETED:

A new logline within an existing woodyard.

SIC Code: 1629

NAICS Code 23

NEAREST NAMED RECEIVING STREAM: Peart River

IS RECEIVING STREAM ON MISSISSIPPI'S 303(d) LIST OF IMPAIRED WATER BODIES? (The 303(d) list of impaired waters and TMDL stream segments may be found on MDEQ's web site:

YES

NO

http://www.deq.state.ms.us/MDEQ.nsf/page/TWB_Total_Maximum_Daily_Load_Section)

HAS A TMDL BEEN ESTABLISHED FOR THE RECEIVING STREAM SEGMENT?

YES

NO

FOR WHICH POLLUTANT:

ARE THERE RECREATIONAL STREAMS, PRIVATE/PUBLIC PONDS OR LAKES WITHIN 1/2 MILE DOWNSTREAM OF PROJECT BOUNDARY THAT MAY BE IMPACTED BY THE CONSTRUCTION ACTIVITY?

YES

NO

EXISTING DATA DESCRIBING THE SOIL (for linear projects please describe in SWPPP):

Wanta Silt loam and loose to medium dense Clayey Sand (SC) and/or medium stiff sandy clays (CL)

WILL FLOCCULANTS BE USED TO TREAT TURBIDITY IN STORM WATER?

YES

NO

IF YES, INDICATE THE TYPE OF FLOCCULANT.

ANIONIC POLYACRYLAMIDE (PAM)
 OTHER _____

OTHER _____

IF YES, DOES THE SWPPP DESCRIBE THE METHOD OF INTRODUCTION, THE LOCATION OF INTRODUCTION AND THE LOCATION OF WHERE FLOCCULATED MATERIAL WILL SETTLE?

IS A SDS SHEET INCLUDED FOR THE FLOCCULATE?

YES

NO

WILL THERE BE A 50 FT BUFFER BETWEEN THE PROJECT DISTURBANCE AND THE WATERS OF THE STATE?

YES

NO

IF NOT, PROVIDE EQUIVALENT CONTROL MEASURES IN THE SWPPP.

¹Acreage for subdivision development includes areas disturbed by construction of roads, utilities and drainage. Additionally, a housesite of at least 10,000 ft² per lot (entire lot, if smaller) shall be included in calculating acreage disturbed.

DOCUMENTATION OF COMPLIANCE WITH OTHER REGULATIONS/REQUIREMENTS
 COVERAGE UNDER THIS PERMIT WILL NOT BE GRANTED UNTIL ALL OTHER REQUIRED
 MDEQ PERMITS AND APPROVALS ARE SATISFACTORILY ADDRESSED

IS LCNOI FOR A FACILITY THAT WILL REQUIRE OTHER PERMITS?

IF YES, CHECK ALL THAT APPLY: AIR HAZARDOUS WASTE PRETREATMENT WATER STATE OPERATING INDIVIDUAL NPDES OTHER: _____

YES NO

IS THE PROJECT REROUTING, FILLING OR CROSSING A WATER CONVEYANCE OF ANY KIND? (If yes, contact the U.S. Army Corps of Engineers' Regulatory Branch for permitting requirements.) YES NO

IF THE PROJECT REQUIRES A CORPS OF ENGINEER SECTION 404 PERMIT, PROVIDE APPROPRIATE DOCUMENTATION THAT:

- The project has been approved by individual permit, or
- The work will be covered by a nationwide permit and NO NOTIFICATION to the Corps is required, or
- The work will be covered by a nationwide or general permit and NOTIFICATION to the Corps is required

IS THE PROJECT REROUTING, FILLING OR CROSSING A STATE WATER CONVEYANCE OF ANY KIND? (If yes, please provide an antidegradation report.) YES NO

IS A LAKE REQUIRING THE CONSTRUCTION OF A DAM BEING PROPOSED? (If yes, provide appropriate approval documentation from MDEQ Office of Land and Water, Dam Safety.) YES NO

IF THE PROJECT IS A SUBDIVISION OR A COMMERCIAL DEVELOPMENT, HOW WILL SANITARY SEWAGE BE DISPOSED? Check one of the following and attach the pertinent documents.

- Existing Municipal or Commercial System. Please attach plans and specifications for the collection system and the associated "Information Regarding Proposed Wastewater Projects" form or approval from County Utility Authority in Hancock, Harrison, Jackson, Pearl River and Stone Counties. If the plans and specifications can not be provided at the time of LCNOI submittal, MDEQ will accept written acknowledgement from official(s) responsible for wastewater collection and treatment that the flows generated from the proposed project can and will be transported and treated properly. The letter must include the estimated flow.
- Collection and Treatment System will be Constructed. Please attach a copy of the cover of the NPDES discharge permit from MDEQ or indicate the date the application was submitted to MDEQ (Date: _____.)
- Individual Onsite Wastewater Disposal Systems for Subdivisions Less than 35 Lots. Please attach a copy of the Letter of General Acceptance from the Mississippi State Department of Health or certification from a registered professional engineer that the platted lots should support individual onsite wastewater disposal systems.
- Individual Onsite Wastewater Disposal Systems for Subdivisions Greater than 35 Lots. A determination of the feasibility of installing a central sewage collection and treatment system must be made by MDEQ. A copy of the response from MDEQ concerning the feasibility study must be attached. If a central collection and wastewater system is not feasible, then please attach a copy of the Letter of General Acceptance from the State Department of Health or certification from a registered professional engineer that the platted lots should support individual onsite wastewater disposal systems.

INDICATE ANY LOCAL STORM WATER ORDINANCE (I.E. MS4) WITH WHICH THE PROJECT MUST COMPLY:

I certify under penalty of law that this document and all attachments were prepared under my direction or supervision in accordance with a system designed to assure that qualified personnel properly gathered and evaluated the information submitted. Based on my inquiry of the person or persons who manage the system, or those persons directly responsible for gathering the information, the information submitted is, to the best of my knowledge and belief, true, accurate and complete. I am aware that there are significant penalties for submitting false information, including the possibility of fine and imprisonment for knowing violations.

Heather Owens
Signature of Applicant¹ (owner or prime contractor)

2/19/24
Date Signed

Heather Owens
Printed Name¹

Environmental Leader
Title

¹This application shall be signed as follows:

- For a corporation, by a responsible corporate officer.
- For a partnership, by a general partner.
- For a sole proprietorship, by the proprietor.

For a municipal, state or other public facility, by principal executive officer, mayor, or ranking elected official

Please submit the LCNOI form to:

Chief, Environmental Permits Division
MS Department of Environmental Quality, Office of Pollution Control
P.O. Box 2261
Jackson, Mississippi 39225

Electronically:

<https://www.mdeq.ms.gov/construction-stormwater/>

Revised 3/23/22

Appendix E – Inspection Reports

Appendix G – SWPPP Amendment Log

Project Name:
SWPPP Contact:

Amendment No.	Description of the Amendment	Date of Amendment	Amendment Prepared by (Name(s) and Title)

Appendix H – Subcontractor Certifications/Agreements

SUBCONTRACTOR CERTIFICATION STORMWATER POLLUTION PREVENTION PLAN

Project Number: _____

Project Title: _____

Operator(s): _____

As a subcontractor, you are required to comply with the Stormwater Pollution Prevention Plan (SWPPP) for any work that you perform on-site. Any person or group who violates any condition of the SWPPP may be subject to substantial penalties or loss of contract. You are encouraged to advise each of your employees working on this project of the requirements of the SWPPP. A copy of the SWPPP is available for your review at the office trailer.

Each subcontractor engaged in activities at the construction site that could impact stormwater must be identified and sign the following certification statement:

I certify under the penalty of law that I have read and understand the terms and conditions of the SWPPP for the above designated project and agree to follow the BMPs and practices described in the SWPPP.

This certification is hereby signed in reference to the above named project:

Company: _____

Address: _____

Telephone Number: _____

Type of construction service to be provided: _____

Signature: _____

Title: _____

Date: _____

Appendix J – SWPPP Training Log

Stormwater Pollution Prevention Training Log

Project Name: _____

Project Location: _____

Instructor's Name(s): _____

Instructor's Title(s): _____

Course Location: _____ Date: _____

Course Length (hours): _____

Stormwater Training Topic: *(check as appropriate)*

- Erosion Control BMPs Emergency Procedures
 Sediment Control BMPs Good Housekeeping BMPs
 Non-Stormwater BMPs

Specific Training Objective: _____

Attendee Roster: *(attach additional pages as necessary)*

No.	Name of Attendee	Company
1		
2		
3		
4		
5		
6		
7		
8		
9		
10		

Appendix K – Delegation of Authority Form

Delegation of Authority

I, _____ (name), hereby designate the person or specifically described position below to be a duly authorized representative for the purpose of overseeing compliance with environmental requirements, including the EPA's Construction General Permit (CGP), at the _____ construction site. The designee is authorized to sign any reports, stormwater pollution prevention plans and all other documents required by the permit.

_____ (name of person or position)
_____ (company)
_____ (address)
_____ (city, State, zip)
_____ (phone)

By signing this authorization, I confirm that I meet the requirements to make such a designation as set forth in Appendix G of EPA's CGP, and that the designee above meets the definition of a "duly authorized representative" as set forth in Appendix G.

I certify under penalty of law that this document and all attachments were prepared under my direction or supervision in accordance with a system designed to assure that qualified personnel properly gathered and evaluated the information submitted. Based on my inquiry of the person or persons who manage the system, or those persons directly responsible for gathering the information, the information submitted is, to the best of my knowledge and belief, true, accurate, and complete. I have no personal knowledge that the information submitted is other than true, accurate, and complete. I am aware that there are significant penalties for submitting false information, including the possibility of fine and imprisonment for knowing violations.

Name: _____

Company: _____

Title: _____

Signature: _____

Date: _____