

AI: 20596

MSR109410



MISSISSIPPI DEPARTMENT OF
ENVIRONMENTAL QUALITY

RECEIVED
SEP 23 2024
Dept. of Environmental Quality

LARGE CONSTRUCTION NOTICE OF INTENT (LCNOI) FOR COVERAGE UNDER THE LARGE CONSTRUCTION STORM WATER GENERAL NPDES PERMIT

INSTRUCTIONS

The Large Construction Notice of Intent (LCNOI) is for coverage under the Large Construction General Permit for land disturbing activities of five (5) acres or greater; or for land disturbing activities, which are part of a larger common plan of development or sale that are initially less than five (5) acres but will ultimately disturb five (5) or more acres. Applicant must be the owner or operator. For construction activities, the operator is typically the prime contractor. The owner(s) of the property and the prime contractor associated with regulated construction activity on the property have joint and severable responsibility for compliance with the Large Construction Storm Water General Permit MSR10.

If the company seeking coverage is a corporation, a limited liability company, a partnership, or a business trust, attach proof of its registration with the Mississippi Secretary of State and/or its Certificate of Good Standing. This registration or Certificate of Good Standing must be dated within twelve (12) months of the date of the submittal of this coverage form. Coverage will be issued in the company name as it is registered with the Mississippi Secretary of State.

Completed LCNOIs should be filed at least thirty (30) days prior to the commencement of construction. Discharge of storm water from large construction activities without written notification of coverage is a violation of state law.

Submittals with this LCNOI must include:

- A site-specific Storm Water Pollution Prevention Plan (SWPPP) developed in accordance with ACT5 of the General Permit
- A detailed site-specific scaled drawing showing the property layout and the features outlined in ACT5 of the General Permit
- A United States Geological Survey (USGS) quadrangle map or photocopy, extending at least one-half mile beyond the facility property boundaries with the site location and outfalls outlined or highlighted. The name of the quadrangle map must be shown on all copies. Quadrangle maps can be obtained from the MDEQ, Office of Geology at 601-961-5523.

Additional submittals may include the following, if applicable:

- Appropriate Section 404 documentation from U.S. Army Corps of Engineers
- Appropriate documentation concerning future disposal of sanitary sewage and sewage collection system construction
- Appropriate documentation from the MDEQ Office of Land & Water concerning dam construction and low flow requirements
- Approval from County Utility Authority in Hancock, Harrison, Jackson, Pearl River and Stone Counties
- Antidegradation report for disturbance within Waters of the State

ALL QUESTIONS MUST BE ANSWERED (Answer "NA" if the question is not applicable)

O.C

IS THIS PART OF A LARGER COMMON PLAN OF DEVELOPMENT?

YES NO

IF YES, NAME OF LARGER COMMON PLAN OF DEVELOPMENT:
AND PERMIT COVERAGE NUMBER: MSR10

ESTIMATED CONSTRUCTION PROJECT START DATE: *Not a set date* YYYY-MM-DD

ESTIMATED CONSTRUCTION PROJECT END DATE: *at this time* YYYY-MM-DD

DESCRIPTION OF CONSTRUCTION ACTIVITY:

PROPOSED DESCRIPTION OF PROPERTY USE AFTER CONSTRUCTION HAS BEEN COMPLETED:

SIC Code: 0251 NAICS Code 112320

NEAREST NAMED RECEIVING STREAM: Beach Creek (Tributary of Coffee Bogue Creek in Pear/Basin)

IS RECEIVING STREAM ON MISSISSIPPI'S 303(d) LIST OF IMPAIRED WATER BODIES? (The 303(d) list of impaired waters and TMDL stream segments may be found on MDEQ's web site: http://www.deq.state.ms.us/MDEQ.nsf/page/TWB_Total_Maximum_Daily_Load_Section) YES NO

HAS A TMDL BEEN ESTABLISHED FOR THE RECEIVING STREAM SEGMENT? YES NO

FOR WHICH POLLUTANT:

ARE THERE RECREATIONAL STREAMS, PRIVATE/PUBLIC PONDS OR LAKES WITHIN 1/2 MILE DOWNSTREAM OF PROJECT BOUNDARY THAT MAY BE IMPACTED BY THE CONSTRUCTION ACTIVITY? YES NO

EXISTING DATA DESCRIBING THE SOIL (for linear projects please describe in SWPPP):
Soil is Falkner silt loam, 0 to 2 Percent Slopes

WILL FLOCCULANTS BE USED TO TREAT TURBIDITY IN STORM WATER? YES NO

IF YES, INDICATE THE TYPE OF FLOCCULANT. ANIONIC POLYACRYLAMIDE (PAM) OTHER _____

IF YES, DOES THE SWPPP DESCRIBE THE METHOD OF INTRODUCTION, THE LOCATION OF INTRODUCTION AND THE LOCATION OF WHERE FLOCCULATED MATERIAL WILL SETTLE?

IS A SDS SHEET INCLUDED FOR THE FLOCCULATE? YES NO

WILL THERE BE A 50 FT BUFFER BETWEEN THE PROJECT DISTURBANCE AND THE WATERS OF THE STATE? YES NO

IF NOT, PROVIDE EQUIVALENT CONTROL MEASURES IN THE SWPPP.

¹Acreage for subdivision development includes areas disturbed by construction of roads, utilities and drainage. Additionally, a housesite of at least 10,000 ft² per lot (entire lot, if smaller) shall be included in calculating acreage disturbed.

I certify under penalty of law that this document and all attachments were prepared under my direction or supervision in accordance with a system designed to assure that qualified personnel properly gathered and evaluated the information submitted. Based on my inquiry of the person or persons who manage the system, or those persons directly responsible for gathering the information, the information submitted is, to the best of my knowledge and belief, true, accurate and complete. I am aware that there are significant penalties for submitting false information, including the possibility of fine and imprisonment for knowing violations.

Johnny C. Thompson
Signature of Applicant¹ (owner or prime contractor)

09/10/24
Date Signed

Johnny C. Thompson
Printed Name¹

Owner
Title

¹This application shall be signed as follows:

- For a corporation, by a responsible corporate officer.
- For a partnership, by a general partner.
- For a sole proprietorship, by the proprietor.

For a municipal, state or other public facility, by principal executive officer, mayor, or ranking elected official

Please submit the LCNOI form to: **Chief, Environmental Permits Division
MS Department of Environmental Quality, Office of Pollution Control
P.O. Box 2261
Jackson, Mississippi 39225**

Electronically: <https://www.mdeq.ms.gov/construction-stormwater/>

Revised 3/23/22

STORM WATER PLAN

Cos Thompson Farms (Cos or Stephanie Thompson)

September 6, 2024

Broiler Poultry Operation

RECEIVED
SEP 23 2024

Site Location:

The site's Section, Township and Range is: Sec 27, T8N R6E

MDEQ

Site Information

The construction of 3 new broiler poultry houses will disturb 54 feet x 500 feet with 75 feet between with a 40 X 100 compost and loadout area and access road for a total construction acreage of 5.9 acres estimated as disturbed. This site has a MODERATE erosion hazard. Site drainage flows into a tributary of Beach Creek. Practices should be installed for any site discharging to the receiving stream to ensure all sediment stays contained within the construction limits.

Controls

Vegetative Controls: Maintain a 15-foot undisturbed vegetative buffer zone around the perimeter of the site. Preserve existing trees where possible. Seed all diversions with permanent seeding within seven calendar days of construction. Stockpile topsoil for use in landscaping after construction. Construct grass-lined waterways lined with temporary straw or hay in areas of concentrated flow and around buildings. Rough all 3:1 cut slopes by disking prior to seeding. Sod any disturbed intermittent stream bank with Bermuda grass. Bare areas left for thirty days or more require temporary seeding within seven calendar days of disturbance. After final grading, permanently seed all disturbed areas within seven calendar days.

Structural Controls (follow NRCS design for all structural measures): Intermittent streams and larger require 404 authorization prior to construction. Excessive drainage areas or other runoff conditions with excessive water flow within the construction area require sediment traps or silt fence construction. Divert upslope waters around disturbed areas. Cut slopes at or below a 3:1 grade. Build a construction entrance to wash mud from vehicle tires prior to exiting the site during muddy conditions. Construct silt fences at all storm drain inlets and around stockpiled soils.

Housekeeping Practices: Repair and maintain all equipment offsite. Insure proper collection and disposal of trash. Store paints, solvents, fertilizers, or any other potentially toxic materials offsite. Provide sanitary waste facilities for construction workers.

Post Construction/Storm Water Management Measures: Ensure no concentrated flow areas develop after construction that would impact downstream water bodies.

Implementation Sequence

1. build construction entrance/exit and provide wash area for muddy vehicles,
2. install structures for sediment and construct diversions and drainage ways,
3. stockpile topsoil and install silt fences around stockpile,
4. install culverts with inlet/outlet protection,
5. plant needed temporary vegetation on disturbed areas and install silt fences,
6. construct facilities, loading areas, and roads,
7. finish slopes around buildings, roughen slopes and vegetate,
8. after site is stabilized, remove all temporary measures, vegetating these areas.

Maintenance Plan

During Construction: Check all disturbed areas, erosion and sediment controls after each significant rainfall but not less than once per week. Make needed repairs within 24 hours. Remove sediment from basins, inlet protection devices, and silt fences when accumulated sediment has reached 50 percent capacity. Replace nonfunctional silt fences. Maintain all vegetated areas to provide proper ground cover - reseed, fertilize, and mulch as needed.

After Construction: Fertilize and lime vegetation as indicated by soil tests. Update soil tests every 3 years and follow recommendations. Maintain permanent structures including pipes, culverts, diversions, ditches, and drains with proper vegetation management and weed control measures, clearance of debris and other blockages, and critical area stabilization of eroded areas.

Attachments:

Attached are the following documents: Topographic Map, Site Plan, Location Map, Ownership Map

Johnny C. Thompson
Signature Owner/Manager

09/10/24
Date

Date:9/3/2024

Topo Map

Client(s): Cos Thompson Poultry
Assisted By: Joseph Addy
Natural Resources Conservation Service
Forest Service Center
Scott County Soil & Water Conservation District

Location:
-89.6648 32.5125 decimal degrees
1406 New Home Road
Lena, MS 39094

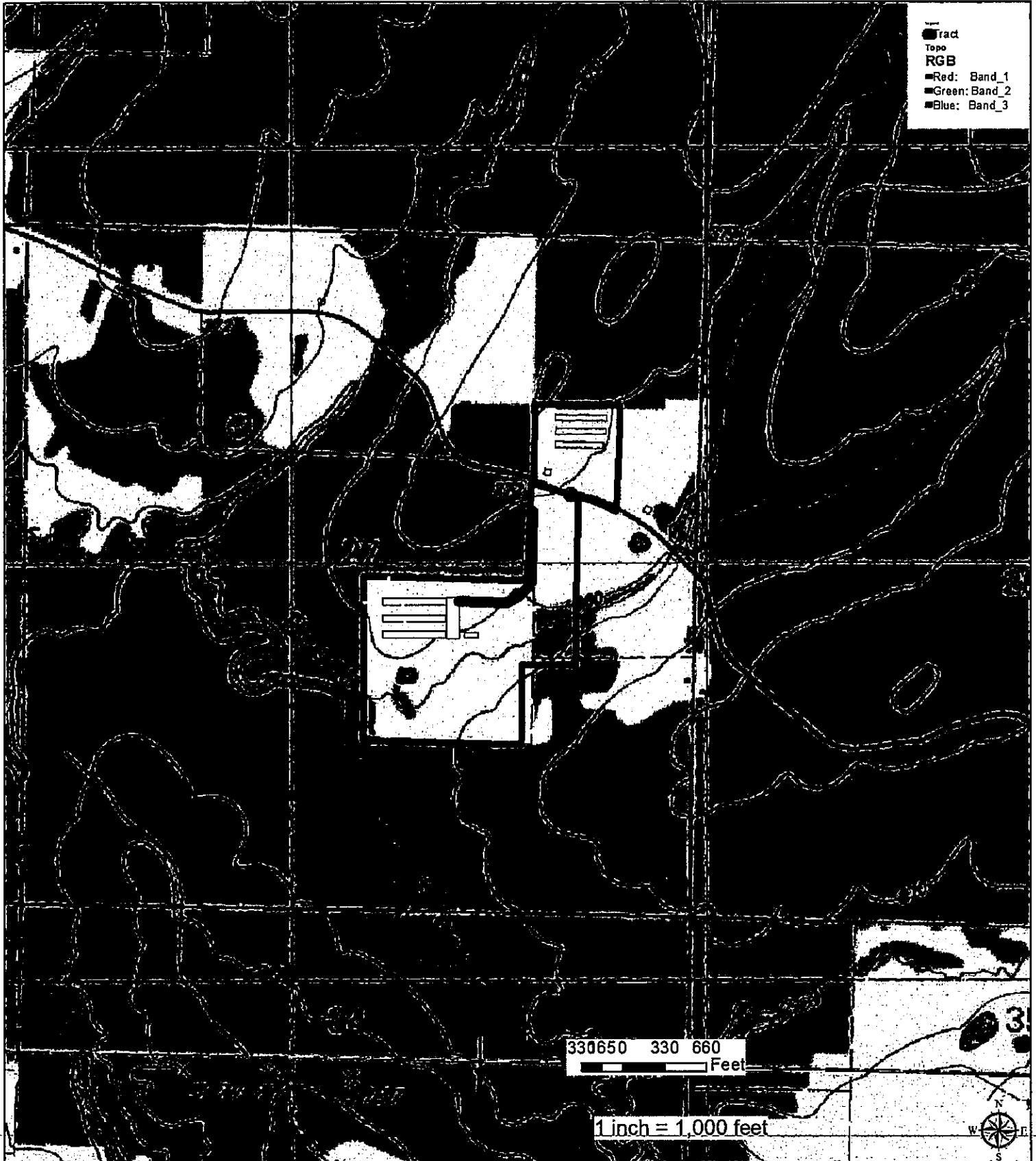

Date: 9/3/2024

Site Map

Client(s): Cos Thompson Poultry
Assisted By: Joseph Addy
Natural Resources Conservation Service
Forest Service Center
Scott County Soil & Water Conservation District

Location:
-89.6648 32.5125 decimal degrees
1406 New Home Road
Lena, MS 39094

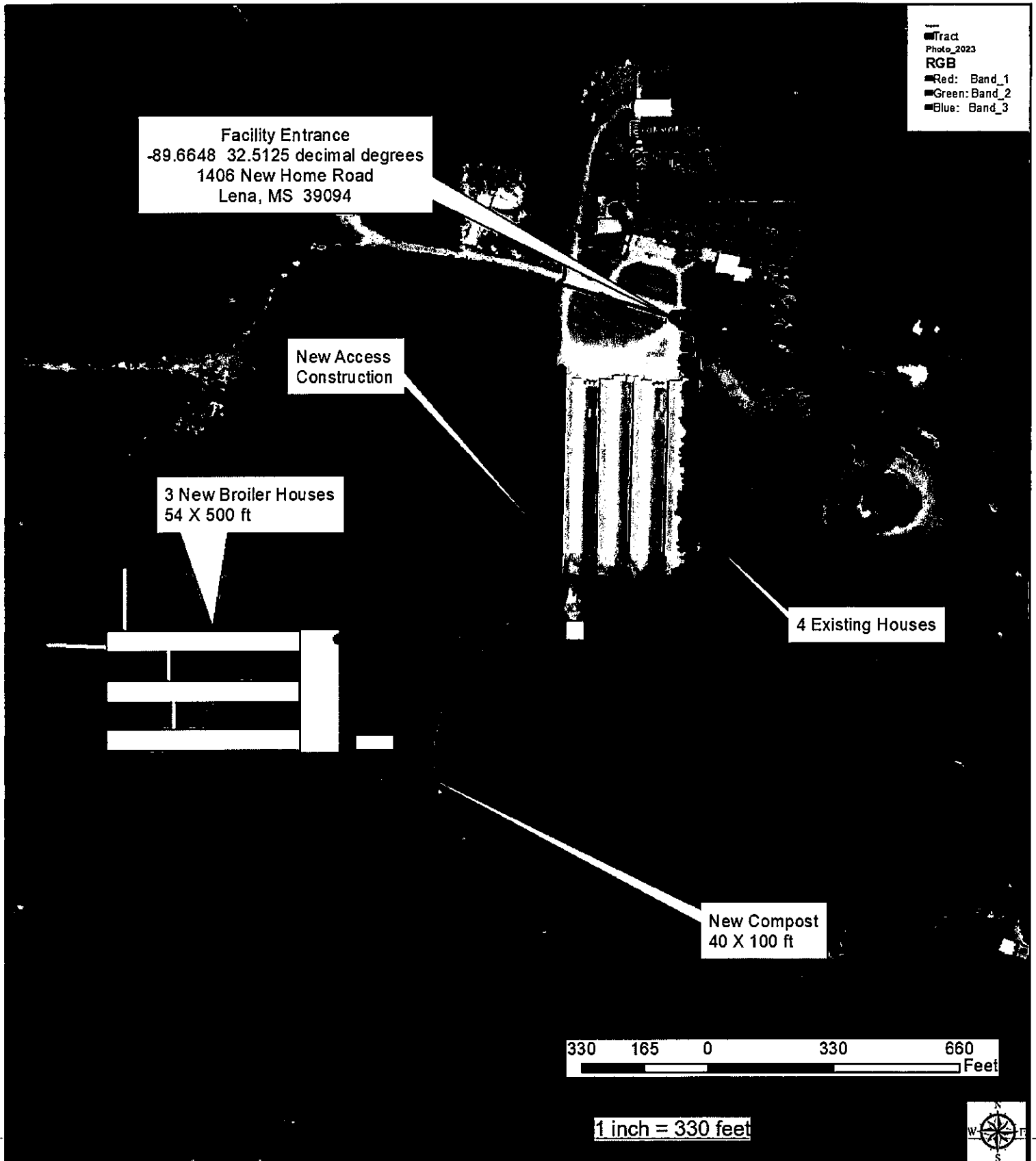

Date:9/3/2024

Client(s): Cos Thompson Poultry
Assisted By: Joseph Addy
Natural Resources Conservation Service
Forest Service Center
Scott County Soil & Water Conservation District

Location Map

Location:
-89.6648 32.5125 decimal degrees
1406 New Home Road
Lena, MS 39094

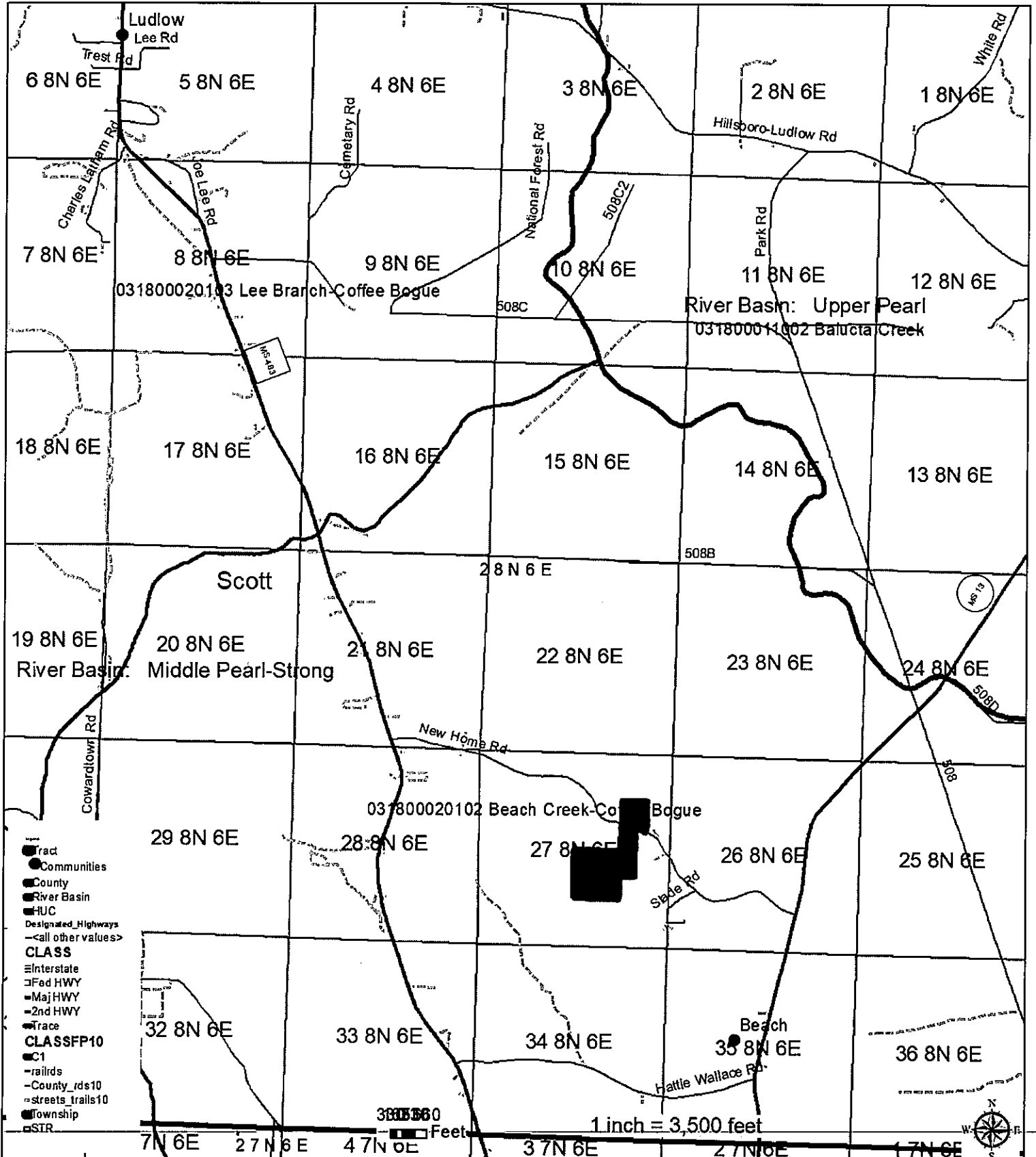

Date:9/3/2024

Ownership Map

Client(s): Cos Thompson Poultry
Assisted By: Joseph Addy
Natural Resources Conservation Service
Forest Service Center
Scott County Soil & Water Conservation District

Location:
-89.6648 32.5125 decimal degrees
1406 New Home Road
Lena, MS 39094

