

MISSISSIPPI ASBESTOS DEMOLITION/RENOVATION NOTIFICATION FORM

Mail notification to: **MDEQ Asbestos and Lead Branch, 515 E. Amite Street, Jackson, MS 39201**

MDEQ Use Only: <input checked="" type="checkbox"/> Email <input type="checkbox"/> Mail <input type="checkbox"/> Hand Delivery		Postmark (mail only)	Date Received 2/3/2025	AI Number 86080
I. Type of Notification (O=Original R=Revised C=Canceled A= Annual) R				
II. TYPE OF OPERATION (D=Demo O= Ordered Demo R=Renovation E=Emer. Renovation) R				
III. FACILITY DESCRIPTION (Include building name, number and floor or room number)				
Bldg. Name: Community Park Apartments				
Address: 120 Gillis Circle				
City: McComb	State: MS	Zip: 39648	County: Pike	
Site Location: Multiple Buildings (APT's)		Tel: 662 773-8132		
Building Size: Appr. 10,000 per bldg (24 bldgs)	# of Floors: 2	Age in Years: 40+		
Present Use: Apt's	Prior Use: Apt's			
IV. FACILITY INFORMATION (Identify owner, asbestos removal contractor, and other operator)				
OWNER NAME: Hughes Spelling Dev.				
Address: 214 W. Jackson St.				
City: Ridgeland	State: MS	Zip: 39157		
Contact: David Roark	Tel: (662) 769-7000			
ASBESTOS REMOVAL CONTRACTOR: EMP Alfred Martin				
Address: PO BOX 9361				
City: Jackson	State: MS	Zip: 39286		
Contact: Alfred Martin	Tel: 601 922-1919			
Certification Number: ABC 1568	Expiration Date: 3.15.25			
OTHER OPERATOR: <i>Southern Land mgnt</i>				
Address: <i>136 Auburn Ave</i>				
City: <i>Natchez</i>	State: <i>MS</i>	Zip: <i>39120</i>		
Contact: <i>Jody Foster</i>	Tel: <i>601 807-1960</i>			
V. WAS SITE INSPECTED TO DETERMINE PRESENCE OF ASBESTOS? (Yes/No): Y				
WAS ASBESTOS PRESENT? (Yes/No): Y			Inspection Date: 6/29/23	
Inspector: Brady Smith	Certification Number: 11069	Expiration Date: 9/15/24		
VI. SUSPECT MATERIALS SAMPLED AND PROCEDURES USED TO DETECT THE PRESENCE OF ASBESTOS MATERIAL:				
PLM - FT, Mastic, Putty, Wall Board (gypsum), textured ceiling, rood shingles,				
VII. QUANTITY OF RACM TO BE REMOVED:				
Pipes (LN FT):	Surface Area (SQ FT): <i>120,000 sf</i>	Volume of Facility Components (CU FT):		
VIII. QUANTITY OF NONFRIABLE ASBESTOS NOT REMOVED:				
Category I:		Category II:		
IX. SCHEDULED DATES ASBESTOS REMOVAL (MM/DD/YY) Start: 2.17.25			Complete: 5.31.25	
X. SCHEDULED DATES DEMO/RENOVATION (MM/DD/YY) Start: 2.17.25			Complete: 1.31.26	

XI. DESCRIPTION OF PLANNED DEMOLITION OR RENOVATION WORK, AND METHOD(S) TO BE USED:

The interior of the building will be demolished followed by renovations.

XII. DESCRIPTION OF WORK PRACTICES AND ENGINEERING CONTROLS TO BE USED TO PREVENT EMISSIONS OF ASBESTOS AT THE DEMOLITION OR RENOVATION SITE:

Contain area. Critical barriers. Wet method demo. Proper disposal.

XIII. WASTE TRANSPORTER #1

Name: Waste Management

Address: 29340 Woodside Dr.

City: Walker

State: LA

Zip: 70785

Contact Person: Michael J Eidt

Tel: 662 448-0773

WASTE TRANSPORTER #2

Name:

Address:

City:

State:

Zip:

Contact Person:

Tel:

XIV. WASTE DISPOSAL SITE

Name: Woodfield Landfill

Address: 29340 WoodsideDr

City: Walker

State: LA

Zip: 70785

Contact Person: Tabby

Tel: 866 909-4458

XV. IF DEMOLITION ORDERED BY A GOVERNMENT AGENCY, PLEASE IDENTIFY THE AGENCY BELOW:

Name:

Title:

Authority:

Date of Order (MM/DD/YY):

Date Ordered to Begin (MM/DD/YY):

XVI. FOR EMERGENCY RENOVATIONS:

Date and Hour of Emergency (MM/DD/YY):

Description of the sudden unexpected event:

Explanation of how the event caused unsafe conditions or would cause equipment damage or an unreasonable financial burden:

XVII. DESCRIPTION OF PROCEDURES TO BE FOLLOWED IN THE EVENT THAT UNEXPECTED ASBESTOS IS FOUND OR PREVIOUSLY NONFRIABLE ASBESTOS MATERIAL BECOMES CRUMBLED, PULVERIZED, OR REDUCED TO POWDER:

Work stopped to further inspect.

XVIII. I CERTIFY THAT AN INDIVIDUAL TRAINED IN THE PROVISIONS OF THIS REGULATION (40 CFR PART 61, SUBPART M) WILL BE ONSITE DURING THE DEMOLITION OR RENOVATION, AND EVIDENCE THAT THE REQUIRED TRAINING HAS BEEN ACCOMPLISHED BY THIS PERSON WILL BE AVAILABLE FOR INSPECTION DURING NORMAL BUSINESS HOURS.

Alfred Martin, Phd.

Type or Print Name

(Signature of Owner/Operator)

1.31.25

(Date)

XIX. I CERTIFY THAT THE ABOVE INFORMATION IS CORRECT:

Alfred Marti, Phd.

Type or Print Name

(Signature of Owner/Operator)

1.31.25

(Date)



June 29, 2023

Mr. Adam Vaughan
Hughes Spellings, LLC
214 West Jackson Street
Ridgeland, MS 39157

via email: adam@hughesspellings.com

**RE: Asbestos Inspection Services
Community Apartments
120 Gillis Circle
McComb, Mississippi**

Dear Mr. Vaughn,

You have requested our services with respect to the presence of Asbestos-Containing Materials (ACMs) at the above-referenced property. As such, Mr. Willie Nester, Mr. Marty Cooke, and Mr. Taylor Walker with Pickering conducted a limited site inspection on June 20, 2023, and June 21, 2023, which included the collection and analysis of building materials suspected to contain asbestos. Areas scheduled for renovation were visually inspected and samples were collected from apartment buildings.

The Community Apartments are comprised of twenty-four multi-tenant buildings with 57, including an office/ laundry building. One hundred and twenty (120) homogeneous areas were identified during the inspection. Three representative samples from each homogeneous area were taken.

Following our site inspection and sample collection activity, seventeen (17) homogeneous materials were identified as ACMs. This conclusion is based on the Environmental Protection Agency's (EPA) definition of an ACM as a material composed of "...greater than 1% asbestos." The ACMs identified are further detailed in the attached report and below.

- Off White Floor Tile Homogenous Area (HA) (CPA-07)
- Exterior Building Putty Homogenous Area (HA) (CPA-11)
- 12" Beige Floor Tile and Adhesive Homogenous Area (HA) (CPA-12)
- 12" 3rd Layer Flooring Homogenous Area (HA) (CPA-20)
- 12" White Floor Tile and Adhesive Homogenous Area (HA) (CPA-21)
- Exterior Building Putty Homogenous Area (HA) (CPA-24)
- 12" Tan Striped Floor Tile and Adhesive Homogenous Area (HA) (CPA-37)
- Exterior Building Putty Homogenous Area (HA) (CPA-42)
- 12" White Floor Tile Adhesive Homogenous Area (HA) (CPA-54)
- 12" Beige Floor Tile and Adhesive Homogenous Area (HA) (CPA-58)
- 12" Beige Floor Tile Adhesive Homogenous Area (HA) (CPA-67)
- 12" Beige Floor Tile Adhesive Homogenous Area (HA) (CPA-72)
- 12" Beige Floor Tile and Adhesive Homogenous Area (HA) (CPA-78)
- 12" Beige Floor Tile and Adhesive Homogenous Area (HA) (CPA-83)

Mr. Jeff Davis
DCSD- District Office Main Building Boiler
October 4, 2021
Page 2 of 19

- 12" Floor Tile and Adhesive Homogenous Area (HA) (CPA-98)

Please find attached a detailed report of findings that includes a list of suspect materials identified, a sample location drawing, analytical results, and my inspector certificate. Should you have any questions concerning this report, please do not hesitate to contact me.

Sincerely,
PICKERING FIRM, INC.

A handwritten signature in blue ink, appearing to read "Brady Smith", with a long horizontal flourish extending to the right.

Brady Smith
Environmental Scientist

Enclosure
Cc: File 25745.02

**ASBESTOS-CONTAINING MATERIALS
INSPECTION REPORT**

**COMMUNITY APARTMENTS
120 GILLIS CIRCLE
McCOMB, MISSISSIPPI 39648**



PREPARED FOR:

**HUGHES SPELLING, LLC
214 WEST JACKSON STREET
RIDGELAND, MISSISSIPPI 39157**

PREPARED BY:

**PICKERING FIRM, INC.
2001 AIRPORT ROAD
SUITE 201
FLOWOOD, MISSISSIPPI 39232**



**June 29, 2023
Pickering Project No. 25745.02**

Table of Contents

1.0 EXECUTIVE SUMMARY	1
2.0 FINDINGS.....	1
3.0 RECOMMENDATIONS	2
4.0 APPENDICES	
Appendix 4.1 Analytical Results	
Appendix 4.2 Site Plan Figure	
Appendix 4.3 Mississippi Asbestos Inspector Certification	

1.0 EXECUTIVE SUMMARY

This inspection was conducted on June 20, 2023, and June 21, 2023, to identify Asbestos-Containing Materials (ACM) that will be affected during an upcoming renovation project. This report describes the inspection tasks and presents our findings and recommendations.

The Community Apartments are located at 120 Gillis Circle in McComb, Mississippi. Twenty-four multi-tenant apartment buildings and the office/laundry building were included in the ACM survey. The site plan is shown in Appendix 4.2, Site Plan Figure.

Prior to the initial walk-through inspection of the facility, special precautions and security/access requirements were coordinated with Mr. Adam Vaughan of Hughes Spelling, LLC. At the time of the inspection, all areas planned for renovation in the facility were accessible and were visually inspected.

During our inspection, areas to be renovated were visually inspected and the locations of suspected ACMs were noted. After suspect materials were identified, a minimum of two (2) samples of each homogeneous material were collected for analysis. The samples were subsequently labeled and submitted to an accredited laboratory for asbestos analysis by Polarized Light Microscopy (PLM).

2.0 FINDINGS

During the asbestos survey, a total of one hundred and twenty (120) building materials identified as homogeneous areas (HA) were sampled. These samples were sent to an accredited laboratory and analyzed for asbestos content. According to the analytical results, seventeen (17) homogeneous asbestos-containing materials were identified. This conclusion is based on the Environmental Protection Agency (EPA) definition of an ACM as a material composed of "...greater than 1% asbestos." The ACMs identified are as follows:

Building 3

- **Off White Floor Tile and Adhesive Homogenous Area (HA) (CPA-07)** - This material is located on the floors within Building 3. Laboratory analysis revealed that these materials contain approximately 2% and 2% chrysotile asbestos, respectively. This material is classified as Category I, non-friable ACM according to National Emission Standard for Hazardous Air Pollutants (NESHAP) regulations.
- **Exterior Building Putty Homogenous Area (HA) (CPA-11)** - This material is located on the exterior of Building 3. Laboratory analysis revealed that these materials contain approximately 2% chrysotile asbestos, respectively. This material is classified as Category I, non-friable ACM according to National Emission Standard for Hazardous Air Pollutants (NESHAP) regulations.

Building 5

- **12" Beige Floor Tile and Adhesive Homogenous Area (HA) (CPA-12)** - This material is located on the floors within Building 5. Laboratory analysis revealed that these materials contain approximately 3% and 2% chrysotile asbestos, respectively. This material is classified as Category I, non-friable ACM according to National Emission Standard for Hazardous Air Pollutants (NESHAP) regulations.
- **12" 3rd Layer Floor Tile Homogenous Area (HA) (CPA-20)** - This material is located underneath the 2nd layer floors within Building 5. Laboratory analysis revealed that these materials contain approximately 2% chrysotile asbestos, respectively. This material is classified as Category I, non-friable ACM according to National Emission Standard for Hazardous Air Pollutants (NESHAP) regulations.

Building 6

- **12" White Floor Tile and Adhesive Homogenous Area (HA) (CPA-21)** - This material is located on the floors within Building 6. Laboratory analysis revealed that these materials contain approximately 2% and 2% chrysotile asbestos, respectively. This material is classified as Category I, non-friable ACM according to National Emission Standard for Hazardous Air Pollutants (NESHAP) regulations.
- **Exterior Building Putty Homogenous Area (HA) (CPA-24)** - This material is located on the

exterior of Building 6. Laboratory analysis revealed that these materials contain approximately 2% chrysotile asbestos, respectively. This material is classified as Category I, non-friable ACM according to National Emission Standard for Hazardous Air Pollutants (NESHAP) regulations.

Building 8

- **12" Tan Striped Floor Tile and Adhesive Homogenous Area (HA) (CPA-37)** - This material is located on the floors within Building 8. Laboratory analysis revealed that these materials contain approximately 2% and 2% chrysotile asbestos, respectively. This material is classified as Category I, non-friable ACM according to National Emission Standard for Hazardous Air Pollutants (NESHAP) regulations.

Building 9

- **Exterior Building Putty Homogenous Area (HA) (CPA-42)** - This material is located on the exterior of Building 9. Laboratory analysis revealed that these materials contain approximately 2% chrysotile asbestos, respectively. This material is classified as Category I, non-friable ACM according to National Emission Standard for Hazardous Air Pollutants (NESHAP) regulations.

Building 12

- **12" White Floor Tile Adhesive Homogenous Area (HA) (CPA-54)** - This material is located on the floors within Building 12. Laboratory analysis revealed that these materials contain approximately 2% chrysotile asbestos, respectively. This material is classified as Category I, non-friable ACM according to National Emission Standard for Hazardous Air Pollutants (NESHAP) regulations.

Building 13

- **12" Beige Floor Tile and Adhesive Homogenous Area (HA) (CPA-58)** - This material is located on the floors within Building 13. Laboratory analysis revealed that these materials contain approximately 2% and 2% chrysotile asbestos, respectively. This material is classified as Category I, non-friable ACM according to National Emission Standard for

Hazardous Air Pollutants (NESHAP) regulations.

Building 15

- **12" Beige Floor Tile Homogenous Area (HA) (CPA-67)** - This material is located on the floors within Building 15. Laboratory analysis revealed that these materials contain approximately 2% chrysotile asbestos, respectively. This material is classified as Category I, non-friable ACM according to National Emission Standard for Hazardous Air Pollutants (NESHAP) regulations.

Building 16

- **12" Beige Floor Tile Adhesive Homogenous Area (HA) (CPA-72)** - This material is located on the floors within Building 16. Laboratory analysis revealed that these materials contain approximately 2% chrysotile asbestos, respectively. This material is classified as Category I, non-friable ACM according to National Emission Standard for Hazardous Air Pollutants (NESHAP) regulations.

Building 17

- **12" Beige Floor Tile and Adhesive Homogenous Area (HA) (CPA-78)** - This material is located on the floors within Building 17. Laboratory analysis revealed that these materials contain approximately 2% and 2% chrysotile asbestos, respectively. This material is classified as Category I, non-friable ACM according to National Emission Standard for Hazardous Air Pollutants (NESHAP) regulations.

Building 19

- **12" Beige Floor Tile and Adhesive Homogenous Area (HA) (CPA-83)** - This material is located on the floors within Building 19. Laboratory analysis revealed that these materials contain approximately 2% and 2% chrysotile asbestos, respectively. This material is classified as Category I, non-friable ACM according to National Emission Standard for Hazardous Air Pollutants (NESHAP) regulations.

Building 21

- **12" Floor Tile Adhesive Homogenous Area (HA) (CPA-93)** - This material is located on the floors within Building 21. Laboratory analysis revealed that these materials contain approximately 2% chrysotile asbestos, respectively. This material is classified as Category I, non-friable ACM according to National Emission Standard for Hazardous Air Pollutants (NESHAP) regulations.

Building 22

- **12" Floor Tile and Adhesive Homogenous Area (HA) (CPA-98)** - This material is located on the floors within Building 22. Laboratory analysis revealed that these materials contain approximately 2% and 2% chrysotile asbestos, respectively. This material is classified as Category I, non-friable ACM according to National Emission Standard for Hazardous Air Pollutants (NESHAP) regulations.

During the asbestos survey, a total of one hundred and twenty (120) building materials identified as homogeneous areas (HA) were sampled. These samples were sent to an accredited laboratory and analyzed for asbestos content. According to the analytical results, one hundred and three (13) homogeneous non-asbestos-containing materials were identified. This conclusion is based on the Environmental Protection Agency (EPA) definition of an ACM as a material composed of "...no asbestos or less than 1% asbestos." The non-ACMs materials identified are as follows:

Building 1

- Beige Floor Tile and Adhesive Homogenous Area (HA) (CPA-01)
- Brown Cove Base and Adhesive Homogenous Area (HA) (CPA-02)
- Gypsum Wall Board and Joint Compound Homogeneous Area (HA) (CPA-03)
- Textured Ceiling Homogenous Area (HA) (CPA-04)
- Exterior Building Putty Homogenous Area (HA) (CPA-05)
- Roof Shingle and Felt Homogenous Area (HA) (CPA-06)

Building 3

- Brown Cove Base and Adhesive Homogenous Area (HA) (CPA-08)
- Gypsum Wall Board and Joint Compound Homogeneous Area (HA) (CPA-09)

- Textured Ceiling Homogenous Area (HA) (CPA-10)
- Roof Shingle and Felt Homogenous Area (HA) (CPA-06)

Building 5

- 12" White Floor and Adhesive Homogenous Area (HA) (CPA-13)
- Brown Cove Base and Adhesive Homogenous Area (HA) (CPA-14)
- Overlaid 12" Tan Floor and Adhesive Homogenous Area (HA) (CPA-15)
- 12" White Floor and Adhesive Homogenous Area (HA) (CPA-16)
- Gypsum Wall Board and Joint Compound Homogeneous Area (HA) (CPA-17)
- Textured Ceiling Homogenous Area (HA) (CPA-18)
- Exterior Building Putty Homogenous Area (HA) (CPA-19)
- Roof Shingle and Felt Homogenous Area (HA) (CPA-06)

Building 6

- Gypsum Wall Board and Joint Compound Homogeneous Area (HA) (CPA-22)
- Textured Ceiling Homogenous Area (HA) (CPA-23)
- Roof Shingle and Felt Homogenous Area (HA) (CPA-06)

Building 7

- 12" Beige Floor Tile and Adhesive Homogenous Area (HA) (CPA-25)
- Overlaid 12" White Floor and Adhesive Homogenous Area (HA) (CPA-26)
- Gypsum Wall Board and Joint Compound Homogeneous Area (HA) (CPA-27)
- Brown Cove Base and Adhesive Homogenous Area (HA) (CPA-28)
- Textured Ceiling Homogenous Area (HA) (CPA-29)
- Exterior Building Putty Homogenous Area (HA) (CPA-30)
- Roof Shingle and Felt Homogenous Area (HA) (CPA-06)

Building 8

- 12" White Floor Tile and Adhesive Homogenous Area (HA) (CPA-31)
- Beige Linoleum and Adhesive Homogenous Area (HA) (CPA-32)
- Brown Cove Base and Adhesive Homogenous Area (HA) (CPA-33)

- Textured Ceiling Homogenous Area (HA) (CPA-34)
- Gypsum Wall Board and Joint Compound Homogeneous Area (HA) (CPA-35)
- Exterior Building Putty Homogenous Area (HA) (CPA-36)
- Roof Shingle and Felt Homogenous Area (HA) (CPA-06)

Building 9

- 12" Beige Floor Tile and Adhesive Homogenous Area (HA) (CPA-38)
- Brown Cove Base and Adhesive Homogenous Area (HA) (CPA-39)
- Gypsum Wall Board and Joint Compound Homogeneous Area (HA) (CPA-40)
- Textured Ceiling Homogenous Area (HA) (CPA-41)
- Roof Shingle and Felt Homogenous Area (HA) (CPA-06)

Building 10

- 12" White Floor Tile and Adhesive Homogenous Area (HA) (CPA-43)
- Gypsum Wall Board and Joint Compound Homogeneous Area (HA) (CPA-44)
- Textured Ceiling Homogenous Area (HA) (CPA-45)
- Beige Linoleum and Adhesive Homogenous Area (HA) (CPA-46)
- Exterior Building Putty Homogenous Area (HA) (CPA-47)
- Roof Shingle and Felt Homogenous Area (HA) (CPA-06)

Building 11

- Gypsum Wall Board and Joint Compound Homogeneous Area (HA) (CPA-48)
- 12" Beige Floor Tile and Adhesive Homogenous Area (HA) (CPA-49)
- 12" Beige Floor Tile and Adhesive Homogenous Area (HA) (CPA-50)
- Brown Cove Base and Adhesive Homogenous Area (HA) (CPA-51)
- Textured Ceiling Homogenous Area (HA) (CPA-52)
- Exterior Building Putty Homogenous Area (HA) (CPA-53)
- Roof Shingle and Felt Homogenous Area (HA) (CPA-06)

Building 12

- Gypsum Wall Board and Joint Compound Homogeneous Area (HA) (CPA-55)
- Textured Ceiling Homogenous Area (HA) (CPA-56)
- Exterior Building Putty Homogenous Area (HA) (CPA-57)
- Roof Shingle and Felt Homogenous Area (HA) (CPA-06)

Building 13

- Brown Cove Base and Adhesive Homogenous Area (HA) (CPA-59)
- Gypsum Wall Board and Joint Compound Homogeneous Area (HA) (CPA-60)
- Textured Ceiling Homogenous Area (HA) (CPA-61)
- Exterior Building Putty Homogenous Area (HA) (CPA-62)
- Roof Shingle and Felt Homogenous Area (HA) (CPA-06)

Building 14

- 12" White Floor Tile and Adhesive Homogenous Area (HA) (CPA-63)
- Gypsum Wall Board and Joint Compound Homogeneous Area (HA) (CPA-64)
- Textured Ceiling Homogenous Area (HA) (CPA-65)
- Exterior Building Putty Homogenous Area (HA) (CPA-66)
- Roof Shingle and Felt Homogenous Area (HA) (CPA-06)

Building 15

- Brown Cove Base and Adhesive Homogenous Area (HA) (CPA-68)
- Gypsum Wall Board and Joint Compound Homogeneous Area (HA) (CPA-69)
- Textured Ceiling Homogenous Area (HA) (CPA-70)
- Exterior Building Putty Homogenous Area (HA) (CPA-71)
- Roof Shingle and Felt Homogenous Area (HA) (CPA-06)

Building 16

- 12" Beige Floor Tile and Adhesive Homogenous Area (HA) (CPA-72)
- 12" White Floor Tile and Adhesive Homogenous Area (HA) (CPA-73)
- Gypsum Wall Board and Joint Compound Homogeneous Area (HA) (CPA-74)

- Brown Cove Base and Adhesive Homogenous Area (HA) (CPA-75)
- Textured Ceiling Homogenous Area (HA) (CPA-76)
- Exterior Building Putty Homogenous Area (HA) (CPA-77)
- Roof Shingle and Felt Homogenous Area (HA) (CPA-06)

Building 17

- 12" Beige Floor Tile and Adhesive Homogenous Area (HA) (CPA-78)
- Gypsum Wall Board and Joint Compound Homogeneous Area (HA) (CPA-80)
- Brown Cove Base and Adhesive Homogenous Area (HA) (CPA-79)
- Textured Ceiling Homogenous Area (HA) (CPA-81)
- Exterior Building Putty Homogenous Area (HA) (CPA-82)
- Roof Shingle and Felt Homogenous Area (HA) (CPA-06)

Building 19

- Gypsum Wall Board and Joint Compound Homogeneous Area (HA) (CPA-85)
- Brown Cove Base and Adhesive Homogenous Area (HA) (CPA-84)
- Textured Ceiling Homogenous Area (HA) (CPA-86)
- Exterior Building Putty Homogenous Area (HA) (CPA-87)
- Roof Shingle and Felt Homogenous Area (HA) (CPA-06)

Building 20

- 12" Tan Floor Tile and Adhesive Homogenous Area (HA) (CPA-88)
- Gypsum Wall Board and Joint Compound Homogeneous Area (HA) (CPA-91)
- Brown Cove Base and Adhesive Homogenous Area (HA) (CPA-90)
- Textured Ceiling Homogenous Area (HA) (CPA-89)
- Exterior Window Caulk Homogenous Area (HA) (CPA-92)
- Roof Shingle and Felt Homogenous Area (HA) (CPA-06)

Building 21

- Gypsum Wall Board and Joint Compound Homogeneous Area (HA) (CPA-96)
- Brown Cove Base and Adhesive Homogenous Area (HA) (CPA-95)

- Textured Ceiling Homogenous Area (HA) (CPA-94)
- Exterior Building Putty Homogenous Area (HA) (CPA-97)
- Roof Shingle and Felt Homogenous Area (HA) (CPA-06)

Building 22

- Gypsum Wall Board and Joint Compound Homogeneous Area (HA) (CPA-100)
- Brown Cove Base and Adhesive Homogenous Area (HA) (CPA-101)
- Textured Ceiling Homogenous Area (HA) (CPA-99)
- Exterior Building Putty Homogenous Area (HA) (CPA-102)
- Roof Shingle and Felt Homogenous Area (HA) (CPA-06)

Building 23

- 12" Tan Floor Tile and Adhesive Homogenous Area (HA) (CPA-103)
- Gypsum Wall Board and Joint Compound Homogeneous Area (HA) (CPA-104)
- Textured Ceiling Homogenous Area (HA) (CPA-105)
- Exterior Building Putty Homogenous Area (HA) (CPA-106)
- Roof Shingle and Felt Homogenous Area (HA) (CPA-06)

Building 24

- 12" Tan 1st Layer Floor Tile and Adhesive Homogenous Area (HA) (CPA-107)
- 12" Tan 2nd Layer Floor Tile and Adhesive Homogenous Area (HA) (CPA-108)
- Gypsum Wall Board and Joint Compound Homogeneous Area (HA) (CPA-110)
- Textured Ceiling Homogenous Area (HA) (CPA-109)
- Brown Cove Base and Adhesive Homogenous Area (HA) (CPA-111)
- Roof Shingle and Felt Homogenous Area (HA) (CPA-06)

Laundry

- Gypsum Wall Board and Joint Compound Homogeneous Area (HA) (CPA-113)
- Textured Ceiling Homogenous Area (HA) (CPA-114)
- Exterior Building Putty Homogenous Area (HA) (CPA-112)

Office

- 12" Tan 1st Layer Floor Tile and Adhesive Homogenous Area (HA) (CPA-117)
- 12" Tan 2nd Layer Floor Tile and Adhesive Homogenous Area (HA) (CPA-118)
- Textured Ceiling Homogenous Area (HA) (CPA-119)
- Exterior Building Putty Homogenous Area (HA) (CPA-120)

This inspection was performed by an inspector who is currently in good standing and is certified by the State of Mississippi to perform asbestos inspections. This documentation is included in Appendix 4.3 - Inspector Certifications.

3.0 RECOMMENDATIONS

Considering these findings, NESHAP Regulations 40 CFR 61, Subpart M, requires the removal of ACM before any renovation or demolition takes place that will disturb those materials and render them friable. Therefore, any future expansion, demolition, or renovation activities at the facility that would impact any of these ACMs should follow the NESHAP regulations. Also, it is recommended that the removal work be designed by a certified asbestos project designer and that air monitoring be conducted before, during, and after the abatement activity. A renovation project of this type will also require a written notification to be submitted to the Mississippi Department of Environmental Quality (MDEQ) ten (10) days prior to the beginning of the project.

4.0 APPENDICES

APPENDIX 4.1
Analytical Results



EMSL Analytical, Inc.

200 Route 130 North Cinnaminson, NJ 08077
Tel/Fax: (800) 220-3675 / (856) 786-5974
http://www.EMSL.com / cinnasblab@EMSL.com

EMSL Order: 042314918
Customer ID: POWE54
Customer PO: 20354
Project ID:

Attention: Willie Nester
Pickering Firm, Inc.
2001 Airport Road
Suite 201
Flowood, MS 39232
Project: 25745.02 (25745.02) T001 / Community Park Apts. Asbestos Inspection (Community Park Apt.)

Phone: (601) 259-6671
Fax: (601) 956-7817
Received Date: 06/22/2023 9:25 AM
Analysis Date: 06/26/2023 - 06/28/2023
Collected Date: 06/21/2023

Test Report: Asbestos Analysis of Bulk Materials via AHERA Method 40CFR 763 Subpart E Appendix E supplemented with EPA 600/R-93/116 using Polarized Light Microscopy

Sample	Description	Appearance	Non-Asbestos		Asbestos
			% Fibrous	% Non-Fibrous	% Type
CPA-01-01-Floor Tile 042314918-0001	Beige Floor Tile	Beige Non-Fibrous Homogeneous		100% Non-fibrous (Other)	None Detected
CPA-01-01-Adhesive 042314918-0001A	Adhesive	Brown/Tan Non-Fibrous Homogeneous		100% Non-fibrous (Other)	None Detected
CPA-01-02-Floor Tile 042314918-0002	Beige Floor Tile	Beige Non-Fibrous Homogeneous		100% Non-fibrous (Other)	None Detected
CPA-01-02-Adhesive 042314918-0002A	Adhesive	Tan Non-Fibrous Homogeneous		100% Non-fibrous (Other)	None Detected
CPA-02-01-Cove Base 042314918-0003	Brown Cove Base	Black Non-Fibrous Homogeneous		100% Non-fibrous (Other)	None Detected
CPA-02-01-Adhesive 042314918-0003A	Adhesive	Brown/Tan Non-Fibrous Homogeneous		100% Non-fibrous (Other)	None Detected
CPA-02-02-Cove Base 042314918-0004	Brown Cove Base	Black Non-Fibrous Homogeneous		100% Non-fibrous (Other)	None Detected
CPA-02-02-Adhesive 042314918-0004A	Adhesive	Tan Non-Fibrous Homogeneous		100% Non-fibrous (Other)	None Detected
CPA-03-01-Gypsum Board 042314918-0005	Wall - Gypsum Board	Brown/White Fibrous Heterogeneous	20% Cellulose	70% Gypsum 10% Non-fibrous (Other)	None Detected
CPA-03-01-Joint Compound 042314918-0005A	Wall - Joint Compound	White Non-Fibrous Homogeneous		100% Non-fibrous (Other)	None Detected
CPA-03-02-Gypsum Board 042314918-0006	Wall - Gypsum Board	Brown/White Fibrous Heterogeneous	20% Cellulose 2% Glass	70% Gypsum 8% Non-fibrous (Other)	None Detected
CPA-03-02-Joint Compound 042314918-0006A	Wall - Joint Compound	White Non-Fibrous Homogeneous		100% Non-fibrous (Other)	None Detected
CPA-04-01 042314918-0007	Textured Ceiling	White Non-Fibrous Homogeneous		100% Non-fibrous (Other)	<1% Chrysotile
CPA-04-02 042314918-0008	Textured Ceiling	White Non-Fibrous Homogeneous		100% Non-fibrous (Other)	<1% Chrysotile
CPA-04-03 042314918-0009	Textured Ceiling	White Non-Fibrous Homogeneous		100% Non-fibrous (Other)	<1% Chrysotile

Initial report from: 06/28/2023 14:59:17



EMSL Analytical, Inc.

200 Route 130 North Cinnaminson, NJ 08077

Tel/Fax: (800) 220-3675 / (856) 786-5974

http://www.EMSL.com / cinnaslab@EMSL.com

EMSL Order: 042314918

Customer ID: POWE54

Customer PO: 20354

Project ID:

Test Report: Asbestos Analysis of Bulk Materials via AHERA Method 40CFR 763 Subpart E Appendix E supplemented with EPA 600/R-93/116 using Polarized Light Microscopy

Sample	Description	Appearance	Non-Asbestos		Asbestos
			% Fibrous	% Non-Fibrous	% Type
CPA-05-01 042314918-0010	Exterior Building Putty	White Non-Fibrous Homogeneous		100% Non-fibrous (Other)	None Detected
CPA-05-02 042314918-0011	Exterior Building Putty	White Non-Fibrous Homogeneous		100% Non-fibrous (Other)	None Detected
CPA-06-01-Shingle 042314918-0012	Roof Shingle	Brown/Black Fibrous Heterogeneous	15% Glass	85% Non-fibrous (Other)	None Detected
CPA-06-01-Felt 042314918-0012A	Felt	Black Fibrous Homogeneous	60% Cellulose	40% Non-fibrous (Other)	None Detected
CPA-06-02-Shingle 042314918-0013	Roof Shingle	Brown/Black Fibrous Heterogeneous	30% Glass	70% Non-fibrous (Other)	None Detected
CPA-06-02-Felt 042314918-0013A	Felt	Black Fibrous Homogeneous	60% Cellulose	40% Non-fibrous (Other)	None Detected
CPA-06-03-Shingle 042314918-0014	Roof Shingle	Brown/Black Fibrous Heterogeneous	15% Glass	85% Non-fibrous (Other)	None Detected
CPA-06-03-Felt 042314918-0014A	Felt	Black Fibrous Homogeneous	60% Cellulose	40% Non-fibrous (Other)	None Detected
CPA-06-04-Shingle 042314918-0015	Roof Shingle	Brown/Black Fibrous Heterogeneous	20% Glass	80% Non-fibrous (Other)	None Detected
CPA-06-04-Felt 042314918-0015A	Felt	Black Fibrous Homogeneous	60% Cellulose	40% Non-fibrous (Other)	None Detected
CPA-06-05-Shingle 042314918-0016	Roof Shingle	Brown/Black Fibrous Heterogeneous	30% Glass	70% Non-fibrous (Other)	None Detected
CPA-06-05-Felt 042314918-0016A	Felt	Black Fibrous Homogeneous	60% Cellulose	40% Non-fibrous (Other)	None Detected
CPA-06-06-Shingle 042314918-0017	Roof Shingle	Brown/Black Fibrous Heterogeneous	15% Glass	85% Non-fibrous (Other)	None Detected
CPA-06-06-Felt 042314918-0017A	Felt	Black Fibrous Homogeneous	60% Cellulose	40% Non-fibrous (Other)	None Detected
CPA-06-07-Shingle 042314918-0018	Roof Shingle	Brown/Black Fibrous Heterogeneous	15% Glass	85% Non-fibrous (Other)	None Detected
CPA-06-07-Felt 042314918-0018A	Felt	Black Fibrous Homogeneous	60% Cellulose	40% Non-fibrous (Other)	None Detected
CPA-06-08-Shingle 042314918-0019	Roof Shingle	Brown/Black Fibrous Heterogeneous	15% Glass	85% Non-fibrous (Other)	None Detected
CPA-06-08-Felt 042314918-0019A	Felt	Black Fibrous Homogeneous	60% Cellulose	40% Non-fibrous (Other)	None Detected
CPA-06-09-Shingle 042314918-0020	Roof Shingle	Brown/Black Fibrous Heterogeneous	15% Glass	85% Non-fibrous (Other)	None Detected

Initial report from: 06/28/2023 14:59:17



EMSL Analytical, Inc.

200 Route 130 North Cinnaminson, NJ 08077

Tel/Fax: (800) 220-3675 / (856) 786-5974

http://www.EMSL.com / cinnasblab@EMSL.com

EMSL Order: 042314918
Customer ID: POWE54
Customer PO: 20354
Project ID:

Test Report: Asbestos Analysis of Bulk Materials via AHERA Method 40CFR 763 Subpart E Appendix E supplemented with EPA 600/R-93/116 using Polarized Light Microscopy

Sample	Description	Appearance	Non-Asbestos		Asbestos % Type
			% Fibrous	% Non-Fibrous	
CPA-06-09-Felt 042314918-0020A	Felt	Black Fibrous Homogeneous	60% Cellulose	40% Non-fibrous (Other)	None Detected
CPA-06-10-Shingle 042314918-0021	Roof Shingle	Brown/Black Fibrous Heterogeneous	20% Glass	80% Non-fibrous (Other)	None Detected
CPA-06-10-Felt 042314918-0021A	Felt	Black Fibrous Homogeneous	60% Cellulose	40% Non-fibrous (Other)	None Detected
CPA-06-11-Shingle 042314918-0022	Roof Shingle	Brown/Black Fibrous Heterogeneous	20% Glass	80% Non-fibrous (Other)	None Detected
CPA-06-11-Felt 042314918-0022A	Felt	Black Fibrous Homogeneous	60% Cellulose	40% Non-fibrous (Other)	None Detected
CPA-06-12-Shingle 042314918-0023	Roof Shingle	Brown/Black Fibrous Heterogeneous	15% Glass	85% Non-fibrous (Other)	None Detected
CPA-06-12-Felt 042314918-0023A	Felt	Black Fibrous Homogeneous	60% Cellulose	40% Non-fibrous (Other)	None Detected
CPA-06-13-Shingle 042314918-0024	Roof Shingle	Brown/Black Fibrous Heterogeneous	20% Glass	80% Non-fibrous (Other)	None Detected
CPA-06-13-Felt 042314918-0024A	Felt	Black Fibrous Homogeneous	60% Cellulose	40% Non-fibrous (Other)	None Detected
CPA-06-14-Shingle 042314918-0025	Roof Shingle	Brown/Black Fibrous Heterogeneous	20% Glass	80% Non-fibrous (Other)	None Detected
CPA-06-14-Felt 042314918-0025A	Felt	Black Non-Fibrous Homogeneous	60% Cellulose	40% Non-fibrous (Other)	None Detected
CPA-06-15-Shingle 042314918-0026	Roof Shingle	Brown/Black Fibrous Heterogeneous	20% Glass	80% Non-fibrous (Other)	None Detected
CPA-06-15-Felt 042314918-0026A	Felt	Black Fibrous Homogeneous	60% Cellulose	40% Non-fibrous (Other)	None Detected
CPA-06-16-Shingle 042314918-0027	Roof Shingle	Brown/Black Fibrous Heterogeneous	20% Glass	80% Non-fibrous (Other)	None Detected
CPA-06-16-Felt 042314918-0027A	Felt	Black Fibrous Homogeneous	60% Cellulose	40% Non-fibrous (Other)	None Detected
CPA-07-01-FT 042314918-0028	Off-White FT	Beige Non-Fibrous Homogeneous		98% Non-fibrous (Other)	2% Chrysotile
CPA-07-01-Adhesive 042314918-0028A	Adhesive	Black/Yellow Non-Fibrous Homogeneous		100% Non-fibrous (Other)	None Detected
CPA-07-02-FT 042314918-0029	Off-White FT				Positive Stop (Not Analyzed)
CPA-07-02-Adhesive 042314918-0029A	Adhesive	Yellow Non-Fibrous Homogeneous		100% Non-fibrous (Other)	None Detected

Initial report from: 06/28/2023 14:59:17



EMSL Analytical, Inc.

200 Route 130 North Cinnaminson, NJ 08077

Tel/Fax: (800) 220-3675 / (856) 786-5974

http://www.EMSL.com / cinnaslab@EMSL.com

EMSL Order: 042314918
 Customer ID: POWE54
 Customer PO: 20354
 Project ID:

Test Report: Asbestos Analysis of Bulk Materials via AHERA Method 40CFR 763 Subpart E Appendix E supplemented with EPA 600/R-93/116 using Polarized Light Microscopy

Sample	Description	Appearance	Non-Asbestos		Asbestos
			% Fibrous	% Non-Fibrous	% Type
CPA-08-01-Cove Base <small>042314918-0030</small>	Brown Cove Base	Brown Non-Fibrous Homogeneous		100% Non-fibrous (Other)	None Detected
CPA-08-01-Adhesive <small>042314918-0030A</small>	Adhesive	Brown Non-Fibrous Homogeneous		100% Non-fibrous (Other)	None Detected
CPA-08-02-Cove Base <small>042314918-0031</small>	Brown Cove Base	Brown Non-Fibrous Homogeneous		100% Non-fibrous (Other)	None Detected
CPA-08-02-Adhesive <small>042314918-0031A</small>	Adhesive	Brown/Tan Non-Fibrous Homogeneous		100% Non-fibrous (Other)	None Detected
CPA-09-01-Gypsum Board <small>042314918-0032</small>	Gypsum Board Wall	Brown/White Fibrous Heterogeneous	20% Cellulose	70% Gypsum 10% Non-fibrous (Other)	None Detected
CPA-09-01-Joint Compound <small>042314918-0032A</small>	Ceiling	White Non-Fibrous Homogeneous		100% Non-fibrous (Other)	<1% Chrysotile
CPA-09-02-Gypsum Board <small>042314918-0033</small>	Gypsum Board Wall	Brown/White Fibrous Heterogeneous	20% Cellulose	70% Gypsum 10% Non-fibrous (Other)	None Detected
CPA-09-02-Joint Compound <small>042314918-0033A</small>	Ceiling	White Non-Fibrous Homogeneous		100% Non-fibrous (Other)	<1% Chrysotile
CPA-10-01 <small>042314918-0034</small>	Textured Ceiling	White Non-Fibrous Homogeneous		100% Non-fibrous (Other)	<1% Chrysotile
CPA-10-02 <small>042314918-0035</small>	Textured Ceiling	White Non-Fibrous Homogeneous		100% Non-fibrous (Other)	<1% Chrysotile
CPA-10-03 <small>042314918-0036</small>	Textured Ceiling	White Non-Fibrous Homogeneous		100% Non-fibrous (Other)	<1% Chrysotile
CPA-11-01 <small>042314918-0037</small>	Exterior Building Putty	Tan/White Non-Fibrous Homogeneous		100% Non-fibrous (Other)	None Detected
CPA-11-02 <small>042314918-0038</small>	Exterior Building Putty	White Non-Fibrous Homogeneous		98% Non-fibrous (Other)	2% Chrysotile
CPA-12-01-FT <small>042314918-0039</small>	12" Beige FT	Beige Non-Fibrous Homogeneous		97% Non-fibrous (Other)	3% Chrysotile
CPA-12-01-Adhesive <small>042314918-0039A</small>	Adhesive	Black Non-Fibrous Homogeneous		98% Non-fibrous (Other)	2% Chrysotile
CPA-12-02-FT <small>042314918-0040</small>	12" Beige FT				Positive Stop (Not Analyzed)
CPA-12-02-Adhesive <small>042314918-0040A</small>	Adhesive				Positive Stop (Not Analyzed)
CPA-13-01-FT <small>042314918-0041</small>	12" White	White Non-Fibrous Homogeneous		100% Non-fibrous (Other)	None Detected

Initial report from: 06/28/2023 14:59:17



EMSL Analytical, Inc.

200 Route 130 North Cinnaminson, NJ 08077

Tel/Fax: (800) 220-3675 / (856) 786-5974

http://www.EMSL.com / cinnaslab@EMSL.com

EMSL Order: 042314918
 Customer ID: POWE54
 Customer PO: 20354
 Project ID:

Test Report: Asbestos Analysis of Bulk Materials via AHERA Method 40CFR 763 Subpart E Appendix E supplemented with EPA 600/R-93/116 using Polarized Light Microscopy

Sample	Description	Appearance	Non-Asbestos		Asbestos
			% Fibrous	% Non-Fibrous	% Type
CPA-13-01-Adhesive <i>042314918-0041A</i>	Adhesive	Tan Non-Fibrous Homogeneous		100% Non-fibrous (Other)	None Detected
CPA-13-02-FT <i>042314918-0042</i>	12" White	White Non-Fibrous Homogeneous		100% Non-fibrous (Other)	None Detected
CPA-13-02-Adhesive <i>042314918-0042A</i>	Adhesive	Tan Non-Fibrous Homogeneous		100% Non-fibrous (Other)	None Detected
CPA-14-01-Cove Base <i>042314918-0043</i>	Brown Cove Base	Brown Non-Fibrous Homogeneous		100% Non-fibrous (Other)	None Detected
CPA-14-01-Adhesive <i>042314918-0043A</i>	Adhesive	Tan Non-Fibrous Homogeneous		100% Non-fibrous (Other)	None Detected
CPA-14-02-Cove Base <i>042314918-0044</i> <i>Sample bag empty</i>	Brown Cove Base				Insufficient Material
CPA-14-02-Adhesive <i>042314918-0044A</i> <i>Sample bag empty</i>	Adhesive				Insufficient Material
CPA-15-01 <i>042314918-0045</i>	12" Tan FT Beneath	Brown Non-Fibrous Homogeneous		100% Non-fibrous (Other)	None Detected
CPA-15-02 <i>042314918-0046</i>	12" Tan FT Beneath	Tan Non-Fibrous Homogeneous		100% Non-fibrous (Other)	None Detected
CPA-16-01-FT <i>042314918-0047</i>	12" White FT Over	White Non-Fibrous Homogeneous		100% Non-fibrous (Other)	None Detected
CPA-16-01-Adhesive <i>042314918-0047A</i>	12" White FT Over	Yellow Non-Fibrous Homogeneous		100% Non-fibrous (Other)	None Detected
CPA-16-02-FT <i>042314918-0048</i>	12" White FT Over	White Non-Fibrous Homogeneous		100% Non-fibrous (Other)	None Detected
CPA-16-02-Adhesive <i>042314918-0048A</i>	12" White FT Over	Yellow Non-Fibrous Homogeneous		100% Non-fibrous (Other)	None Detected
CPA-17-01-Gypsum Board <i>042314918-0049</i>	Gypsum Board	Brown/White Fibrous Heterogeneous	30% Cellulose	5% Gypsum 65% Non-fibrous (Other)	None Detected
CPA-17-01-Joint Compound <i>042314918-0049A</i>	Gypsum Board	White Non-Fibrous Homogeneous		100% Non-fibrous (Other)	<1% Chrysotile
CPA-17-02 <i>042314918-0050</i>	Gypsum Board	Brown/White Fibrous Heterogeneous	40% Cellulose	50% Gypsum 10% Non-fibrous (Other)	None Detected
CPA-18-01 <i>042314918-0051</i>	Textured Ceiling	White Non-Fibrous Homogeneous		100% Non-fibrous (Other)	<1% Chrysotile
CPA-18-02 <i>042314918-0052</i>	Textured Ceiling	White Non-Fibrous Homogeneous		100% Non-fibrous (Other)	<1% Chrysotile

Initial report from: 06/28/2023 14:59:17



EMSL Analytical, Inc.

200 Route 130 North Cinnaminson, NJ 08077

Tel/Fax: (800) 220-3675 / (856) 786-5974

<http://www.EMSL.com / cinnaslab@EMSL.com>

EMSL Order: 042314918

Customer ID: POWE54

Customer PO: 20354

Project ID:

Test Report: Asbestos Analysis of Bulk Materials via AHERA Method 40CFR 763 Subpart E Appendix E supplemented with EPA 600/R-93/116 using Polarized Light Microscopy

Sample	Description	Appearance	Non-Asbestos		Asbestos
			% Fibrous	% Non-Fibrous	% Type
CPA-18-03 <i>042314918-0053</i>	Textured Ceiling	White Non-Fibrous Homogeneous		100% Non-fibrous (Other)	<1% Chrysotile
CPA-19-01 <i>042314918-0054</i>	Exterior Building Putty	Tan Non-Fibrous Homogeneous		100% Non-fibrous (Other)	None Detected
CPA-19-02 <i>042314918-0055</i>	Exterior Building Putty	Tan Non-Fibrous Homogeneous		100% Non-fibrous (Other)	None Detected
CPA-20-01-Adhesive <i>042314918-0056</i>	12" 3rd Layer Flooring	Yellow Non-Fibrous Homogeneous		100% Non-fibrous (Other)	None Detected
CPA-20-01-FT <i>042314918-0056A</i>	12" 3rd Layer Flooring	Gray Non-Fibrous Homogeneous		98% Non-fibrous (Other)	2% Chrysotile
CPA-20-01-Adhesive <i>042314918-0056B</i>	12" 3rd Layer Flooring	Black Non-Fibrous Homogeneous		100% Non-fibrous (Other)	<1% Chrysotile
<i>Result includes a small amount of inseparable attached material</i>					
CPA-20-02-Adhesive <i>042314918-0057</i>	12" 3rd Layer Flooring	Yellow Non-Fibrous Homogeneous		100% Non-fibrous (Other)	None Detected
CPA-20-02-FT <i>042314918-0057A</i>	12" 3rd Layer Flooring				Positive Stop (Not Analyzed)
CPA-20-02-Adhesive <i>042314918-0057B</i>	12" 3rd Layer Flooring	Black Non-Fibrous Homogeneous		100% Non-fibrous (Other)	<1% Chrysotile
<i>Result includes a small amount of inseparable attached material</i>					
CPA-21-01-FT <i>042314918-0058</i>	12" White FT	White Non-Fibrous Homogeneous		98% Non-fibrous (Other)	2% Chrysotile
CPA-21-01-Adhesive <i>042314918-0058A</i>	12" White FT	Black Non-Fibrous Homogeneous		98% Non-fibrous (Other)	2% Chrysotile
CPA-21-02 <i>042314918-0059</i>	12" White FT				Positive Stop (Not Analyzed)
CPA-22-01-Gypsum Board <i>042314918-0060</i>	Gypsum Board	Brown/White Fibrous Heterogeneous	40% Cellulose	50% Gypsum 10% Non-fibrous (Other)	None Detected
CPA-22-01-Joint Compound <i>042314918-0060A</i>	Gypsum Board	White Non-Fibrous Homogeneous		100% Non-fibrous (Other)	<1% Chrysotile
CPA-22-02-Gypsum Board <i>042314918-0061</i>	Gypsum Board	Brown/White Fibrous Heterogeneous	30% Cellulose	60% Gypsum 10% Non-fibrous (Other)	None Detected
CPA-22-02-Joint Compound <i>042314918-0061A</i>	Gypsum Board	White Non-Fibrous Homogeneous		100% Non-fibrous (Other)	<1% Chrysotile
CPA-23-01 <i>042314918-0062</i>	Textured Ceiling	Tan Non-Fibrous Homogeneous		100% Non-fibrous (Other)	<1% Chrysotile

Initial report from: 06/28/2023 14:59:17



EMSL Analytical, Inc.

200 Route 130 North Cinnaminson, NJ 08077

Tel/Fax: (800) 220-3675 / (856) 786-5974

http://www.EMSL.com / cinnaslab@EMSL.com

EMSL Order: 042314918

Customer ID: POWE54

Customer PO: 20354

Project ID:

Test Report: Asbestos Analysis of Bulk Materials via AHERA Method 40CFR 763 Subpart E Appendix E supplemented with EPA 600/R-93/116 using Polarized Light Microscopy

Sample	Description	Appearance	Non-Asbestos		Asbestos
			% Fibrous	% Non-Fibrous	% Type
CPA-23-02 042314918-0063	Textured Ceiling	Tan Non-Fibrous Homogeneous		100% Non-fibrous (Other)	<1% Chrysotile
CPA-23-03 042314918-0064	Textured Ceiling	Tan Non-Fibrous Homogeneous		100% Non-fibrous (Other)	<1% Chrysotile
CPA-24-01 042314918-0065	Exterior Building Putty	Gray Non-Fibrous Homogeneous		98% Non-fibrous (Other)	2% Chrysotile
CPA-24-02 042314918-0066	Exterior Building Putty				Positive Stop (Not Analyzed)
CPA-25-01-FT 042314918-0067	12" Beige FT	Beige Non-Fibrous Homogeneous		100% Non-fibrous (Other)	None Detected
CPA-25-01-Adhesive 042314918-0067A	Adhesive				Insufficient Material
CPA-25-02-FT 042314918-0068	12" Beige FT	Beige Non-Fibrous Homogeneous		100% Non-fibrous (Other)	None Detected
CPA-25-02-Adhesive 042314918-0068A	Adhesive	Brown Non-Fibrous Homogeneous		100% Non-fibrous (Other)	None Detected
CPA-26-01 042314918-0069	12" White Beneath CPA25	Tan Non-Fibrous Homogeneous		100% Non-fibrous (Other)	None Detected
CPA-26-02-FT 042314918-0070	12" White Beneath CPA25	Tan Non-Fibrous Homogeneous		100% Non-fibrous (Other)	None Detected
CPA-26-02-Adhesive 042314918-0070A	12" White Beneath CPA25	Yellow Non-Fibrous Homogeneous		100% Non-fibrous (Other)	None Detected
CPA-27-01-Gypsum Board 042314918-0071	Gypsum Board	Brown/White Fibrous Heterogeneous	40% Cellulose	40% Gypsum 20% Non-fibrous (Other)	None Detected
CPA-27-01-Joint Compound 042314918-0071A	Joint Compound	White Non-Fibrous Homogeneous		100% Non-fibrous (Other)	<1% Chrysotile
CPA-27-02 042314918-0072	Gypsum Board	Brown/White Fibrous Heterogeneous	30% Cellulose	60% Gypsum 10% Non-fibrous (Other)	None Detected
CPA-28-01-Cove Base 042314918-0073	Brown Cove Base	Brown Non-Fibrous Homogeneous		100% Non-fibrous (Other)	None Detected
CPA-28-01-Adhesive 042314918-0073A	Brown Cove Base	Yellow Non-Fibrous Homogeneous		100% Non-fibrous (Other)	None Detected
CPA-28-02-Cove Base 042314918-0074	Brown Cove Base	Brown Non-Fibrous Homogeneous		100% Non-fibrous (Other)	None Detected
CPA-28-02-Adhesive 042314918-0074A	Brown Cove Base	Tan Non-Fibrous Homogeneous		100% Non-fibrous (Other)	None Detected

Initial report from: 06/28/2023 14:59:17



EMSL Analytical, Inc.

200 Route 130 North Cinnaminson, NJ 08077

Tel/Fax: (800) 220-3675 / (856) 786-5974

http://www.EMSL.com / cinnaslab@EMSL.com

EMSL Order: 042314918

Customer ID: POWE54

Customer PO: 20354

Project ID:

Test Report: Asbestos Analysis of Bulk Materials via AHERA Method 40CFR 763 Subpart E Appendix E supplemented with EPA 600/R-93/116 using Polarized Light Microscopy

Sample	Description	Appearance	Non-Asbestos		Asbestos
			% Fibrous	% Non-Fibrous	% Type
CPA-29-01 042314918-0075	Textured Ceiling	White Non-Fibrous Homogeneous		100% Non-fibrous (Other)	<1% Chrysotile
CPA-29-02 042314918-0076	Textured Ceiling	White Non-Fibrous Homogeneous		100% Non-fibrous (Other)	<1% Chrysotile
CPA-29-03 042314918-0077	Textured Ceiling	Tan/White Non-Fibrous Homogeneous		100% Non-fibrous (Other)	<1% Chrysotile
CPA-30-01 042314918-0078	Exterior Building Putty	Gray/White Non-Fibrous Homogeneous		100% Non-fibrous (Other)	None Detected
CPA-30-02 042314918-0079	Exterior Building Putty	Gray/White Non-Fibrous Homogeneous		100% Non-fibrous (Other)	None Detected
CPA-31-01-FT 042314918-0080	12" White FT	Beige Non-Fibrous Homogeneous		100% Non-fibrous (Other)	None Detected
CPA-31-01-Adhesive 042314918-0080A	12" White FT	Yellow Non-Fibrous Homogeneous		100% Non-fibrous (Other)	None Detected
CPA-31-02-FT 042314918-0081	12" White FT	Gray/Beige Non-Fibrous Homogeneous		100% Non-fibrous (Other)	None Detected
CPA-31-02-Adhesive 042314918-0081A	12" White FT	Yellow Non-Fibrous Homogeneous		100% Non-fibrous (Other)	None Detected
CPA-32-01-Linoleum 042314918-0082	Beige Linoleum	Tan Fibrous Heterogeneous	20% Cellulose 2% Glass	78% Non-fibrous (Other)	None Detected
CPA-32-01-Adhesive 042314918-0082A	Beige Linoleum	Tan Non-Fibrous Homogeneous		100% Non-fibrous (Other)	None Detected
CPA-32-02-Linoleum 042314918-0083	Beige Linoleum	Tan Fibrous Heterogeneous	20% Cellulose 2% Glass	78% Non-fibrous (Other)	None Detected
CPA-32-02-Adhesive 042314918-0083A	Beige Linoleum	Tan Non-Fibrous Homogeneous		100% Non-fibrous (Other)	None Detected
CPA-33-01-Cove Base 042314918-0084	Brown Cove Base	Brown Non-Fibrous Homogeneous		100% Non-fibrous (Other)	None Detected
CPA-33-01-Adhesive 042314918-0084A	Brown Cove Base	Tan/Yellow Non-Fibrous Homogeneous		100% Non-fibrous (Other)	None Detected
CPA-33-02 042314918-0085 Bag is empty	Brown Cove Base				Layer Not Present
CPA-34-01 042314918-0086	Textured Ceiling	White Non-Fibrous Homogeneous		100% Non-fibrous (Other)	<1% Chrysotile
CPA-34-02 042314918-0087	Textured Ceiling	White Non-Fibrous Homogeneous		100% Non-fibrous (Other)	<1% Chrysotile
CPA-34-03 042314918-0088	Textured Ceiling	Tan Non-Fibrous Homogeneous		5% Mica 95% Non-fibrous (Other)	<1% Chrysotile

Initial report from: 06/28/2023 14:59:17



EMSL Analytical, Inc.

200 Route 130 North Cinnaminson, NJ 08077

Tel/Fax: (800) 220-3675 / (856) 786-5974

http://www.EMSL.com / cinnasblab@EMSL.com

EMSL Order: 042314918
Customer ID: POWE54
Customer PO: 20354
Project ID:

Test Report: Asbestos Analysis of Bulk Materials via AHERA Method 40CFR 763 Subpart E Appendix E supplemented with EPA 600/R-93/116 using Polarized Light Microscopy

Sample	Description	Appearance	Non-Asbestos		Asbestos % Type
			% Fibrous	% Non-Fibrous	
CPA-35-01-Gypsum Board	Gypsum Board	White Fibrous Heterogeneous	20% Cellulose	70% Gypsum 10% Non-fibrous (Other)	None Detected
042314918-0089					
CPA-35-01-Joint Compound	Gypsum Board	White Non-Fibrous Homogeneous		100% Non-fibrous (Other)	<1% Chrysotile
042314918-0089A					
CPA-35-02	Gypsum Board	Brown/White Fibrous Heterogeneous	30% Cellulose	60% Gypsum 10% Non-fibrous (Other)	None Detected
042314918-0090					
CPA-36-01	Exterior Building Putty	Gray Non-Fibrous Homogeneous		2% Quartz 98% Non-fibrous (Other)	None Detected
042314918-0091					
CPA-36-02	Exterior Building Putty	Gray Non-Fibrous Homogeneous		2% Quartz 98% Non-fibrous (Other)	None Detected
042314918-0092					
CPA-37-01-FT	12" Tan Strips FT	Tan Non-Fibrous Homogeneous		98% Non-fibrous (Other)	2% Chrysotile
042314918-0093					
CPA-37-01-Adhesive	12" Tan Strips FT	Black Non-Fibrous Homogeneous		98% Non-fibrous (Other)	2% Chrysotile
042314918-0093A					
CPA-37-02	12" Tan Strips FT				Positive Stop (Not Analyzed)
042314918-0094					
CPA-38-01-FT	12" Beige FT	Tan Non-Fibrous Homogeneous		100% Non-fibrous (Other)	None Detected
042314918-0095					
CPA-38-01-Adhesive	Adhesive	Tan/Black Non-Fibrous Homogeneous		100% Non-fibrous (Other)	None Detected
042314918-0095A					
CPA-38-02-FT	12" Beige FT	Tan Non-Fibrous Homogeneous		100% Non-fibrous (Other)	None Detected
042314918-0096					
CPA-38-02-Adhesive	Adhesive	Tan/Black Non-Fibrous Homogeneous		100% Non-fibrous (Other)	None Detected
042314918-0096A					
CPA-39-01-Cove Base	Brown Cove Base	Brown Non-Fibrous Homogeneous		100% Non-fibrous (Other)	None Detected
042314918-0097					
CPA-39-01-Adhesive	Brown Cove Base	Tan Non-Fibrous Homogeneous		100% Non-fibrous (Other)	None Detected
042314918-0097A					
CPA-39-02-Cove Base	Brown Cove Base	Brown Non-Fibrous Homogeneous		100% Non-fibrous (Other)	None Detected
042314918-0098					
CPA-39-02-Adhesive	Brown Cove Base	Tan Non-Fibrous Homogeneous		100% Non-fibrous (Other)	None Detected
042314918-0098A					
CPA-40-01-Gypsum Board	Gypsum Board	Brown/White Fibrous Heterogeneous	80% Cellulose	15% Gypsum 5% Non-fibrous (Other)	None Detected
042314918-0099					
CPA-40-01-Joint Compound	Gypsum Board	White Non-Fibrous Homogeneous		100% Non-fibrous (Other)	None Detected
042314918-0099A					

Initial report from: 06/28/2023 14:59:17



EMSL Analytical, Inc.

200 Route 130 North Cinnaminson, NJ 08077

Tel/Fax: (800) 220-3675 / (856) 786-5974

http://www.EMSL.com / cinnaslab@EMSL.com

EMSL Order: 042314918
 Customer ID: POWE54
 Customer PO: 20354
 Project ID:

Test Report: Asbestos Analysis of Bulk Materials via AHERA Method 40CFR 763 Subpart E Appendix E supplemented with EPA 600/R-93/116 using Polarized Light Microscopy

Sample	Description	Appearance	Non-Asbestos		Asbestos
			% Fibrous	% Non-Fibrous	% Type
CPA-40-02-Gypsum Board	Gypsum Board	Brown/White Fibrous Heterogeneous	30% Cellulose	60% Gypsum 10% Non-fibrous (Other)	None Detected
<i>042314918-0100</i>					
CPA-40-02-Joint Compound	Gypsum Board	White Non-Fibrous Homogeneous		100% Non-fibrous (Other)	None Detected
<i>042314918-0100A</i>					
CPA-41-01	Textured Ceiling	White Non-Fibrous Homogeneous		100% Non-fibrous (Other)	None Detected
<i>042314918-0101</i>					
CPA-41-02	Textured Ceiling	White Non-Fibrous Homogeneous		100% Non-fibrous (Other)	None Detected
<i>042314918-0102</i>					
CPA-41-03	Textured Ceiling	Tan Non-Fibrous Homogeneous		100% Non-fibrous (Other)	<1% Chrysotile
<i>042314918-0103</i>					
CPA-42-01	Exterior Building Putty	Gray Non-Fibrous Homogeneous		98% Non-fibrous (Other)	2% Chrysotile
<i>042314918-0104</i>					
CPA-42-02	Exterior Building Putty				Positive Stop (Not Analyzed)
<i>042314918-0105</i>					
CPA-43-01-FT	12" White FT	Tan Non-Fibrous Homogeneous		100% Non-fibrous (Other)	None Detected
<i>042314918-0106</i>					
CPA-43-01-Adhesive	Adhesive	Tan Non-Fibrous Homogeneous		100% Non-fibrous (Other)	None Detected
<i>042314918-0106A</i>					
CPA-43-02-FT	12" White FT	Tan Non-Fibrous Homogeneous		100% Non-fibrous (Other)	None Detected
<i>042314918-0107</i>					
CPA-43-02-Adhesive	Adhesive	Yellow Non-Fibrous Homogeneous		100% Non-fibrous (Other)	None Detected
<i>042314918-0107A</i>					
CPA-44-01-Gypsum Board	Gypsum Board	Brown/White Fibrous Heterogeneous	40% Cellulose	50% Gypsum 10% Non-fibrous (Other)	None Detected
<i>042314918-0108</i>					
CPA-44-01-Joint Compound	Joint Compound	White Non-Fibrous Homogeneous		100% Non-fibrous (Other)	<1% Chrysotile
<i>042314918-0108A</i>					
CPA-44-02-Gypsum Board	Gypsum Board	Brown/White Fibrous Heterogeneous	20% Cellulose <1% Glass	70% Gypsum 10% Non-fibrous (Other)	None Detected
<i>042314918-0109</i>					
CPA-44-02-Joint Compound	Joint Compound	White Non-Fibrous Homogeneous		100% Non-fibrous (Other)	<1% Chrysotile
<i>042314918-0109A</i>					
CPA-45-01	Textured Ceiling	Tan/White Non-Fibrous Homogeneous		100% Non-fibrous (Other)	<1% Chrysotile
<i>042314918-0110</i>					
CPA-45-02	Textured Ceiling	Tan/White Non-Fibrous Homogeneous		100% Non-fibrous (Other)	<1% Chrysotile
<i>042314918-0111</i>					

Initial report from: 06/28/2023 14:59:17



EMSL Analytical, Inc.

200 Route 130 North Cinnaminson, NJ 08077

Tel/Fax: (800) 220-3675 / (856) 786-5974

<http://www.EMSL.com/cinnaslab@EMSL.com>

EMSL Order: 042314918
 Customer ID: POWE54
 Customer PO: 20354
 Project ID:

Test Report: Asbestos Analysis of Bulk Materials via AHERA Method 40CFR 763 Subpart E Appendix E supplemented with EPA 600/R-93/116 using Polarized Light Microscopy

Sample	Description	Appearance	Non-Asbestos		Asbestos
			% Fibrous	% Non-Fibrous	% Type
CPA-45-03 042314918-0112	Textured Ceiling	Tan/White Non-Fibrous Homogeneous		100% Non-fibrous (Other)	<1% Chrysotile
CPA-46-01 042314918-0113	Beige Linoleum	Tan/White Fibrous Heterogeneous	30% Cellulose	70% Non-fibrous (Other)	None Detected
CPA-46-02 042314918-0114	Beige Linoleum	Gray/Tan Fibrous Heterogeneous	20% Cellulose	80% Non-fibrous (Other)	None Detected
CPA-47-01 042314918-0115	Exterior Building Putty	Gray/White Non-Fibrous Homogeneous		100% Non-fibrous (Other)	None Detected
CPA-47-02 042314918-0116	Exterior Building Putty	Gray/White Non-Fibrous Homogeneous		100% Non-fibrous (Other)	None Detected
CPA-48-01 042314918-0117	Gypsum Board	Brown/White Fibrous Heterogeneous	60% Cellulose	30% Gypsum 10% Non-fibrous (Other)	None Detected
CPA-48-02 042314918-0118	Gypsum Board	Brown/White Fibrous Heterogeneous	70% Cellulose	20% Gypsum 10% Non-fibrous (Other)	None Detected
CPA-49-01-FT 042314918-0119	12" Beige FT	Tan/Beige Non-Fibrous Homogeneous		100% Non-fibrous (Other)	None Detected
CPA-49-01-Adhesive 042314918-0119A	Adhesive	Tan/Black Non-Fibrous Homogeneous		100% Non-fibrous (Other)	None Detected
CPA-49-02-FT 042314918-0120	12" Beige FT	Tan/Beige Non-Fibrous Homogeneous		100% Non-fibrous (Other)	None Detected
CPA-49-02-Adhesive 042314918-0120A	Adhesive	Tan Non-Fibrous Homogeneous		100% Non-fibrous (Other)	None Detected
CPA-50-01-FT 042314918-0121	12" Beige FT	Tan Non-Fibrous Homogeneous		100% Non-fibrous (Other)	None Detected
CPA-50-01-Adhesive 042314918-0121A	Adhesive				Layer Not Present
CPA-50-01-Caulk 042314918-0121B	Adhesive	Tan/White Non-Fibrous Homogeneous		100% Non-fibrous (Other)	None Detected
CPA-50-02-FT 042314918-0122	12" Beige FT	Tan Non-Fibrous Homogeneous		100% Non-fibrous (Other)	None Detected
CPA-50-02-Adhesive 042314918-0122A	Adhesive	Brown Non-Fibrous Homogeneous		100% Non-fibrous (Other)	None Detected
CPA-51-01-Cove Base 042314918-0123	Brown Cove Base	Brown Non-Fibrous Homogeneous		100% Non-fibrous (Other)	None Detected
CPA-51-01-Adhesive 042314918-0123A	Adhesive	Tan Non-Fibrous Homogeneous		100% Non-fibrous (Other)	None Detected
CPA-51-02-Cove Base 042314918-0124	Brown Cove Base	Brown Non-Fibrous Homogeneous		100% Non-fibrous (Other)	None Detected

Initial report from: 06/28/2023 14:59:17



EMSL Analytical, Inc.

200 Route 130 North Cinnaminson, NJ 08077

Tel/Fax: (800) 220-3675 / (856) 786-5974

http://www.EMSL.com / cinnaslab@EMSL.com

EMSL Order: 042314918

Customer ID: POWE54

Customer PO: 20354

Project ID:

Test Report: Asbestos Analysis of Bulk Materials via AHERA Method 40CFR 763 Subpart E Appendix E supplemented with EPA 600/R-93/116 using Polarized Light Microscopy

Sample	Description	Appearance	Non-Asbestos		Asbestos
			% Fibrous	% Non-Fibrous	% Type
CPA-51-02-Adhesive <i>042314918-0124A</i>	Adhesive	Tan Non-Fibrous Homogeneous		100% Non-fibrous (Other)	None Detected
CPA-52-01 <i>042314918-0125</i>	Textured Ceiling	White Non-Fibrous Homogeneous		100% Non-fibrous (Other)	None Detected
CPA-52-02 <i>042314918-0126</i>	Textured Ceiling	White Non-Fibrous Homogeneous		100% Non-fibrous (Other)	None Detected
CPA-52-03 <i>042314918-0127</i>	Textured Ceiling	White Non-Fibrous Homogeneous		100% Non-fibrous (Other)	None Detected
CPA-53-01 <i>042314918-0128</i> <i>Bag is empty</i>	Exterior Building Putty				Not Submitted
CPA-53-02 <i>042314918-0129</i> <i>Bag is empty</i>	Exterior Building Putty				Layer Not Present
CPA-54-01 <i>042314918-0130</i>	12" White FT	White Non-Fibrous Homogeneous		100% Non-fibrous (Other)	None Detected
CPA-54-02-FT <i>042314918-0131</i>	12" White FT	White Non-Fibrous Homogeneous		100% Non-fibrous (Other)	None Detected
CPA-54-02-Adhesive <i>042314918-0131A</i>	Adhesive	Black Non-Fibrous Homogeneous		98% Non-fibrous (Other)	2% Chrysotile
CPA-55-01 <i>042314918-0132</i>	Gypsum Board	Brown/White Fibrous Heterogeneous	30% Cellulose	60% Gypsum 10% Non-fibrous (Other)	None Detected
CPA-55-02-Gypsum Board <i>042314918-0133</i>	Gypsum Board	Brown/White Fibrous Heterogeneous	40% Cellulose	50% Gypsum 10% Non-fibrous (Other)	None Detected
CPA-55-02-Joint Compound <i>042314918-0133A</i>	Joint Compound	White Non-Fibrous Homogeneous		100% Non-fibrous (Other)	<1% Chrysotile
CPA-56-01 <i>042314918-0134</i>	Textured Ceiling	Tan/White Non-Fibrous Homogeneous		100% Non-fibrous (Other)	<1% Chrysotile
CPA-56-02 <i>042314918-0135</i>	Textured Ceiling	Tan/White Non-Fibrous Homogeneous		100% Non-fibrous (Other)	<1% Chrysotile
CPA-56-03 <i>042314918-0136</i>	Textured Ceiling	Tan/White Non-Fibrous Homogeneous		100% Non-fibrous (Other)	<1% Chrysotile
CPA-57-01 <i>042314918-0137</i>	Exterior Building Putty	Tan Non-Fibrous Homogeneous		100% Non-fibrous (Other)	None Detected
CPA-57-02 <i>042314918-0138</i>	Exterior Building Putty	Tan/White Non-Fibrous Homogeneous		100% Non-fibrous (Other)	None Detected
CPA-58-01-FT <i>042314918-0139</i>	12" Beige FT	Gray/White Non-Fibrous Homogeneous		98% Non-fibrous (Other)	2% Chrysotile

Initial report from: 06/28/2023 14:59:17



EMSL Analytical, Inc.

200 Route 130 North Cinnaminson, NJ 08077

Tel/Fax: (800) 220-3675 / (856) 786-5974

http://www.EMSL.com / cinnaslab@EMSL.com

EMSL Order: 042314918
Customer ID: POWE54
Customer PO: 20354
Project ID:

Test Report: Asbestos Analysis of Bulk Materials via AHERA Method 40CFR 763 Subpart E Appendix E supplemented with EPA 600/R-93/116 using Polarized Light Microscopy

Sample	Description	Appearance	Non-Asbestos		Asbestos
			% Fibrous	% Non-Fibrous	% Type
CPA-58-01-Adhesive <i>042314918-0139A</i>	12" Beige FT	Black Non-Fibrous Homogeneous		98% Non-fibrous (Other)	2% Chrysotile
CPA-58-02 <i>042314918-0140</i>	12" Beige FT				Positive Stop (Not Analyzed)
CPA-59-01-Cove Base <i>042314918-0141</i>	Brown Cove Base	Brown Non-Fibrous Homogeneous		100% Non-fibrous (Other)	None Detected
CPA-59-01-Adhesive <i>042314918-0141A</i>	Brown Cove Base	Tan/White Non-Fibrous Homogeneous		100% Non-fibrous (Other)	None Detected
CPA-59-02-Cove Base <i>042314918-0142</i>	Brown Cove Base	Brown Non-Fibrous Homogeneous		100% Non-fibrous (Other)	None Detected
CPA-59-02-Adhesive <i>042314918-0142A</i>	Brown Cove Base	Tan Non-Fibrous Homogeneous		100% Non-fibrous (Other)	None Detected
CPA-60-01-Gypsum Board <i>042314918-0143</i>	Gypsum Board	Brown/White Fibrous Heterogeneous	30% Cellulose	60% Gypsum 10% Non-fibrous (Other)	None Detected
CPA-60-01-Joint Compound <i>042314918-0143A</i>	Gypsum Board	White Non-Fibrous Homogeneous		100% Non-fibrous (Other)	<1% Chrysotile
CPA-60-02-Gypsum Board <i>042314918-0144</i>	Gypsum Board	Brown/White Fibrous Heterogeneous	30% Cellulose	60% Gypsum 10% Non-fibrous (Other)	None Detected
CPA-60-02-Joint Compound <i>042314918-0144A</i>	Gypsum Board	White Non-Fibrous Homogeneous		100% Non-fibrous (Other)	<1% Chrysotile
CPA-61-01 <i>042314918-0145</i>	Textured Ceiling	Tan/White Non-Fibrous Homogeneous		100% Non-fibrous (Other)	<1% Chrysotile
CPA-61-02 <i>042314918-0146</i>	Textured Ceiling	Tan/White Non-Fibrous Homogeneous		100% Non-fibrous (Other)	<1% Chrysotile
CPA-61-03 <i>042314918-0147</i>	Textured Ceiling	Tan/White Non-Fibrous Homogeneous		100% Non-fibrous (Other)	<1% Chrysotile
CPA-62-01 <i>042314918-0148</i>	Exterior Building Putty	White Non-Fibrous Homogeneous		100% Non-fibrous (Other)	None Detected
CPA-62-02 <i>042314918-0149</i>	Exterior Building Putty	White Non-Fibrous Homogeneous		100% Non-fibrous (Other)	None Detected
CPA-63-01-FT <i>042314918-0150</i>	12" White FT	Tan Non-Fibrous Homogeneous		100% Non-fibrous (Other)	None Detected
CPA-63-01-Adhesive <i>042314918-0150A</i>	Adhesive	Tan/White Non-Fibrous Homogeneous		100% Non-fibrous (Other)	None Detected
CPA-63-02-FT <i>042314918-0151</i>	12" White FT	Tan Non-Fibrous Homogeneous		100% Non-fibrous (Other)	None Detected

Initial report from: 06/28/2023 14:59:17



EMSL Analytical, Inc.

200 Route 130 North Cinnaminson, NJ 08077

Tel/Fax: (800) 220-3675 / (856) 786-5974

http://www.EMSL.com / cinnaslab@EMSL.com

EMSL Order: 042314918
Customer ID: POWE54
Customer PO: 20354
Project ID:

Test Report: Asbestos Analysis of Bulk Materials via AHERA Method 40CFR 763 Subpart E Appendix E supplemented with EPA 600/R-93/116 using Polarized Light Microscopy

Sample	Description	Appearance	Non-Asbestos		Asbestos
			% Fibrous	% Non-Fibrous	% Type
CPA-63-02-Adhesive <small>042314918-0151A</small>	Adhesive	Tan Non-Fibrous Homogeneous		100% Non-fibrous (Other)	None Detected
CPA-64-01-Gypsum Board <small>042314918-0152</small>	Gypsum Board	Brown/White Fibrous Heterogeneous	30% Cellulose	60% Gypsum 10% Non-fibrous (Other)	None Detected
CPA-64-01-Joint Compound <small>042314918-0152A</small>	Gypsum Board	White Non-Fibrous Homogeneous		100% Non-fibrous (Other)	<1% Chrysotile
CPA-64-02-Gypsum Board <small>042314918-0153</small>	Gypsum Board	Brown/White Fibrous Heterogeneous	40% Cellulose	50% Gypsum 10% Non-fibrous (Other)	None Detected
CPA-64-02-Joint Compound <small>042314918-0153A</small>	Gypsum Board	White Non-Fibrous Homogeneous		100% Non-fibrous (Other)	<1% Chrysotile
CPA-65-01 <small>042314918-0154</small>	Textured Ceiling	White Non-Fibrous Homogeneous		100% Non-fibrous (Other)	<1% Chrysotile
CPA-65-02 <small>042314918-0155</small>	Textured Ceiling	White Non-Fibrous Homogeneous		100% Non-fibrous (Other)	<1% Chrysotile
CPA-65-03 <small>042314918-0156</small>	Textured Ceiling	Tan Non-Fibrous Homogeneous		100% Non-fibrous (Other)	<1% Chrysotile
CPA-66-01 <small>042314918-0157</small>	Exterior Building Putty	White Non-Fibrous Homogeneous		100% Non-fibrous (Other)	None Detected
CPA-66-02 <small>042314918-0158</small>	Exterior Building Putty	White Non-Fibrous Homogeneous		100% Non-fibrous (Other)	None Detected
CPA-67-01 <small>042314918-0159</small>	12" Beige FT	Tan Non-Fibrous Homogeneous		100% Non-fibrous (Other)	None Detected
CPA-67-02-FT <small>042314918-0160</small>	12" Beige FT	Tan Non-Fibrous Homogeneous		100% Non-fibrous (Other)	None Detected
CPA-67-02-Adhesive <small>042314918-0160A</small>	12" Beige FT	Black Non-Fibrous Homogeneous		98% Non-fibrous (Other)	2% Chrysotile
CPA-68-01-Cove Base <small>042314918-0161</small>	Brown Cove Base	Brown Non-Fibrous Homogeneous		100% Non-fibrous (Other)	None Detected
CPA-68-01-Adhesive <small>042314918-0161A</small>	Brown Cove Base	Yellow Non-Fibrous Homogeneous		100% Non-fibrous (Other)	None Detected
CPA-68-02-Cove Base <small>042314918-0162</small>	Brown Cove Base	Brown Non-Fibrous Homogeneous		100% Non-fibrous (Other)	None Detected
CPA-68-02-Adhesive <small>042314918-0162A</small>	Brown Cove Base	Tan Non-Fibrous Homogeneous		100% Non-fibrous (Other)	None Detected

Initial report from: 06/28/2023 14:59:17



EMSL Analytical, Inc.

200 Route 130 North Cinnaminson, NJ 08077

Tel/Fax: (800) 220-3675 / (856) 786-5974

http://www.EMSL.com / cinnasblab@EMSL.com

EMSL Order: 042314918
 Customer ID: POWE54
 Customer PO: 20354
 Project ID:

Test Report: Asbestos Analysis of Bulk Materials via AHERA Method 40CFR 763 Subpart E Appendix E supplemented with EPA 600/R-93/116 using Polarized Light Microscopy

Sample	Description	Appearance	Non-Asbestos		Asbestos
			% Fibrous	% Non-Fibrous	% Type
CPA-69-01-Gypsum Board	Gypsum Board	Brown/White Fibrous Heterogeneous	60% Cellulose	30% Gypsum 10% Non-fibrous (Other)	None Detected
042314918-0163					
CPA-69-01-Joint Compound	Gypsum Board	White Non-Fibrous Homogeneous		100% Non-fibrous (Other)	None Detected
042314918-0163A					
CPA-69-02	Gypsum Board	Brown/White Fibrous Heterogeneous	30% Cellulose	60% Gypsum 10% Non-fibrous (Other)	None Detected
042314918-0164					
CPA-70-01	Textured Ceiling	Tan Non-Fibrous Homogeneous		100% Non-fibrous (Other)	<1% Chrysotile
042314918-0165					
CPA-70-02	Textured Ceiling	Tan/White Non-Fibrous Homogeneous		20% Mica 80% Non-fibrous (Other)	None Detected
042314918-0166					
CPA-70-03	Textured Ceiling	Tan Non-Fibrous Homogeneous		100% Non-fibrous (Other)	<1% Chrysotile
042314918-0167					
CPA-71-01	Exterior Building Putty	Brown Non-Fibrous Homogeneous		100% Non-fibrous (Other)	None Detected
042314918-0168					
CPA-71-02	Exterior Building Putty	Gray Non-Fibrous Homogeneous		100% Non-fibrous (Other)	None Detected
042314918-0169					
CPA-72-01-FT	12" Beige FT	White/Beige Non-Fibrous Homogeneous		100% Non-fibrous (Other)	None Detected
042314918-0170					
CPA-72-01-Adhesive	Adhesive	Black/Yellow Non-Fibrous Homogeneous		100% Non-fibrous (Other)	<1% Chrysotile
042314918-0170A					
CPA-72-02-FT	12" Beige FT	Tan Non-Fibrous Homogeneous		100% Non-fibrous (Other)	None Detected
042314918-0171					
CPA-72-02-Adhesive	Adhesive	Black Non-Fibrous Homogeneous		98% Non-fibrous (Other)	2% Chrysotile
042314918-0171A					
CPA-73-01	12" White FT	Tan/White Non-Fibrous Homogeneous		100% Non-fibrous (Other)	None Detected
042314918-0172					
CPA-73-02-FT	12" White FT	Gray Non-Fibrous Homogeneous		100% Non-fibrous (Other)	None Detected
042314918-0173					
CPA-73-02-Adhesive	Adhesive	Brown Non-Fibrous Homogeneous		100% Non-fibrous (Other)	None Detected
042314918-0173A					
CPA-74-01	Gypsum Board	Brown/White Fibrous Heterogeneous	50% Cellulose	40% Gypsum 10% Non-fibrous (Other)	None Detected
042314918-0174					
CPA-74-02	Gypsum Board	Brown/White Fibrous Heterogeneous	30% Cellulose	60% Gypsum 10% Non-fibrous (Other)	None Detected
042314918-0175					
CPA-75-01-Cove Base	Brown Cove Base	Brown Non-Fibrous Homogeneous		100% Non-fibrous (Other)	None Detected
042314918-0176					

Initial report from: 06/28/2023 14:59:17



EMSL Analytical, Inc.

200 Route 130 North Cinnaminson, NJ 08077
Tel/Fax: (800) 220-3675 / (856) 786-5974
<http://www.EMSL.com> / cinnaslab@EMSL.com

EMSL Order: 042314918
Customer ID: POWE54
Customer PO: 20354
Project ID:

Test Report: Asbestos Analysis of Bulk Materials via AHERA Method 40CFR 763 Subpart E Appendix E supplemented with EPA 600/R-93/116 using Polarized Light Microscopy

Sample	Description	Appearance	Non-Asbestos		Asbestos
			% Fibrous	% Non-Fibrous	% Type
CPA-75-01-Adhesive <i>042314918-0176A</i>	Adhesive	Tan/Red Non-Fibrous Homogeneous		100% Non-fibrous (Other)	None Detected
CPA-75-02-Cove Base <i>042314918-0177</i>	Brown Cove Base	Brown Non-Fibrous Homogeneous		100% Non-fibrous (Other)	None Detected
CPA-75-02-Adhesive <i>042314918-0177A</i>	Adhesive	Tan/Red Non-Fibrous Homogeneous		100% Non-fibrous (Other)	None Detected
CPA-76-01 <i>042314918-0178</i>	Textured Ceiling	Tan Non-Fibrous Homogeneous		100% Non-fibrous (Other)	<1% Chrysotile
CPA-76-02 <i>042314918-0179</i>	Textured Ceiling	Tan Non-Fibrous Homogeneous		100% Non-fibrous (Other)	<1% Chrysotile
CPA-76-03 <i>042314918-0180</i>	Textured Ceiling	Tan Non-Fibrous Homogeneous		100% Non-fibrous (Other)	<1% Chrysotile
CPA-77-01 <i>042314918-0181</i>	Exterior Building Putty	White Non-Fibrous Homogeneous		100% Non-fibrous (Other)	None Detected
CPA-77-02 <i>042314918-0182</i>	Exterior Building Putty	Tan/White Non-Fibrous Homogeneous		100% Non-fibrous (Other)	None Detected
CPA-78-01-FT <i>042314918-0183</i>	12" Beige FT	Beige Non-Fibrous Homogeneous		98% Non-fibrous (Other)	2% Chrysotile
CPA-78-01-Adhesive <i>042314918-0183A</i>	Adhesive	Black Non-Fibrous Homogeneous		98% Non-fibrous (Other)	2% Chrysotile
CPA-78-02-FT <i>042314918-0184</i>	12" Beige FT				Positive Stop (Not Analyzed)
CPA-78-02-Adhesive <i>042314918-0184A</i>	Adhesive				Positive Stop (Not Analyzed)
CPA-79-01-Cove Base <i>042314918-0185</i>	Brown Cove Base	Black Non-Fibrous Homogeneous		100% Non-fibrous (Other)	None Detected
CPA-79-01-Adhesive <i>042314918-0185A</i>	Adhesive	Tan Non-Fibrous Homogeneous		100% Non-fibrous (Other)	None Detected
CPA-79-02-Cove Base <i>042314918-0186</i>	Brown Cove Base	Black Non-Fibrous Homogeneous		100% Non-fibrous (Other)	None Detected
CPA-79-02-Adhesive <i>042314918-0186A</i>	Adhesive	Tan Non-Fibrous Homogeneous		100% Non-fibrous (Other)	None Detected
CPA-80-01-Gypsum Board <i>042314918-0187</i>	Gypsum Board	Brown/White Fibrous Heterogeneous	30% Cellulose	60% Gypsum 10% Non-fibrous (Other)	None Detected
CPA-80-01-Joint Compound <i>042314918-0187A</i>	Joint Compound	White Non-Fibrous Homogeneous		100% Non-fibrous (Other)	<1% Chrysotile

Initial report from: 06/28/2023 14:59:17



EMSL Analytical, Inc.

200 Route 130 North Cinnaminson, NJ 08077

Tel/Fax: (800) 220-3675 / (856) 786-5974

<http://www.EMSL.com> / cinnasblab@EMSL.com

EMSL Order: 042314918
Customer ID: POWE54
Customer PO: 20354
Project ID:

Test Report: Asbestos Analysis of Bulk Materials via AHERA Method 40CFR 763 Subpart E Appendix E supplemented with EPA 600/R-93/116 using Polarized Light Microscopy

Sample	Description	Appearance	Non-Asbestos		Asbestos
			% Fibrous	% Non-Fibrous	% Type
CPA-80-02-Gypsum Board <small>042314918-0188</small>	Gypsum Board	Brown/White Fibrous Heterogeneous	20% Cellulose	70% Gypsum 10% Non-fibrous (Other)	None Detected
CPA-80-02-Joint Compound <small>042314918-0188A</small>	Joint Compound	White Non-Fibrous Homogeneous		100% Non-fibrous (Other)	<1% Chrysotile
CPA-81-01 <small>042314918-0189</small>	Textured Ceiling	Tan Non-Fibrous Homogeneous		100% Non-fibrous (Other)	<1% Chrysotile
CPA-81-02 <small>042314918-0190</small>	Textured Ceiling	Tan Non-Fibrous Homogeneous		100% Non-fibrous (Other)	<1% Chrysotile
CPA-81-03 <small>042314918-0191</small>	Textured Ceiling	Tan Non-Fibrous Homogeneous		100% Non-fibrous (Other)	<1% Chrysotile
CPA-82-01 <small>042314918-0192</small>	Exterior Building Putty	White Non-Fibrous Homogeneous		100% Non-fibrous (Other)	None Detected
CPA-82-02 <small>042314918-0193</small>	Exterior Building Putty	White Non-Fibrous Homogeneous		100% Non-fibrous (Other)	None Detected
CPA-83-01-FT <small>042314918-0194</small>	12" Beige FT	Beige Non-Fibrous Homogeneous		98% Non-fibrous (Other)	2% Chrysotile
CPA-83-01-Adhesive <small>042314918-0194A</small>	Adhesive	Black Non-Fibrous Homogeneous		98% Non-fibrous (Other)	2% Chrysotile
CPA-83-02 <small>042314918-0195</small>	12" Beige FT				Positive Stop (Not Analyzed)
CPA-84-01-Cove Base <small>042314918-0196</small>	Brown Cove Base	Brown Non-Fibrous Homogeneous		100% Non-fibrous (Other)	None Detected
CPA-84-01-Adhesive <small>042314918-0196A</small>	Adhesive	Tan Non-Fibrous Homogeneous		100% Non-fibrous (Other)	None Detected
CPA-84-02-Cove Base <small>042314918-0197</small>	Brown Cove Base	Brown Non-Fibrous Homogeneous		100% Non-fibrous (Other)	None Detected
CPA-84-02-Adhesive <small>042314918-0197A</small>	Adhesive	Tan Non-Fibrous Homogeneous		100% Non-fibrous (Other)	None Detected
CPA-85-01 <small>042314918-0198</small>	Gypsum Board	Brown/White Fibrous Heterogeneous	40% Cellulose	50% Gypsum 10% Non-fibrous (Other)	None Detected
CPA-85-02-Gypsum Board <small>042314918-0199</small>	Gypsum Board	Brown/White Fibrous Heterogeneous	30% Cellulose	60% Gypsum 10% Non-fibrous (Other)	None Detected
CPA-85-02-Joint Compound <small>042314918-0199A</small>	Joint Compound	White Non-Fibrous Homogeneous		100% Non-fibrous (Other)	<1% Chrysotile
CPA-86-01 <small>042314918-0200</small>	Textured Ceiling	Tan/White Non-Fibrous Homogeneous		100% Non-fibrous (Other)	<1% Chrysotile

Initial report from: 06/28/2023 14:59:17



EMSL Analytical, Inc.

200 Route 130 North Cinnaminson, NJ 08077

Tel/Fax: (800) 220-3675 / (856) 786-5974

http://www.EMSL.com / cinnaslab@EMSL.com

EMSL Order: 042314918
 Customer ID: POWE54
 Customer PO: 20354
 Project ID:

Test Report: Asbestos Analysis of Bulk Materials via AHERA Method 40CFR 763 Subpart E Appendix E supplemented with EPA 600/R-93/116 using Polarized Light Microscopy

Sample	Description	Appearance	Non-Asbestos		Asbestos
			% Fibrous	% Non-Fibrous	% Type
CPA-86-02 042314918-0201	Textured Ceiling	Tan/White Non-Fibrous Homogeneous		100% Non-fibrous (Other)	<1% Chrysotile
CPA-86-03 042314918-0202	Textured Ceiling	Tan Non-Fibrous Homogeneous		100% Non-fibrous (Other)	<1% Chrysotile
CPA-87-01 042314918-0203	Exterior Building Putty	Pink Non-Fibrous Homogeneous		100% Non-fibrous (Other)	None Detected
CPA-87-02 042314918-0204	Exterior Building Putty	Tan/White Non-Fibrous Homogeneous		100% Non-fibrous (Other)	None Detected
CPA-88-01-FT 042314918-0205	12" Tan FT	Tan Non-Fibrous Homogeneous		100% Non-fibrous (Other)	None Detected
CPA-88-01-Adhesive 042314918-0205A	Adhesive	Tan Non-Fibrous Homogeneous		100% Non-fibrous (Other)	None Detected
CPA-88-02-FT 042314918-0206	12" Tan FT	Tan Non-Fibrous Homogeneous		100% Non-fibrous (Other)	None Detected
CPA-88-02-Adhesive 042314918-0206A	Adhesive	Tan Non-Fibrous Homogeneous		100% Non-fibrous (Other)	None Detected
CPA-89-01 042314918-0207	Textured Ceiling	Tan Non-Fibrous Homogeneous		100% Non-fibrous (Other)	<1% Chrysotile
CPA-89-02 042314918-0208	Textured Ceiling	Tan/White Non-Fibrous Homogeneous		100% Non-fibrous (Other)	<1% Chrysotile
CPA-89-03 042314918-0209	Textured Ceiling	Tan/White Non-Fibrous Homogeneous		100% Non-fibrous (Other)	<1% Chrysotile
CPA-90-01-Cove Base 042314918-0210	Cove Base	Brown Non-Fibrous Homogeneous		100% Non-fibrous (Other)	None Detected
CPA-90-01-Adhesive 042314918-0210A	Adhesive	Tan Non-Fibrous Homogeneous		100% Non-fibrous (Other)	None Detected
CPA-90-02-Cove Base 042314918-0211	Cove Base	Brown Non-Fibrous Homogeneous		100% Non-fibrous (Other)	None Detected
CPA-90-02-Adhesive 042314918-0211A	Adhesive	Tan Non-Fibrous Homogeneous		100% Non-fibrous (Other)	None Detected
CPA-91-01 042314918-0212	Sheetrock	Brown/White Fibrous Heterogeneous	40% Cellulose	50% Gypsum 10% Non-fibrous (Other)	None Detected
CPA-91-02 042314918-0213	Sheetrock	Brown/White Fibrous Heterogeneous	30% Cellulose	60% Gypsum 10% Non-fibrous (Other)	None Detected
CPA-92-01 042314918-0214	Window Caulk	White Non-Fibrous Homogeneous		100% Non-fibrous (Other)	None Detected
CPA-92-02 042314918-0215	Window Caulk	White Non-Fibrous Homogeneous		100% Non-fibrous (Other)	None Detected

Initial report from: 06/28/2023 14:59:17



EMSL Analytical, Inc.

200 Route 130 North Cinnaminson, NJ 08077

Tel/Fax: (800) 220-3675 / (856) 786-5974

http://www.EMSL.com / cinnaslab@EMSL.com

EMSL Order: 042314918

Customer ID: POWE54

Customer PO: 20354

Project ID:

Test Report: Asbestos Analysis of Bulk Materials via AHERA Method 40CFR 763 Subpart E Appendix E supplemented with EPA 600/R-93/116 using Polarized Light Microscopy

Sample	Description	Appearance	Non-Asbestos		Asbestos
			% Fibrous	% Non-Fibrous	% Type
CPA-93-01-FT 042314918-0216	12" Tan FT	Tan Non-Fibrous Homogeneous		100% Non-fibrous (Other)	None Detected
CPA-93-01-Adhesive 042314918-0216A	12" Tan FT	Black Non-Fibrous Homogeneous		98% Non-fibrous (Other)	2% Chrysotile
CPA-93-02-FT 042314918-0217	12" Tan FT	Tan Non-Fibrous Homogeneous		100% Non-fibrous (Other)	None Detected
CPA-93-02-Adhesive 042314918-0217A	12" Tan FT				Positive Stop (Not Analyzed)
CPA-94-01 042314918-0218	Textured Ceiling	White Non-Fibrous Homogeneous		100% Non-fibrous (Other)	None Detected
CPA-94-02 042314918-0219	Textured Ceiling	White Non-Fibrous Homogeneous		100% Non-fibrous (Other)	None Detected
CPA-94-03 042314918-0220	Textured Ceiling	White Non-Fibrous Homogeneous		100% Non-fibrous (Other)	None Detected
CPA-95-01-Cove Base 042314918-0221	Cove Base	Brown Non-Fibrous Homogeneous		100% Non-fibrous (Other)	None Detected
CPA-95-01-Adhesive 042314918-0221A	Adhesive	Tan Non-Fibrous Homogeneous		100% Non-fibrous (Other)	None Detected
CPA-95-02-Cove Base 042314918-0222	Cove Base	Brown Non-Fibrous Homogeneous		100% Non-fibrous (Other)	None Detected
CPA-95-02-Adhesive 042314918-0222A	Adhesive	White/Yellow Non-Fibrous Homogeneous		100% Non-fibrous (Other)	None Detected
CPA-96-01-Sheetrock 042314918-0223	Sheetrock	Brown/White Fibrous Heterogeneous	20% Cellulose 2% Glass	70% Gypsum <1% Mica 8% Non-fibrous (Other)	None Detected
CPA-96-01-Joint Compound 042314918-0223A	Joint Compound	White Non-Fibrous Homogeneous		100% Non-fibrous (Other)	<1% Chrysotile
CPA-96-02-Sheetrock 042314918-0224	Sheetrock	Brown/White Fibrous Heterogeneous	20% Cellulose	60% Gypsum 20% Non-fibrous (Other)	None Detected
CPA-96-02-Texture 042314918-0224A	Texture	White Non-Fibrous Homogeneous		100% Non-fibrous (Other)	None Detected
CPA-97-01 042314918-0225	Window Caulk	Brown Non-Fibrous Homogeneous		100% Non-fibrous (Other)	None Detected
CPA-97-02 042314918-0226	Window Caulk	Brown Non-Fibrous Homogeneous		100% Non-fibrous (Other)	None Detected
CPA-98-01-FT 042314918-0227	12x12 FT	Beige Non-Fibrous Homogeneous		98% Non-fibrous (Other)	2% Chrysotile
CPA-98-01-Adhesive 042314918-0227A	12x12 FT	Black Non-Fibrous Homogeneous		98% Non-fibrous (Other)	2% Chrysotile

Initial report from: 06/28/2023 14:59:17



EMSL Analytical, Inc.

200 Route 130 North Cinnaminson, NJ 08077
Tel/Fax: (800) 220-3675 / (856) 786-5974
<http://www.EMSL.com/cinnaslab@EMSL.com>

EMSL Order: 042314918
Customer ID: POWE54
Customer PO: 20354
Project ID:

Test Report: Asbestos Analysis of Bulk Materials via AHERA Method 40CFR 763 Subpart E Appendix E supplemented with EPA 600/R-93/116 using Polarized Light Microscopy

Sample	Description	Appearance	Non-Asbestos		Asbestos
			% Fibrous	% Non-Fibrous	% Type
CPA-98-02	12x12 FT				Positive Stop (Not Analyzed)
<i>042314918-0228</i>					
CPA-99-01	Textured Ceiling	White Non-Fibrous Homogeneous		20% Mica 80% Non-fibrous (Other)	<1% Chrysotile
<i>042314918-0229</i>					
CPA-99-02	Textured Ceiling	White Non-Fibrous Homogeneous		20% Mica 80% Non-fibrous (Other)	<1% Chrysotile
<i>042314918-0230</i>					
CPA-99-03	Textured Ceiling	Tan Non-Fibrous Homogeneous		15% Mica 85% Non-fibrous (Other)	<1% Chrysotile
<i>042314918-0231</i>					
CPA-100-01-Sheetrock	Sheetrock	Brown/White Fibrous Heterogeneous	20% Cellulose 2% Glass	70% Gypsum <1% Mica 8% Non-fibrous (Other)	None Detected
<i>042314918-0232</i>					
CPA-100-01-Joint Compound	Joint Compound	White Non-Fibrous Homogeneous		100% Non-fibrous (Other)	<1% Chrysotile
<i>042314918-0232A</i>					
CPA-100-02-Sheetrock	Sheetrock	Brown/White Fibrous Heterogeneous	20% Cellulose 3% Glass	60% Gypsum 17% Non-fibrous (Other)	None Detected
<i>042314918-0233</i>					
CPA-100-02-Joint Compound	Joint Compound	White Non-Fibrous Homogeneous		100% Non-fibrous (Other)	<1% Chrysotile
<i>042314918-0233A</i>					
CPA-101-01-Cove Base	Cove Base	Black Non-Fibrous Homogeneous		100% Non-fibrous (Other)	None Detected
<i>042314918-0234</i>					
CPA-101-01-Adhesive	Adhesive	Tan Non-Fibrous Homogeneous		100% Non-fibrous (Other)	None Detected
<i>042314918-0234A</i>					
CPA-101-02-Cove Base	Cove Base	Black Non-Fibrous Homogeneous		100% Non-fibrous (Other)	None Detected
<i>042314918-0235</i>					
CPA-101-02-Adhesive	Adhesive	Tan Non-Fibrous Homogeneous		100% Non-fibrous (Other)	None Detected
<i>042314918-0235A</i>					
CPA-102-01	Window Caulk	White Non-Fibrous Homogeneous		100% Non-fibrous (Other)	None Detected
<i>042314918-0236</i>					
CPA-102-02	Window Caulk	White Non-Fibrous Homogeneous		100% Non-fibrous (Other)	None Detected
<i>042314918-0237</i>					
CPA-103-01-FT	12x12 Tan FT	Tan Non-Fibrous Homogeneous		100% Non-fibrous (Other)	None Detected
<i>042314918-0238</i>					
CPA-103-01-Adhesive	Adhesive	Tan/Black Non-Fibrous Homogeneous		100% Non-fibrous (Other)	<1% Chrysotile
<i>042314918-0238A</i>					
CPA-103-02-FT	12x12 Tan FT	Brown Non-Fibrous Homogeneous		100% Non-fibrous (Other)	None Detected
<i>042314918-0239</i>					
CPA-103-02-Adhesive	Adhesive	Tan/Black Non-Fibrous Homogeneous		100% Non-fibrous (Other)	<1% Chrysotile
<i>042314918-0239A</i>					

Initial report from: 06/28/2023 14:59:17



EMSL Analytical, Inc.

200 Route 130 North Cinnaminson, NJ 08077

Tel/Fax: (800) 220-3675 / (856) 786-5974

<http://www.EMSL.com/cinnasblab@EMSL.com>

EMSL Order: 042314918
Customer ID: POWE54
Customer PO: 20354
Project ID:

Test Report: Asbestos Analysis of Bulk Materials via AHERA Method 40CFR 763 Subpart E Appendix E supplemented with EPA 600/R-93/116 using Polarized Light Microscopy

Sample	Description	Appearance	Non-Asbestos		Asbestos
			% Fibrous	% Non-Fibrous	% Type
CPA-104-01-Sheetrock 042314918-0240	Sheetrock	Brown/White Fibrous Heterogeneous	20% Cellulose 2% Glass	70% Gypsum <1% Mica 8% Non-fibrous (Other)	None Detected
CPA-104-01-Joint Compound 042314918-0240A	Joint Compound	White Non-Fibrous Homogeneous		100% Non-fibrous (Other)	<1% Chrysotile
CPA-104-02-Sheetrock 042314918-0241	Sheetrock	Brown/White Fibrous Heterogeneous	20% Cellulose 2% Glass	60% Gypsum 18% Non-fibrous (Other)	None Detected
CPA-104-02-Joint Compound 042314918-0241A	Joint Compound	White Non-Fibrous Homogeneous		100% Non-fibrous (Other)	<1% Chrysotile
CPA-105-01 042314918-0242	Textured Ceiling	White Non-Fibrous Homogeneous		100% Non-fibrous (Other)	None Detected
CPA-105-02 042314918-0243	Textured Ceiling	White Non-Fibrous Homogeneous		100% Non-fibrous (Other)	None Detected
CPA-105-03 042314918-0244	Textured Ceiling	White Non-Fibrous Homogeneous		100% Non-fibrous (Other)	None Detected
CPA-106-01 042314918-0245	Window Caulk	Gray Non-Fibrous Homogeneous		100% Non-fibrous (Other)	None Detected
CPA-106-02 042314918-0246	Window Caulk	Gray Non-Fibrous Homogeneous		100% Non-fibrous (Other)	None Detected
CPA-107-01-Adhesive 042314918-0247	12x12 FT - Top Layer	Yellow Non-Fibrous Homogeneous		100% Non-fibrous (Other)	None Detected
CPA-107-01-FT 042314918-0247A	12x12 FT - Top Layer	Tan Non-Fibrous Homogeneous		100% Non-fibrous (Other)	None Detected
CPA-107-01-Adhesive 042314918-0247B	12x12 FT - Top Layer	Tan/Black Non-Fibrous Homogeneous		100% Non-fibrous (Other)	<1% Chrysotile
CPA-107-02 042314918-0248	12x12 FT - Top Layer	Brown Non-Fibrous Homogeneous		100% Non-fibrous (Other)	None Detected
CPA-108-01 042314918-0249	12x12 FT - 2nd Layer	Tan Non-Fibrous Homogeneous		100% Non-fibrous (Other)	None Detected
CPA-108-02-Adhesive 042314918-0250	12x12 FT - 2nd Layer	Tan Non-Fibrous Homogeneous		100% Non-fibrous (Other)	None Detected
CPA-108-02-FT 042314918-0250A	12x12 FT - 2nd Layer	Beige Non-Fibrous Homogeneous		100% Non-fibrous (Other)	None Detected
CPA-108-02-Adhesive 042314918-0250B	12x12 FT - 2nd Layer	Black Non-Fibrous Homogeneous		100% Non-fibrous (Other)	<1% Chrysotile
CPA-109-01 042314918-0251	Textured Ceiling	White Non-Fibrous Homogeneous		100% Non-fibrous (Other)	None Detected

Initial report from: 06/28/2023 14:59:17



EMSL Analytical, Inc.

200 Route 130 North Cinnaminson, NJ 08077

Tel/Fax: (800) 220-3675 / (856) 786-5974

http://www.EMSL.com / cinnaslab@EMSL.com

EMSL Order: 042314918
 Customer ID: POWE54
 Customer PO: 20354
 Project ID:

Test Report: Asbestos Analysis of Bulk Materials via AHERA Method 40CFR 763 Subpart E Appendix E supplemented with EPA 600/R-93/116 using Polarized Light Microscopy

Sample	Description	Appearance	Non-Asbestos		Asbestos
			% Fibrous	% Non-Fibrous	% Type
CPA-109-02 <small>042314918-0252</small>	Textured Ceiling	White Non-Fibrous Homogeneous		100% Non-fibrous (Other)	None Detected
CPA-109-03 <small>042314918-0253</small>	Textured Ceiling	White Non-Fibrous Homogeneous		100% Non-fibrous (Other)	None Detected
CPA-110-01-Sheetrock <small>042314918-0254</small>	Sheetrock	Brown/White Fibrous Heterogeneous	20% Cellulose <1% Glass	75% Gypsum <1% Mica 5% Non-fibrous (Other)	None Detected
CPA-110-01-Joint Compound <small>042314918-0254A</small>	Joint Compound	White Non-Fibrous Homogeneous		100% Non-fibrous (Other)	<1% Chrysotile
CPA-110-02-Sheetrock <small>042314918-0255</small>	Sheetrock	Brown/White Fibrous Heterogeneous	30% Cellulose <1% Glass	50% Gypsum 20% Non-fibrous (Other)	None Detected
CPA-110-02-Joint Compound <small>042314918-0255A</small>	Joint Compound	White Non-Fibrous Homogeneous		100% Non-fibrous (Other)	<1% Chrysotile
CPA-111-01-Cove Base <small>042314918-0256</small>	Cove Base	Brown Non-Fibrous Homogeneous		100% Non-fibrous (Other)	None Detected
CPA-111-01-Adhesive <small>042314918-0256A</small>	Adhesive	Tan Non-Fibrous Homogeneous		100% Non-fibrous (Other)	None Detected
CPA-111-02-Cove Base <small>042314918-0257</small>	Cove Base	Brown Non-Fibrous Homogeneous		100% Non-fibrous (Other)	None Detected
CPA-111-02-Adhesive <small>042314918-0257A</small>	Adhesive	Tan Non-Fibrous Homogeneous		100% Non-fibrous (Other)	None Detected
CPA-112-01 <small>042314918-0258</small>	Window Caulk	White Non-Fibrous Homogeneous		100% Non-fibrous (Other)	None Detected
CPA-112-02 <small>042314918-0259</small>	Window Caulk	White Non-Fibrous Homogeneous		100% Non-fibrous (Other)	None Detected
CPA-113-01-Sheetrock <small>042314918-0260</small>	Sheetrock	Brown/White Fibrous Heterogeneous	30% Cellulose	65% Gypsum 5% Non-fibrous (Other)	None Detected
CPA-113-01-Joint Compound <small>042314918-0260A</small>	Joint Compound	White Non-Fibrous Homogeneous		100% Non-fibrous (Other)	None Detected
CPA-113-02-Sheetrock <small>042314918-0261</small>	Sheetrock	Brown/White Fibrous Heterogeneous	30% Cellulose	50% Gypsum 20% Non-fibrous (Other)	None Detected
CPA-113-02-Texture <small>042314918-0261A</small>	Texture	White Non-Fibrous Homogeneous		100% Non-fibrous (Other)	<1% Chrysotile
CPA-114-01 <small>042314918-0262</small>	Textured Ceiling	White Non-Fibrous Homogeneous		100% Non-fibrous (Other)	<1% Chrysotile
CPA-114-02 <small>042314918-0263</small>	Textured Ceiling	White Non-Fibrous Homogeneous		100% Non-fibrous (Other)	<1% Chrysotile

Initial report from: 06/28/2023 14:59:17



EMSL Analytical, Inc.

200 Route 130 North Cinnaminson, NJ 08077
Tel/Fax: (800) 220-3675 / (856) 786-5974
<http://www.EMSL.com/cinnaslab@EMSL.com>

EMSL Order: 042314918
Customer ID: POWE54
Customer PO: 20354
Project ID:

Test Report: Asbestos Analysis of Bulk Materials via AHERA Method 40CFR 763 Subpart E Appendix E supplemented with EPA 600/R-93/116 using Polarized Light Microscopy

Sample	Description	Appearance	Non-Asbestos		Asbestos % Type
			% Fibrous	% Non-Fibrous	
CPA-114-03 042314918-0264	Textured Ceiling	Tan Non-Fibrous Homogeneous		100% Non-fibrous (Other)	<1% Chrysotile
CPA-115-01 042314918-0265	Window Caulk	Brown/White/Red Non-Fibrous Homogeneous		100% Non-fibrous (Other)	None Detected
CPA-115-02 042314918-0266	Window Caulk	Brown/White Non-Fibrous Homogeneous		100% Non-fibrous (Other)	None Detected
CPA-116-01-FT 042314918-0267	12x12 White FT - Top	White Non-Fibrous Homogeneous		100% Non-fibrous (Other)	None Detected
CPA-116-01-Adhesive 042314918-0267A	Adhesive	Tan Non-Fibrous Homogeneous		100% Non-fibrous (Other)	None Detected
CPA-116-02-FT 042314918-0268	12x12 White FT - Top	White Non-Fibrous Homogeneous		100% Non-fibrous (Other)	None Detected
CPA-116-02-Adhesive 042314918-0268A	Adhesive	Tan/Black Non-Fibrous Homogeneous		100% Non-fibrous (Other)	<1% Chrysotile
CPA-117-01-FT 042314918-0269	12x12 White FT - 2nd Layer	Gray/White Non-Fibrous Homogeneous		100% Non-fibrous (Other)	None Detected
CPA-117-01-Adhesive 042314918-0269A	Adhesive	Tan Non-Fibrous Homogeneous		100% Non-fibrous (Other)	None Detected
CPA-117-02-Adhesive 042314918-0270	Adhesive	Yellow Non-Fibrous Homogeneous		100% Non-fibrous (Other)	None Detected
CPA-117-02-FT 042314918-0270A	12x12 White FT - 2nd Layer	White Non-Fibrous Homogeneous		100% Non-fibrous (Other)	None Detected
CPA-117-02-Adhesive 042314918-0270B	Adhesive	Tan/Black Non-Fibrous Homogeneous		100% Non-fibrous (Other)	<1% Chrysotile
CPA-118-01 042314918-0271	Textured Ceiling	White Non-Fibrous Homogeneous		100% Non-fibrous (Other)	<1% Chrysotile
CPA-118-02 042314918-0272	Textured Ceiling	White Non-Fibrous Homogeneous		100% Non-fibrous (Other)	<1% Chrysotile
CPA-118-03 042314918-0273	Textured Ceiling	White Non-Fibrous Homogeneous		100% Non-fibrous (Other)	<1% Chrysotile
CPA-119-01-Sheetrock 042314918-0274	Sheetrock	Brown Fibrous Heterogeneous	20% Cellulose	75% Gypsum 5% Non-fibrous (Other)	None Detected
CPA-119-01-Joint Compound 042314918-0274A	Joint Compound	White Non-Fibrous Homogeneous		100% Non-fibrous (Other)	<1% Chrysotile
CPA-119-02-Sheetrock 042314918-0275	Sheetrock	Brown Fibrous Heterogeneous	40% Cellulose	40% Gypsum 20% Non-fibrous (Other)	None Detected

Initial report from: 06/28/2023 14:59:17



EMSL Analytical, Inc.

200 Route 130 North Cinnaminson, NJ 08077

Tel/Fax: (800) 220-3675 / (856) 786-5974

http://www.EMSL.com / cinnaslab@EMSL.com

EMSL Order: 042314918
Customer ID: POWE54
Customer PO: 20354
Project ID:

Test Report: Asbestos Analysis of Bulk Materials via AHERA Method 40CFR 763 Subpart E Appendix E supplemented with EPA 600/R-93/116 using Polarized Light Microscopy

Sample	Description	Appearance	Non-Asbestos		Asbestos
			% Fibrous	% Non-Fibrous	% Type
CPA-119-02-Joint Compound	Joint Compound	White Non-Fibrous Homogeneous		100% Non-fibrous (Other)	<1% Chrysotile
<i>042314918-0275A</i>					
CPA-120-01	Window Caulk	Tan/White Non-Fibrous Homogeneous		100% Non-fibrous (Other)	<1% Chrysotile
<i>042314918-0276</i>					
CPA-120-02	Window Caulk	Tan/White Non-Fibrous Homogeneous		100% Non-fibrous (Other)	<1% Chrysotile
<i>042314918-0277</i>					

Analyst(s) _____

- Alison Pacey (86)
- Amanda Straw (74)
- Hilary Jarvis (29)
- Hannah Morgan (42)
- Paul Rihm (48)
- Ross Matlock (117)

Samantha Rundstrom, Laboratory Manager
or Other Approved Signatory

EMSL maintains liability limited to cost of analysis. Interpretation and use of test results are the responsibility of the client. This report relates only to the samples reported above, and may not be reproduced, except in full, without written approval by EMSL. EMSL bears no responsibility for sample collection activities or analytical method limitations. The report reflects the samples as received. Results are generated from the field sampling data (sampling volumes and areas, locations, etc.) provided by the client on the Chain of Custody. Samples are within quality control criteria and met method specifications unless otherwise noted. The above analyses were performed in general compliance with Appendix E to Subpart E of 40 CFR (previously EPA 600/M4-82-020 "Interim Method") but augmented with procedures outlined in the 1993 ("final") version of the method. This report must not be used by the client to claim product certification, approval, or endorsement by NVLAP, NIST or any agency of the federal government. Non-friable organically bound materials present a problem matrix and therefore EMSL recommends gravimetric reduction prior to analysis. Unless requested by the client, building materials manufactured with multiple layers (i.e. linoleum, wallboard, etc.) are reported as a single sample. Estimation of uncertainty is available on request.

Samples analyzed by EMSL Analytical, Inc. Indianapolis, IN NVLAP Lab Code 200188-0, AZ0939, CA 2575, CO AL-15132, TX 300262, A2LA Accredited - Certificate #2845.25

Initial report from: 06/28/2023 14:59:17

APPENDIX 4.2
Site Plan Figure

REVISIONS:	

PROJECT #: 25745.03
 DATE: June 2023
 DRAWN BY: BS
 DESIGNED: [blank]
 CHECKED BY: MN



COMMUNITY APARTMENTS
 HUGHES SPELLING, LLC
 MCCOMB, MISSISSIPPI

SCALE:

SHEET NUMBER:
 1

DESCRIPTION:
 Site Map

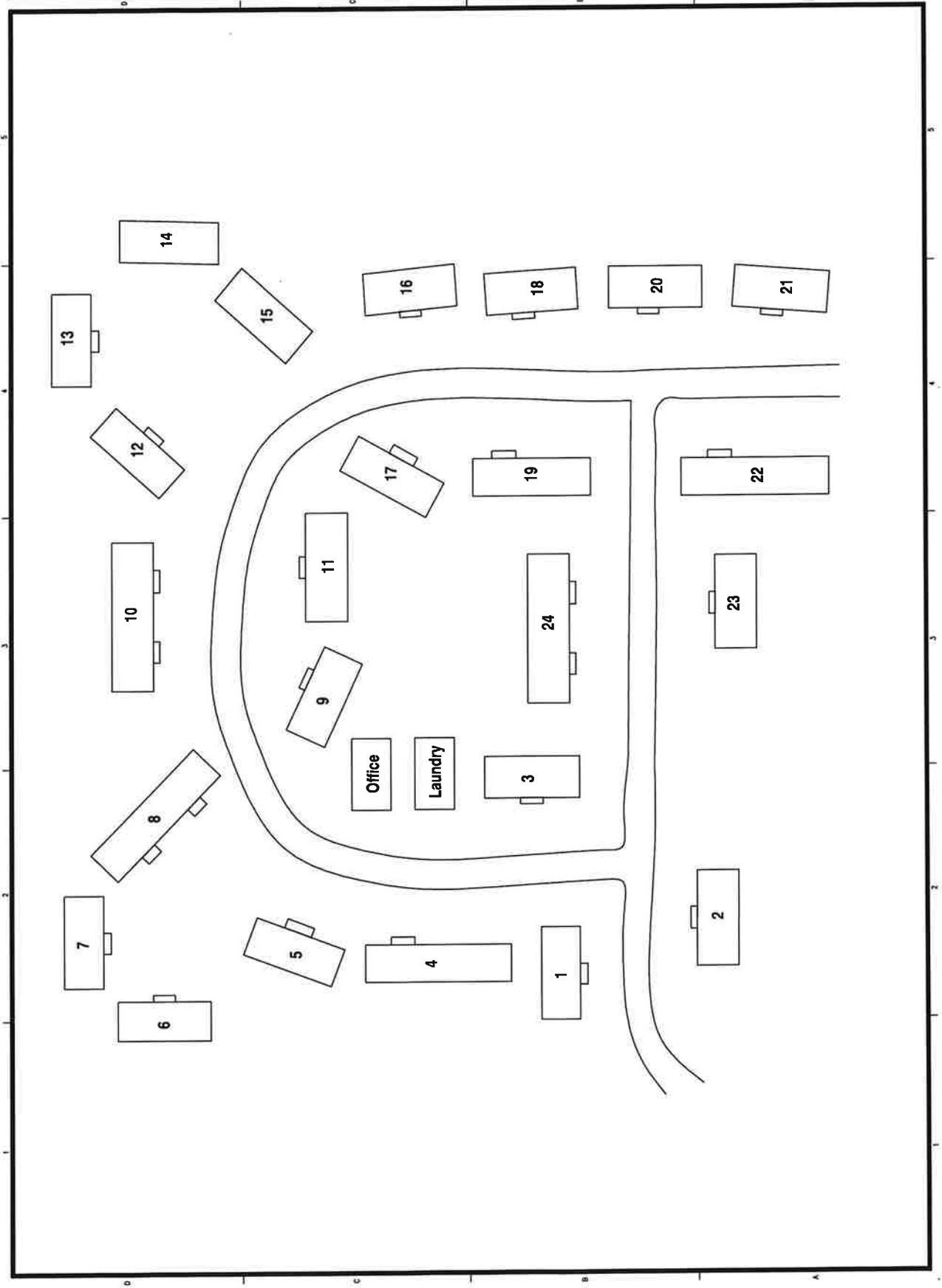

APPENDIX 4.3
Mississippi Asbestos Inspector Certification

State of Mississippi

*Department of Environmental Quality
Office of Pollution Control*

Certificate of Licensure

In accordance with the Asbestos Abatement Accreditation and Certification Act,
Enacted as 1989 Mississippi Law, Chapter 505

Be it known that

Martin A. Cooke

Having submitted acceptable evidence of qualifications and
training and other appropriate information, is hereby granted this

***Asbestos Inspector
Certification***



*Certificate No.: ABI-00002227
Expiration Date: Jan 19th, 2023
Training Expires on Jan 19th, 2023*

Chief, Asbestos & Lead Branch

40586 LIC20220003

State of Mississippi

*Department of Environmental Quality
Office of Pollution Control*

Certificate of Licensure

In accordance with the Asbestos Abatement Accreditation and Certification Act,
Enacted as 1989 Mississippi Law, Chapter 505

Be it known that

Willie J. Nester

Having submitted acceptable evidence of qualifications and
training and other appropriate information, is hereby granted this

*Asbestos Management Planner
Certification*



*Certificate No.: AMP-00002245
Expiration Date: Jan 19th, 2023
Training Expires on Jan 19th, 2023*

Chief, Asbestos & Lead Branch

40546 LIC20220001

State of Mississippi

*Department of Environmental Quality
Office of Pollution Control*

Certificate of Licensure

In accordance with the Asbestos Abatement Accreditation and Certification Act,
Enacted as 1989 Mississippi Law, Chapter 505

Be it known that

Taylor S Walker

Having submitted acceptable evidence of qualifications and
training and other appropriate information, is hereby granted this

*Asbestos Inspector
Certification*



*Certificate No.: ABI-00012021
Expiration Date: Mar 29th, 2024
Training Expires on Mar 29th, 2024*

Chief, Asbestos & Lead Branch

83748 LIC20230001



DYKE NELSON ARCHITECTURE 235 SOUTH 14TH ST. BATON ROUGE, LA 70802-DNA-WORKSHOP.COM | 225.224.3363

COMMUNITY PARK 17 GILLIS CIR MCCOMB, MISSISSIPPI

SECTIONS

JOB NUMBER: 25011
 ISSUED: 02/10/22
 PRELIMINARY
 NOT FOR CONSTRUCTION

DATE: 02/10/22
 DRAWN BY: J. W. NELSON
 CHECKED BY: J. W. NELSON
 PROJECT: COMMUNITY PARK
 17 GILLIS CIR MCCOMB, MISSISSIPPI
 2022-02-10 10:00 AM
 2022-02-10 10:00 AM
 2022-02-10 10:00 AM

DEVELOPER: SITE PLAN
 A100
 PHASE: 1

NOTES:

1. ALL CONSTRUCTION SHALL BE IN ACCORDANCE WITH THE LATEST EDITIONS OF THE MISSISSIPPI BUILDING CODE AND ALL APPLICABLE LOCAL ORDINANCES. THE CONTRACTOR SHALL BE RESPONSIBLE FOR OBTAINING ALL NECESSARY PERMITS AND APPROVALS FROM THE LOCAL JURISDICTIONS. THE CONTRACTOR SHALL BE RESPONSIBLE FOR OBTAINING ALL NECESSARY PERMITS AND APPROVALS FROM THE LOCAL JURISDICTIONS. THE CONTRACTOR SHALL BE RESPONSIBLE FOR OBTAINING ALL NECESSARY PERMITS AND APPROVALS FROM THE LOCAL JURISDICTIONS.

2. THE CONTRACTOR SHALL BE RESPONSIBLE FOR OBTAINING ALL NECESSARY PERMITS AND APPROVALS FROM THE LOCAL JURISDICTIONS. THE CONTRACTOR SHALL BE RESPONSIBLE FOR OBTAINING ALL NECESSARY PERMITS AND APPROVALS FROM THE LOCAL JURISDICTIONS. THE CONTRACTOR SHALL BE RESPONSIBLE FOR OBTAINING ALL NECESSARY PERMITS AND APPROVALS FROM THE LOCAL JURISDICTIONS.

3. THE CONTRACTOR SHALL BE RESPONSIBLE FOR OBTAINING ALL NECESSARY PERMITS AND APPROVALS FROM THE LOCAL JURISDICTIONS. THE CONTRACTOR SHALL BE RESPONSIBLE FOR OBTAINING ALL NECESSARY PERMITS AND APPROVALS FROM THE LOCAL JURISDICTIONS. THE CONTRACTOR SHALL BE RESPONSIBLE FOR OBTAINING ALL NECESSARY PERMITS AND APPROVALS FROM THE LOCAL JURISDICTIONS.

4. THE CONTRACTOR SHALL BE RESPONSIBLE FOR OBTAINING ALL NECESSARY PERMITS AND APPROVALS FROM THE LOCAL JURISDICTIONS. THE CONTRACTOR SHALL BE RESPONSIBLE FOR OBTAINING ALL NECESSARY PERMITS AND APPROVALS FROM THE LOCAL JURISDICTIONS. THE CONTRACTOR SHALL BE RESPONSIBLE FOR OBTAINING ALL NECESSARY PERMITS AND APPROVALS FROM THE LOCAL JURISDICTIONS.

5. THE CONTRACTOR SHALL BE RESPONSIBLE FOR OBTAINING ALL NECESSARY PERMITS AND APPROVALS FROM THE LOCAL JURISDICTIONS. THE CONTRACTOR SHALL BE RESPONSIBLE FOR OBTAINING ALL NECESSARY PERMITS AND APPROVALS FROM THE LOCAL JURISDICTIONS. THE CONTRACTOR SHALL BE RESPONSIBLE FOR OBTAINING ALL NECESSARY PERMITS AND APPROVALS FROM THE LOCAL JURISDICTIONS.

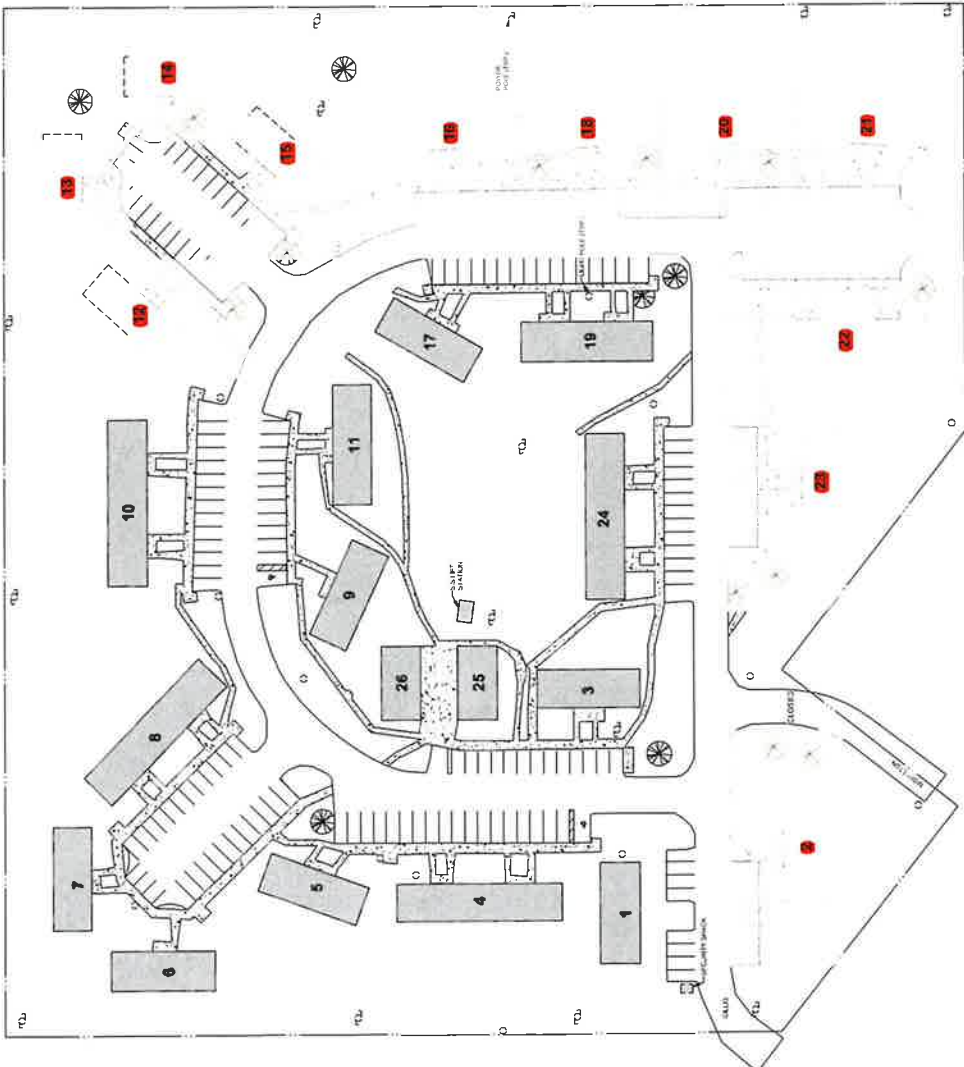

Building to be demolished (H)

1 18
 2 19
 3 20
 4 21
 5 22
 6 23

EXISTING SITE PLAN
 1" = 40'-0"

