

APPLICANT IS THE: OWNER PRIME CONTRACTOR

OWNER CONTACT INFORMATION

OWNER CONTACT PERSON: James Pennington
OWNER COMPANY LEGAL NAME: Stella-Jones Corporation
OWNER STREET OR P.O. BOX: 17156 Highway 51
OWNER CITY: Durant STATE: MS ZIP: 39063
OWNER PHONE #: (870) 678-3885 OWNER EMAIL: jpennington@stella-jones.com

PREPARER CONTACT INFORMATION

IF NOI WAS PREPARED BY SOMEONE OTHER THAN THE APPLICANT
CONTACT PERSON: Alicia Gibson, PE
COMPANY LEGAL NAME: Evergreen Engineering, Inc.
STREET OR P.O. BOX: 8607 Roberts Drive, Suite 100
CITY: Atlanta STATE: GA ZIP: 30350
PHONE # () (404) 376-4875 EMAIL: agibson@evergreenengineering.com

PRIME CONTRACTOR CONTACT INFORMATION

PRIME CONTRACTOR CONTACT PERSON: Brandon Hodges
PRIME CONTRACTOR COMPANY LEGAL NAME: Hodges Rock Solid Land Services
PRIME CONTRACTOR STREET OR P.O. BOX: 9937 Hwy 411
PRIME CONTRACTOR CITY: McCool STATE: MS ZIP: 39108
PRIME CONTRACTOR PHONE #: (662) 739-8215 PRIME CONTRACTOR EMAIL: brandonhodges21@yahoo.com

FACILITY SITE INFORMATION

FACILITY SITE NAME: Stella-Jones
FACILITY SITE ADDRESS (If the physical address is not available, please indicate the nearest named road. For linear projects indicate the beginning of the project and identify all counties the project traverses.)
STREET: 17156 US 51
CITY: Durant STATE: MS COUNTY: Holmes ZIP: 39063
FACILITY SITE TRIBAL LAND ID (N/A If not applicable): N/A
LATITUDE: 33 degrees 05 minutes 54 seconds LONGITUDE: 89 degrees 50 minutes 24 seconds
LAT & LONG DATA SOURCE (GPS (Please GPS Project Entrance/Start Point) or Map Interpolation): GPS
TOTAL ACREAGE THAT WILL BE DISTURBED !: 9 Acres (+/-)

m

IS THIS PART OF A LARGER COMMON PLAN OF DEVELOPMENT? YES NO

IF YES, NAME OF LARGER COMMON PLAN OF DEVELOPMENT: _____
 AND PERMIT COVERAGE NUMBER: MSR10 _____

ESTIMATED CONSTRUCTION PROJECT START DATE: 2022-08-22
 YYYY-MM-DD

ESTIMATED CONSTRUCTION PROJECT END DATE: 2023-02-22
 YYYY-MM-DD

DESCRIPTION OF CONSTRUCTION ACTIVITY: Grading and drainage improvements, installing of gravel roads and laydown areas, installing new processing equipment

PROPOSED DESCRIPTION OF PROPERTY USE AFTER CONSTRUCTION HAS BEEN COMPLETED:
Log storage and pole processing

SIC Code: 2411 NAICS Code 331999

NEAREST NAMED RECEIVING STREAM: Big Black River

IS RECEIVING STREAM ON MISSISSIPPI'S 303(d) LIST OF IMPAIRED WATER BODIES? (The 303(d) list of impaired waters and TMDL stream segments may be found on MDEQ's website: http://www.deq.state.ms.us/MDEQ.nsf/page/TWB_Total_Maximum_Daily_Load_Section) YES NO

HAS A TMDL BEEN ESTABLISHED FOR THE RECEIVING STREAM SEGMENT? YES NO

FOR WHICH POLLUTANT:

ARE THERE RECREATIONAL STREAMS, PRIVATE/PUBLIC PONDS OR LAKES WITHIN 1/2 MILE DOWNSTREAM OF PROJECT BOUNDARY THAT MAY BE IMPACTED BY THE CONSTRUCTION ACTIVITY? YES NO

EXISTING DATA DESCRIBING THE SOIL (for linear projects please describe in SWPPP):
Silty clay with occasional areas of sandy clay and silty sand

WILL FLOCCULANTS BE USED TO TREAT TURBIDITY IN STORM WATER? YES NO

IF YES, INDICATE THE TYPE OF FLOCCULANT. ANIONIC POLYACRYLAMIDE (PAM)
 OTHER _____

IF YES, DOES THE SWPPP DESCRIBE THE METHOD OF INTRODUCTION, THE LOCATION OF INTRODUCTION AND THE LOCATION OF WHERE FLOCCULATED MATERIAL WILL SETTLE?

IS A SDS SHEET INCLUDED FOR THE FLOCCULATE? YES NO

WILL THERE BE A 50 FT BUFFER BETWEEN THE PROJECT DISTURBANCE AND THE WATERS OF THE STATE? YES NO

IF NOT, PROVIDE EQUIVALENT CONTROL MEASURES IN THE SWPPP.

¹Acreage for subdivision development includes areas disturbed by construction of roads, utilities and drainage. Additionally, a housesite of at least 10,000 ft² per lot (entire lot, if smaller) shall be included in calculating acreage disturbed.

DOCUMENTATION OF COMPLIANCE WITH OTHER REGULATIONS/REQUIREMENTS
 COVERAGE UNDER THIS PERMIT WILL NOT BE GRANTED UNTIL ALL OTHER REQUIRED
 MDEQ PERMITS AND APPROVALS ARE SATISFACTORILY ADDRESSED

IS LCNOI FOR A FACILITY THAT WILL REQUIRE OTHER PERMITS? YES NO

IF YES, CHECK ALL THAT APPLY: AIR HAZARDOUS WASTE PRETREATMENT
 WATER STATE OPERATING INDIVIDUAL NPDES OTHER: _____

IS THE PROJECT REROUTING, FILLING OR CROSSING A WATER CONVEYANCE OF ANY KIND? (If yes, contact the U.S. Army Corps of Engineers' Regulatory Branch for permitting requirements.) YES NO

IF THE PROJECT REQUIRES A CORPS OF ENGINEER SECTION 404 PERMIT, PROVIDE APPROPRIATE DOCUMENTATION THAT:

- The project has been approved by individual permit, or
- The work will be covered by a nationwide permit and NO NOTIFICATION to the Corps is required, or
- The work will be covered by a nationwide or general permit and NOTIFICATION to the Corps is required

IS THE PROJECT REROUTING, FILLING OR CROSSING A STATE WATER CONVEYANCE OF ANY KIND? (If yes, please provide an antidegradation report.) YES NO

IS A LAKE REQUIRING THE CONSTRUCTION OF A DAM BEING PROPOSED? (If yes, provide appropriate approval documentation from MDEQ Office of Land and Water, Dam Safety.) YES NO

IF THE PROJECT IS A SUBDIVISION OR A COMMERCIAL DEVELOPMENT, HOW WILL SANITARY SEWAGE BE DISPOSED? Check one of the following and attach the pertinent documents.

- Existing Municipal or Commercial System. Please attach plans and specifications for the collection system and the associated "Information Regarding Proposed Wastewater Projects" form or approval from County Utility Authority in Hancock, Harrison, Jackson, Pearl River and Stone Counties. If the plans and specifications can not be provided at the time of LCNOI submittal, MDEQ will accept written acknowledgement from official(s) responsible for wastewater collection and treatment that the flows generated from the proposed project can and will be transported and treated properly. The letter must include the estimated flow.
- Collection and Treatment System will be Constructed. Please attach a copy of the cover of the NPDES discharge permit from MDEQ or indicate the date the application was submitted to MDEQ (Date: _____.)
- Individual Onsite Wastewater Disposal Systems for Subdivisions Less than 35 Lots. Please attach a copy of the Letter of General Acceptance from the Mississippi State Department of Health or certification from a registered professional engineer that the platted lots should support individual onsite wastewater disposal systems.
- Individual Onsite Wastewater Disposal Systems for Subdivisions Greater than 35 Lots. A determination of the feasibility of installing a central sewage collection and treatment system must be made by MDEQ. A copy of the response from MDEQ concerning the feasibility study must be attached. If a central collection and wastewater system is not feasible, then please attach a copy of the Letter of General Acceptance from the State Department of Health or certification from a registered professional engineer that the platted lots should support individual onsite wastewater disposal systems.

INDICATE ANY LOCAL STORM WATER ORDINANCE (I.E. MS4) WITH WHICH THE PROJECT MUST COMPLY:

N/A

I certify under penalty of law that this document and all attachments were prepared under my direction or supervision in accordance with a system designed to assure that qualified personnel properly gathered and evaluated the information submitted. Based on my inquiry of the person or persons who manage the system, or those persons directly responsible for gathering the information, the information submitted is, to the best of my knowledge and belief, true, accurate and complete. I am aware that there are significant penalties for submitting false information, including the possibility of fine and imprisonment for knowing violations.

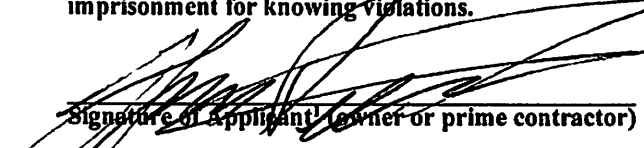
Signature of Applicant (owner or prime contractor)
Glynn Pittman
Printed Name

8/22/2022
Date Signed
Vice President of Operations
Title

1This application shall be signed as follows:

- For a corporation, by a responsible corporate officer.
- For a partnership, by a general partner.
- For a sole proprietorship, by the proprietor.

For a municipal, state or other public facility, by principal executive officer, mayor, or ranking elected official

Please submit the LCNOI form to:

**Chief, Environmental Permits Division
MS Department of Environmental Quality, Office of Pollution Control
P.O. Box 2261
Jackson, Mississippi 39225**

Electronically:

<https://www.mdeq.ms.gov/construction-stormwater/>

Revised 3/23/22



U.S. DEPARTMENT OF THE INTERIOR
U.S. GEOLOGICAL SURVEY

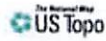

DURANT QUADRANGLE
MISSISSIPPI
7.5-MINUTE SERIES

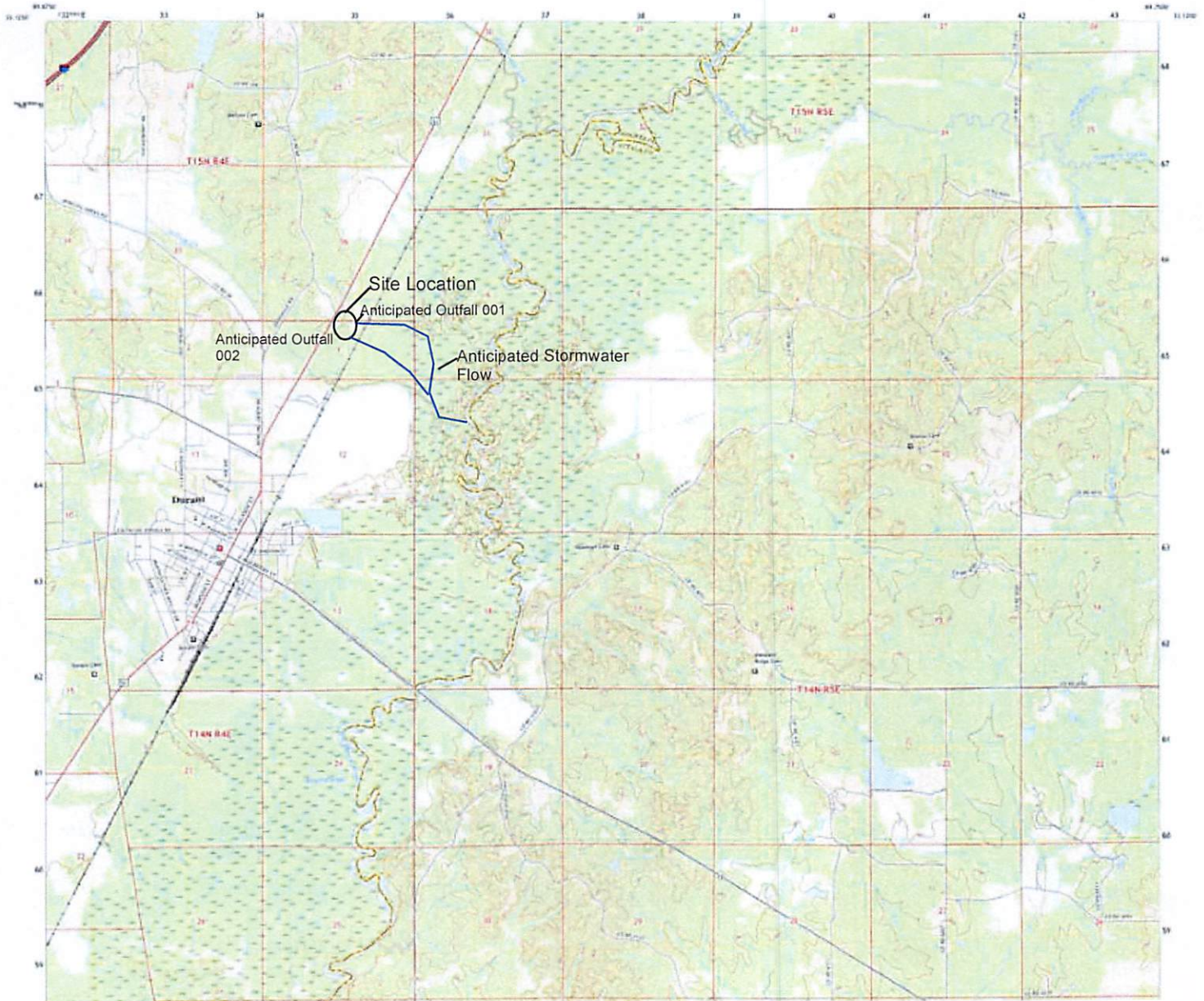

Produced by the United States Geological Survey

North American Datum of 1983 (NAD83)
Vertical Datum: Mean Sea Level (MSL)
Horizontal Datum: NAD83
Scale: 1:24,000
Projection: UTM
Zone: 18N
Datum: NAD83
Units: Meters
Datum: NAD83
Units: Meters
Datum: NAD83
Units: Meters



SCALE 1:24,000
VERTICAL DATUM: MEAN SEA LEVEL
HORIZONTAL DATUM: NAD83
UNIT: METERS

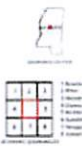

ROAD CLASSIFICATION

Expressway	Local Connector
Arterial Road	Local Road
Major	Minor
Interstate Road	State Road

DURANT, MS
2020





GENERAL NOTES

- CONTRACTOR SHALL MAINTAIN ALL EROSION CONTROL MEASURES AS OUTLINED IN THE STORM WATER POLLUTION PREVENTION PLAN.
- CONTRACTOR SHALL BE RESPONSIBLE FOR REMOVAL OF MUD TRACKED ONTO PUBLIC RIGHT-OF-WAY ON A TIMELY BASIS.
- ADDITIONAL PROTECTION: CONTRACTOR IS RESPONSIBLE FOR INSTALLING AND MAINTAINING ANY ADDITIONAL EROSION CONTROL MEASURES OTHER THAN THOSE SHOWN ON THESE PLANS TO INSURE THAT SEDIMENT IS CONFINED TO THE SITE.
- IF THE ACTION OF VEHICLES TRAVELING OVER THE CRUSHED STONE CONSTRUCTION EXIT POINT IS NOT SUFFICIENT TO REMOVE THE MAJORITY OF DIRT AND MUD FROM THE EXITING TRAFFIC, THE CONTRACTOR SHALL PROVIDE HOSE BARRIERS AT THIS EXIT POINT AND WASH TRIES BEFORE THE VEHICLES ENTER A PUBLIC ROAD. PROVISIONS SHALL BE MADE TO INTERCEPT THE WASH WATER AND TRAP THE SEDIMENT BEFORE IT IS CARRIED OFF THE SITE.
- IF SOIL STABILIZER IS USED ON THE SITE, SILT FENCES SHALL BE USED TO CONTROL AND CONTAIN THE SEDIMENT.
- TEMPORARY EROSION AND SEDIMENT CONTROL MEASURES SHALL BE REMOVED AND DEPOSED OF WITHIN 30 DAYS AFTER FINAL STABILIZATION. FINAL STABILIZATION HAS OCCURRED WHEN ALL SOIL DISTURBING ACTIVITIES ARE COMPLETED AND A UNIFORM PERENNIAL VEGETATIVE COVER WITH A DENSITY OF 70% FOR UNPAVED AREAS AND AREAS NOT COVERED BY PERMANENT STRUCTURES HAS BEEN ESTABLISHED.
- THE EROSION CONTROL PLAN IS TO BE USED BY THE CONTRACTOR AS A MINIMUM GUIDELINE AND SHALL NOT BE USED AS A CONCLUSIVE OUTLINE. THE CONTRACTOR SHALL BE RESPONSIBLE FOR PROVIDING ADDITIONAL EROSION CONTROL METHODS AND/OR PRODUCTS NEEDED DUE TO UNFORESEEN CONSTRUCTION PROCEDURES.

SITE SPECIFIC NOTES

- TOTAL AREA OF THIS PROPERTY IS 18.65 ACRES.
- THIS SITE ACCEPTS WATER FROM NEIGHBORING PROPERTIES. ALL WATER FLOWING FROM OFF-SITE IS CAUGHT IN EXISTING DITCHES AS SHOWN ON THE PLAN.
- ALL WATER DISCHARGES FROM THIS SITE BY WAY OF EXISTING DITCHES LOCATED AT THE SOUTH-EAST CORNER AND THE NORTH-EAST CORNERS OF THE PROPERTY ACCEPT FOR A SMALL AREA WHICH SHEET FLOWS INTO THE EXISTING DITCH RUNNING ALONG THE RAILROAD TRACKS AT THE EAST PROPERTY LINE.
- THERE IS AN EXISTING POND ON THE SITE. THIS POND WILL REMAIN IN PLACE AND BE USED AS A DETENTION AND SETTLING BASIN FOR STORM WATER FLOWING FROM THE SOUTHWESTERN QUADRANT OF THE PROPERTY.
- SURVEY DATA SHOWN ON THIS DRAWING IS BASED ON A BOUNDARY AND TOPOGRAPHIC SURVEY PERFORMED BY SAMMY D. HUNT, P.E.
- CONTOURS OUTSIDE OF SURVEY LIMITS ARE BASED ON USGS DURANT QUADRANGLE, 7.5 MINUTES SERIES MAP.

SILT FENCE NOTES:

- INSPECT AND REPAIR FENCE AFTER EACH STORM EVENT AND REMOVE SEDIMENT WHEN NECESSARY.
- REMOVED SEDIMENT SHALL BE DEPOSITED TO AN AREA THAT WILL NOT CONTRIBUTE SEDIMENT OFF-SITE AND CAN BE PERMANENTLY STABILIZED.
- SILT FENCE SHALL BE PLACED ON SLOPE CONTOURS TO MAXIMIZE PONDING EFFICIENCY.

HAY BALE NOTES:

- THE STRAW BALES SHALL BE PLACED AS SHOWN ON THE PLAN DRAWING AND AT ANY OTHER LOCATION EXPERIENCING CONCENTRATED FLOW.
- BALES TO BE PLACED IN A ROW WITH THE ENDS TIGHTLY ABUTTING. USE STRAW ROCKS OR FILTER FABRIC TO FILL GAPS BETWEEN THE BALES AND TAMP THE BACKFILL MATERIAL TO PREVENT EROSION OR FLOW AROUND BALES.

INSTALLATION NOTES:

- DRIVE POST 1" INTO GROUND AND EXCAVATE A 6"x6" TRENCH UPHILL ALONG THE LINE OF POST.
- ATTACH WIRE FENCE TO THE POST AND EXTEND BOTTOM OF FENCE 6" INTO THE EXCAVATED TRENCH.
- ATTACH THE FILTER FABRIC TO THE WIRE FENCE AND EXTEND THE BOTTOM OF THE FABRIC 6" INTO THE TRENCH.
- BACKFILL THE TRENCH WITH SOIL & COMPACT OR PLACE WASHED STONE TO THE HEIGHT OF 6" ABOVE GROUND LEVEL. BOTTOM OF FENCE MUST BE ANCHORED SO THAT RUNOFF IS FORCED THROUGH THE FENCE AND CAN NOT GO UNDER IT.



SITE LOCATION PLAN
THIS PROJECT IS LOCATED NORTH OF DURANT, MS AT
33° 09' 53.50" N
89° 50' 24.42" W
SURVEY COORDINATES ARE PROVIDED ON THE SITE PLAN.

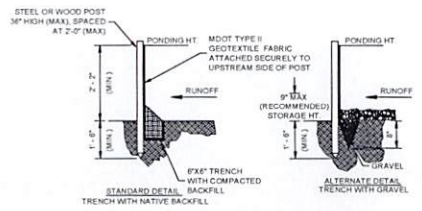
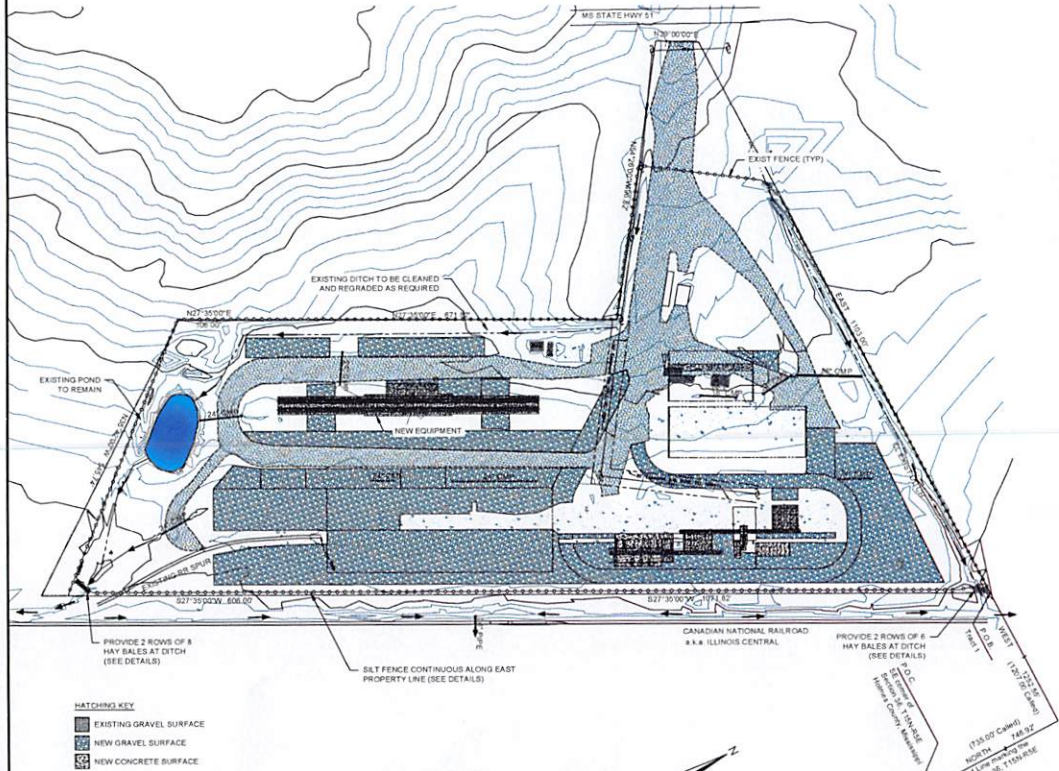

NOTE: AS AN ALTERNATE TO THE DETAILS SHOWN, A WIRE FENCE MAY BE UTILIZED TO REINFORCE THE GEOTEXTILE FABRIC WHICH ALLOWS GREATER POST SPACING. REFER TO MDOT DWG TEC-1-SHT 142 FOR DETAILS.

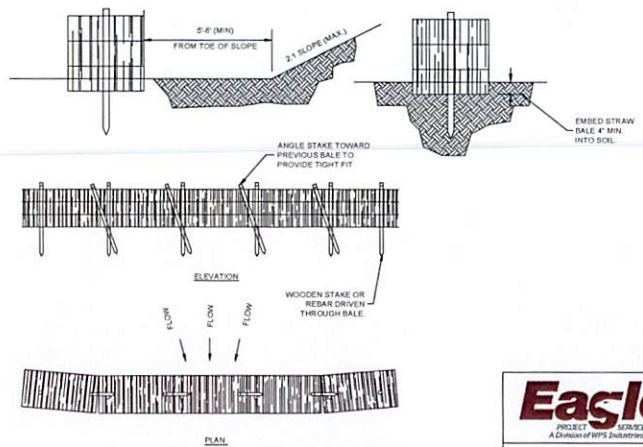

HATCHING KEY

[Hatched pattern]	EXISTING GRAVEL SURFACE
[Dotted pattern]	NEW GRAVEL SURFACE
[Solid grey]	NEW CONCRETE SURFACE
[White]	EXISTING CONCRETE SURFACE

SITE EROSION CONTROL PLAN
1" = 100'

HAY BALES (TYP.)
SCALE: N.T.S.

REVIEW & COMMENT

EVERGREEN ENGINEERING, INC.
Engineering and Construction Services
ATLANTA, GEORGIA
404.487.1444
www.evergreenengineering.com

CLIENT	STELLA-JONES
PROJECT	STELLA-JONES FACILITY
LOCATION	1700 US 51, DURANT, MS 38824
DATE	NOVEMBER 2010
SCALE	AS SHOWN
PROJECT NO.	1100S01
DATE	04/11/2011
PROJECT NO.	4349.0
DATE	04/11/2011

PROJECT SERVICES
A Division of WSP Industries, Inc.



Michael Watson
SECRETARY OF STATE

Office of the Secretary of State
Jackson, Mississippi

Certificate of Good Standing

I, MICHAEL WATSON, Secretary of State of the State of Mississippi, and as such, the legal custodian of the records as required by the laws of Mississippi, to be filed in my office, do hereby certify:

That on the 26th day of April, 2011, the State of Mississippi issued a Charter/ Certificate of Authority to:

STELLA-JONES CORPORATION

That the state of incorporation is Delaware.

That the period of duration is perpetual.

That according to the records of this office, Articles of Dissolution or a Certificate of Withdrawal have not been filed.

That according to the records of this office, a current Annual Report has been delivered to the Office of the Secretary of State.

I further certify that all fees, taxes and penalties owed to this state, as reflected in the records of the Secretary of State, have been paid and that the corporation is in existence or has authority to transact business in Mississippi.

That insofar as the records of this office are concerned, the said Stella-Jones Corporation is in good standing at this time.

Given under my hand and seal of office
the 22nd day of August, 2022

Michael Watson

Certificate Number: CN22146676

Verify this certificate online at <http://corp.sos.ms.gov/corpcnv/verifycertificate.aspx>



Stella-Jones Corporation
Park West One, Suite 500
Pittsburgh, PA 15275
Telephone: 412-325-0202
Fax: 412-774-1689

August 22, 2022

Via Electronic Submittal
<https://www.mdeq.ms.gov/construction-stormwater/>

Mississippi Department of Environmental Quality
Office of Pollution Control
PO Box 2261
Jackson, Mississippi 39225

RECEIVED
AUG 26 2022
Dept. of Environmental Quality

Attn: Chief, Environmental Permits Division

Re: Large Construction Stormwater Notice of Intent

To Whom it May Concern:

Please accept this application as our Notice of Intent to begin construction at our facility with an address of 17156 US Highway 51, Durant, Holmes County, Mississippi.

Stella-Jones greatly appreciates your expedient review of our Notice of Intent. Please do not hesitate to contact me at 412-894-2875, extension 6975 or hgawne@stella-jones.com if you have any questions or require further information regarding this matter.

Sincerely,

A handwritten signature in black ink that reads "Heather Gawne".

Heather Gawne
Director of Environmental Compliance



MISSISSIPPI DEPARTMENT OF
ENVIRONMENTAL QUALITY

LARGE CONSTRUCTION NOTICE OF INTENT (LCNOI) FOR COVERAGE UNDER THE LARGE CONSTRUCTION STORM WATER GENERAL NPDES PERMIT

INSTRUCTIONS

The Large Construction Notice of Intent (LCNOI) is for coverage under the Large Construction General Permit for land disturbing activities of five (5) acres or greater; or for land disturbing activities, which are part of a larger common plan of development or sale that are initially less than five (5) acres but will ultimately disturb five (5) or more acres. Applicant must be the owner or operator. For construction activities, the operator is typically the prime contractor. The owner(s) of the property and the prime contractor associated with regulated construction activity on the property have joint and severable responsibility for compliance with the Large Construction Storm Water General Permit MSR10.

If the company seeking coverage is a corporation, a limited liability company, a partnership, or a business trust, attach proof of its registration with the Mississippi Secretary of State and/or its Certificate of Good Standing. This registration or Certificate of Good Standing must be dated within twelve (12) months of the date of the submittal of this coverage form. Coverage will be issued in the company name as it is registered with the Mississippi Secretary of State.

Completed LCNOIs should be filed at least thirty (30) days prior to the commencement of construction. Discharge of storm water from large construction activities without written notification of coverage is a violation of state law.

Submittals with this LCNOI must include:

- A site-specific Storm Water Pollution Prevention Plan (SWPPP) developed in accordance with ACT5 of the General Permit
- A detailed site-specific scaled drawing showing the property layout and the features outlined in ACT5 of the General Permit
- A United States Geological Survey (USGS) quadrangle map or photocopy, extending at least one-half mile beyond the facility property boundaries with the site location and outfalls outlined or highlighted. The name of the quadrangle map must be shown on all copies. Quadrangle maps can be obtained from the MDEQ, Office of Geology at 601-961-5523.

Additional submittals may include the following, if applicable:

- Appropriate Section 404 documentation from U.S. Army Corps of Engineers
- Appropriate documentation concerning future disposal of sanitary sewage and sewage collection system construction
- Appropriate documentation from the MDEQ Office of Land & Water concerning dam construction and low flow requirements
- Approval from County Utility Authority in Hancock, Harrison, Jackson, Pearl River and Stone Counties
- Antidegradation report for disturbance within Waters of the State

ALL QUESTIONS MUST BE ANSWERED (Answer "NA" if the question is not applicable)