

# MISSISSIPPI ASBESTOS DEMOLITION/RENOVATION NOTIFICATION FORM

Mail notification to: **MDEQ Asbestos and Lead Branch, 515 E. Amite Street, Jackson, MS 39201**

MDEQ Use Only: <input checked="" type="checkbox"/> Email <input type="checkbox"/> Mail <input type="checkbox"/> Hand Delivery	Postmark (mail only)	Date Received <b>8/21/2024</b>	AI Number
<b>I. Type of Notification (O=Original R=Revised C=Canceled A= Annual) R</b>			
<b>II. TYPE OF OPERATION (D=Demo O= Ordered Demo R=Renovation E=Emer. Renovation) R</b>			
<b>III. FACILITY DESCRIPTION (Include building name, number and floor or room number)</b>			
Bldg. Name: <b>Amazon Data Services</b>			
Address: <del>1415 W County Line Rd.</del> <b>32.4041946, -90.1870070 (See Map)</b>			
City: <b>Ridgeland</b>	State: <b>MS</b>	Zip: <b>39157</b>	County: <b>Madison</b>
Site Location: <b>Throughout House</b>		Tel: <b>601-559-7788</b>	
Building Size: <b>4224</b>	# of Floors: <b>1</b>	Age in Years: <b>41</b>	
Present Use: <b>Evacuated</b>	Prior Use: <b>Home</b>		
<b>IV. FACILITY INFORMATION (Identify owner, asbestos removal contractor, and other operator)</b>			
OWNER NAME: <b>Amazon Data Services</b>			
Address: <b>419 Greenwood Ln.</b>			
City: <b>Ridgeland</b>	State: <b>MS</b>	Zip: <b>39157</b>	
Contact: <b>Landline</b>	Tel: <b>601-981-4327</b>		
ASBESTOS REMOVAL CONTRACTOR: <b>Anderson Environmental Services, Inc.</b>			
Address: <b>783 Harris St.</b>			
City: <b>Jackson</b>	State: <b>MS</b>	Zip: <b>39202</b>	
Contact: <b>Darryl Anderson</b>	Tel: <b>601-940-4644</b>		
Certification Number: <b>ABC-00002173</b>	Expiration Date: <b>10/27/2024</b>		
OTHER OPERATOR: <b>Hemphill Construction Company, Inc.</b>			
Address: <b>1858 US 49</b>			
City: <b>Florence</b>	State: <b>MS</b>	Zip: <b>39073</b>	
Contact: <b>Brandon Brown</b>	Tel: <b>601-559-7788</b>		
<b>V. WAS SITE INSPECTED TO DETERMINE PRESENCE OF ASBESTOS? (Yes/No): Yes</b>			
WAS ASBESTOS PRESENT? (Yes/No): <b>Yes</b>		Inspection Date: <b>2/14/2024</b>	
Inspector: <b>David Loague</b>	Certification Number: <b>ABI-00001796</b>	Expiration Date: <b>06/07/2024</b>	
<b>VI. SUSPECT MATERIALS SAMPLED AND PROCEDURES USED TO DETECT THE PRESENCE OF ASBESTOS MATERIAL:</b>			
Materials sampled were off-white compound with paint, drywall, ceiling board, wallpaper, caulk, and roofing. Inspection report attached.			
Polarized Light Microscopy (PLM) for sample identification.			
<b>VII. QUANTITY OF RACM TO BE REMOVED:</b>			
Pipes (LN FT): <b>0</b>	Surface Area (SQ FT): <b>3,548</b>	Volume of Facility Components (CU FT): <b>47,898</b>	
<b>VIII. QUANTITY OF NONFRIABLE ASBESTOS NOT REMOVED:</b>			
Category I: <b>None</b>	Category II: <b>None</b>		
<b>IX. SCHEDULED DATES ASBESTOS REMOVAL (MM/DD/YY) Start: 9/3/2024</b>		Complete: <b>9/10/2024</b>	
<b>X. SCHEDULED DATES DEMO/RENOVATION (MM/DD/YY) Start: 9/11/2024</b>		Complete: <b>11/1/2024</b>	

XI. DESCRIPTION OF PLANNED DEMOLITION OR RENOVATION WORK, AND METHOD(S) TO BE USED:

**Renovation of Building / Standard Construction Renovation**

XII. DESCRIPTION OF WORK PRACTICES AND ENGINEERING CONTROLS TO BE USED TO PREVENT EMISSIONS OF ASBESTOS AT THE DEMOLITION OR RENOVATION SITE:

Put signs and danger barricade tape around area, placed in containment, under negative pressure, kept wet and put in acm bags

XIII. WASTE TRANSPORTER #1

Name: Elite Construction Services, LLC 101 Meadowview Drive Brandon MS 39047

Address: 101 Meadowview Drive

City: Brandon State: MS Zip: 39047

Contact Person: Chad Thompson Tel: (601) 955-6019

WASTE TRANSPORTER #2 N/A

Name:

Address:

City: State: Zip:

Contact Person: Tel:

XIV. WASTE DISPOSAL SITE

Name: Republic Services Little Dixie Landfill

Address: 1716 North County Line

City: Ridgeland State: MS Zip: 39157

Contact Person: Mike Raley Tel: 601-939-2221

XV. IF DEMOLITION ORDERED BY A GOVERNMENT AGENCY, PLEASE IDENTIFY THE AGENCY BELOW:

Name: N/A Title:

Authority:

Date of Order (MM/DD/YY): Date Ordered to Begin (MM/DD/YY):

XVI. FOR EMERGENCY RENOVATIONS:

Date and Hour of Emergency (MM/DD/YY): ~~8/16/2024~~

Description of the sudden unexpected event:

~~Asbestos Detected~~

Explanation of how the event caused unsafe conditions or would cause equipment damage or an unreasonable financial burden:

XVII. DESCRIPTION OF PROCEDURES TO BE FOLLOWED IN THE EVENT THAT UNEXPECTED ASBESTOS IS FOUND OR PREVIOUSLY NONFRIABLE ASBESTOS MATERIAL BECOMES CRUMBLLED, PULVERIZED, OR REDUCED TO POWDER:

Halt all work and notify proper authority.

XVIII. I CERTIFY THAT AN INDIVIDUAL TRAINED IN THE PROVISIONS OF THIS REGULATION (40 CFR PART 61, SUBPART M) WILL BE ONSITE DURING THE DEMOLITION OR RENOVATION, AND EVIDENCE THAT THE REQUIRED TRAINING HAS BEEN ACCOMPLISHED BY THIS PERSON WILL BE AVAILABLE FOR INSPECTION DURING NORMAL BUSINESS HOURS.

Daryl Anderson  
Type or Print Name

*Daryl Anderson*  
(Signature of Owner/Operator)

8-20-24  
(Date)

XIX. I CERTIFY THAT THE ABOVE INFORMATION IS CORRECT:

Brandon Brown  
Type or Print Name

*Brandon Brown*  
(Signature of Owner/Operator)

8-20-24  
(Date)

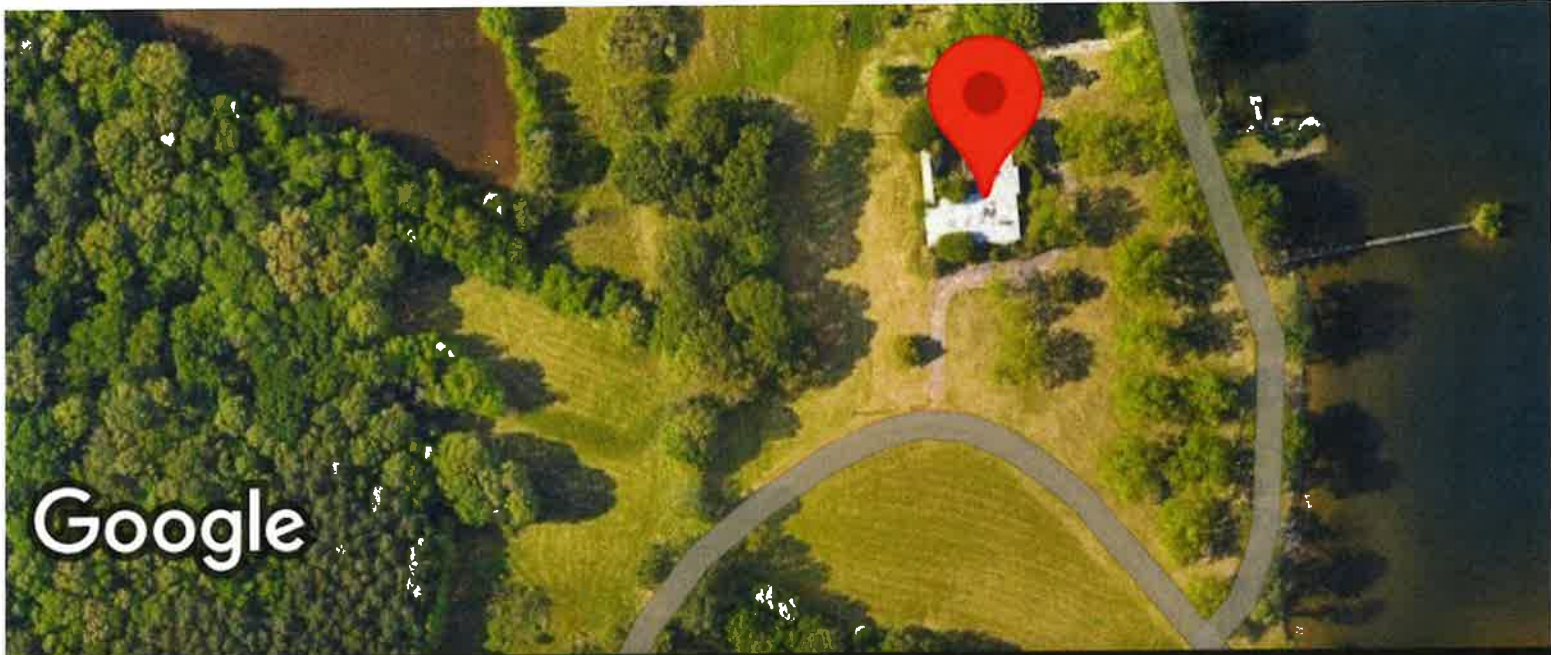

Google

# Dropped pin

Near Ridgeland, MS

 24 min



**Directions**



**Start**



**Save**



**Measure distance**



**CR37+M5H Ridgeland, Mississippi**



**(32.4041946, -90.1870070)**

# ASBESTOS INSPECTION REPORT

Inspection Date: February 14, 2024

Report Date: February 27, 2024



## Madison County Property Ridgeland, Mississippi

A handwritten signature in black ink that reads "David Loague".

David Loague  
Asbestos Inspector  
Certification No. ABI-00001796

Post Office Box 356 | Sherman, Mississippi 38869

Office: (662) 840-5945 | Fax: (662) 840-5965

[www.envirocomp.net](http://www.envirocomp.net)

**"FOR ALL YOUR ENVIRONMENTAL AND SAFETY CONSULTING NEEDS."**

---

## TABLE OF CONTENTS

---

	<u>Page</u>
1.0 EXECUTIVE SUMMARY .....	1
2.0 RESIDENTIAL STRUCTURE- RIDGELAND, MISSISSIPPI.....	2

**ATTACHMENTS:**

- ATTACHMENT 1: LABORATORY ANALYTICAL RESULTS AND CHAIN OF CUSTODY
- ATTACHMENT 2: INSPECTION PHOTOS
- ATTACHMENT 3; FACILITY DIAGRAM AND MATERIALS ESTIMATE
- ATTACHMENT 4: ASBESTOS INSPECTOR CERTIFICATION

---

## 1.0 EXECUTIVE SUMMARY

---

Environmental Compliance & Safety, Inc. (ECS) was retained by Mr. Walt Dinkelacker of Headwaters, Inc., PO Box 2836, Ridgeland, Mississippi to perform an asbestos inspection of an approximately 5,000 square foot residential structure located in Ridgeland, Mississippi. The primary purpose of the asbestos inspection was to inspect the building for suspect asbestos containing material (ACM) and collect samples as necessary to determine the presence of asbestos through laboratory analysis. David Loague, an accredited and licensed Mississippi Asbestos Inspector, performed the asbestos inspection on February 14, 2024.

Mr. Loague collected one hundred and twelve (112) samples of suspect ACM from the structure. The samples were containerized and shipped to Eurofins EPK Built Environment Testing, LLC (Eurofins), located at 6215 Regency Parkway, Suite 900, in Norcross, Georgia. Eurofins is accredited through the National Voluntary Laboratory Accreditation Program (NVLAP). Eurofins uses Polarized Light Microscopy (PLM) for sample identification. Laboratory analytical results indicate eighteen (18) of the analyzed suspect ACM samples contained asbestos. All other analyzed samples were identified as "no fibers were detected" (ND). A description of the layers analyzed in each sample and a summary of the results of each analysis is contained in the table found in Section 2.0 of this report.

Attachment 1 contains the laboratory analysis for all collected samples, Attachment 2 contains photos of the eighteen sample locations (photos of all sample locations can be provided upon request), Attachment 3 contains a facility diagram with positive asbestos sample locations and an estimate of materials in each room, and Attachment 4 contains the credentials for ECS Asbestos Inspector, David Loague.

## 2.0 RESIDENTIAL STRUCTURE - RIDGELAND, MISSISSIPPI

The existing structure is currently vacant and was previously utilized as a private residence. The structure consists of four (4) bedrooms with closets, five (5) bathrooms, two (2) living rooms, a breakfast area, a formal dining room, two (2) kitchen areas, an informal dining area, enclosed garage, storage room, and an underground safe room. The ceilings of the house were either painted ceiling board or painted wood paneling. Fiberglass insulation was observed in the ceiling. The interior walls of the house were either painted wall board, wood paneling, ceramic tile, or painted concrete. The structure was built on a conventional floor utilizing metal trusses. A layer of concrete covered a base sheet. The concrete floor was covered with either carpet, ceramic tile, wood laminate, or hardwood flooring. The flooring of the informal dining area, garage, and storage room was concrete. The informal dining room floor was covered with ceramic tile.

The exterior walls of the house were constructed of brick. The roof of the house was flat with a built-up roof covered with a layer of rolled shingles. Two exterior buildings around the pool were not accessible due to being locked. A total of one hundred and twelve (112) samples of suspect ACM were collected and a total of ninety-eight (98) analyses were conducted on the samples. Twenty-four (24) samples contained more than one layer.

The table below provides a summary of the sample collection results. Eurofins laboratory analytical results show eighteen (18) samples contained **2% Chrysotile Asbestos**. All other collected samples were "None Detected" for asbestos.

SAMPLE ID	SAMPLE DESCRIPTION	LOCATION	ASBESTOS CONTENT
S.001	Yellow Mastic w/Debris	Bedroom #3	None Detected
S.002	Yellow Mastic w/Debris	Bedroom #3	None Detected
S.003	Off-white Compound with Paint	Bedroom #3 (wall)	2% Chrysotile
	White Drywall with Brown Paper		None Detected
S.004*	Wall Board (White/Gray)	Bedroom #3 (wall)	Positive Stop
S.005	White Drywall with Brown Paper and Paint	Bedroom #3 (ceiling)	None Detected
S..006	White Drywall with Brown Paper and Paint	Bedroom #3 (ceiling)	None Detected
S.007	Off-white Compound with Paint	Bathroom #3 (wall)	2% Chrysotile
	White Drywall with Brown Paper		None Detected
S.008*	Wall Board (White Gray)	Bathroom #3 (wall)	Positive Stop
S.009	Multicolored Wallpaper	Bathroom #3	None Detected
S.010	Multicolored Wallpaper	Bathroom #3	None Detected
S.011	White Drywall with Brown Paper and Paint	Bathroom #3 (ceiling)	None Detected

SAMPLE ID	SAMPLE DESCRIPTION	LOCATION	ASBESTOS CONTENT
S.012	White Drywall with Brown Paper and Paint	Bathroom #3 (ceiling)	None Detected
S.013	Yellow Mastic w/Debris	Bedroom #3 Closet	None Detected
S.014	Yellow Mastic w/Debris	Bedroom #3 Closet	None Detected
S.015	<b>Off-white Compound with Paint</b>	Bedroom #3 Closet (wall)	<b>2% Chrysotile</b>
	Cream Tape		None Detected
	<b>Off-White Joint Compound</b>		<b>2% Chrysotile</b>
	White Drywall with Brown Paper		None Detected
S.016*	Wall Board (White/Gray)	Bedroom #3 Closet (wall)	Positive Stop
S.017	White Drywall with Brown Paper and Paint	Bedroom #3 Closet (ceiling)	None Detected
S.018	White Drywall with Brown Paper and Paint	Bedroom #3 Closet (ceiling)	None Detected
S.019	Yellow Mastic w/Debris	Bedroom #2	None Detected
S.020	Yellow Mastic w/Debris	Bedroom #2	None Detected
S.021	<b>Off-white Compound with Paint</b>	Bedroom #2 (wall)	<b>2% Chrysotile</b>
	White Drywall with Brown Paper		None Detected
S.022*	Wall Board (White/Gray)	Bedroom #2 (wall)	Positive Stop
S.023	White Drywall with Brown Paper and Paint	Bedroom #2 (ceiling)	None Detected
S.024	White Drywall with Brown Paper and Paint	Bedroom #2 (ceiling)	None Detected
S.025	<b>Off-white Compound with Paint</b>	Bedroom #2 Closet (wall)	<b>2% Chrysotile</b>
	White Drywall with Brown Paper		None Detected
S.026*	Wall Board (White/Gray)	Bedroom #2 Closet (wall)	Positive Stop
S.027	White Drywall with Brown Paper and Paint	Bedroom #2 Closet (ceiling)	None Detected
S.028	White Drywall with Brown Paper and Paint	Bedroom #2 Closet (ceiling)	None Detected
S.029	Yellow Mastic w/Debris	Bedroom Closet	None Detected
S.030	Yellow Mastic w/Debris	Bedroom Closet	None Detected
S.031	<b>Off-white Compound with Paint</b>	Bathroom 1 / 2 (Tub/Shower) (wall)	<b>2% Chrysotile</b>
	White Drywall with Brown Paper		None Detected
S.032*	Wall Board (White/Gray)	Bathroom 1 / 2 (Tub/Shower) (wall)	Positive Stop
S.033	<b>Off-white Compound with Paint</b>	Bathroom 1 / 2 (Tub/Shower) (ceiling)	<b>2% Chrysotile</b>
	White Drywall with Brown Paper		None Detected
S.034*	Ceiling Board (White/Gray)	Bathroom 1 / 2 (Tub/Shower) (ceiling)	Positive Stop
S.035	Yellow Mastic	Bathroom 1 / 2 (Vanity)	None Detected
S.036	Yellow Mastic	Bathroom 1 / 2 (Vanity)	None Detected
S.037	White Drywall with Brown Paper and Paint	Bathroom 1 / 2 (Vanity) (wall)	None Detected
S.038	White Drywall with Brown Paper and Paint	Bathroom 1 / 2 (Vanity) (wall)	None Detected
S.039	White Drywall with Brown Paper and Paint	Bathroom 1 / 2 (Vanity) (ceiling)	None Detected



SAMPLE ID	SAMPLE DESCRIPTION	LOCATION	ASBESTOS CONTENT
S.040	White Drywall with Brown Paper and Paint	Bathroom 1 / 2 (Vanity) (ceiling)	None Detected
S.041	Yellow Mastic	Bedroom #1	None Detected
S.042	Yellow Mastic	Bedroom #1	None Detected
S.043	White Drywall with Brown Paper and Paint	Bedroom #1 (wall)	None Detected
S.044	<b>Off-white Compound with Paint</b>	Bedroom #1 (wall)	<b>2% Chrysotile</b>
	White Drywall with Brown Paper		None Detected
S.045	White Drywall with Brown Paper and Paint	Bedroom #1 (ceiling)	None Detected
S.046	White Drywall with Brown Paper and Paint	Bedroom #1(ceiling)	None Detected
S.047	Yellow Mastic	Bedroom #1 Closet #1	None Detected
S.048	Yellow Mastic	Bedroom #1 Closet #1	None Detected
S.049	<b>Off-white Compound with Paint</b>	Bedroom #1 Closet #1 (wall)	<b>2% Chrysotile</b>
	White Drywall with Brown Paper		None Detected
S.050*	Wall Board (white/Gray)	Bedroom #1 Closet #1 (wall)	Positive Stop
S.051	White Drywall with Brown Paper and Paint	Bedroom #1 Closet #1 (ceiling)	None Detected
S.052	White Drywall with Brown Paper and Paint	Bedroom #1 Closet #1 (ceiling)	None Detected
S.053	Yellow Mastic	Bedroom #1 Closet #2	None Detected
S.054	Yellow Mastic	Bedroom #1 Closet #2	None Detected
S.055	<b>Off-white Compound with Paint</b>	Bedroom #1 Closet #2 (wall)	<b>2% Chrysotile</b>
	White Drywall with Brown Paper		None Detected
S.056*	Wall Board (White/Gray)	Bedroom #1 Closet #2 (wall)	Positive Stop
S.057	White Drywall with Brown Paper and Paint	Bedroom #1 Closet #2 (ceiling)	None Detected
S.058*	<b>Off-white Compound with Paint</b>	Bedroom #1 Closet #2 (ceiling)	<b>2% Chrysotile</b>
	White Drywall with Brown Paper		None Detected
S.059	White Drywall with Brown Paper and Paint	Hallway to Bedrooms (wall)	None Detected
S.060	White Drywall with Brown Paper and Paint	Hallway to Bedrooms (wall)	None Detected
S.061	<b>Off-white Compound with Paint</b>	Hallway to Bedrooms (ceiling)	<b>2% Chrysotile</b>
	White Drywall with Brown Paper		None Detected
S.062*	Ceiling Board (White/Gray)	Hallway to Bedrooms (ceiling)	Positive Stop
S.063	<b>Off-white Compound with Paint</b>	Hallway to Bedrooms Closet (wall)	<b>2% Chrysotile</b>
	White Drywall with Brown Paper		None Detected
S.064*	Wall Board (White/Gray)	Hallway to Bedrooms Closet (wall)	Positive Stop
S.065	White Drywall with Brown Paper and Paint	Hallway to Bedrooms closet (ceiling)	None Detected
S.066	White Drywall with Brown Paper and Paint	Hallway to Bedrooms closet (ceiling)	None Detected
S.067	White Drywall with Brown Paper and Paint	Master Bedroom (wall)	None Detected

SAMPLE ID	SAMPLE DESCRIPTION	LOCATION	ASBESTOS CONTENT
S.068	White Compound with Paint	Master Bedroom (wall)	None Detected
	White Drywall with Brown Paper		None Detected
S.069	White Drywall with Brown Paper and Paint	Master Bedroom (ceiling)	None Detected
S.070	White Drywall with Brown Paper and Paint	Master Bedroom (ceiling)	None Detected
S.071	White Drywall with Brown Paper	Master Bath Shower/Vanity (wall)	None Detected
S.072	White Drywall with Brown Paper	Master Bath Shower/Vanity (wall)	None Detected
S.073	Green Wallpaper	Master Bath Shower/Vanity	None Detected
S.074	Green Wallpaper	Master Bath Shower/Vanity	None Detected
S.075	White Compound with Paint	Master Bath Shower/Vanity (ceiling)	None Detected
	White Drywall with Brown Paper		None Detected
S.076	White Compound with Paint	Master Bath Shower/Vanity (ceiling)	None Detected
	White Drywall with Brown Paper		None Detected
S.077	White Drywall with Brown Paper and Paint	Master Bath Hallway (wall)	None Detected
S.078	White Compound with Paint	Master Bath Hallway (wall)	None Detected
	White Drywall with Brown Paper		None Detected
S.079	White Caulk	HVAC Room	None Detected
S.080	White Caulk	HVAC Room	None Detected
S.081	White Drywall with Brown Paper	Living Room #1 (wall)	None Detected.
S.082	Off-white Compound with Paint	Living Room #1 (wall)	2% Chrysotile
	White Drywall with Brown Paper		None Detected
S.083	Tan Plaster	Living Room #2	None Detected
S.084	Tan Plaster	Living Room #2	None Detected
S.085	Off-white Compound with Paint	Stairs to Safe Room (wall)	2% Chrysotile
	White Drywall with Brown Paper		None Detected
S.086*	Wall Board (White/Gray)	Stairs to Safe Room (wall)	Positive Stop
S.087	Brown Flooring	Under Dining Room Floor	None Detected
S.088	Brown Flooring	Under Dining Room Floor	None Detected
S.089	Off-white Caulk	Chimney on Roof	None Detected
	Black Roof Flashing		None Detected
	Silver Paint		2% Chrysotile
S.090	Gray Non-Fibrous Material with Paint	Roof	None Detected
S.091	Black/White Coating	Roof	None Detected
	Black Roofing Tar		None Detected
S.092	Black/White Coating	Roof	None Detected
	Black Roofing Tar		None Detected

SAMPLE ID	SAMPLE DESCRIPTION	LOCATION	ASBESTOS CONTENT
S.093	White Compound with Paint	Living Room #2 (wall)	None Detected
	Cream Tape		None Detected
	White Joint Compound		None Detected
S.094	White Compound with Paint	Living Room #2 (wall)	None Detected
	Cream Tape		None Detected
	White Joint Compound		None Detected
	White Drywall with Brown Paper		None Detected
S.095	Gold Wallpaper	Bathroom #4	None Detected
S.096	Gold Wallpaper	Bathroom #4	None Detected
S.097	<b>Off-white Compound with Paint</b>	Bathroom #4 (wall)	<b>2% Chrysotile</b>
	Cream Tape		None Detected
	<b>Off-White Joint Compound</b>		<b>2% Chrysotile</b>
	White Drywall with Brown Paper		None Detected
S.098*	Wall Board (White/Gray)	Bathroom #4 (wall)	Positive Stop
S.099	Brown Fibrous Material	Roof	None Detected
S.100	Brown Fibrous Material	Roof	None Detected
S.101	Gray Caulk	Bedroom #2	None Detected
S.102	Gray Caulk	Bedroom #2	None Detected
S.103	Gray Caulk	Bedroom #2	None Detected
S.104	Gray Caulk	Bedroom #2	None Detected
S.105	Gray Caulk	Bedroom #1	None Detected
S.106	Gray Caulk	Bedroom #1	None Detected
S.107	Gray Caulk	Living Room #1	None Detected
S.108	Gray Caulk	Living Room #1	None Detected
S.109	Green Wallpaper	Bathroom #5	None Detected
S.110	Green Wallpaper	Bathroom #5	None Detected
S.111	<b>Off-white Compound with Paint</b>	Bathroom #5 (wall)	<b>2% Chrysotile</b>
	White Drywall with Brown Paper		None Detected
S.112*	Wall Board (Gray/White)	Bathroom #5 (wall)	Positive Stop

*\*Sample was not analyzed due to prior positive series. Positive stop analysis refers to a laboratory protocol that analyzes multiple samples of similar material and stops analysis when asbestos is identified at concentrations greater than 1%.*

It is important to note, if demolition is planned, then the Mississippi Department of Environmental Quality (MDEQ) must be notified ten (10) days prior to the start of the demolition activities. Should you have any questions concerning the contents of this report or require additional assistance please contact Kirk Shelton or me at your convenience at (662) 840-5945.

## **ATTACHMENTS**

## **ATTACHMENT 1**

LABORATORY ANALYTICAL RESULTS AND CHAIN OF CUSTODY

Report for:

**Kirk Shelton**  
**Environmental Compliance and Safety**  
282 3rd Avenue  
Sherman, MS 38869

---

Regarding: Eurofins EPK Built Environment Testing, LLC  
Project: Headwaters\_20240214; Asbestos Inspection - 5000 Sq. Ft. Structure  
EML ID: 3542582

Approved by:

Dates of Analysis:  
Asbestos PLM: 02-21-2024 and 02-22-2024



Approved Signatory  
Balu Krishnan

Service SOPs: Asbestos PLM (EPA 40CFR App E to Sub E of Part 763 & EPA METHOD 600/R-93-116, SOP EM-AS-S-1267)  
NVLAP Lab Code 201060-0

---

All samples were received in acceptable condition unless noted in the Report Comments portion in the body of the report. The results relate only to the samples as received and tested. The results include an inherent uncertainty of measurement associated with estimating percentages by polarized light microscopy. Measurement uncertainty data for sample results with >1% asbestos concentration can be provided when requested.

Eurofins EPK Built Environment Testing, LLC ("the Company"), a member of the Eurofins Built Environment Testing group of companies, shall have no liability to the client or the client's customer with respect to decisions or recommendations made, actions taken or courses of conduct implemented by either the client or the client's customer as a result of or based upon the Test Results. In no event shall the Company be liable to the client with respect to the Test Results except for the Company's own willful misconduct or gross negligence nor shall the Company be liable for incidental or consequential damages or lost profits or revenues to the fullest extent such liability may be disclaimed by law, even if the Company has been advised of the possibility of such damages, lost profits or lost revenues. In no event shall the Company's liability with respect to the Test Results exceed the amount paid to the Company by the client therefor.

Client: Environmental Compliance and Safety  
 C/O: Kirk Shelton  
 Re: Headwaters\_20240214; Asbestos Inspection -  
 5000 Sq. Ft. Structure

Date of Sampling: 02-15-2024  
 Date of Receipt: 02-16-2024  
 Date of Report: 02-22-2024

**ASBESTOS PLM REPORT**

**Total Samples Submitted:** 112  
**Total Samples Analyzed:** 98  
**Total Samples with Layer Asbestos Content > 1%:** 18

**Location: S.001, Floor Mastic (Yellow)**

Lab ID-Version‡: 17306785-1

Sample Layers	Asbestos Content
Yellow Mastic with Debris	ND
<b>Composite Non-Asbestos Content:</b>	4% Cellulose
<b>Sample Composite Homogeneity:</b>	Poor

**Location: S.002, Floor Mastic (Yellow)**

Lab ID-Version‡: 17306786-1

Sample Layers	Asbestos Content
Yellow Mastic with Debris	ND
<b>Composite Non-Asbestos Content:</b>	4% Cellulose
<b>Sample Composite Homogeneity:</b>	Poor

**Location: S.003, Wall Board (White/Gray)**

Lab ID-Version‡: 17306787-1

Sample Layers	Asbestos Content
Off-White Compound with Paint	2% Chrysotile
White Drywall with Brown Paper	ND
<b>Composite Asbestos Fibrous Content:</b>	< 1% Asbestos
<b>Composite Non-Asbestos Content:</b>	10% Cellulose
<b>Sample Composite Homogeneity:</b>	Moderate

**Comments:** Sample S.004 were not analyzed due to prior positive series.

**Location: S.005, Ceiling Board (White/Gray)**

Lab ID-Version‡: 17306789-1

Sample Layers	Asbestos Content
White Drywall with Brown Paper and Paint	ND
<b>Composite Non-Asbestos Content:</b>	10% Cellulose
<b>Sample Composite Homogeneity:</b>	Moderate

The test report shall not be reproduced except in full, without written approval of the laboratory. The report must not be used by the client to claim product certification, approval, or endorsement by NVLAP, NIST, or any agency of the federal government. The Company reserves the right to dispose of all samples after a period of thirty (30) days, according to all state and federal guidelines, unless otherwise specified.

Inhomogeneous samples are separated into homogeneous subsamples and analyzed individually. ND means no fibers were detected. When detected, the minimum detection and reporting limit is less than 1% unless point counting is performed. Floor tile samples may contain large amounts of interference material and it is recommended that the sample be analyzed by gravimetric point count analysis to lower the detection limit and to aid in asbestos identification.

‡ A "Version" indicated by "-x" after the Lab ID# with a value greater than 1 indicates a sample with amended data. The revision number is reflected by the value of "x".

Client: Environmental Compliance and Safety  
 C/O: Kirk Shelton  
 Re: Headwaters\_20240214; Asbestos Inspection -  
 5000 Sq. Ft. Structure

Date of Sampling: 02-15-2024  
 Date of Receipt: 02-16-2024  
 Date of Report: 02-22-2024

**ASBESTOS PLM REPORT**

**Location: S.006, Ceiling Board (White/Gray)**

Lab ID-Version‡: 17306790-1

Sample Layers	Asbestos Content
White Drywall with Brown Paper and Paint	ND
<b>Composite Non-Asbestos Content:</b>	10% Cellulose
<b>Sample Composite Homogeneity:</b>	Moderate

**Location: S.007, Wall Board (White/Gray)**

Lab ID-Version‡: 17306791-1

Sample Layers	Asbestos Content
Off-White Compound with Paint	2% Chrysotile
White Drywall with Brown Paper	ND
<b>Composite Non-Asbestos Content:</b>	10% Cellulose
<b>Sample Composite Homogeneity:</b>	Moderate

**Comments:** Sample S.008 were not analyzed due to prior positive series.

**Location: S.009, Wall Paper (Multi-Color)**

Lab ID-Version‡: 17306793-1

Sample Layers	Asbestos Content
Multicolored Wallpaper	ND
<b>Composite Non-Asbestos Content:</b>	95% Cellulose
<b>Sample Composite Homogeneity:</b>	Good

**Location: S.010, Wall Paper (Multi-Color)**

Lab ID-Version‡: 17306794-1

Sample Layers	Asbestos Content
Multicolored Wallpaper	ND
<b>Composite Non-Asbestos Content:</b>	95% Cellulose
<b>Sample Composite Homogeneity:</b>	Good

The test report shall not be reproduced except in full, without written approval of the laboratory. The report must not be used by the client to claim product certification, approval, or endorsement by NVLAP, NIST, or any agency of the federal government. The Company reserves the right to dispose of all samples after a period of thirty (30) days, according to all state and federal guidelines, unless otherwise specified.

Inhomogeneous samples are separated into homogeneous subsamples and analyzed individually. ND means no fibers were detected. When detected, the minimum detection and reporting limit is less than 1% unless point counting is performed. Floor tile samples may contain large amounts of interference material and it is recommended that the sample be analyzed by gravimetric point count analysis to lower the detection limit and to aid in asbestos identification.

‡ A "Version" indicated by "-x" after the Lab ID# with a value greater than 1 indicates a sample with amended data. The revision number is reflected by the value of "x".



Client: Environmental Compliance and Safety  
 C/O: Kirk Shelton  
 Re: Headwaters\_20240214; Asbestos Inspection -  
 5000 Sq. Ft. Structure

Date of Sampling: 02-15-2024  
 Date of Receipt: 02-16-2024  
 Date of Report: 02-22-2024

**ASBESTOS PLM REPORT**

**Location: S.011, Ceiling Board (White/Gray)**

Lab ID-Version‡: 17306795-1

Sample Layers	Asbestos Content
White Drywall with Brown Paper and Paint	ND
<b>Composite Non-Asbestos Content:</b>	10% Cellulose
<b>Sample Composite Homogeneity:</b>	Moderate

**Location: S.012, Ceiling Board (White/Gray)**

Lab ID-Version‡: 17306796-1

Sample Layers	Asbestos Content
White Drywall with Brown Paper and Paint	ND
<b>Composite Non-Asbestos Content:</b>	10% Cellulose
<b>Sample Composite Homogeneity:</b>	Moderate

**Location: S.013, Floor Mastic (Yellow)**

Lab ID-Version‡: 17306797-1

Sample Layers	Asbestos Content
Yellow Mastic with Debris	ND
<b>Composite Non-Asbestos Content:</b>	4% Cellulose
<b>Sample Composite Homogeneity:</b>	Good

**Location: S.014, Floor Mastic (Yellow)**

Lab ID-Version‡: 17306798-1

Sample Layers	Asbestos Content
Yellow Mastic with Debris	ND
<b>Composite Non-Asbestos Content:</b>	4% Cellulose
<b>Sample Composite Homogeneity:</b>	Good

The test report shall not be reproduced except in full, without written approval of the laboratory. The report must not be used by the client to claim product certification, approval, or endorsement by NVLAP, NIST, or any agency of the federal government. The Company reserves the right to dispose of all samples after a period of thirty (30) days, according to all state and federal guidelines, unless otherwise specified.

Inhomogeneous samples are separated into homogeneous subsamples and analyzed individually. ND means no fibers were detected. When detected, the minimum detection and reporting limit is less than 1% unless point counting is performed. Floor tile samples may contain large amounts of interference material and it is recommended that the sample be analyzed by gravimetric point count analysis to lower the detection limit and to aid in asbestos identification.

‡ A "Version" indicated by "-x" after the Lab ID# with a value greater than 1 indicates a sample with amended data. The revision number is reflected by the value of "x".

Client: Environmental Compliance and Safety  
C/O: Kirk Shelton  
Re: Headwaters\_20240214; Asbestos Inspection -  
5000 Sq. Ft. Structure

Date of Sampling: 02-15-2024  
Date of Receipt: 02-16-2024  
Date of Report: 02-22-2024

**ASBESTOS PLM REPORT**

**Location: S.015, Wall Board (White/Gray)**

Lab ID-Version‡: 17306799-1

Sample Layers	Asbestos Content
Off-White Compound with Paint	2% Chrysotile
Cream Tape	ND
Off-White Joint Compound	2% Chrysotile
White Drywall with Brown Paper	ND
<b>Composite Asbestos Fibrous Content:</b>	< 1% Asbestos
<b>Composite Non-Asbestos Content:</b>	15% Cellulose
<b>Sample Composite Homogeneity:</b>	Moderate

**Comments:** Composite asbestos content provided is only for Drywall/Joint compound. Composite content provided for this analysis has been performed by following the NESHAP guidelines. Sample S.0.16 were not analyzed due to prior positive series.

**Location: S.017, Ceiling Board (White/Gray)**

Lab ID-Version‡: 17306801-1

Sample Layers	Asbestos Content
White Drywall with Brown Paper and Paint	ND
<b>Composite Non-Asbestos Content:</b>	10% Cellulose
<b>Sample Composite Homogeneity:</b>	Moderate

**Location: S.018, Ceiling Board (White/Gray)**

Lab ID-Version‡: 17306802-1

Sample Layers	Asbestos Content
White Drywall with Brown Paper and Paint	ND
<b>Composite Non-Asbestos Content:</b>	10% Cellulose
<b>Sample Composite Homogeneity:</b>	Moderate

**Location: S.019, Floor Mastic (Yellow)**

Lab ID-Version‡: 17306803-1

Sample Layers	Asbestos Content
Yellow Mastic with Debris	ND
<b>Composite Non-Asbestos Content:</b>	4% Cellulose
<b>Sample Composite Homogeneity:</b>	Moderate

The test report shall not be reproduced except in full, without written approval of the laboratory. The report must not be used by the client to claim product certification, approval, or endorsement by NVLAP, NIST, or any agency of the federal government. The Company reserves the right to dispose of all samples after a period of thirty (30) days, according to all state and federal guidelines, unless otherwise specified.

Inhomogeneous samples are separated into homogeneous subsamples and analyzed individually. ND means no fibers were detected. When detected, the minimum detection and reporting limit is less than 1% unless point counting is performed. Floor tile samples may contain large amounts of interference material and it is recommended that the sample be analyzed by gravimetric point count analysis to lower the detection limit and to aid in asbestos identification.

‡ A "Version" indicated by "-x" after the Lab ID# with a value greater than 1 indicates a sample with amended data. The revision number is reflected by the value of "x".

Client: Environmental Compliance and Safety  
 C/O: Kirk Shelton  
 Re: Headwaters\_20240214; Asbestos Inspection -  
 5000 Sq. Ft. Structure

Date of Sampling: 02-15-2024  
 Date of Receipt: 02-16-2024  
 Date of Report: 02-22-2024

**ASBESTOS PLM REPORT**

**Location: S.020, Floor Mastic (Yellow)**

Lab ID-Version‡: 17306804-1

Sample Layers	Asbestos Content
Yellow Mastic with Debris	ND
<b>Composite Non-Asbestos Content:</b>	4% Cellulose
<b>Sample Composite Homogeneity:</b>	Moderate

**Location: S.021, Wall Board (White/Gray)**

Lab ID-Version‡: 17306805-1

Sample Layers	Asbestos Content
Off-White Compound with Paint	2% Chrysotile
White Drywall with Brown Paper	ND
<b>Composite Non-Asbestos Content:</b>	10% Cellulose
<b>Sample Composite Homogeneity:</b>	Moderate

**Comments:** Sample S.022 were not analyzed due to prior positive series.

**Location: S.023, Ceiling Board (White/Gray)**

Lab ID-Version‡: 17306807-1

Sample Layers	Asbestos Content
White Drywall with Brown Paper and Paint	ND
<b>Composite Non-Asbestos Content:</b>	10% Cellulose
<b>Sample Composite Homogeneity:</b>	Moderate

**Location: S.024, Ceiling Board (White/Gray)**

Lab ID-Version‡: 17306808-1

Sample Layers	Asbestos Content
White Drywall with Brown Paper and Paint	ND
<b>Composite Non-Asbestos Content:</b>	10% Cellulose
<b>Sample Composite Homogeneity:</b>	Moderate

The test report shall not be reproduced except in full, without written approval of the laboratory. The report must not be used by the client to claim product certification, approval, or endorsement by NVLAP, NIST, or any agency of the federal government. The Company reserves the right to dispose of all samples after a period of thirty (30) days, according to all state and federal guidelines, unless otherwise specified.

Inhomogeneous samples are separated into homogeneous subsamples and analyzed individually. ND means no fibers were detected. When detected, the minimum detection and reporting limit is less than 1% unless point counting is performed. Floor tile samples may contain large amounts of interference material and it is recommended that the sample be analyzed by gravimetric point count analysis to lower the detection limit and to aid in asbestos identification.

‡ A "Version" indicated by "-x" after the Lab ID# with a value greater than 1 indicates a sample with amended data. The revision number is reflected by the value of "x".

Client: Environmental Compliance and Safety  
 C/O: Kirk Shelton  
 Re: Headwaters\_20240214; Asbestos Inspection -  
 5000 Sq. Ft. Structure

Date of Sampling: 02-15-2024  
 Date of Receipt: 02-16-2024  
 Date of Report: 02-22-2024

**ASBESTOS PLM REPORT**

**Location: S.025, Wall Board (White/Gray)**

Lab ID-Version‡: 17306809-1

Sample Layers	Asbestos Content
Off-White Compound with Paint	2% Chrysotile
White Drywall with Brown Paper	ND
<b>Composite Non-Asbestos Content:</b>	10% Cellulose
<b>Sample Composite Homogeneity:</b>	Moderate

Comments: Sample S.026 were not analyzed due to prior positive series.

**Location: S.027, Ceiling Board (White/Gray)**

Lab ID-Version‡: 17306811-1

Sample Layers	Asbestos Content
White Drywall with Brown Paper and Paint	ND
<b>Composite Non-Asbestos Content:</b>	10% Cellulose
<b>Sample Composite Homogeneity:</b>	Moderate

**Location: S.028, Ceiling Board (White/Gray)**

Lab ID-Version‡: 17306812-1

Sample Layers	Asbestos Content
White Drywall with Brown Paper and Paint	ND
<b>Composite Non-Asbestos Content:</b>	10% Cellulose
<b>Sample Composite Homogeneity:</b>	Moderate

**Location: S.029, Floor Mastic (Yellow)**

Lab ID-Version‡: 17306813-1

Sample Layers	Asbestos Content
Yellow Mastic with Debris	ND
<b>Composite Non-Asbestos Content:</b>	4% Cellulose
<b>Sample Composite Homogeneity:</b>	Good

The test report shall not be reproduced except in full, without written approval of the laboratory. The report must not be used by the client to claim product certification, approval, or endorsement by NVLAP, NIST, or any agency of the federal government. The Company reserves the right to dispose of all samples after a period of thirty (30) days, according to all state and federal guidelines, unless otherwise specified.

Inhomogeneous samples are separated into homogeneous subsamples and analyzed individually. ND means no fibers were detected. When detected, the minimum detection and reporting limit is less than 1% unless point counting is performed. Floor tile samples may contain large amounts of interference material and it is recommended that the sample be analyzed by gravimetric point count analysis to lower the detection limit and to aid in asbestos identification.

‡ A "Version" indicated by "-x" after the Lab ID# with a value greater than 1 indicates a sample with amended data. The revision number is reflected by the value of "x".

Client: Environmental Compliance and Safety  
 C/O: Kirk Shelton  
 Re: Headwaters\_20240214; Asbestos Inspection -  
 5000 Sq. Ft. Structure

Date of Sampling: 02-15-2024  
 Date of Receipt: 02-16-2024  
 Date of Report: 02-22-2024

**ASBESTOS PLM REPORT**

**Location: S.030, Floor Mastic (Yellow)**

Lab ID-Version‡: 17306814-1

Sample Layers	Asbestos Content
Yellow Mastic with Debris	ND
<b>Composite Non-Asbestos Content:</b>	4% Cellulose
<b>Sample Composite Homogeneity:</b>	Good

**Location: S.031, Wall Board (White/Gray)**

Lab ID-Version‡: 17306815-1

Sample Layers	Asbestos Content
Off-White Compound with Paint	2% Chrysotile
White Drywall with Brown Paper	ND
<b>Composite Non-Asbestos Content:</b>	10% Cellulose
<b>Sample Composite Homogeneity:</b>	Moderate

**Comments:** Sample S.032 were not analyzed due to prior positive series.

**Location: S.033, Ceiling Board (White/Gray)**

Lab ID-Version‡: 17306817-1

Sample Layers	Asbestos Content
Off-White Compound with Paint	2% Chrysotile
White Drywall with Brown Paper	ND
<b>Sample Composite Homogeneity:</b>	Moderate

**Comments:** Sample S.034 were not analyzed due to prior positive series.

**Location: S.035, Floor Mastic (Yellow)**

Lab ID-Version‡: 17306819-1

Sample Layers	Asbestos Content
Yellow Mastic	ND
<b>Composite Non-Asbestos Content:</b>	2% Cellulose
<b>Sample Composite Homogeneity:</b>	Good

The test report shall not be reproduced except in full, without written approval of the laboratory. The report must not be used by the client to claim product certification, approval, or endorsement by NVLAP, NIST, or any agency of the federal government. The Company reserves the right to dispose of all samples after a period of thirty (30) days, according to all state and federal guidelines, unless otherwise specified.

Inhomogeneous samples are separated into homogeneous subsamples and analyzed individually. ND means no fibers were detected. When detected, the minimum detection and reporting limit is less than 1% unless point counting is performed. Floor tile samples may contain large amounts of interference material and it is recommended that the sample be analyzed by gravimetric point count analysis to lower the detection limit and to aid in asbestos identification.

‡ A "Version" indicated by -"x" after the Lab ID# with a value greater than 1 indicates a sample with amended data. The revision number is reflected by the value of "x".

Client: Environmental Compliance and Safety  
 C/O: Kirk Shelton  
 Re: Headwaters\_20240214; Asbestos Inspection -  
 5000 Sq. Ft. Structure

Date of Sampling: 02-15-2024  
 Date of Receipt: 02-16-2024  
 Date of Report: 02-22-2024

**ASBESTOS PLM REPORT**

**Location: S.036, Floor Mastic (Yellow)**

Lab ID-Version‡: 17306820-1

Sample Layers	Asbestos Content
Yellow Mastic	ND
<b>Composite Non-Asbestos Content:</b>	2% Cellulose
<b>Sample Composite Homogeneity:</b>	Good

**Location: S.037, Wall Board (White/Gray)**

Lab ID-Version‡: 17306821-1

Sample Layers	Asbestos Content
White Drywall with Brown Paper and Paint	ND
<b>Composite Non-Asbestos Content:</b>	10% Cellulose
<b>Sample Composite Homogeneity:</b>	Moderate

**Location: S.038, Wall Board (White/Gray)**

Lab ID-Version‡: 17306822-1

Sample Layers	Asbestos Content
White Drywall with Brown Paper and Paint	ND
<b>Composite Non-Asbestos Content:</b>	10% Cellulose
<b>Sample Composite Homogeneity:</b>	Moderate

**Location: S.039, Ceiling Board (White/Gray)**

Lab ID-Version‡: 17306823-1

Sample Layers	Asbestos Content
White Drywall with Brown Paper and Paint	ND
<b>Composite Non-Asbestos Content:</b>	10% Cellulose
<b>Sample Composite Homogeneity:</b>	Moderate

The test report shall not be reproduced except in full, without written approval of the laboratory. The report must not be used by the client to claim product certification, approval, or endorsement by NVLAP, NIST, or any agency of the federal government. The Company reserves the right to dispose of all samples after a period of thirty (30) days, according to all state and federal guidelines, unless otherwise specified.

Inhomogeneous samples are separated into homogeneous subsamples and analyzed individually. ND means no fibers were detected. When detected, the minimum detection and reporting limit is less than 1% unless point counting is performed. Floor tile samples may contain large amounts of interference material and it is recommended that the sample be analyzed by gravimetric point count analysis to lower the detection limit and to aid in asbestos identification.

‡ A "Version" indicated by "-x" after the Lab ID# with a value greater than 1 indicates a sample with amended data. The revision number is reflected by the value of "x".

Client: Environmental Compliance and Safety  
 C/O: Kirk Shelton  
 Re: Headwaters\_20240214; Asbestos Inspection -  
 5000 Sq. Ft. Structure

Date of Sampling: 02-15-2024  
 Date of Receipt: 02-16-2024  
 Date of Report: 02-22-2024

**ASBESTOS PLM REPORT**

**Location: S.040, Ceiling Board (White/Gray)**

Lab ID-Version‡: 17306824-1

Sample Layers	Asbestos Content
White Drywall with Brown Paper and Paint	ND
<b>Composite Non-Asbestos Content:</b>	10% Cellulose
<b>Sample Composite Homogeneity:</b>	Moderate

**Location: S.041, Floor Mastic (Yellow)**

Lab ID-Version‡: 17306825-1

Sample Layers	Asbestos Content
Yellow Mastic	ND
<b>Composite Non-Asbestos Content:</b>	3% Cellulose
<b>Sample Composite Homogeneity:</b>	Good

**Location: S.042, Floor Mastic (Yellow)**

Lab ID-Version‡: 17306826-1

Sample Layers	Asbestos Content
Yellow Mastic	ND
<b>Composite Non-Asbestos Content:</b>	3% Cellulose
<b>Sample Composite Homogeneity:</b>	Good

**Location: S.043, Wall Board (White/Gray)**

Lab ID-Version‡: 17306827-1

Sample Layers	Asbestos Content
White Drywall with Brown Paper and Paint	ND
<b>Composite Non-Asbestos Content:</b>	10% Cellulose
<b>Sample Composite Homogeneity:</b>	Moderate

The test report shall not be reproduced except in full, without written approval of the laboratory. The report must not be used by the client to claim product certification, approval, or endorsement by NVLAP, NIST, or any agency of the federal government. The Company reserves the right to dispose of all samples after a period of thirty (30) days, according to all state and federal guidelines, unless otherwise specified.

Inhomogeneous samples are separated into homogeneous subsamples and analyzed individually. ND means no fibers were detected. When detected, the minimum detection and reporting limit is less than 1% unless point counting is performed. Floor tile samples may contain large amounts of interference material and it is recommended that the sample be analyzed by gravimetric point count analysis to lower the detection limit and to aid in asbestos identification.

‡ A "Version" indicated by "-x" after the Lab ID# with a value greater than 1 indicates a sample with amended data. The revision number is reflected by the value of "x".

Client: Environmental Compliance and Safety  
 C/O: Kirk Shelton  
 Re: Headwaters\_20240214; Asbestos Inspection -  
 5000 Sq. Ft. Structure

Date of Sampling: 02-15-2024  
 Date of Receipt: 02-16-2024  
 Date of Report: 02-22-2024

**ASBESTOS PLM REPORT**

**Location: S.044, Wall Board (White/Gray)**

Lab ID-Version‡: 17306828-1

Sample Layers	Asbestos Content
Off-White Compound with Paint	2% Chrysotile
White Drywall with Brown Paper	ND
<b>Composite Non-Asbestos Content:</b>	10% Cellulose
<b>Sample Composite Homogeneity:</b>	Moderate

**Location: S.045, Ceiling Board (White/Gray)**

Lab ID-Version‡: 17306829-1

Sample Layers	Asbestos Content
White Drywall with Brown Paper and Paint	ND
<b>Composite Non-Asbestos Content:</b>	10% Cellulose
<b>Sample Composite Homogeneity:</b>	Moderate

**Location: S.046, Ceiling Board (White/Gray)**

Lab ID-Version‡: 17306830-1

Sample Layers	Asbestos Content
White Drywall with Brown Paper and Paint	ND
<b>Composite Non-Asbestos Content:</b>	10% Cellulose
<b>Sample Composite Homogeneity:</b>	Moderate

**Location: S.047, Floor Mastic (Yellow)**

Lab ID-Version‡: 17306831-1

Sample Layers	Asbestos Content
Yellow Mastic	ND
<b>Composite Non-Asbestos Content:</b>	2% Cellulose
<b>Sample Composite Homogeneity:</b>	Good

The test report shall not be reproduced except in full, without written approval of the laboratory. The report must not be used by the client to claim product certification, approval, or endorsement by NVLAP, NIST, or any agency of the federal government. The Company reserves the right to dispose of all samples after a period of thirty (30) days, according to all state and federal guidelines, unless otherwise specified.

Inhomogeneous samples are separated into homogeneous subsamples and analyzed individually. ND means no fibers were detected. When detected, the minimum detection and reporting limit is less than 1% unless point counting is performed. Floor tile samples may contain large amounts of interference material and it is recommended that the sample be analyzed by gravimetric point count analysis to lower the detection limit and to aid in asbestos identification.

‡ A "Version" indicated by "-x" after the Lab ID# with a value greater than 1 indicates a sample with amended data. The revision number is reflected by the value of "x".



Client: Environmental Compliance and Safety  
 C/O: Kirk Shelton  
 Re: Headwaters\_20240214; Asbestos Inspection -  
 5000 Sq. Ft. Structure

Date of Sampling: 02-15-2024  
 Date of Receipt: 02-16-2024  
 Date of Report: 02-22-2024

**ASBESTOS PLM REPORT**

**Location: S.048, Floor Mastic (Yellow)**

Lab ID-Version‡: 17306832-1

Sample Layers	Asbestos Content
Yellow Mastic	ND
<b>Composite Non-Asbestos Content:</b>	2% Cellulose
<b>Sample Composite Homogeneity:</b>	Good

**Location: S.049, Wall Board (White/Gray)**

Lab ID-Version‡: 17306833-1

Sample Layers	Asbestos Content
Off-White Compound with Paint	2% Chrysotile
White Drywall with Brown Paper	ND
<b>Composite Non-Asbestos Content:</b>	10% Cellulose
<b>Sample Composite Homogeneity:</b>	Moderate

**Comments:** Sample S.050 were not analyzed due to prior positive series.

**Location: S.051, Ceiling Board (White/Gray)**

Lab ID-Version‡: 17306835-1

Sample Layers	Asbestos Content
White Drywall with Brown Paper and Paint	ND
<b>Composite Non-Asbestos Content:</b>	10% Cellulose
<b>Sample Composite Homogeneity:</b>	Moderate

**Location: S.052, Ceiling Board (White/Gray)**

Lab ID-Version‡: 17306836-1

Sample Layers	Asbestos Content
White Drywall with Brown Paper and Paint	ND
<b>Composite Non-Asbestos Content:</b>	10% Cellulose
<b>Sample Composite Homogeneity:</b>	Moderate

The test report shall not be reproduced except in full, without written approval of the laboratory. The report must not be used by the client to claim product certification, approval, or endorsement by NVLAP, NIST, or any agency of the federal government. The Company reserves the right to dispose of all samples after a period of thirty (30) days, according to all state and federal guidelines, unless otherwise specified.

Inhomogeneous samples are separated into homogeneous subsamples and analyzed individually. ND means no fibers were detected. When detected, the minimum detection and reporting limit is less than 1% unless point counting is performed. Floor tile samples may contain large amounts of interference material and it is recommended that the sample be analyzed by gravimetric point count analysis to lower the detection limit and to aid in asbestos identification.

‡ A "Version" indicated by "-x" after the Lab ID# with a value greater than 1 indicates a sample with amended data. The revision number is reflected by the value of "x".

Client: Environmental Compliance and Safety  
 C/O: Kirk Shelton  
 Re: Headwaters\_20240214; Asbestos Inspection -  
 5000 Sq. Ft. Structure

Date of Sampling: 02-15-2024  
 Date of Receipt: 02-16-2024  
 Date of Report: 02-22-2024

**ASBESTOS PLM REPORT**

**Location: S.053, Floor Mastic (Yellow)**

Lab ID-Version‡: 17306837-1

Sample Layers	Asbestos Content
Yellow Mastic	ND
<b>Composite Non-Asbestos Content:</b>	2% Cellulose
<b>Sample Composite Homogeneity:</b>	Good

**Location: S.054, Floor Mastic (Yellow)**

Lab ID-Version‡: 17306838-1

Sample Layers	Asbestos Content
Yellow Mastic	ND
<b>Composite Non-Asbestos Content:</b>	2% Cellulose
<b>Sample Composite Homogeneity:</b>	Good

**Location: S.055, Wall Board (White/Gray)**

Lab ID-Version‡: 17306839-1

Sample Layers	Asbestos Content
Off-White Compound with Paint	2% Chrysotile
White Drywall with Brown Paper	ND
<b>Composite Non-Asbestos Content:</b>	10% Cellulose
<b>Sample Composite Homogeneity:</b>	Moderate

**Comments:** Sample S.056 were not analyzed due to prior positive series.

**Location: S.057, Ceiling Board (White/Gray)**

Lab ID-Version‡: 17306841-1

Sample Layers	Asbestos Content
White Drywall with Brown Paper and Paint	ND
<b>Composite Non-Asbestos Content:</b>	10% Cellulose
<b>Sample Composite Homogeneity:</b>	Moderate

The test report shall not be reproduced except in full, without written approval of the laboratory. The report must not be used by the client to claim product certification, approval, or endorsement by NVLAP, NIST, or any agency of the federal government. The Company reserves the right to dispose of all samples after a period of thirty (30) days, according to all state and federal guidelines, unless otherwise specified.

Inhomogeneous samples are separated into homogeneous subsamples and analyzed individually. ND means no fibers were detected. When detected, the minimum detection and reporting limit is less than 1% unless point counting is performed. Floor tile samples may contain large amounts of interference material and it is recommended that the sample be analyzed by gravimetric point count analysis to lower the detection limit and to aid in asbestos identification.

‡ A "Version" indicated by -"x" after the Lab ID# with a value greater than 1 indicates a sample with amended data. The revision number is reflected by the value of "x".

Client: Environmental Compliance and Safety  
 C/O: Kirk Shelton  
 Re: Headwaters\_20240214; Asbestos Inspection -  
 5000 Sq. Ft. Structure

Date of Sampling: 02-15-2024  
 Date of Receipt: 02-16-2024  
 Date of Report: 02-22-2024

**ASBESTOS PLM REPORT**

**Location: S.058, Ceiling Board (White/Gray)**

Lab ID-Version†: 17306842-1

Sample Layers	Asbestos Content
Off-White Compound with Paint	2% Chrysotile
White Drywall with Brown Paper	ND
<b>Composite Non-Asbestos Content:</b>	10% Cellulose
<b>Sample Composite Homogeneity:</b>	Moderate

**Location: S.059, Wall Board (White/Gray)**

Lab ID-Version†: 17306843-1

Sample Layers	Asbestos Content
White Drywall with Brown Paper and Paint	ND
<b>Composite Non-Asbestos Content:</b>	10% Cellulose
<b>Sample Composite Homogeneity:</b>	Moderate

**Location: S.060, Wall Board (White/Gray)**

Lab ID-Version†: 17306844-1

Sample Layers	Asbestos Content
White Drywall with Brown Paper and Paint	ND
<b>Composite Non-Asbestos Content:</b>	10% Cellulose
<b>Sample Composite Homogeneity:</b>	Moderate

**Location: S.061, Ceiling Board (White/Gray)**

Lab ID-Version†: 17306845-1

Sample Layers	Asbestos Content
Off-White Compound with Paint	2% Chrysotile
White Drywall with Brown Paper	ND
<b>Composite Non-Asbestos Content:</b>	10% Cellulose
<b>Sample Composite Homogeneity:</b>	Moderate

**Comments:** Sample 5.062 were not analyzed due to prior positive series.

The test report shall not be reproduced except in full, without written approval of the laboratory. The report must not be used by the client to claim product certification, approval, or endorsement by NVLAP, NIST, or any agency of the federal government. The Company reserves the right to dispose of all samples after a period of thirty (30) days, according to all state and federal guidelines, unless otherwise specified.

Inhomogeneous samples are separated into homogeneous subsamples and analyzed individually. ND means no fibers were detected. When detected, the minimum detection and reporting limit is less than 1% unless point counting is performed. Floor tile samples may contain large amounts of interference material and it is recommended that the sample be analyzed by gravimetric point count analysis to lower the detection limit and to aid in asbestos identification.

† A "Version" indicated by "-x" after the Lab ID# with a value greater than 1 indicates a sample with amended data. The revision number is reflected by the value of "x".

Client: Environmental Compliance and Safety  
 C/O: Kirk Shelton  
 Re: Headwaters\_20240214; Asbestos Inspection -  
 5000 Sq. Ft. Structure

Date of Sampling: 02-15-2024  
 Date of Receipt: 02-16-2024  
 Date of Report: 02-22-2024

**ASBESTOS PLM REPORT**

**Location: S.063, Wall Board (White/Gray)**

Lab ID-Version‡: 17306847-1

Sample Layers	Asbestos Content
Off-White Compound with Paint	2% Chrysotile
White Drywall with Brown Paper	ND
<b>Composite Non-Asbestos Content:</b>	10% Cellulose
<b>Sample Composite Homogeneity:</b>	Moderate

Comments: Sample S.064 were not analyzed due to prior positive series.

**Location: S.065, Ceiling Board (White/Gray)**

Lab ID-Version‡: 17306849-1

Sample Layers	Asbestos Content
White Drywall with Brown Paper and Paint	ND
<b>Composite Non-Asbestos Content:</b>	10% Cellulose
<b>Sample Composite Homogeneity:</b>	Moderate

**Location: S.066, Ceiling Board (White/Gray)**

Lab ID-Version‡: 17306850-1

Sample Layers	Asbestos Content
White Drywall with Brown Paper and Paint	ND
<b>Composite Non-Asbestos Content:</b>	10% Cellulose
<b>Sample Composite Homogeneity:</b>	Moderate

**Location: S.067, Wall Board (White/Gray)**

Lab ID-Version‡: 17306851-1

Sample Layers	Asbestos Content
White Drywall with Brown Paper and Paint	ND
<b>Composite Non-Asbestos Content:</b>	10% Cellulose
<b>Sample Composite Homogeneity:</b>	Moderate

The test report shall not be reproduced except in full, without written approval of the laboratory. The report must not be used by the client to claim product certification, approval, or endorsement by NVLAP, NIST, or any agency of the federal government. The Company reserves the right to dispose of all samples after a period of thirty (30) days, according to all state and federal guidelines, unless otherwise specified.

Inhomogeneous samples are separated into homogeneous subsamples and analyzed individually. ND means no fibers were detected. When detected, the minimum detection and reporting limit is less than 1% unless point counting is performed. Floor tile samples may contain large amounts of interference material and it is recommended that the sample be analyzed by gravimetric point count analysis to lower the detection limit and to aid in asbestos identification.

‡ A "Version" indicated by "-x" after the Lab ID# with a value greater than 1 indicates a sample with amended data. The revision number is reflected by the value of "x".

Client: Environmental Compliance and Safety  
 C/O: Kirk Shelton  
 Re: Headwaters\_20240214; Asbestos Inspection -  
 5000 Sq. Ft. Structure

Date of Sampling: 02-15-2024  
 Date of Receipt: 02-16-2024  
 Date of Report: 02-22-2024

**ASBESTOS PLM REPORT**

**Location: S.068, Wall Board (White/Gray)**

Lab ID-Version‡: 17306852-1

Sample Layers	Asbestos Content
White Compound with Paint	ND
White Drywall with Brown Paper	ND
<b>Composite Non-Asbestos Content:</b>	10% Cellulose
<b>Sample Composite Homogeneity:</b>	Moderate

**Location: S.069, Ceiling Board (White/Gray)**

Lab ID-Version‡: 17306853-1

Sample Layers	Asbestos Content
White Drywall with Brown Paper and Paint	ND
<b>Composite Non-Asbestos Content:</b>	10% Cellulose
<b>Sample Composite Homogeneity:</b>	Moderate

**Location: S.070, Ceiling Board (White/Gray)**

Lab ID-Version‡: 17306854-1

Sample Layers	Asbestos Content
White Drywall with Brown Paper and Paint	ND
<b>Composite Non-Asbestos Content:</b>	10% Cellulose
<b>Sample Composite Homogeneity:</b>	Moderate

**Location: S.071, Wall Board (White/Gray)**

Lab ID-Version‡: 17306855-1

Sample Layers	Asbestos Content
White Drywall with Brown Paper	ND
<b>Composite Non-Asbestos Content:</b>	10% Cellulose
<b>Sample Composite Homogeneity:</b>	Moderate

The test report shall not be reproduced except in full, without written approval of the laboratory. The report must not be used by the client to claim product certification, approval, or endorsement by NVLAP, NIST, or any agency of the federal government. The Company reserves the right to dispose of all samples after a period of thirty (30) days, according to all state and federal guidelines, unless otherwise specified.

Inhomogeneous samples are separated into homogeneous subsamples and analyzed individually. ND means no fibers were detected. When detected, the minimum detection and reporting limit is less than 1% unless point counting is performed. Floor tile samples may contain large amounts of interference material and it is recommended that the sample be analyzed by gravimetric point count analysis to lower the detection limit and to aid in asbestos identification.

‡ A "Version" indicated by "-x" after the Lab ID# with a value greater than 1 indicates a sample with amended data. The revision number is reflected by the value of "x".

Client: Environmental Compliance and Safety  
 C/O: Kirk Shelton  
 Re: Headwaters\_20240214; Asbestos Inspection -  
 5000 Sq. Ft. Structure

Date of Sampling: 02-15-2024  
 Date of Receipt: 02-16-2024  
 Date of Report: 02-22-2024

**ASBESTOS PLM REPORT**

**Location: S.072, Wall Board (White/Gray)**

Lab ID-Version‡: 17306856-1

Sample Layers	Asbestos Content
White Drywall with Brown Paper	ND
<b>Composite Non-Asbestos Content:</b>	10% Cellulose
<b>Sample Composite Homogeneity:</b>	Moderate

**Location: S.073, Wall Paper (Green/White)**

Lab ID-Version‡: 17306857-1

Sample Layers	Asbestos Content
Green Wallpaper	ND
<b>Composite Non-Asbestos Content:</b>	95% Cellulose
<b>Sample Composite Homogeneity:</b>	Good

**Location: S.074, Wall Paper (Green/White)**

Lab ID-Version‡: 17306858-1

Sample Layers	Asbestos Content
Green Wallpaper	ND
<b>Composite Non-Asbestos Content:</b>	95% Cellulose
<b>Sample Composite Homogeneity:</b>	Good

**Location: S.075, Ceiling Board (White/Gray)**

Lab ID-Version‡: 17306859-1

Sample Layers	Asbestos Content
White Compound with Paint	ND
White Drywall with Brown Paper	ND
<b>Composite Non-Asbestos Content:</b>	10% Cellulose
<b>Sample Composite Homogeneity:</b>	Moderate

The test report shall not be reproduced except in full, without written approval of the laboratory. The report must not be used by the client to claim product certification, approval, or endorsement by NVLAP, NIST, or any agency of the federal government. The Company reserves the right to dispose of all samples after a period of thirty (30) days, according to all state and federal guidelines, unless otherwise specified.

Inhomogeneous samples are separated into homogeneous subsamples and analyzed individually. ND means no fibers were detected. When detected, the minimum detection and reporting limit is less than 1% unless point counting is performed. Floor tile samples may contain large amounts of interference material and it is recommended that the sample be analyzed by gravimetric point count analysis to lower the detection limit and to aid in asbestos identification.

‡ A "Version" indicated by "-x" after the Lab ID# with a value greater than 1 indicates a sample with amended data. The revision number is reflected by the value of "x".

Client: Environmental Compliance and Safety  
 C/O: Kirk Shelton  
 Re: Headwaters\_20240214; Asbestos Inspection -  
 5000 Sq. Ft. Structure

Date of Sampling: 02-15-2024  
 Date of Receipt: 02-16-2024  
 Date of Report: 02-22-2024

**ASBESTOS PLM REPORT**

**Location: S.076, Ceiling Board (White/Gray)**

Lab ID-Version‡: 17306860-1

Sample Layers	Asbestos Content
White Compound with Paint	ND
White Drywall with Brown Paper	ND
<b>Composite Non-Asbestos Content:</b>	10% Cellulose
<b>Sample Composite Homogeneity:</b>	Moderate

**Location: S.077, Wall Board (White/Gray)**

Lab ID-Version‡: 17306861-1

Sample Layers	Asbestos Content
White Drywall with Brown Paper and Paint	ND
<b>Composite Non-Asbestos Content:</b>	10% Cellulose
<b>Sample Composite Homogeneity:</b>	Moderate

**Location: S.078, Wall Board (White/Gray)**

Lab ID-Version‡: 17306862-1

Sample Layers	Asbestos Content
White Compound with Paint	ND
White Drywall with Brown Paper	ND
<b>Composite Non-Asbestos Content:</b>	10% Cellulose
<b>Sample Composite Homogeneity:</b>	Moderate

**Location: S.079, Pipe Caulking (White)**

Lab ID-Version‡: 17306863-1

Sample Layers	Asbestos Content
White Caulk	ND
<b>Sample Composite Homogeneity:</b>	Good

The test report shall not be reproduced except in full, without written approval of the laboratory. The report must not be used by the client to claim product certification, approval, or endorsement by NVLAP, NIST, or any agency of the federal government. The Company reserves the right to dispose of all samples after a period of thirty (30) days, according to all state and federal guidelines, unless otherwise specified.

Inhomogeneous samples are separated into homogeneous subsamples and analyzed individually. ND means no fibers were detected. When detected, the minimum detection and reporting limit is less than 1% unless point counting is performed. Floor tile samples may contain large amounts of interference material and it is recommended that the sample be analyzed by gravimetric point count analysis to lower the detection limit and to aid in asbestos identification.

‡ A "Version" indicated by "-x" after the Lab ID# with a value greater than 1 indicates a sample with amended data. The revision number is reflected by the value of "x".

Client: Environmental Compliance and Safety  
 C/O: Kirk Shelton  
 Re: Headwaters\_20240214; Asbestos Inspection -  
 5000 Sq. Ft. Structure

Date of Sampling: 02-15-2024  
 Date of Receipt: 02-16-2024  
 Date of Report: 02-22-2024

**ASBESTOS PLM REPORT**

**Location: S.080, Pipe Caulking (White)**

Lab ID-Version‡: 17306864-1

Sample Layers	Asbestos Content
White Caulk	ND
<b>Sample Composite Homogeneity:</b> Good	

**Location: S.081, Wall Board (White/Gray)**

Lab ID-Version‡: 17306865-1

Sample Layers	Asbestos Content
White Drywall with Brown Paper	ND
<b>Composite Non-Asbestos Content:</b> 10% Cellulose	
<b>Sample Composite Homogeneity:</b> Moderate	

**Location: S.082, Wall Board (White/Gray)**

Lab ID-Version‡: 17306866-1

Sample Layers	Asbestos Content
Off-White Compound with Paint	2% Chrysotile
White Drywall with Brown Paper	ND
<b>Composite Non-Asbestos Content:</b> 10% Cellulose	
<b>Sample Composite Homogeneity:</b> Moderate	

**Location: S.083, Plaster (Tan)**

Lab ID-Version‡: 17306867-1

Sample Layers	Asbestos Content
Tan Plaster	ND
<b>Sample Composite Homogeneity:</b> Good	

The test report shall not be reproduced except in full, without written approval of the laboratory. The report must not be used by the client to claim product certification, approval, or endorsement by NVLAP, NIST, or any agency of the federal government. The Company reserves the right to dispose of all samples after a period of thirty (30) days, according to all state and federal guidelines, unless otherwise specified.

Inhomogeneous samples are separated into homogeneous subsamples and analyzed individually. ND means no fibers were detected. When detected, the minimum detection and reporting limit is less than 1% unless point counting is performed. Floor tile samples may contain large amounts of interference material and it is recommended that the sample be analyzed by gravimetric point count analysis to lower the detection limit and to aid in asbestos identification.

‡ A "Version" indicated by "-x" after the Lab ID# with a value greater than 1 indicates a sample with amended data. The revision number is reflected by the value of "x".



Client: Environmental Compliance and Safety  
 C/O: Kirk Shelton  
 Re: Headwaters\_20240214; Asbestos Inspection -  
 5000 Sq. Ft. Structure

Date of Sampling: 02-15-2024  
 Date of Receipt: 02-16-2024  
 Date of Report: 02-22-2024

**ASBESTOS PLM REPORT**

**Location: S.084, Plaster (Tan)**

Lab ID-Version‡: 17306868-1

Sample Layers	Asbestos Content
Tan Plaster	ND
<b>Sample Composite Homogeneity:</b> Good	

**Location: S.085, Wall Board (White/Gray)**

Lab ID-Version‡: 17306869-1

Sample Layers	Asbestos Content
Off-White Compound with Paint	2% Chrysotile
White Drywall with Brown Paper	ND
<b>Composite Non-Asbestos Content:</b> 10% Cellulose	
<b>Sample Composite Homogeneity:</b> Moderate	

**Comments:** Sample S.086 were not analyzed due to prior positive series.

**Location: S.087, Floor Underlay (Brown)**

Lab ID-Version‡: 17306871-1

Sample Layers	Asbestos Content
Brown Flooring	ND
<b>Composite Non-Asbestos Content:</b> 95% Cellulose	
<b>Sample Composite Homogeneity:</b> Good	

**Location: S.088, Floor Underlay (Brown)**

Lab ID-Version‡: 17306872-1

Sample Layers	Asbestos Content
Brown Flooring	ND
<b>Composite Non-Asbestos Content:</b> 95% Cellulose	
<b>Sample Composite Homogeneity:</b> Good	

The test report shall not be reproduced except in full, without written approval of the laboratory. The report must not be used by the client to claim product certification, approval, or endorsement by NVLAP, NIST, or any agency of the federal government. The Company reserves the right to dispose of all samples after a period of thirty (30) days, according to all state and federal guidelines, unless otherwise specified.

Inhomogeneous samples are separated into homogeneous subsamples and analyzed individually. ND means no fibers were detected. When detected, the minimum detection and reporting limit is less than 1% unless point counting is performed. Floor tile samples may contain large amounts of interference material and it is recommended that the sample be analyzed by gravimetric point count analysis to lower the detection limit and to aid in asbestos identification.

‡ A "Version" indicated by "-x" after the Lab ID# with a value greater than 1 indicates a sample with amended data. The revision number is reflected by the value of "x".

Client: Environmental Compliance and Safety  
 C/O: Kirk Shelton  
 Re: Headwaters\_20240214; Asbestos Inspection -  
 5000 Sq. Ft. Structure

Date of Sampling: 02-15-2024  
 Date of Receipt: 02-16-2024  
 Date of Report: 02-22-2024

**ASBESTOS PLM REPORT**

**Location: S.089, Flashing/Caulking Chimney (Wall)**

Lab ID-Version‡: 17306873-1

Sample Layers	Asbestos Content
Off-White Caulk	ND
Black Roof Flashing	ND
Silver Paint	2% Chrysotile
<b>Sample Composite Homogeneity:</b>	Good

**Location: S.090, Patch Roof (White)**

Lab ID-Version‡: 17306874-1

Sample Layers	Asbestos Content
Gray Non-Fibrous Material with Paint	ND
<b>Sample Composite Homogeneity:</b>	Moderate

**Location: S.091, Built-Up Roof (Black)**

Lab ID-Version‡: 17306875-1

Sample Layers	Asbestos Content
Black/White Coating	ND
Black Roofing Tar	ND
<b>Composite Non-Asbestos Content:</b>	10% Glass Fibers
<b>Sample Composite Homogeneity:</b>	Moderate

**Location: S.092, Built-Up Roof (Black)**

Lab ID-Version‡: 17306876-1

Sample Layers	Asbestos Content
Black/White Coating	ND
Black Roofing Tar	ND
<b>Composite Non-Asbestos Content:</b>	10% Glass Fibers
<b>Sample Composite Homogeneity:</b>	Moderate

The test report shall not be reproduced except in full, without written approval of the laboratory. The report must not be used by the client to claim product certification, approval, or endorsement by NVLAP, NIST, or any agency of the federal government. The Company reserves the right to dispose of all samples after a period of thirty (30) days, according to all state and federal guidelines, unless otherwise specified.

Inhomogeneous samples are separated into homogeneous subsamples and analyzed individually. ND means no fibers were detected. When detected, the minimum detection and reporting limit is less than 1% unless point counting is performed. Floor tile samples may contain large amounts of interference material and it is recommended that the sample be analyzed by gravimetric point count analysis to lower the detection limit and to aid in asbestos identification.

‡ A "Version" indicated by "-x" after the Lab ID# with a value greater than 1 indicates a sample with amended data. The revision number is reflected by the value of "x".

Client: Environmental Compliance and Safety  
 C/O: Kirk Shelton  
 Re: Headwaters\_20240214; Asbestos Inspection -  
 5000 Sq. Ft. Structure

Date of Sampling: 02-15-2024  
 Date of Receipt: 02-16-2024  
 Date of Report: 02-22-2024

**ASBESTOS PLM REPORT**

**Location: S.093, Ceiling Board / Mud (White/Gray)**

Lab ID-Version‡: 17306877-1

Sample Layers	Asbestos Content
White Compound with paint	ND
Cream Tape	ND
White Joint Compound	ND
<b>Composite Non-Asbestos Content:</b>	5% Cellulose
<b>Sample Composite Homogeneity:</b>	Moderate

**Location: S.094, Ceiling Board / Mud (White/Gray)**

Lab ID-Version‡: 17306878-1

Sample Layers	Asbestos Content
White Compound with paint	ND
Cream Tape	ND
White Joint Compound	ND
White Drywall with Brown Paper	ND
<b>Composite Non-Asbestos Content:</b>	15% Cellulose
<b>Sample Composite Homogeneity:</b>	Moderate

**Location: S.095, Wall Paper (Gold)**

Lab ID-Version‡: 17306879-1

Sample Layers	Asbestos Content
Gold Wallpaper	ND
<b>Composite Non-Asbestos Content:</b>	99% Cellulose
<b>Sample Composite Homogeneity:</b>	Good

**Location: S.096, Wall Paper (Gold)**

Lab ID-Version‡: 17306880-1

Sample Layers	Asbestos Content
Gold Wallpaper	ND
<b>Composite Non-Asbestos Content:</b>	99% Cellulose
<b>Sample Composite Homogeneity:</b>	Good

The test report shall not be reproduced except in full, without written approval of the laboratory. The report must not be used by the client to claim product certification, approval, or endorsement by NVLAP, NIST, or any agency of the federal government. The Company reserves the right to dispose of all samples after a period of thirty (30) days, according to all state and federal guidelines, unless otherwise specified.

Inhomogeneous samples are separated into homogeneous subsamples and analyzed individually. ND means no fibers were detected. When detected, the minimum detection and reporting limit is less than 1% unless point counting is performed. Floor tile samples may contain large amounts of interference material and it is recommended that the sample be analyzed by gravimetric point count analysis to lower the detection limit and to aid in asbestos identification.

‡ A "Version" indicated by "-x" after the Lab ID# with a value greater than 1 indicates a sample with amended data. The revision number is reflected by the value of "x".

Client: Environmental Compliance and Safety  
 C/O: Kirk Shelton  
 Re: Headwaters\_20240214; Asbestos Inspection -  
 5000 Sq. Ft. Structure

Date of Sampling: 02-15-2024  
 Date of Receipt: 02-16-2024  
 Date of Report: 02-22-2024

**ASBESTOS PLM REPORT**

**Location: S.097, Wall Board (White/Gray)**

Lab ID-Version‡: 17306881-1

Sample Layers	Asbestos Content
Off-White Compound with Paint	2% Chrysotile
Cream Tape	ND
Off-White Joint Compound	2% Chrysotile
White Drywall with Brown Paper	ND
<b>Composite Asbestos Fibrous Content:</b>	< 1% Asbestos
<b>Composite Non-Asbestos Content:</b>	15% Cellulose
<b>Sample Composite Homogeneity:</b>	Moderate

**Comments:** Composite asbestos content provided is only for Drywall/Joint compound. Composite content provided for this analysis has been performed by following the NESHAP guidelines. Sample S.098 were not analyzed due to prior positive series.

**Location: S.099, Roofing Underlay (Brown)**

Lab ID-Version‡: 17306883-1

Sample Layers	Asbestos Content
Brown Fibrous Material	ND
<b>Composite Non-Asbestos Content:</b>	95% Cellulose
<b>Sample Composite Homogeneity:</b>	Good

**Location: S.100, Roofing Underlay (Brown)**

Lab ID-Version‡: 17306884-1

Sample Layers	Asbestos Content
Brown Fibrous Material	ND
<b>Composite Non-Asbestos Content:</b>	95% Cellulose
<b>Sample Composite Homogeneity:</b>	Good

**Location: S.101, Window Caulking (Gray)**

Lab ID-Version‡: 17306885-1

Sample Layers	Asbestos Content
Gray Caulk	ND
<b>Sample Composite Homogeneity:</b>	Good

The test report shall not be reproduced except in full, without written approval of the laboratory. The report must not be used by the client to claim product certification, approval, or endorsement by NVLAP, NIST, or any agency of the federal government. The Company reserves the right to dispose of all samples after a period of thirty (30) days, according to all state and federal guidelines, unless otherwise specified.

Inhomogeneous samples are separated into homogeneous subsamples and analyzed individually. ND means no fibers were detected. When detected, the minimum detection and reporting limit is less than 1% unless point counting is performed. Floor tile samples may contain large amounts of interference material and it is recommended that the sample be analyzed by gravimetric point count analysis to lower the detection limit and to aid in asbestos identification.

‡ A "Version" indicated by -"x" after the Lab ID# with a value greater than 1 indicates a sample with amended data. The revision number is reflected by the value of "x".

**Eurofins EPK Built Environment Testing, LLC**  
 6215 Regency Parkway, Suite 900, Norcross, GA 30071  
 (866) 871-1984 www.eurofinsus.com/Built

Client: Environmental Compliance and Safety  
 C/O: Kirk Shelton  
 Re: Headwaters\_20240214; Asbestos Inspection -  
 5000 Sq. Ft. Structure

Date of Sampling: 02-15-2024  
 Date of Receipt: 02-16-2024  
 Date of Report: 02-22-2024

**ASBESTOS PLM REPORT**

**Location: S.102, Window Caulking (Gray)**

Lab ID-Version‡: 17306886-1

Sample Layers	Asbestos Content
Gray Caulk	ND
<b>Sample Composite Homogeneity:</b> Good	

**Location: S.103, Window Caulking (Gray)**

Lab ID-Version‡: 17306887-1

Sample Layers	Asbestos Content
Gray Caulk	ND
<b>Sample Composite Homogeneity:</b> Good	

**Location: S.104, Window Caulking (Gray)**

Lab ID-Version‡: 17306888-1

Sample Layers	Asbestos Content
Gray Caulk	ND
<b>Sample Composite Homogeneity:</b> Good	

**Location: S.105, Window Caulking (Gray)**

Lab ID-Version‡: 17306889-1

Sample Layers	Asbestos Content
Gray Caulk	ND
<b>Sample Composite Homogeneity:</b> Good	

The test report shall not be reproduced except in full, without written approval of the laboratory. The report must not be used by the client to claim product certification, approval, or endorsement by NVLAP, NIST, or any agency of the federal government. The Company reserves the right to dispose of all samples after a period of thirty (30) days, according to all state and federal guidelines, unless otherwise specified.

Inhomogeneous samples are separated into homogeneous subsamples and analyzed individually. ND means no fibers were detected. When detected, the minimum detection and reporting limit is less than 1% unless point counting is performed. Floor tile samples may contain large amounts of interference material and it is recommended that the sample be analyzed by gravimetric point count analysis to lower the detection limit and to aid in asbestos identification.

‡ A "Version" indicated by "-x" after the Lab ID# with a value greater than 1 indicates a sample with amended data. The revision number is reflected by the value of "x".

Client: Environmental Compliance and Safety  
 C/O: Kirk Shelton  
 Re: Headwaters\_20240214; Asbestos Inspection -  
 5000 Sq. Ft. Structure

Date of Sampling: 02-15-2024  
 Date of Receipt: 02-16-2024  
 Date of Report: 02-22-2024

**ASBESTOS PLM REPORT**

**Location: S.106, Window Caulking (Gray)**

Lab ID-Version‡: 17306890-1

Sample Layers	Asbestos Content
Gray Caulk	ND
<b>Sample Composite Homogeneity:</b>	Good

**Location: S.107, Window Caulking (Gray)**

Lab ID-Version‡: 17306891-1

Sample Layers	Asbestos Content
Gray Caulk	ND
<b>Sample Composite Homogeneity:</b>	Good

**Location: S.108, Window Caulking (Gray)**

Lab ID-Version‡: 17306892-1

Sample Layers	Asbestos Content
Gray Caulk	ND
<b>Sample Composite Homogeneity:</b>	Good

**Location: S.109, Wall Paper (Green/White)**

Lab ID-Version‡: 17306893-1

Sample Layers	Asbestos Content
Green Wallpaper	ND
<b>Composite Non-Asbestos Content:</b>	99% Cellulose
<b>Sample Composite Homogeneity:</b>	Good

The test report shall not be reproduced except in full, without written approval of the laboratory. The report must not be used by the client to claim product certification, approval, or endorsement by NVLAP, NIST, or any agency of the federal government. The Company reserves the right to dispose of all samples after a period of thirty (30) days, according to all state and federal guidelines, unless otherwise specified.

Inhomogeneous samples are separated into homogeneous subsamples and analyzed individually. ND means no fibers were detected. When detected, the minimum detection and reporting limit is less than 1% unless point counting is performed. Floor tile samples may contain large amounts of interference material and it is recommended that the sample be analyzed by gravimetric point count analysis to lower the detection limit and to aid in asbestos identification.

‡ A "Version" indicated by -"x" after the Lab ID# with a value greater than 1 indicates a sample with amended data. The revision number is reflected by the value of "x".

Client: Environmental Compliance and Safety  
 C/O: Kirk Shelton  
 Re: Headwaters\_20240214; Asbestos Inspection -  
 5000 Sq. Ft. Structure

Date of Sampling: 02-15-2024  
 Date of Receipt: 02-16-2024  
 Date of Report: 02-22-2024

**ASBESTOS PLM REPORT**

**Location: S.110, Wall Paper (Green/White)**

Lab ID-Version‡: 17306894-1

Sample Layers	Asbestos Content
Green Wallpaper	ND
<b>Composite Non-Asbestos Content:</b>	99% Cellulose
<b>Sample Composite Homogeneity:</b>	Good

**Location: S.111, Wall Board (White/Gray)**

Lab ID-Version‡: 17306895-1

Sample Layers	Asbestos Content
Off-White Compound with Paint	2% Chrysotile
White Drywall with Brown Paper	ND
<b>Composite Non-Asbestos Content:</b>	10% Cellulose
<b>Sample Composite Homogeneity:</b>	Moderate

**Comments:** Samples S.112 were not analyzed due to prior positive series.

The test report shall not be reproduced except in full, without written approval of the laboratory. The report must not be used by the client to claim product certification, approval, or endorsement by NVLAP, NIST, or any agency of the federal government. The Company reserves the right to dispose of all samples after a period of thirty (30) days, according to all state and federal guidelines, unless otherwise specified.

Inhomogeneous samples are separated into homogeneous subsamples and analyzed individually. ND means no fibers were detected. When detected, the minimum detection and reporting limit is less than 1% unless point counting is performed. Floor tile samples may contain large amounts of interference material and it is recommended that the sample be analyzed by gravimetric point count analysis to lower the detection limit and to aid in asbestos identification.

‡ A "Version" indicated by "-x" after the Lab ID# with a value greater than 1 indicates a sample with amended data. The revision number is reflected by the value of "x".

CHAIN OF CUSTODY  eurofins

www.eurofinsus.com/Built

East: (866) 871-1984  
 Central: (800) 651-4802  
 West: (866) 888-0653

Built Environment Testing

WEATHER	Fog	Rain	Snow	Wind	Clear
None					
Light					
Moderate					
Heavy					
LEVL					



003542582

Page 1 of 8

CONTACT INFORMATION

Company: E.C.S. INC.  
 Address: PO BOX 356, Sherman, MS 38869  
 Contact: Kirk Shelton  
 Phone: (662) 840-5945 / (662) 397-6555 | kshelton@envirocomp.net  
 Special Instructions:

PROJECT INFORMATION

Project ID: Headwaters\_20240214  
 Project Description: Asbestos Inspection - 5000 Sq. Ft. Structure  
 Project Zip Code: 39158  
 Sampling Date/Time: 2/18/24 8:45-11:00  
 Sampled By: David Long

TURN AROUND TIME CODES - (TAT)

STD - Standard (Default)  
 ND - Next Business Day  
 SD - Same Business Day  
 WH - Week and Holiday ASAP  
 Rushes received after 2pm or on weekends, will be considered received the next business day. Please alert us in advance of weekend analysis needs

SAMPLE ID	DESCRIPTION	Sample Type (Below)	TAT (Above)	Total Volume/Area (as applicable)	NOTES (Time of day, Temp, RH, etc.)
S.001	Floor Mastic (yellow)	B	STD		Positive for with S.001
S.002	Floor Mastic (yellow)	B	STD		Positive for with S.003
S.003	Wall Board (white/gray)	B	STD		Positive for with S.005
S.004	Wall Board (white/gray)	B	STD		Positive for with S.007
S.005	Ceiling Board (white/gray)	B	STD		Positive for with S.009
S.006	Ceiling Board (white/gray)	B	STD		Positive for with S.011
S.007	Wall Board (white/gray)	B	STD		Positive for with S.013
S.008	Wall Board (white/gray)	B	STD		
S.009	Wall Paper (multi-color)	B	STD		
S.010	Wall Paper (multi-color)	B	STD		
S.011	Ceiling Board (white/gray)	B	STD		
S.012	Ceiling Board (white/gray)	B	STD		
S.013	Floor Mastic (yellow)	B	STD		
S.014	Floor Mastic (yellow)	B	STD		
S.015	Wall Board (white/gray)	B	STD		

SAMPLE TYPE CODES

BC - BioCassella CP - Contact Plate T - Tape O - Other  
 A1S - Andersen ST - Spore Trap SW - Swab  
 SAS - Surface Air Sampler B - Bulk SO - Soil  
 NP - Non-potable Water P - Potable Water D - Dust

REQUESTED SI

Non-Culturable	Culturable	Other Requests
Spore Trap Tape Swab, Bulk	BioCassella™ Andersen, SAS Swab, Water, Bulk, Dust, Soil, Contact Plate	Asbestos in Air - PCM Andomether Coat (MCHB 7400) Asbestos Bulk - PCM Lead (Pb), Flame AA PCB (please specify test) Mergens (please specify test)
Quantitative Spore Count (Direct)	Gram Stain and Counts (Culture Air and Surface Bacteria)	
Dust Characterization	Quantitative Air Fung (Genus ID Asp spp.) Molda Surface Fung (Genus + Asp spp.)	
Other Biological Parameters - equipment	Legionella culture Tear Culture, Endo (Presence/Absence) Quantitative Air Fung (Genus ID Asp spp.) Culturable Air Fung (Genus ID Asp spp.)	
Dried Microscopic Exam (Qualitative)		

RECEIVED BY

DATE & TIME: 2/18/24 9:49  
 RECEIVED BY: *David Long*

RELINQUISHED BY

DATE & TIME: 2/18/24 17:00  
 RELINQUISHED BY: *David Long*

By submitting this Chain of Custody, you agree to be bound by the terms and conditions set forth at <https://www.eurofinsus.com/environment-testing/built-environment/resources/sampling-guides-and-forms>  
 ©COPYRIGHT 2022 EUROFINS EPK BUILT ENVIRONMENT TESTING, LLC





003542582

Page 2 of 8

# CHAIN OF CUSTODY eurofins

www.eurofins.com/built

Built Environment Testing

Eant: (866) 871-1984  
Central: (800) 651-4002  
West: (866) 888-6653

**CONTACT INFORMATION**

Company: ECS, INC. Address: PO BOX 356, Sherman, MS 38869  
 Contact: Kirk Shelton Special Instructions:  
 Phone: (662) 840-5945 / (662) 397-6555 | kshelton@envirocomp.net

**PROJECT INFORMATION**

Project ID: Headwaters\_20240214  
 Project Description: Asbestos Inspection - 5000 Sq. Ft. Structure  
 Project Zip Code: 39158  
 Sampling Date/Time: 2/18/24 11AM-1PM  
 Sampled by: David Popa

SAMPLE ID	DESCRIPTION	Sample Type (Below)	TAT (Above)	Total Volume/Area (as applicable)	NOTES (Time of day, Temp, RH, etc.)	TURN AROUND TIME CODES - (TAT)			
						STD - Standard (Default)	ND - Next Business Day	SD - Same Business Day	WH - Weekend/Holiday/SAP
S.016	Wall Board Cuckita (brng)	B	STD		Positive str with S.015				
S.017	Ceiling Board Cuckita (brng)	B	STD						
S.018	Ceiling Board Cuckita (brng)	B	STD		Positive str with S.017				
S.019	Floor Mastic C yellow	B	STD						
S.020	Floor Mastic C yellow	B	STD		Positive str with S.015				
S.021	Wall Board Cuckita (brng)	B	STD						
S.022	Wall Board Cuckita (brng)	B	STD		Positive str with S.021				
S.023	Ceiling Board Cuckita (brng)	B	STD						
S.024	Ceiling Board Cuckita (brng)	B	STD		Positive str with S.021				
S.025	Wall Board Cuckita (brng)	B	STD		Positive str with S.025				
S.026	Wall Board Cuckita (brng)	B	STD						
S.027	Ceiling Board Cuckita (brng)	B	STD		Positive str with S.015				
S.028	Ceiling Board Cuckita (brng)	B	STD						
S.029	Floor Mastic C yellow	B	STD		Positive str with S.021				
S.030	Floor Mastic C yellow	B	STD		Positive str with S.021				

**RELINQUISHED BY** David Popa **DATE & TIME** 2/15/24 1100

**RECEIVED BY** [Signature] **DATE & TIME** 2/16/24 9:40

**WEATHER**

None	Fog	Rain	Snow	Wind	Cloud
Light					
Moderate					
Heavy					

Non-Culturable	Culturable	Other Requests
Spore Trap	BioCassette™, Andersen, SAS, Swab, Water, Bulk, Dust, Soil, Contact Plate	Asbestos Bulk - P1M
Type: Swab, Bulk	Legionella culture	Asbestos in Air - PCM Airborne Count (NIOSH 7400)
Direct Microscopic Exam (Qualitative)	Gram Stain and Counts (Qualitative Air and Surface Bacteria)	PCR (please specify test)
Quantitative spore count (direct)	Culturable Air Fungi (Genus ID Also spp.)	Lead (Pb) Flame AA
Dust Characterization	7-Mode Surface Fungi (Genus + Asp spp.)	Adhesives (please specify test)
Other biological particles - supplement	Total Coliform, E. coli (Presence/Absence)	

By submitting this Chain of Custody, you agree to be bound by the terms and conditions set forth at: <https://www.eurofins.com/environmental-testing/built-environment/resources/sampling-quotes-and-forms>

# CHAIN OF CUSTODY eurofins

www.eurofins.com/Built

East: (866) 871-1984  
 Central: (800) 661-4802  
 West: (866) 888-8853

Built Environment Testing

WEATHER	Fog	Rain	Snow	Wind	Other
LEVEL	None				
	Light				
	Moderate				
	Heavy				

Page 3 of 8



003542582

### REQUESTED SER

Non-Culturable	Culturable	Other Requests
Spore Trap Tape, Swab, Bulk Other biological particles - supplement Dried Microscope Exam (Qualitative) Quantitative spore count/direct count Dust Characterization	BioCassette™ Andersen, SAS, Swab, Water, Bulk, Dust, Soil, Contact Plate Legionella culture Total Coliform, E.coli (Presence/Sense), Coliformy, Sewage Screen OTHER (please specify test) Asbestos Surf. P. M. Asbestos in Air - PCM Airborne Count (NIOSH 7403)	Lead (Pb) Flame AA PCR (please specify test) Allergens (please specify test)

### CONTACT INFORMATION

Company	ECS, INC.	
Contact	Kirk Shelton	
Phone	(662) 840-5945 / (662) 397-6555	
Address	PO BOX 356, Sherman, MS 38869	
Special Instructions:	kshelton@envirocomp.net	

### PROJECT INFORMATION

Project ID:	Headwaters_20240214	
Project Description:	Asbestos Inspection - 5000 Sq. Ft. Structure	
Project Zip Code:	39158	Sampling Date/Time: 2/18/24 8:40-11:00
PO Number:		By: DAVID FOGEL

SAMPLE ID	DESCRIPTION	Sample Type (Below)	TAT (Above)	Total Volume/Area (as applicable)	NOTES (Time of day, Temp, RH, etc.)	TURN AROUND TIME CODES - (TAT)	
						STD - Standard (Default)	Rushes received after 2pm or on weekends, will be considered received the next business day. Please alert us in advance of weekend analysis needs
S.031	Wall Board (white/gray)	B	STD				
S.032	Wall Board (white/gray)	B	STD		Positive stop with S.037		
S.033	Ceiling Board (white/gray)	B	STD				
S.034	Ceiling Board (white/gray)	B	STD				
S.035	Floor Mastic (yellow)	B	STD		Positive stop with S.033		
S.036	Floor Mastic (yellow)	B	STD				
S.037	Wall Board (white/gray)	B	STD		Positive stop with S.033		
S.038	Wall Board (white/gray)	B	STD				
S.039	Ceiling Board (white/gray)	B	STD		Positive stop with S.037		
S.040	Ceiling Board (white/gray)	B	STD				
S.041	Floor Mastic (yellow)	B	STD		Positive stop with S.039		
S.042	Floor Mastic (yellow)	B	STD				
S.043	Wall Board (white/gray)	B	STD		Positive stop with S.041		
S.044	Wall Board (white/gray)	B	STD				
S.045	Ceiling Board (white/gray)	B	STD		Positive stop with S.043		

### SAMPLE TYPE CODES

BC - BioCassette™	GP - Contact Plate	T - Tape	O - Other
A1S - Andersen	ST - Spore Trap	SW - Swab	
SAS - Surface Air Sampler	B - Bulk	SO - Soil	
NP - Non-potable Water	P - Potable Water	D - Dual	

### RELINQUISHED BY

David Fogel

### DATE & TIME

2/15/24

### RECEIVED BY

WUU

### DATE & TIME

2/16/24

9:49

By submitting this Chain of Custody, you agree to be bound by the terms and conditions set forth at: <https://www.eurofins.com/environment-testing/built-environment/testing-guides-and-forms>



003542582

Page 4 of 8

CHAIN OF CUSTODY eurofins  
www.eurofinsus.com/Built

East: (868) 871-1984  
Central: (800) 851-4802  
West: (868) 888-6653

Built Environment Testing

WEATHER	Fog	Rain	Snow	Wind	Clear
LEVEL	None	Light	Moderate	Heavy	

**CONTACT INFORMATION**

Company: EGS, INC.  
 Address: PO BOX 356, Sherman, MS 38869  
 Contact: Kirk Shelton  
 Phone: (662) 840-5945 / (662) 397-6555 kshelton@envirocomp.net

**PROJECT INFORMATION**

Project ID: Headwaters\_20240214  
 Project Description: Asbestos Inspection - 5000 Sq. Ft. Structure  
 Project Zip Code: 39158  
 Sampling Date/Time: 2/15/24 11:00 AM  
 Sample Location: DAVID LANGE

SAMPLE ID	DESCRIPTION	Sample Type (Below)	TAT (Above)	Total Volume/Area (as applicable)	NOTES (Time of day, Temp, RH, etc.)	TURN AROUND TIME CODES - (TAT)	
						STD - Standard (Default)	MD - Next Business Day
S.046	Ceiling Board (white/gray)	B	STD		Positive Star with S.051		
S.047	Floor mastic (yellow)	B	STD		Positive Star with S.051		
S.048	Floor mastic (yellow)	B	STD		Positive Star with S.051		
S.049	Wall Board (white/gray)	B	STD		Positive Star with S.051		
S.050	Wall Board (white/gray)	B	STD		Positive Star with S.051		
S.051	Ceiling Board (white/gray)	B	STD		Positive Star with S.051		
S.052	Ceiling Board (white/gray)	B	STD		Positive Star with S.051		
S.053	Floor mastic (yellow)	B	STD		Positive Star with S.051		
S.054	Floor mastic (yellow)	B	STD		Positive Star with S.051		
S.055	Wall Board (white/gray)	B	STD		Positive Star with S.051		
S.056	Wall Board (white/gray)	B	STD		Positive Star with S.051		
S.057	Ceiling Board (white/gray)	B	STD		Positive Star with S.051		
S.058	Ceiling Board (white/gray)	B	STD		Positive Star with S.051		
S.059	Wall Board (white/gray)	B	STD		Positive Star with S.051		
S.060	Wall Board (white/gray)	B	STD		Positive Star with S.051		

**SAMPLE TYPE CODES**

BC - BioCassette  
 AT - Andersen  
 SAS - Surface Air Sampler  
 NP - Non-potable Water

CP - Contact Plate  
 ST - Spore Trap  
 B - Bulk  
 P - Potable Water

T - Tape  
 SW - Swab  
 SO - Soil  
 D - Dust

RELINQUISHED BY: David Lopez  
 DATE & TIME: 2/15/24 1:00

**REQUESTED SER**

Non-Culturable	Culturable	Other Requests
Spore Trap	BioCassette - Andersen, SAS, Swab, Water, Bulk, Dust, Soil, Contact Plate	Asbestos in Air - PCM Airborne Count (NIOSH 7400)
Other biological parameters - supplement	Gram Stain and Counts (Culture Air and Surface Bedders)	Asbestos Bulk - PCM
Dred Microscopic Exam (Qualitative)	Culturable Air Fungi (Genus ID Asp spp.)	Lead (Pb) - Flame AA
Quantitative spore count (Quantitative)	Legionella culture	PCr (please specify test)
Dust Characterization	Total Coliform, E coli (Presence/Absence)	Micogens (please specify test)
	Quantitative Beverage Screen	
	OTHER (please specify test)	

RECEIVED BY: *WJW*  
 DATE & TIME: 2/14/24 9:49

By submitting this Chain of Custody, you agree to be bound by the terms and conditions set forth at: <https://www.eurofins.com/environment-testing/built-environment/testing/resources/sampling-guides-and-forms>

WEATHER		Fog	Rain	Snow	Wind	Clear
LEVEL						
None						
Light						
Moderate						
Heavy						

**CONTACT INFORMATION**

Company: ECS, INC.  
 Address: PO BOX 356, Sherman, MS 38869  
 Contact: Kirk Shelton  
 Phone: (662) 840-5945 / (662) 397-6555  
 Email: kshelton@envirocomp.net

**PROJECT INFORMATION**

Project ID: Headwaters\_20240214  
 Project Description: Asbestos Inspection - 5000 Sq. Ft. Structure  
 Project Zip Code: 39158  
 Sampling Date/Time: 2/18/24 8:45 AM  
 Sampled By: DAVID KOMPANE  
 Turn Around Time Codes (TAT):  
 STD - Standard (Default)  
 ND - Next Business Day  
 SD - Same Business Day  
 WH - Weekend/Holiday/SAP  
 Notes: Rushes received after 2pm or on weekends, will be considered received the next business day. Please alert us in advance of weekend analysis needs.

SAMPLE ID	DESCRIPTION	Sample Type (Below)	TAT (Above)	Total Volume/Area (as applicable)	NOTES (Time of day, Temp, RH, etc.)	Requested Service	
						Non-Culturable	Culturable
S.061	Ceiling Board (white/gray)	B	STD		Positive Star with S.062	Asbestos Bulk - PLM	Asbestos in Air - PCM Airborne by Count (NIOSH 7400)
S.062	Ceiling Board (white/gray)	B	STD		Positive Star with S.061	Asbestos Bulk - PLM	Asbestos in Air - PCM Airborne by Count (NIOSH 7400)
S.063	Wall Board (white/gray)	B	STD		Positive Star with S.062	Asbestos Bulk - PLM	Asbestos in Air - PCM Airborne by Count (NIOSH 7400)
S.064	Wall Board (white/gray)	B	STD		Positive Star with S.063	Asbestos Bulk - PLM	Asbestos in Air - PCM Airborne by Count (NIOSH 7400)
S.065	Ceiling Board (white/gray)	B	STD		Positive Star with S.064	Asbestos Bulk - PLM	Asbestos in Air - PCM Airborne by Count (NIOSH 7400)
S.066	Ceiling Board (white/gray)	B	STD		Positive Star with S.065	Asbestos Bulk - PLM	Asbestos in Air - PCM Airborne by Count (NIOSH 7400)
S.067	Wall Board (white/gray)	B	STD		Positive Star with S.066	Asbestos Bulk - PLM	Asbestos in Air - PCM Airborne by Count (NIOSH 7400)
S.068	Wall Board (white/gray)	B	STD		Positive Star with S.067	Asbestos Bulk - PLM	Asbestos in Air - PCM Airborne by Count (NIOSH 7400)
S.069	Ceiling Board (white/gray)	B	STD		Positive Star with S.068	Asbestos Bulk - PLM	Asbestos in Air - PCM Airborne by Count (NIOSH 7400)
S.070	Ceiling Board (white/gray)	B	STD		Positive Star with S.069	Asbestos Bulk - PLM	Asbestos in Air - PCM Airborne by Count (NIOSH 7400)
S.071	Wall Board (white/gray)	B	STD		Positive Star with S.070	Asbestos Bulk - PLM	Asbestos in Air - PCM Airborne by Count (NIOSH 7400)
S.072	Wall Board (white/gray)	B	STD		Positive Star with S.071	Asbestos Bulk - PLM	Asbestos in Air - PCM Airborne by Count (NIOSH 7400)
S.073	Wall Paper (green/white)	B	STD		Positive Star with S.072	Asbestos Bulk - PLM	Asbestos in Air - PCM Airborne by Count (NIOSH 7400)
S.074	Wall Paper (green/white)	B	STD		Positive Star with S.073	Asbestos Bulk - PLM	Asbestos in Air - PCM Airborne by Count (NIOSH 7400)
S.075	Ceiling Board (white/gray)	B	STD		Positive Star with S.074	Asbestos Bulk - PLM	Asbestos in Air - PCM Airborne by Count (NIOSH 7400)

SAMPLE TYPE CODES			
BC - BioCassette	CP - Contact Plate	T - Tape	O - Other
A1S - Andersen	ST - Spore Trap	SW - Swab	
SAS - Surface Air Sampler	B - Bulk	SO - Soil	
NP - Non-potable Water	P - Potable Water	D - Dust	

RELINQUISHED BY	DATE & TIME
<i>David Korp</i>	2/18/24 1700
RECEIVED BY	DATE & TIME
<i>llm</i>	2/18/24 9:49



003542582

Page 5 of 5



003542582

Page 608

# CHAIN OF CUSTODY eurofins

www.eurofinsus.com/Built

Built Environment Testing

East: (866) 871-1894  
Central: (800) 651-4802  
West: (866) 898-6653

WEATHER		Fog	Rain	Snow	Wind	Clear
None						
Light						
Moderate						
Heavy						
LEVER						

**CONTACT INFORMATION**

Company: **ECOS, INC.**  
 Address: **PO BOX 356, Sherman, MS 38869**  
 Contact: **Kirk Shelton**  
 Phone: **(662) 840-5945 / (662) 397-6555** | Email: **kshelton@envirocomp.net**

Special Instructions:

**PROJECT INFORMATION**

Headwaters 20240214  
 Asbestos Inspection - 5000 Sq. Ft. Structure  
 Sampling Date/Time: **2/18/24 8:45-11:00**  
 Sample by: **David Long**

**TURN AROUND TIME CODES - (TAT)**  
 STD - Standard (Default) Rushes received after 2pm or on weekends, will be considered received the next business day. Please alert us in advance of weekend analysis needs.  
 ND - Next Business Day  
 SD - Same Business Day  
 WH - Weekend/Holiday/ASAP

SAMPLE ID	DESCRIPTION	Sample Type (Below)	TAT (Above)	Total Volume/Area (as applicable)	NOTES
S.076	Ceiling Board (white/gray)	B	STD		Positive ster with S.076
S.077	Wall Board (white/gray)	B	STD		
S.078	Wall Board (white/gray)	B	STD		Positive ster with S.078
S.079	Pipe (ulky) (white)	B	STD		
S.080	Pipe (ulky) (white)	B	STD		
S.081	Wall Board (white/gray)	B	STD		
S.082	Wall Board (white/gray)	B	STD		
S.083	Plaster (tan)	B	STD		Positive ster with S.083
S.084	Plaster (tan)	B	STD		Positive ster with S.084
S.085	Wall Board (white/gray)	B	STD		Positive ster with S.085
S.086	Wall Board (white/gray)	B	STD		Positive ster with S.086
S.087	Floor underlay (Brown)	B	STD		Positive ster with S.087
S.088	Floor underlay (Brown)	B	STD		Positive ster with S.088
S.089	Plank (ulky chimney) (white)	B	STD		
S.090	Plank - roof (white)	B	STD		

**SAMPLE TYPE CODES**

BC - Bio-Cassette  
 AT - Antlermen  
 SA5 - Surface Air Sampler  
 NP - Non-potable Water

CP - Contact Plate  
 ST - Spore Trap  
 B - Bulk  
 P - Potable Water

T - Tape  
 SW - Swab  
 SO - Soil  
 D - Dust

Other

RELINQUISHED BY: *David Long* DATE & TIME: 2/18/24 1700

RECEIVED BY: *[Signature]* DATE & TIME: 2/19/24 9:50

**REQUESTED SER**

Non-Culturable	Culturable	Other Requests
Spore Trap Timp Swab, Bulk	BioCassette™ Anderson, SAS, Swab, Water, Bulk, Dust, Soil, Contact Plate	Asbestos m. Air, PCM Airborne Fiber Count (NIOSH 7400)
Spore Trap Analysis	1. Media Surface Fungi (Genus) + Asp spp Culturable Air Fungi (Genus) + Asp spp Gram Stain and Counts (Culture As and Surface Bacteria) Legionella culture Total Coliform, E. coli (Presence/Absence) Quant. Sewage Screen OTR (please specify test)	Asbestos Bulk - PLM Lead (Pb) - Panna AA PCR (please specify test) Ategens (please specify test)

By submitting this Chain of Custody, you agree to be bound by the terms and conditions set forth at: <https://www.eurofinsus.com/online-environment-testing/built-environment/surveys/sampling-guides-and-forms>

©COPYRIGHT 2022 EUROFINS EPK BUILT ENVIRONMENT TESTING, LLC



003542582

Page 7 of 8

# CHAIN OF CUSTODY eurofins

www.eurofinsus.com/Built

Built Environment Testing

East: (886) 871-1984  
Central: (800) 551-4802  
West: (886) 889-6683

WEATHER		Temp	Hum	Snow	Wind (Dir/Spd)
None					
Light					
Moderate					
Heavy					
LEVEL					

**CONTACT INFORMATION**

Company: ECS, INC. Address: PO BOX 356, Sherman, MS 38869

Contact: Kirk Shelton (Special Instructions)

Phone: (662) 840-5945 / (662) 397-6555 | kshelton@envirocomp.net

**PROJECT INFORMATION**

Headwaters 20240214

Asbestos Inspection - 5000 Sq. Ft. Structure

Sampling Date/Time: 2/14/24 9:45-10:00

Sampled By: David Kohler

SAMPLE ID	DESCRIPTION	Sample Type (Below)	TAT (Above)	Total Volume/Area (as applicable)	NOTES (Time of day, Temp, RH, etc.)	TURN AROUND TIME CODES - (TAT)			
						STD - Standard (Default)	ND - Next Business Day	SD - Same Business Day	WH - Weekend/holiday/ASAP
S.091	Built-up ROOF (R/pack)	B	STD						
S.092	Built-up ROOF (B/pack)	B	STD						
S.093	Gully Board (Wood/White/Gray)	B	STD						
S.094	Gully Board (Wood/White/Gray)	B	STD						
S.095	Wall Paper (Gold)	B	STD						
S.096	Wall Paper (Gold)	B	STD		Positive Step with S.095				
S.097	Wall Board (White/Gray)	B	STD						
S.098	Wall Board (White/Gray)	B	STD		Positive Step with S.097				
S.099	Roofing Underlayment (Brown)	B	STD						
S.100	Roofing Underlayment (Brown)	B	STD						
S.101	Window Casework (Gray)	B	STD						
S.102	Window Casework (Gray)	B	STD						
S.103	Window Casework (Gray)	B	STD		Positive Step with S.101				
S.104	Window Casework (Gray)	B	STD						
S.105	Window Casework (Gray)	B	STD		Positive Step with S.104				

**SAMPLE TYPE CODES**

GP - Contact Plate | Y - Tape | O - Other

ST - Spore Trap | SW - Swab

SAS - Surface Air Sampler | B - Bulk | SO - Soil

NP - Non-potable Water | P - Potable Water | D - Dual

RELINQUISHED BY: David Kohler DATE & TIME: 2/15/24 12:00

RECEIVED BY: [Signature] DATE & TIME: 2/16/24 9:50

Non-Culturable		Culturable		Other Requests
Spore Trap	Tape Swab, Bulk	Bioassay	Andersen, SAS	
Spore Trap Analysis				Asbestos in Air - PCM Airborne Count (NIOSH 7400)
Other biological particles - superficial				Adhesives BUA - PLM
Direct Microscopic Exam (Qualitative)				PCR (please specify test)
Quantitative spore count (Breadboard)				Lead (Pb) - Flame AA
Dust Characterization				Asbestos BUA - PLM
1 Media Surface Fungus (Genus) - Asp spp.				Adhesives in Air - PCM Airborne Count (NIOSH 7400)
Culture Air Fungus (Genus) - Asp spp.				PCR (please specify test)
Genus Stem and Counts (Culture Air and Surface Fungal)				Adhesives BUA - PLM
Legionella culture				Adhesives BUA - PLM
Total Coliforms (Presence/Absence)				Adhesives BUA - PLM
Coliformy-Sewage Screen				Adhesives BUA - PLM
OTHER (please specify test)				Adhesives BUA - PLM

By submitting this Chain of Custody, you agree to be bound by the terms and conditions set forth at <https://www.eurofinsus.com/environment-testing/built-environment/resources/sampling-guides-and-forms>

©COPYRIGHT 2022 EUROFINS EPK BUILT ENVIRONMENT TESTING, LLC



003542582

Page 9 of 8

# CHAIN OF CUSTODY eurofins

www.eurofins.com/Built

Built Environment Testing

East: (866) 871-1984  
Central: (800) 851-4802  
West: (866) 888-6653

WEATHER		Fog	Rain	Snow	Wind	Clear
LEVEL		None				
		Light				
		Moderate				
		Heavy				

### REQUESTED SI

Non-Culturable		Culturable		Other Requests
Spore Trap	Tapir Swab Disk	BioCassette™ Andersen, SAS	OTHER (Please specify test)	
Quantitative Spore Count (Qualitative)	Quantitative Spore Count (Medium)	Legionella culture	Total Coliform E test (Presence/Sense)	Asbestos in Air PCM Airborne Count (NIOSH 7400)
Direct Microscopic Exam (Qualitative)	Duct Characterization	Gram Stain and Counts (Culture Air and Surface Bacteria)	Curable Air Fungi (Genus) + Asp spp	Lead (Pb) - Firm As
Spore Trap Analysis	Duct Characterization	1-Media Surface Fungi (Genus) + Asp spp	Asbestos Bulk + PLM	PCB (Please specify test)
				Allergens (Please specify test)

RECEIVED BY	DATE & TIME
<i>W</i>	2/16/24 9:50

### CONTACT INFORMATION

**Company:** ECS, INC.  
**Contact:** Kirk Shelton  
**Phone:** (662) 840-5945 / (662) 397-6555  
**Address:** PO BOX 356, Sherman, MS 38869  
**Special Instructions:** kshelton@envirocomp.net

### PROJECT INFORMATION

**Project ID:** Headwaters\_20240214  
**Project Description:** Asbestos Inspection - 5000 Sq. Ft. Structure  
**Project Zip Code:** 39158  
**Sampling Date/Time:** 2/15/24 5:00-5:00  
**By:** David Longenecker  
**TURN AROUND TIME CODES - (TAT)**  
 STD - Standard (Default)  
 ND - Next Business Day  
 SD - Same Business Day  
 WH - Weekend/holiday/ASAP  
 Rushes received after 2pm or on weekends, will be considered received the next business day. Please alert us in advance of weekend analysis needs.

SAMPLE ID	DESCRIPTION	Sample Type (Below)	TAT (Above)	Total Volume/Area (as applicable)	NOTES (Time of day, Temp, RH, etc.)
S.106	Window Caulking (Grey)	B	STD		Positive for mold S.106
S.107	Window Caulking (Grey)	B	STD		
S.108	Window Caulking (Grey)	B	STD		
S.109	Wall Paper (Green/White)	B	STD		Positive for mold S.109
S.110	Wall Paper (Green/White)	B	STD		
S.111	Wall Board Ceiling (Grey)	B	STD		
S.112	Wall Board Ceiling (Grey)	B	STD		Positive for mold S.111
		B	STD		
		B	STD		
		B	STD		
		B	STD		
		B	STD		
		B	STD		

SAMPLE TYPE CODES				RELINQUISHED BY	DATE & TIME
BC - BioCassette™	CP - Contact Plate	T - Tape	O - Other	<i>David Pope</i>	2/15/24 1700
AIS - Andersen	ST - Spore Trap	SW - Swab			
SAS - Surface Air Sampler	B - Bulk	SO - Soil			
NP - Non-potable Water	P - Potable Water	D - Dust			

By submitting this Chain of Custody, you agree to be bound by the terms and conditions set forth at <https://www.eurofins.com/environment-testing/built-environment/resources/sampling-guides-and-forms>

## **ATTACHMENT 2**

INSPECTION PHOTOS





Picture 1. Sample S.003 in Bedroom #3 wall board (2% Chrysotile).



Picture 2. Sample S.007 in Bathroom #3 wall board (2% Chrysotile).



Picture 3. Sample S.015 in Bedroom #3 closet wall board (2% Chrysotile).

Picture Not Available



Picture 5. Sample S.025 in Bedroom #2 Closet wall board (2% Chrysotile).



Picture 6. Sample 031 in Bathroom 1/2 (tub/shower) wall board (2% Chrysotile).



Picture 7. Sample S.033 in Bathroom 1/2 (tub/shower) ceiling board (2% Chrysotile).



Picture 8. Sample S.044 in Bedroom #1 wall board (2% Chrysotile).



Picture 9. Sample S.049 Bedroom #1 Closet #1 wall board (2% Chrysotile).



Picture 10. Sample S.055 in Bedroom #1 Closet #2 wall board (2% Chrysotile).



Picture 11. Sample S.058 in Bedroom #1 Closet #2 ceiling board (2% Chrysotile).



Picture 12. Sample S.061 in the hallway to bedrooms ceiling board (2% Chrysotile).



Picture 13. Sample S.063 in the hallway to bedrooms closet wall board (2% Chrysotile).



Picture 14. Sample S.082 in Living Room #1 wall board (2% Chrysotile).



Picture 15. Sample S.085 stairs to safe room wall board (2% Chrysotile).



Picture 16. Sample S.089 flashing/caulking on chimney on roof (2% Chrysotile).



Picture 17. Sample S.097 in Bathroom #4 wall board (2% Chrysotile).



Picture 18. Sample S.111 Bathroom #5 wall board (2% Chrysotile).

## **ATTACHMENT 3**

FACILITY DIAGRAM AND MATERIALS ESTIMATE

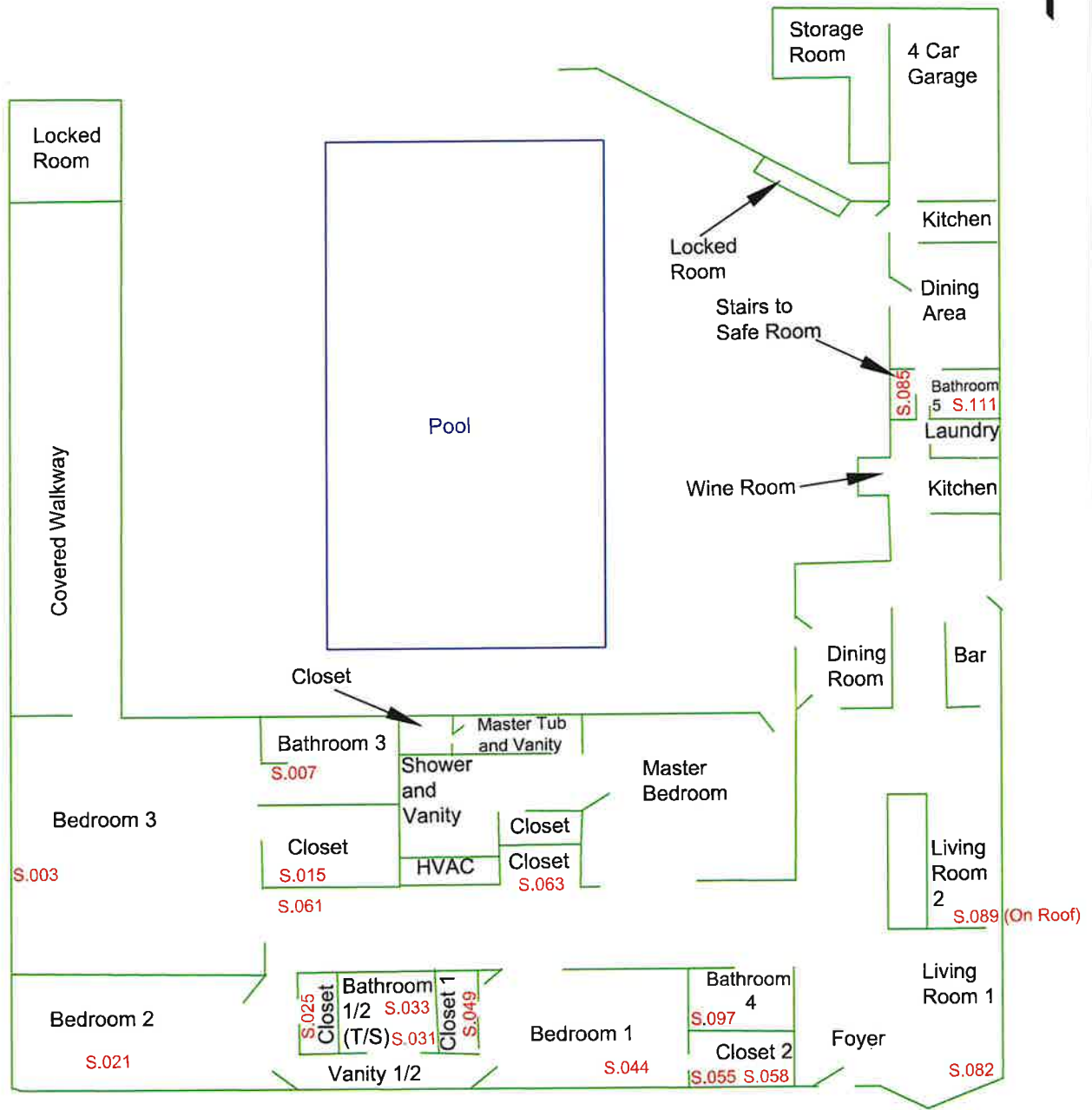

Environmental Compliance & Safety, Inc.  
 P.O. Box 356  
 Sherman, MS 38869  
 (662) 840-5945

Madison County Property  
 Ridgeland, MS

Facility Diagram

Figure 1

Legend:  
 Sample ID S.001

Scale: NTS

Drawn By: JAD

Date: 2/27/2024

**Material Estimates  
Abandoned Home  
1204 West County Line Road**

<b>Location</b>	<b>Material</b>	<b>Area (sq. ft)</b>
Bedroom 3	Mastic (floor)	259.0
	Sheetrock (walls)	639.1
	Sheetrock (ceiling)	259.0
Bedroom 3 Closet	Mastic (floor)	41.3
	Sheetrock (walls)	212.3
	Sheetrock (ceiling)	41.3
Bathroom 3	Sheetrock (walls)	249.1
	Sheetrock (ceiling)	57.8
Bedroom 2	Mastic (floor)	270.0
	Sheetrock (walls)	649.0
	Sheetrock (ceiling)	270.0
Bedroom 2 Closet	Mastic (floor)	19.5
	<sup>1</sup> Sheetrock (walls)	134.5
	Sheetrock (ceiling)	19.5
Bathroom 1 / 2	Mastic (floor)	74.4
	Sheetrock (walls)	268.0
	Sheetrock (ceiling)	144.1
Bedroom 1	Mastic (floor)	237.5
	Sheetrock (walls)	616.7
	Sheetrock (ceiling)	237.5
Bedroom 1 Closet 1	Mastic (floor)	19.5
	<sup>1</sup> Sheetrock (walls)	135.4
	Sheetrock (ceiling)	19.5
Bedroom 1 Closet 2	Mastic (floor)	33.3
	Sheetrock (walls)	235.0
	Sheetrock (ceiling)	33.3
Hallway	Sheetrock (walls)	544.0
	Sheetrock (ceiling)	170.0

<b>Location</b>	<b>Material</b>	<b>Area (sq. ft)</b>
Hallway Closet	Sheetrock (walls)	92.1
	Sheetrock (ceiling)	7.2
Master Bedroom	Sheetrock (walls)	803.0
	Sheetrock (ceiling)	407.3
Master Bedroom Hallway	<sup>2</sup> Sheetrock (walls)	80.0
	Sheetrock (ceiling)	23.5
Master Bedroom Closet	Sheetrock (walls)	208.0
	Sheetrock (ceiling)	42.0
Master Bedroom Bath 1	Sheetrock (walls)	276.0
	Sheetrock (ceiling)	70.2
Master Bedroom Bath 2	Has already has been stripped	
Bathroom 4	Sheetrock (walls)	195.9
	Sheetrock (ceiling)	34.6
Foyer	<sup>3</sup> Sheetrock (walls)	460.0
	Sheetrock (ceiling)	416.0
Living Room 1	Sheetrock (walls)	820.2
	Sheetrock (ceiling)	442.0
Living Room 2	Sheetrock (walls)	625.5
	Sheetrock (ceiling)	505.7
Living Room 2 Closet	Sheetrock (walls)	141.0
	Sheetrock (ceiling)	14.0
Bar/Breakfast Nook	<sup>4</sup> Sheetrock (walls)	251.3
	Sheetrock (ceiling)	165.0
Dining Room	Sheetrock (walls)	539.7
	Sheetrock (ceiling)	357.0
Hallway	<sup>5</sup> Sheetrock (walls)	288.0
	Sheetrock (ceiling)	96.0
Laundry Room	Sheetrock (walls)	421.0
	Sheetrock (ceiling)	88.2
Hallway Closet	Sheetrock (walls)	130.7
	Sheetrock (ceiling)	12.3

<b>Location</b>	<b>Material</b>	<b>Area (sq. ft)</b>
Area outside Pool Bathroom	Sheetrock (walls)	252.0
	Sheetrock (ceiling)	48.0
Changing Room for Pool Bathroom	Sheetrock (walls)	225.0
	Sheetrock (ceiling)	39.0
Bathroom off Pool	Sheetrock (walls)	208.0
	Sheetrock (ceiling)	48.0
Pool Dining Area	All brick/wood	N/A
Stairway Down to Safe Room	Sheetrock (walls)	224.0
	Sheetrock (ceiling)	56.0
Area at bottom of stairs	Sheetrock (walls)	140.0
	Sheetrock (ceiling)	100.0
Garage	Concrete and brick	N/A
Storage Room in Garage	Concrete and brick	N/A
<b>Totals</b>	<b>Mastic</b>	<b>954.5</b>
	<b>Sheetrock (walls)</b>	<b>10,064.5</b>
	<b>Sheetrock (ceiling)</b>	<b>4,224.0</b>

<sup>1</sup> Very little sheetrock on one wall since it has 3 sliding doors. Assumed 1/3 of total for one side.

<sup>2</sup> Master bedroom hallway has 4 doors, so estimated amount adjusted accordingly.

<sup>3</sup> Foyer really only has one solid wall so used total of that wall and then 1/2 of the other wall for estimate.

<sup>4</sup> Bar/breakfast nook has openings so assumed one wall for each.

<sup>5</sup> Hallway had open ends so used one wall and then 1/2 of the other wall to account for all the doors.



**ATTACHMENT 4**

ASBESTOS INSPECTOR CERTIFICATION

# *State of Mississippi*

*Department of Environmental Quality  
Office of Pollution Control*

## *Certificate of Licensure*

In accordance with the Asbestos Abatement Accreditation and Certification Act,  
Enacted as 1989 Mississippi Law, Chapter 505

Be it known that

*David Loague*

Having submitted acceptable evidence of qualifications and  
training and other appropriate information, is hereby granted this

*Asbestos Inspector  
Certification*



*Certificate No.: ABI-00001796  
Expiration Date: Jun 7th, 2024  
Training Expires on Jun 7th, 2024*

*Chief, Asbestos & Lead Branch*

43685 LIC20230001

# CERTIFICATE OF COMPLETION

Center for Continuing Education

## David Loague

XXX-XX-9429

has attended and satisfactorily completed course exam with a passing score of 70% or better  
Asbestos Inspection & Assessment Refresher

Accreditation



**MISSISSIPPI STATE**  
UNIVERSITY™

**EXTENSION**

ASBR-04-060723-02

CERTIFICATE NUMBER

06/07/24

EXAMINATION DATE

Matt Thomas

COURSE INSTRUCTOR

06/07/23

EXAMINATION DATE

Richard Swann

PROGRAM DIRECTOR

06/07/23

COURSE DATE(S)



MSDE Accredited Training Provider

P.O. Box 5141 ■ Mississippi State, MS 39762-5247 ■ 662.325.5002 ■ FAX 662.325.2702

#1103