

Brad White
Executive Director
Jeff Ely, P.E.
Chief of Staff



Earl Glenn, Jr., P.E.
Deputy Executive Director/Chief Engineer
Lisa M. Hancock, CPA
Deputy Executive Director/Administration

August 1, 2025

Ms. Carrie Barefoot
Construction and Building Materials
Environmental Permits Division
Office of Pollution Control
Mississippi Department of Environmental Quality
P. O. Box 2261
Jackson, Mississippi 39225

Dear Ms. Barefoot:

Re: LCNOI Submittal Under MSR10

This LCNOI application is for the MDOT Project No. STP-0022-01(089) FMS 108392/301000 on SR 15 in Harrison County approximately 1.5 miles north of Cedar Hammock Road. This is a bridge removal and replacement project for MDOT use. All necessary information is enclosed in this application.

Under ACT5, T-5 (A) of the new General Permit it is required that a buffer zone shall be maintained between land disturbing activities and perennial water bodies. A minimum of 150-foot buffer zone is recommended. Your office defines a buffer zone under ACT12, T-2 as a strip of dense undisturbed perennial vegetation, either original or reestablished, that borders perennial streams and rivers, ponds and lakes and wetlands. ACT12, T-17 defines infeasible as being not technologically possible, or not economically practicable and achievable. This BMP of a minimum 150-foot buffer zone recommended for perennial water bodies in the Large Construction General Permit is not feasible for MDOT projects. Due to the nature of these linear construction projects which require bridges, box bridges, box culverts and pipe culverts, it would not be practical or cost-effective to adhere to this requirement.

If a 150-foot buffer area is not feasible then ACT5 T-3(6) requires a 50-foot undisturbed natural buffer around waters of the United States; or provide and maintain an undisturbed natural buffer that is less than 50 feet and supplemented by additional erosion and sediment controls which in combination achieves the sediment load reduction equivalent to a 50-foot undisturbed natural buffer. Riparian Buffer zones will not be needed since this is for lot grading and construction. The subject bridge will be removed and subsequently replaced with a Double 16X8 box culvert. All embankments will be restored using flowable fill and riprap for scour protection. Cypress Branch is not listed as impaired but does drain into the Tchoutacabouffa River which has a Pathogens TMDL.

Concerning roadway erosion control the following items will be used: geotextile fabric stabilization, crushed stone base, topsoil for slope treatment, vegetative mulch, solid sodding, grassing (10 Acres), agricultural limestone, temporary grassing, temporary silt fence, temporary erosion checks, 20" wattles, temporary slope drains, silt dike, sandbags, and temporary stream diversion. The site specific SWPPP that will be submitted by the contractor for approval will have all of this information. We believe these BMPs will suffice for adequate control of soil erosion leaving the worksite.

If you have questions, please feel free to give me a call at (601)359-7275. This project is scheduled to be advertised in August, 2025, and let in September, 2025. We ask that you expedite your review and approval so that these dates can be met. Thank you for your assistance in this matter.

Sincerely,

John C. Taylor, PE, BCEE, RPG
MDOT, Roadway Design Division

AI: 89375

MSR109622



Rec'd via email:
07/31/2025

MISSISSIPPI DEPARTMENT OF
ENVIRONMENTAL QUALITY

LARGE CONSTRUCTION NOTICE OF INTENT (LCNOI) FOR COVERAGE UNDER THE LARGE CONSTRUCTION STORM WATER GENERAL NPDES PERMIT

INSTRUCTIONS

The Large Construction Notice of Intent (LCNOI) is for coverage under the Large Construction General Permit for land disturbing activities of five (5) acres or greater; or for land disturbing activities, which are part of a larger common plan of development or sale that are initially less than five (5) acres but will ultimately disturb five (5) or more acres. Applicant must be the owner or operator. For construction activities, the operator is typically the prime contractor. The owner(s) of the property and the prime contractor associated with regulated construction activity on the property have joint and severable responsibility for compliance with the Large Construction Storm Water General Permit MSR10.

If the company seeking coverage is a corporation, a limited liability company, a partnership, or a business trust, attach proof of its registration with the Mississippi Secretary of State and/or its Certificate of Good Standing. This registration or Certificate of Good Standing must be dated within twelve (12) months of the date of the submittal of this coverage form. Coverage will be issued in the company name as it is registered with the Mississippi Secretary of State.

Completed LCNOIs should be filed at least thirty (30) days prior to the commencement of construction. Discharge of storm water from large construction activities without written notification of coverage is a violation of state law.

Submittals with this LCNOI must include:

- A site-specific Storm Water Pollution Prevention Plan (SWPPP) developed in accordance with ACT5 of the General Permit
- A detailed site-specific scaled drawing showing the property layout and the features outlined in ACT5 of the General Permit
- A United States Geological Survey (USGS) quadrangle map or photocopy, extending at least one-half mile beyond the facility property boundaries with the site location and outfalls outlined or highlighted. The name of the quadrangle map must be shown on all copies. Quadrangle maps can be obtained from the MDEQ, Office of Geology at 601-961-5523.

Additional submittals may include the following, if applicable:

- Appropriate Section 404 documentation from U.S. Army Corps of Engineers
- Appropriate documentation concerning future disposal of sanitary sewage and sewage collection system construction
- Appropriate documentation from the MDEQ Office of Land & Water concerning dam construction and low flow requirements
- Approval from County Utility Authority in Hancock, Harrison, Jackson, Pearl River and Stone Counties
- Antidegradation report for disturbance within Waters of the State

ALL QUESTIONS MUST BE ANSWERED (Answer "NA" if the question is not applicable)

OC

APPLICANT IS THE: ☐ OWNER ☐ PRIME CONTRACTOR

OWNER CONTACT INFORMATION

OWNER CONTACT PERSON: _____

OWNER COMPANY LEGAL NAME: _____

OWNER STREET OR P.O. BOX: _____

OWNER CITY: _____ STATE: _____ ZIP: _____

OWNER PHONE #: (____) _____ OWNER EMAIL: _____

PREPARER CONTACT INFORMATION

IF NOI WAS PREPARED BY SOMEONE OTHER THAN THE APPLICANT

CONTACT PERSON: _____

COMPANY LEGAL NAME: _____

STREET OR P.O. BOX: _____

CITY: _____ STATE: _____ ZIP: _____

PHONE # (____) _____ EMAIL: _____

PRIME CONTRACTOR CONTACT INFORMATION

PRIME CONTRACTOR CONTACT PERSON: _____

PRIME CONTRACTOR COMPANY LEGAL NAME: _____

PRIME CONTRACTOR STREET OR P.O. BOX: _____

PRIME CONTRACTOR CITY: _____ STATE: _____ ZIP: _____

PRIME CONTRACTOR PHONE #: (____) _____ PRIME CONTRACTOR EMAIL: _____

FACILITY SITE INFORMATION

FACILITY SITE NAME: _____

FACILITY SITE ADDRESS (If the physical address is not available, please indicate the nearest named road. For linear projects indicate the beginning of the project and identify all counties the project traverses.)

STREET: _____

CITY: _____ STATE: _____ COUNTY: _____ ZIP: _____

FACILITY SITE TRIBAL LAND ID (N/A If not applicable): _____

LATITUDE: ____ degrees ____ minutes ____ seconds LONGITUDE: ____ degrees ____ minutes ____ seconds

LAT & LONG DATA SOURCE (GPS (Please GPS Project Entrance/Start Point) or Map Interpolation): _____

TOTAL ACREAGE THAT WILL BE DISTURBED ¹: _____

IS THIS PART OF A LARGER COMMON PLAN OF DEVELOPMENT?	YES <input type="checkbox"/>	NO <input type="checkbox"/>
IF YES, NAME OF LARGER COMMON PLAN OF DEVELOPMENT: _____		
AND PERMIT COVERAGE NUMBER: MSR10_____		
ESTIMATED CONSTRUCTION PROJECT START DATE:	____-____-____	
ESTIMATED CONSTRUCTION PROJECT END DATE:	____-____-____	
DESCRIPTION OF CONSTRUCTION ACTIVITY: _____		
PROPOSED DESCRIPTION OF PROPERTY USE AFTER CONSTRUCTION HAS BEEN COMPLETED: _____		

SIC Code: ____-____-____	NAICS Code _____
---------------------------------	-------------------------

NEAREST NAMED RECEIVING STREAM: _____		
IS RECEIVING STREAM ON MISSISSIPPI'S 303(d) LIST OF IMPAIRED WATER BODIES? (The 303(d) list of impaired waters and TMDL stream segments may be found on MDEQ's web site: http://www.deq.state.ms.us/MDEQ.nsf/page/TWB_Total_Maximum_Daily_Load_Section)	YES <input type="checkbox"/>	NO <input type="checkbox"/>
HAS A TMDL BEEN ESTABLISHED FOR THE RECEIVING STREAM SEGMENT?	YES <input type="checkbox"/>	NO <input type="checkbox"/>
FOR WHICH POLLUTANT: Pathogens TMDL 3.41EX12 Counts/30 days		
ARE THERE RECREATIONAL STREAMS, PRIVATE/PUBLIC PONDS OR LAKES WITHIN ½ MILE DOWNSTREAM OF PROJECT BOUNDARY THAT MAY BE IMPACTED BY THE CONSTRUCTION ACTIVITY?	YES <input type="checkbox"/>	NO <input type="checkbox"/>
EXISTING DATA DESCRIBING THE SOIL (for linear projects please describe in SWPPP): _____		
WILL FLOCCULANTS BE USED TO TREAT TURBIDITY IN STORM WATER?	YES <input type="checkbox"/>	NO <input type="checkbox"/>
IF YES, INDICATE THE TYPE OF FLOCCULANT.	<input type="checkbox"/> ANIONIC POLYACRYLAMIDE (PAM) <input type="checkbox"/> OTHER _____	
IF YES, DOES THE SWPPP DESCRIBE THE METHOD OF INTRODUCTION, THE LOCATION OF INTRODUCTION AND THE LOCATION OF WHERE FLOCCULATED MATERIAL WILL SETTLE?		
IS A SDS SHEET INCLUDED FOR THE FLOCCULATE?	YES <input type="checkbox"/>	NO <input type="checkbox"/>
WILL THERE BE A 50 FT BUFFER BETWEEN THE PROJECT DISTURBANCE AND THE WATERS OF THE STATE?	YES <input type="checkbox"/>	NO <input type="checkbox"/>
IF NOT, PROVIDE EQUIVALENT CONTROL MEASURES IN THE SWPPP.		

¹ Acreage for subdivision development includes areas disturbed by construction of roads, utilities and drainage. Additionally, a housesite of at least 10,000 ft² per lot (entire lot, if smaller) shall be included in calculating acreage disturbed.

DOCUMENTATION OF COMPLIANCE WITH OTHER REGULATIONS/REQUIREMENTS
COVERAGE UNDER THIS PERMIT WILL NOT BE GRANTED UNTIL ALL OTHER REQUIRED
MDEQ PERMITS AND APPROVALS ARE SATISFACTORILY ADDRESSED

IS LCNOI FOR A FACILITY THAT WILL REQUIRE OTHER PERMITS?

YES ☐ NO ☐

IF YES, CHECK ALL THAT APPLY: ☐ AIR ☐ HAZARDOUS WASTE ☐ PRETREATMENT

☐ WATER STATE OPERATING ☐ INDIVIDUAL NPDES ☐ OTHER: _____

IS THE PROJECT REROUTING, FILLING OR CROSSING A WATER CONVEYANCE OF ANY KIND? (If yes, contact the U.S. Army Corps of Engineers' Regulatory Branch for permitting requirements.) YES ☐ NO ☐

IF THE PROJECT REQUIRES A CORPS OF ENGINEER SECTION 404 PERMIT, PROVIDE APPROPRIATE DOCUMENTATION THAT:

- The project has been approved by individual permit, or
- The work will be covered by a nationwide permit and NO NOTIFICATION to the Corps is required, or
- The work will be covered by a nationwide or general permit and NOTIFICATION to the Corps is required

IS THE PROJECT REROUTING, FILLING OR CROSSING A STATE WATER CONVEYANCE OF ANY KIND? (If yes, please provide an antidegradation report.) YES ☐ NO ☐

IS A LAKE REQUIRING THE CONSTRUCTION OF A DAM BEING PROPOSED? (If yes, provide appropriate approval documentation from MDEQ Office of Land and Water, Dam Safety.) YES ☐ NO ☐

IF THE PROJECT IS A SUBDIVISION OR A COMMERCIAL DEVELOPMENT, HOW WILL SANITARY SEWAGE BE DISPOSED? Check one of the following and attach the pertinent documents.

- ☐ Existing Municipal or Commercial System. Please attach plans and specifications for the collection system and the associated "Information Regarding Proposed Wastewater Projects" form or approval from County Utility Authority in Hancock, Harrison, Jackson, Pearl River and Stone Counties. If the plans and specifications can not be provided at the time of LCNOI submittal, MDEQ will accept written acknowledgement from official(s) responsible for wastewater collection and treatment that the flows generated from the proposed project can and will be transported and treated properly. The letter must include the estimated flow.
- ☐ Collection and Treatment System will be Constructed. Please attach a copy of the cover of the NPDES discharge permit from MDEQ or indicate the date the application was submitted to MDEQ (Date: _____.)
- ☐ Individual Onsite Wastewater Disposal Systems for Subdivisions Less than 35 Lots. Please attach a copy of the Letter of General Acceptance from the Mississippi State Department of Health or certification from a registered professional engineer that the platted lots should support individual onsite wastewater disposal systems.
- ☐ Individual Onsite Wastewater Disposal Systems for Subdivisions Greater than 35 Lots. A determination of the feasibility of installing a central sewage collection and treatment system must be made by MDEQ. A copy of the response from MDEQ concerning the feasibility study must be attached. If a central collection and wastewater system is not feasible, then please attach a copy of the Letter of General Acceptance from the State Department of Health or certification from a registered professional engineer that the platted lots should support individual onsite wastewater disposal systems.

INDICATE ANY LOCAL STORM WATER ORDINANCE (I.E. MS4) WITH WHICH THE PROJECT MUST COMPLY:

I certify under penalty of law that this document and all attachments were prepared under my direction or supervision in accordance with a system designed to assure that qualified personnel properly gathered and evaluated the information submitted. Based on my inquiry of the person or persons who manage the system, or those persons directly responsible for gathering the information, the information submitted is, to the best of my knowledge and belief, true, accurate and complete. I am aware that there are significant penalties for submitting false information, including the possibility of fine and imprisonment for knowing violations.

Signature of Applicant¹ (owner or prime contractor)

Date Signed

Printed Name¹

Title

¹This application shall be signed as follows:

- For a corporation, by a responsible corporate officer.
- For a partnership, by a general partner.
- For a sole proprietorship, by the proprietor.

For a municipal, state or other public facility, by principal executive officer, mayor, or ranking elected official

Please submit the LCNOI form to:

Chief, Environmental Permits Division
MS Department of Environmental Quality, Office of Pollution Control
P.O. Box 2261
Jackson, Mississippi 39225

Electronically:

<https://www.mdeq.ms.gov/construction-stormwater/>

Revised 3/23/22

Location Map

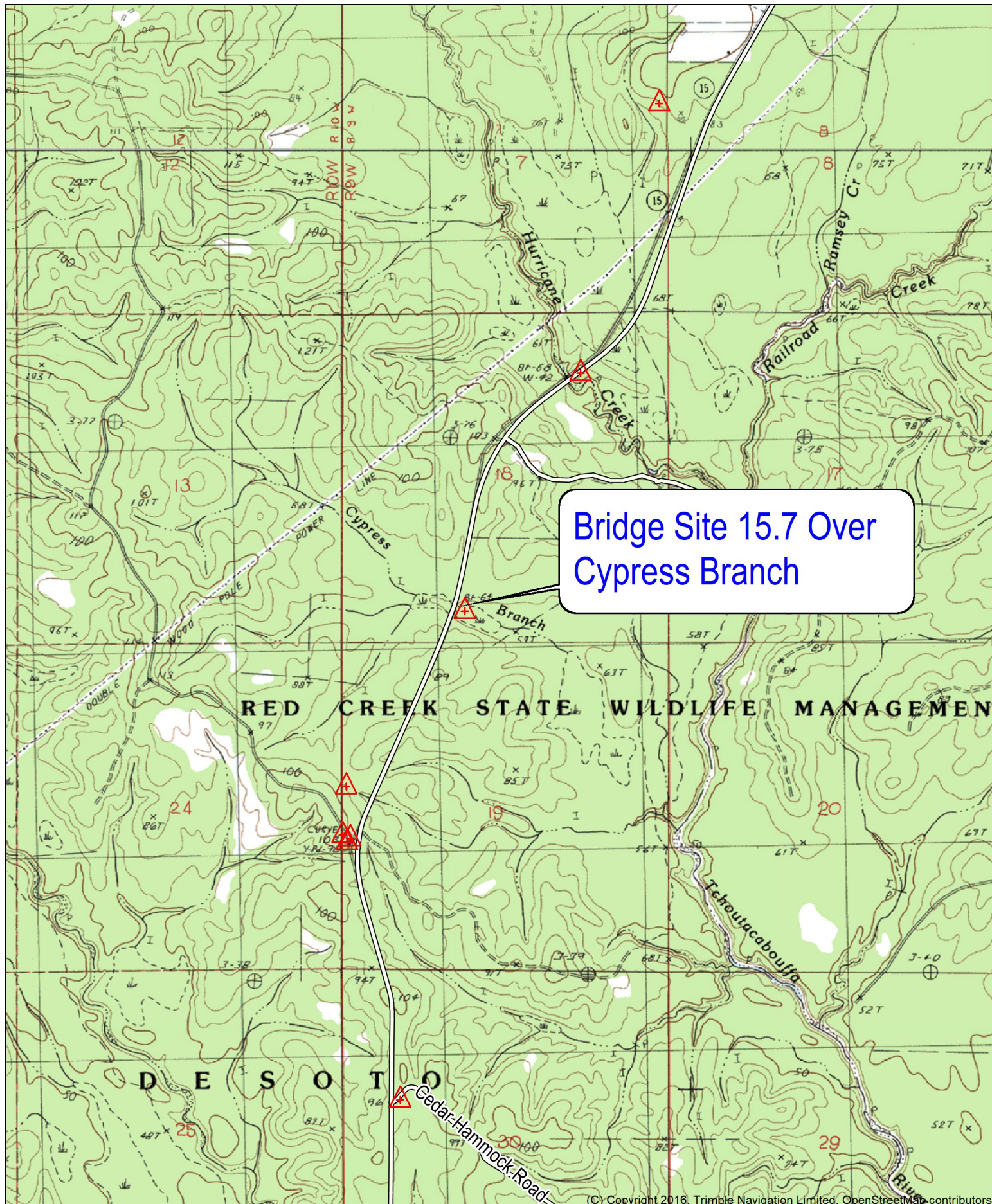

Bridge Site 15.7 Over
Cypress Branch

Name: WHITE PLAINS
Date: 01/29/24
Scale: 1 inch = 2,000 ft.

Location: 030° 36' 17.1029" N, 088° 55' 35.4794" W
Harrison County, Ms Bridge Replacement Along SR 15 Over Cypress
Creek
FAC 100000/001000

CORPS Nationwide 23 Coverage



Inter-Departmental Memorandum

Date: June 30, 2025

To: Mr. Billy Owen
District 6 Engineer

From: Environmental Division Director *ABJ*
Adam Johnson

Subject: Project Number: STP-0022-01(089); 108392-301000
SR 15 over Cypress Creek (#15.7)
Harrison County

Corps ID Number: SAM-2025-453

Please see enclosed copy of the Corps of Engineers Nationwide 23 permit authorization for the subject project. Please note that the Environmental Division will handle mitigation through the Corps of Engineers and that the Construction Division is to handle the Certification of Compliance upon completion of the project. The permit authorization expires March 14, 2026.

If you have any questions or require additional information, please contact Andrea Wodtke at (601) 359-7922.

ABJ:ARW:tbs

Attachment

pc: Construction Division (Attn: Michael Hogan - with attachments)



DEPARTMENT OF THE ARMY
U.S. ARMY CORPS OF ENGINEERS, VICKSBURG DISTRICT
4155 CLAY STREET
VICKSBURG, MISSISSIPPI 39183-3435

June 27, 2025

SUBJECT: Department of the Army Regulatory Requirements for the Proposed Harrison 15 (108392-301) Bridge Replacement Located in Section 18, T5S-R9W Harrison County, Mississippi

Mr. Adam Johnson
Environmental Division Director
Mississippi Department of Transportation
PO Box 1850
Jackson, MS 39215-1850

Dear Mr. Johnson:

Based upon the information furnished (enclosure 1), it appears that Department of the Army permit requirements for the proposed work, will be authorized by Nationwide Permit No. 23, as specified in the December 27, 2021, *Federal Register*, Reissuance and Modification of Nationwide Permits; Final Rule; Notice (86 FR 73522), provided the activity complies with the Special Conditions (enclosure 2), the General Conditions (enclosure 3), and the conditions of the Clean Water Act Section 401 Water Quality Certification (enclosure 4). It is your responsibility to read and become familiar with the enclosed conditions in order for you to ensure that the activity authorized herein complies with the Nationwide Permit.

This verification is valid until March 14, 2026, unless the Nationwide Permit is modified, suspended, or revoked. Activities which are under construction, or that are under contract to commence, in reliance upon a Nationwide Permit will remain authorized provided the activity is completed within 12 months of the date of any subsequent modification, expiration, or revocation of the Nationwide Permit. Upon completion of the activity authorized by this Nationwide Permit, please fill out the enclosed certification of compliance (enclosure 5) and return it to our office.

Our office is concurring with the aquatic resources identified within the wetland delineation provided with this application, however, we are not addressing geographic jurisdiction associated with the regulated activity.

This verification of Department of the Army regulatory requirements does not convey any property rights, either in real estate or material or any exclusive privileges and does not authorize any injury to property or invasion of rights or local laws or regulations or obviate the requirement to obtain State or local assent required by law for the activity discussed herein.

Thank you for advising us of your plans. If you change your plans for the proposed work, or if the proposed work does not comply with the conditions of the Nationwide Permit, please contact Mr. Jared Everitt, telephone (601) 631-7104, or email address: Jared.H.Everitt@usace.army.mil. In any future correspondence concerning this project, please refer to Identification No. SAM-2025-453.

Sincerely,

Bryan
Williamson

Digitally signed by Bryan
Williamson
Date: 2025.06.26
10:11:33 -05'00'

Bryan Williamson
Chief, Mississippi Branch/Deputy
Regulatory Division

Enclosures



State of Mississippi

TATE REEVES
Governor

MISSISSIPPI DEPARTMENT OF ENVIRONMENTAL QUALITY

CHRIS WELLS, EXECUTIVE DIRECTOR

October 12, 2021

Jennifer Mallard
U.S Army Corps of Engineers,
Vicksburg District
4155 Clay Street
Vicksburg, Mississippi 39183-3435

Re: US Army Corps of Engineers
Nationwide Permit No. 23
WQC No. WQC2021049

Pursuant to Section 401 of the Federal Water Pollution Control Act (33 U. S. C. 1251, 1341), the Office of Pollution Control (OPC) issues this Certification, after public notice and opportunity for public hearing, to the U.S. Army Corps of Engineers, an applicant for a Federal License or permit to conduct the following activity:

US Army COE, Nationwide Permits:

Nationwide Permits (NWP) are general permits issued on a nationwide basis to streamline the authorization of activities that have no more than minimal and cumulative adverse effects on the aquatic environment. The U.S. Army Corps of Engineers issues NWPs to authorize certain activities that require Department of the Army permits under Section 404 of the Clean Water Act and/or Section 10 of the Rivers and Harbors Act of 1899.

23. *Approved Categorical Exclusions.* Activities undertaken, assisted, authorized, regulated, funded, or financed, in whole or in part, by another Federal agency or department where:

(a) That agency or department has determined, pursuant to the Council on Environmental Quality's implementing regulations for the National Environmental Policy Act (40 CFR part 1500 et seq.), that the activity is categorically excluded from the requirement to prepare an environmental impact statement or environmental assessment analysis, because it is included within a category of actions which neither individually nor cumulatively have a significant effect on the human environment; and

(b) The Office of the Chief of Engineers (Attn: CECW-CO) has concurred with that agency's or department's determination that the activity is categorically excluded and approved the activity for authorization under NWP 23.

The Office of the Chief of Engineers may require additional conditions, including preconstruction notification, for authorization of an agency's categorical exclusions under this NWP.

Notification: Certain categorical exclusions approved for authorization under this NWP require the permittee to submit a pre-construction notification to the district engineer prior to commencing the activity (see general condition 32). The activities that require pre-construction notification are listed in the appropriate Regulatory Guidance Letter(s). (Authorities: Sections 10 and 404)

Note: The agency or department may submit an application for an activity believed to be categorically excluded to the Office of the Chief of Engineers (Attn: CECW-CO). Prior to approval for authorization under this NWP of any agency's activity, the Office of the Chief of Engineers will solicit public comment. As of the date of issuance of this NWP, agencies with approved categorical exclusions are: the Bureau of Reclamation, Federal Highway Administration, and U.S. Coast Guard. Activities approved for authorization under this NWP as of the date of this notice are found in Corps Regulatory Guidance Letter 05-07. Any future approved categorical exclusions will be announced in Regulatory Guidance Letters and posted on this same web site. [NWP No. 23, WQC2021049].

The Office of Pollution Control certifies that the above-described activity will be in compliance with the applicable provisions of Sections 301, 302, 303, 306, and 307 of the Federal Water Pollution Control Act and Section 49-17-29 of the Mississippi Code of 1972, if the applicant complies with the following conditions:

1. The permittee shall obtain appropriate wastewater permits and/or approvals for the proposed activity prior to the commencement of construction activities. (11 Miss. Admin. Code Pt. 6, R. 1.1.1.B) (Statement A)
2. For projects greater than five acres of total ground disturbances including clearing, grading, excavating, or other construction activities, the applicant shall obtain the necessary coverage under the State of Mississippi's Large Construction Storm Water General NPDES Permit. For projects greater than one, to less the five acres of total ground disturbances including clearing, grading, excavating, or other construction activities, the applicant shall follow the conditions and

limitations of the State of Mississippi's Small Construction Storm Water General NPDES Permit. No construction activities shall begin until the necessary approvals and/or permits have been obtained. (11 Miss. Admin. Code Pt. 6, R. 1.1.1.B.) (Statement A & B)

3. Turbidity outside the limits of a 750-foot mixing zone shall not exceed the ambient turbidity by more than 50 Nephelometric Turbidity Units. (11 Miss. Admin. Code Pt. 6, R. 2.2.A.) (Statement C)
4. No sewage, oil, refuse, or other pollutants shall be discharged into the watercourse. (11 Miss. Admin. Code Pt. 6, R. 2.2.A.(3)) (Statement C)

As part of the Scope of Review for Application Decisions, 11 Mississippi Administrative Code Part 6, Rule 1.3.4(B), the above conditions are necessary for the Department to ensure that appropriate measures will be taken to eliminate unreasonable degradation and irreparable harm to waters of the State, such that the activity will not meet the criteria for denial:

(A) Denial of wastewater permits and/or approvals by the State with regard to the proposed activities.

(B) Nonpoint source/storm water management practices necessary to protect water quality have not been proposed.

(C) The proposed activity permanently alters the aquatic ecosystem such that water quality criteria are violated and/or it no longer supports its existing or classified uses. An example is the channelization of streams

The Office of Pollution Control also certifies that there are no limitations under Section 302 nor standards under Sections 306 and 307 of the Federal Water Pollution Control Act which are applicable to the applicant's above-described activity.

This certification is valid for the project as proposed. Any deviations without proper modifications and/or approvals may result in a violation of the 401 Water Quality Certification. If you have any questions, please contact the Department.

Sincerely,



Krystal Rudolph, P.E., BCEE
Chief, Environmental Permits Division

KR: ld

cc: U.S. Army Corps of Engineers, Mobile District
U.S. Army Corps of Engineers, Memphis District
U.S. Army Corps of Engineers, Nashville District
U.S. Army Corps of Engineers, New Orleans District
Mississippi Department of Marine Resources
U.S. Fish and Wildlife Service
U.S. Environmental Protection Agency, Region 4

**CERTIFICATION OF COMPLIANCE
WITH DEPARTMENT OF THE ARMY PERMIT**

Nationwide Permit Number: NWP 23

Identification Number: SAM-2025-453

Name of Permittee: Mr. Adam Johnson
MDOT

Issued Date: 6/27/2025

Evaluator Name: Mr. Jared Everitt

Expiration Date: 03/14/2026

Compliance Location: Harrison County, Mississippi; Approximate
Coordinates: 30.604929, -88.928949

Upon completion of the activity authorized by this permit, sign this certification and return it to the following address:

USACE, Vicksburg District
ATTN: Regulatory Division
4155 Clay Street
Vicksburg, Mississippi 39183-3435

Please note that your permitted activity is subject to a compliance inspection by an Army Corps of Engineers representative. If you fail to comply with this permit, you are subject to permit modification, suspension, or revocation.

I hereby certify that the work authorized by the above-referenced permit has been completed in accordance with the terms and conditions of the said permit including any required mitigation.

Date Work was Completed: _____

Signature of Permittee

Date Signed

Roadway Plans

GENERAL INDEX

INCLUDED THIS PROJECT	BEGIN WITH SHEET
<input checked="" type="checkbox"/> ROADWAY.....	1
<input type="checkbox"/> PERMANENT SIGNS.....	1001
<input type="checkbox"/> TRAFFIC SIGNALS.....	2001
<input type="checkbox"/> ITS COMPONENTS.....	3001
<input type="checkbox"/> LIGHTING.....	4001
<input type="checkbox"/> (RESERVED).....	5001
<input checked="" type="checkbox"/> ROADWAY STD. DWGS.....	6001
<input checked="" type="checkbox"/> BOX CULVERT STD. DWGS (LRFD).....	7001
<input type="checkbox"/> BOX CULVERT STD. DWGS (STD. SPEC.)....	7501
<input type="checkbox"/> BRIDGE.....	8001
<input checked="" type="checkbox"/> CROSS SECTIONS.....	9001

STATE OF MISSISSIPPI
MISSISSIPPI DEPARTMENT OF TRANSPORTATION

PLAN AND PROFILE OF
PROPOSED STATE HIGHWAY
FEDERAL AID PROJECT NO. STP-0022-01(089)

S.R. 15 OVER CYPRESS BRANCH
HARRISON COUNTY

FMS CONST: 108392/301000

B.O.P STA. 540+00

BOX BRIDGES REQ'D.

BR.# 15.7 STA. 548+47.83
152.5 L.F. DBL. 16'X8'

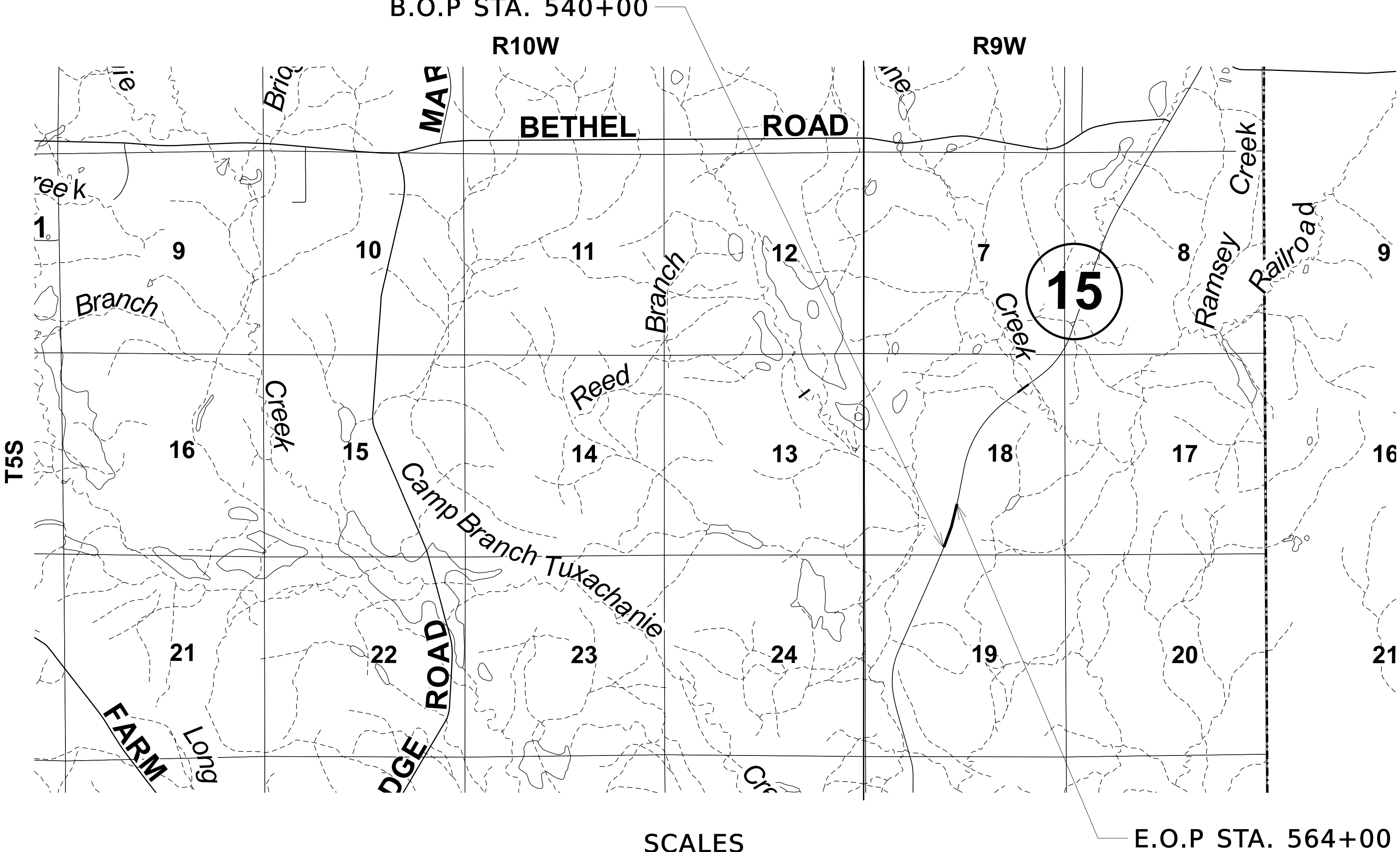

CONVENTIONAL
SYMBOLS

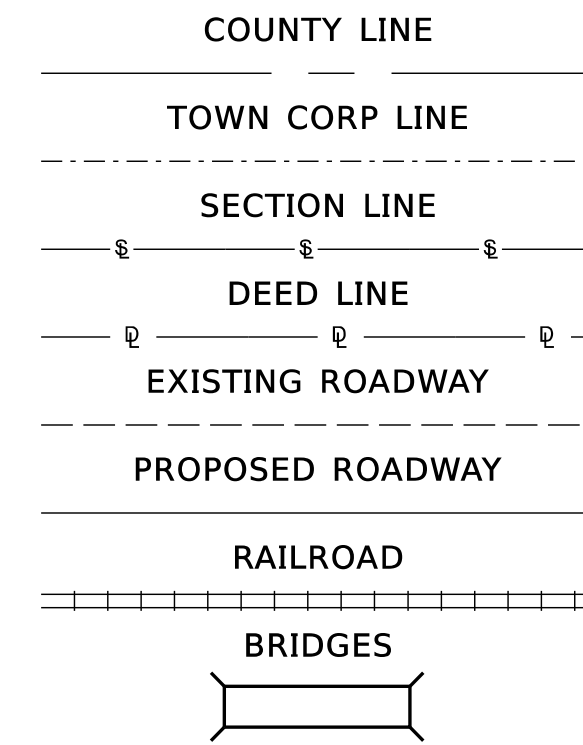

LENGTH DATA

LENGTH OF ROADWAY	1300	FT. 0.2462 MI.
LENGTH OF BRIDGES	0	FT. 0 MI.
LENGTH OF PROJECT (NET)	1300	FT. 0.2462 MI.
LENGTH OF EXCEPTIONS	0	FT. 0 MI.
LENGTH OF PROJECT (GROSS)	1300	FT. 0.2462 MI.

SCALES

1 IN.= 50 FT.
1 IN.= 50 FT.
1 IN.= 5 FT.
1 IN.= 2,000 FT.

EXCEPTIONS
NONE

EQUATIONS
NONE

PLAN
PROFILE
LAYOUT

DESIGN CONTROL

55 MPH = V (SPEED DESIGN)

ADT (2035) = 1680 : ADT (2045) = 2050
DHV = 190 : D = 60 % T = 8 %

PERMITS ACQUIRED
BY MDOT

WETLANDS AND WATERS PERMITS

	WATERS	WETLANDS
NATIONWIDE #14	<input type="checkbox"/>	<input type="checkbox"/>
NATIONWIDE (OTHER)*	<input type="checkbox"/>	<input type="checkbox"/>
GENERAL*	<input type="checkbox"/>	<input type="checkbox"/>
INDIVIDUAL (404)*	<input type="checkbox"/>	<input type="checkbox"/>

STORMWATER PERMIT ☐

Y REQUIRED, CNOI SUBMITTED BY MDOT
(DISTURBED AREA=5 ACRES)

S REQUIRED, SCNOI TO BE SUBMITTED BY
CONTRACTOR (1 TO 4.99 ACRES)

N NO STORMWATER PERMIT
REQUIRED (<1 ACRE)

APPROVED BY: _____

DESIGNED BY: BROWN, MITCHELL & ALEXANDER

CONSTRUCTION PROJECT DATA

EXTERNAL PROJECT NUMBER STP-0022-01(089)

FMS & DETAIL 108392/301000

P S & E DATE: 3/30/2023

APPROVED:

DEPUTY EXECUTIVE DIRECTOR / CHIEF ENGINEER

EXECUTIVE DIRECTOR

PRELIMINARY
NOT FOR
CONSTRUCTION

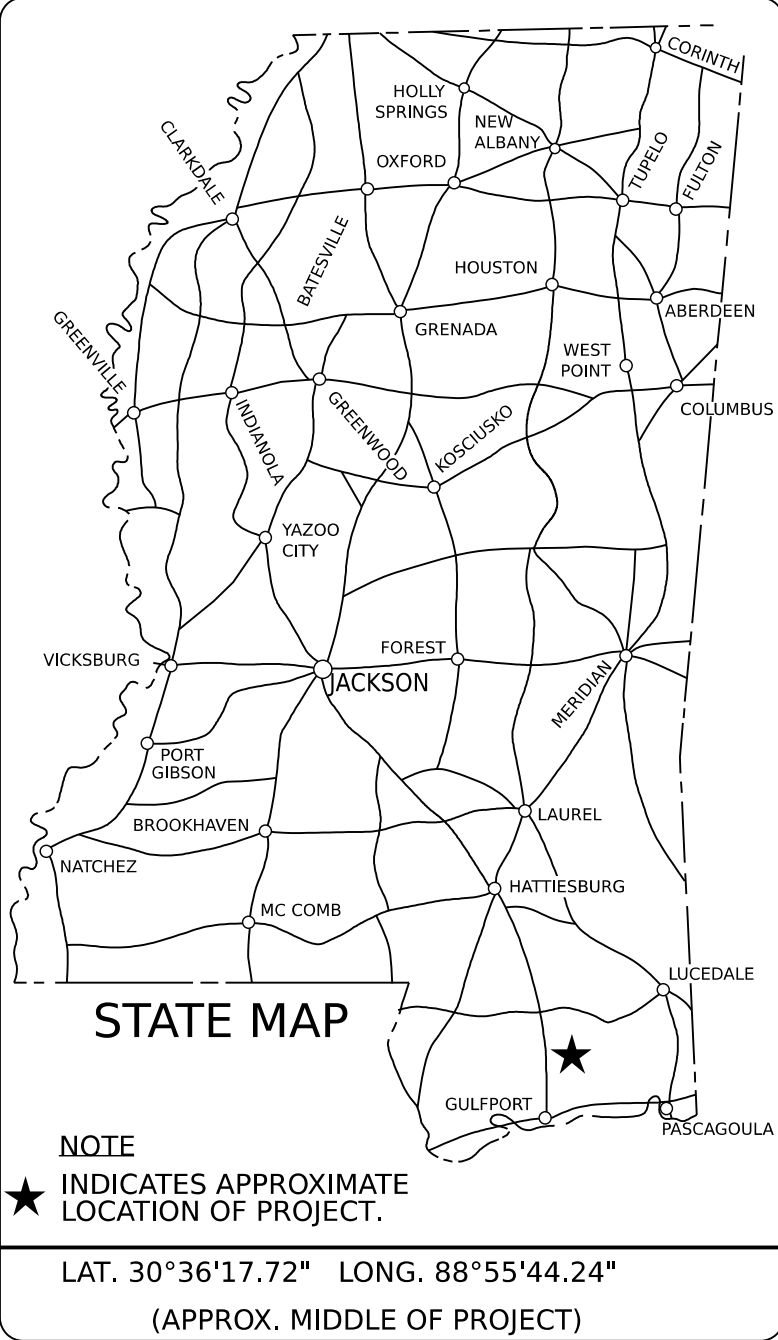

PLAN SHEET

10:55:06 AM 1.TITLE.dgn

DATE

B.M.ELEV. 68.25'
DESC. CHISELED "X" IN BRIDGE
ABUTMENT MARKED TBML

P.C.M. ELEV. 64.89'
PT NAME: 15-24-2
N. 402256.94
E. 954305.23
DESC. 3/2" ALUM. DISK ON A
FENO. ROD STAMPED 15-24-2

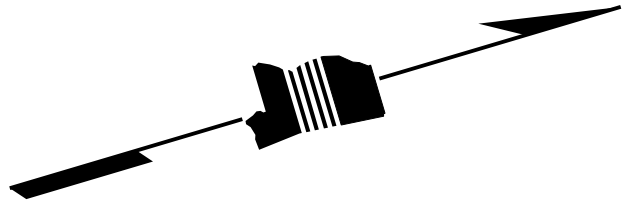

PRELIMINARY
NOT FOR
CONSTRUCTION

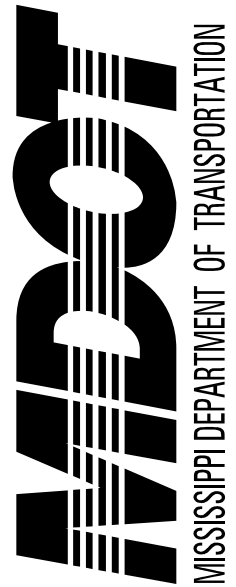

DESIGNED BY: BMA

DETAILED BY:

CHECKED BY:

DATE: 02/01/2024

FMS CON: 108392/301000

PROJECT NO.: STP-0022-01(089)

COUNTY: HARRISON

EROSION CONTROL PLAN
MAINLINE

WK. NO.
ECP-3

SHEET NO.
18

BR. NO. 15.7

TEMPORARY EROSION CONTROL ITEMS	UNITS	SYMBOL	TOTALS
SILT FENCE	LF	-SF-	
SUPER SILT FENCE	LF	-SSF-	
WATTLES, 12"	LF		
WATTLES, 20"	LF		
TRIANGULAR SILT DIKE	LF		
SANDBAGS	LF		
RIPRAP	TON		
EROSION CHECKS	BALE		
TYPE D SILT BASINS	EACH		

PLAN-PROFILE SHEET

9:58:39 AM ECP.dgn

DATE

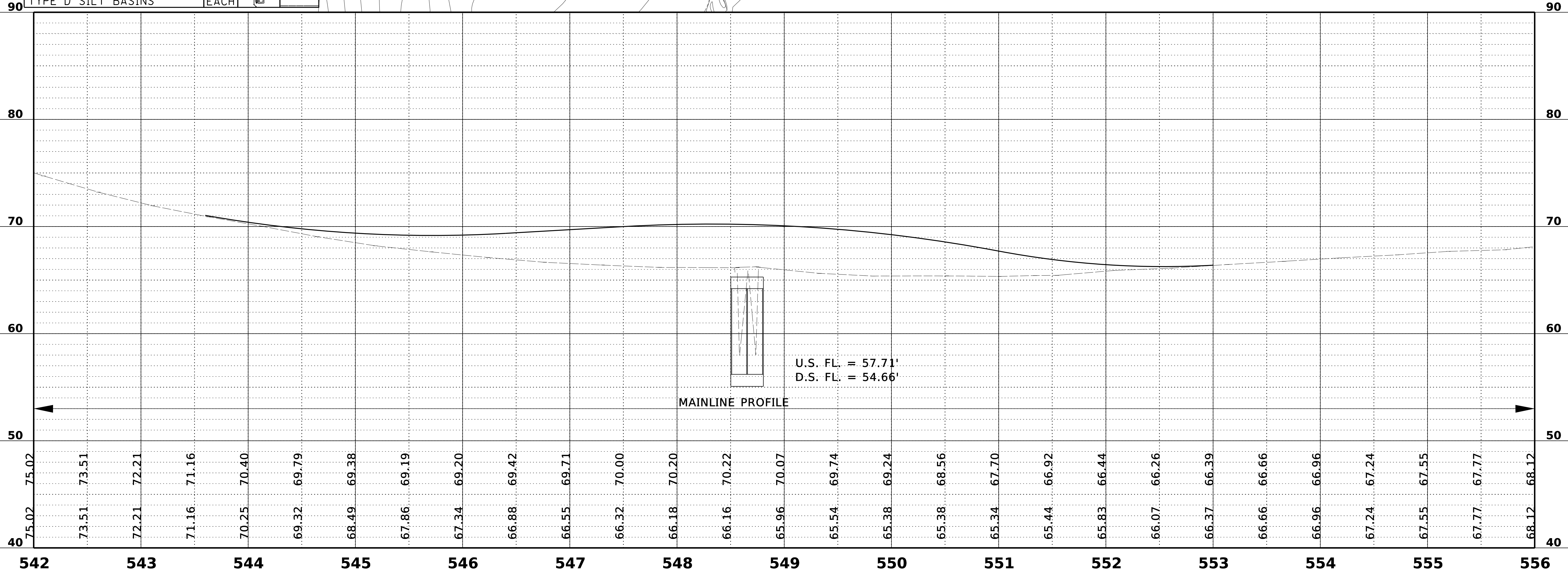

PLAN-PROFILE SHEET

DATE 9:52:24 AM ECP.dgn

TEMPORARY EROSION CONTROL ITEMS	UNITS	SYMBOL	TOTALS
SILT FENCE	LF	-SF-	
SUPER SILT FENCE	LF	-SSF-	
WATTLES, 12"	LF		
WATTLES, 20"	LF		
TRIANGULAR SILT DIKE	LF		
SANDBAGS	LF		
RIPRAP	TON		
EROSION CHECKS	BALE		
TYPE D SILT BASINS	EACH		

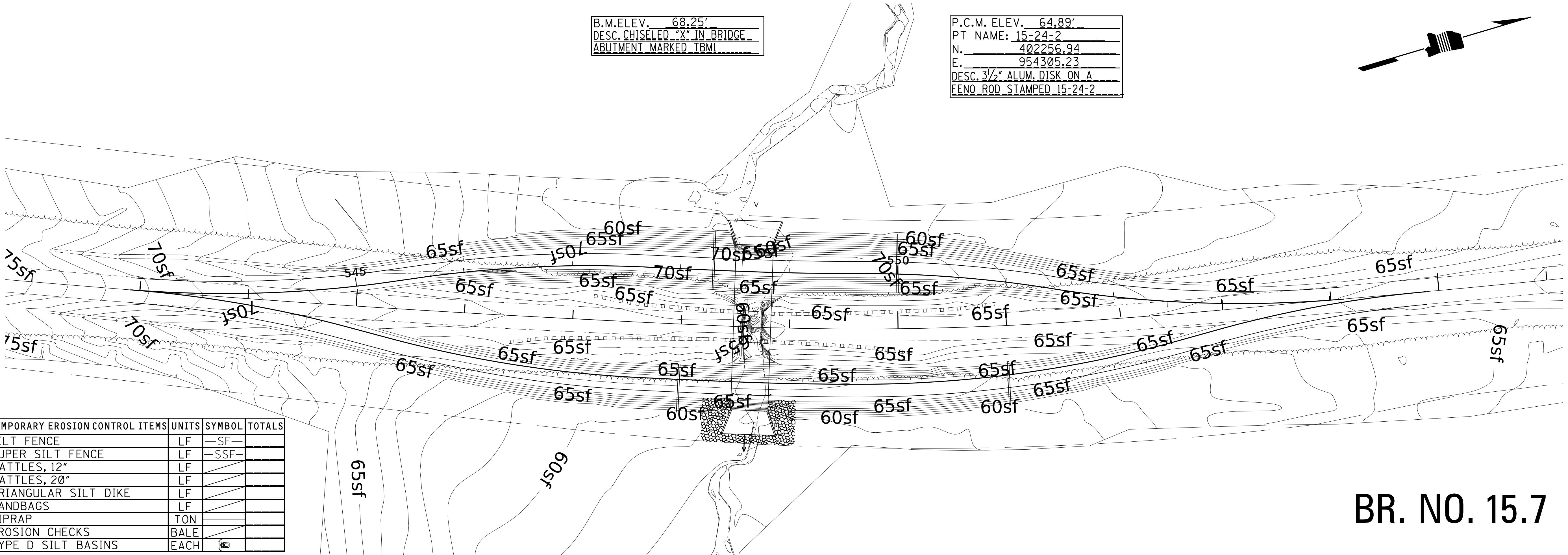

B.M. ELEV. 68.25'
DESC. CHISELED "X" IN BRIDGE
ABUTMENT MARKED TBM

P.C.M. ELEV. 64.89'
PT NAME: 15-24-2
N. 402256.94
E. 954305.23
DESC. 3/2" ALUM. DISK ON A
FENO. ROD STAMPED 15-24-2

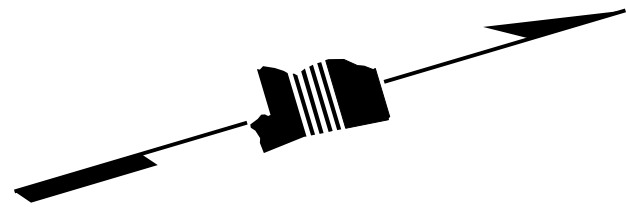

BR. NO. 15.7

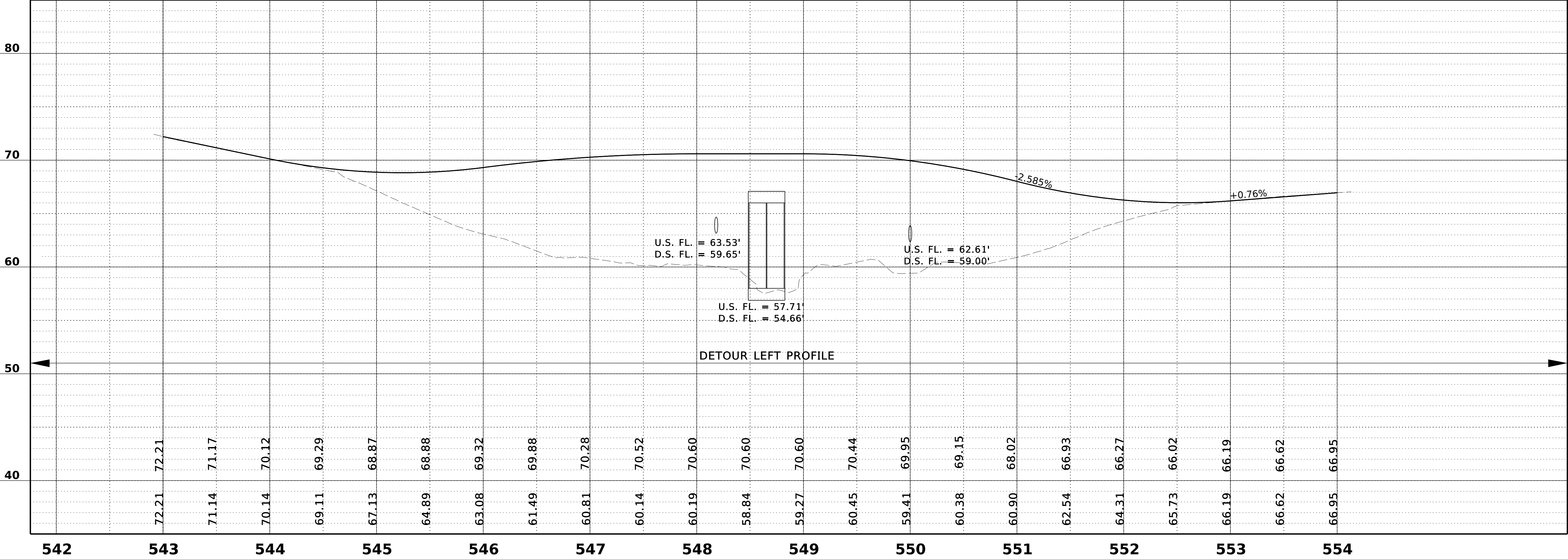

PRELIMINARY
NOT FOR
CONSTRUCTION

MISSISSIPPI DEPARTMENT OF TRANSPORTATION

DESIGNED BY: BMA
DETAILED BY:
CHECKED BY:
DATE: 02/01/2024







FMS CON: 108392/301000
PROJECT NO.: STP-0022-01(089)
COUNTY: HARRISON

EROSION CONTROL PLAN
DETOUR LEFT

WK. NO.
ECP-3-LT
SHEET NO.
19

PLAN-PROFILE SHEET

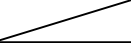
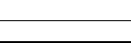
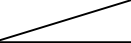
DATE 9:57:47 AM ECP.dgn

TEMPORARY EROSION CONTROL ITEMS	UNITS	SYMBOL	TOTALS
SILT FENCE	LF		
SUPER SILT FENCE	LF		
WATTLES, 12"	LF		
WATTLES, 20"	LF		
TRIANGULAR SILT DIKE	LF		
SANDBAGS	LF		
RIPRAP	TON		
EROSION CHECKS	BALE		
TYPE D SILT BASINS	EACH		

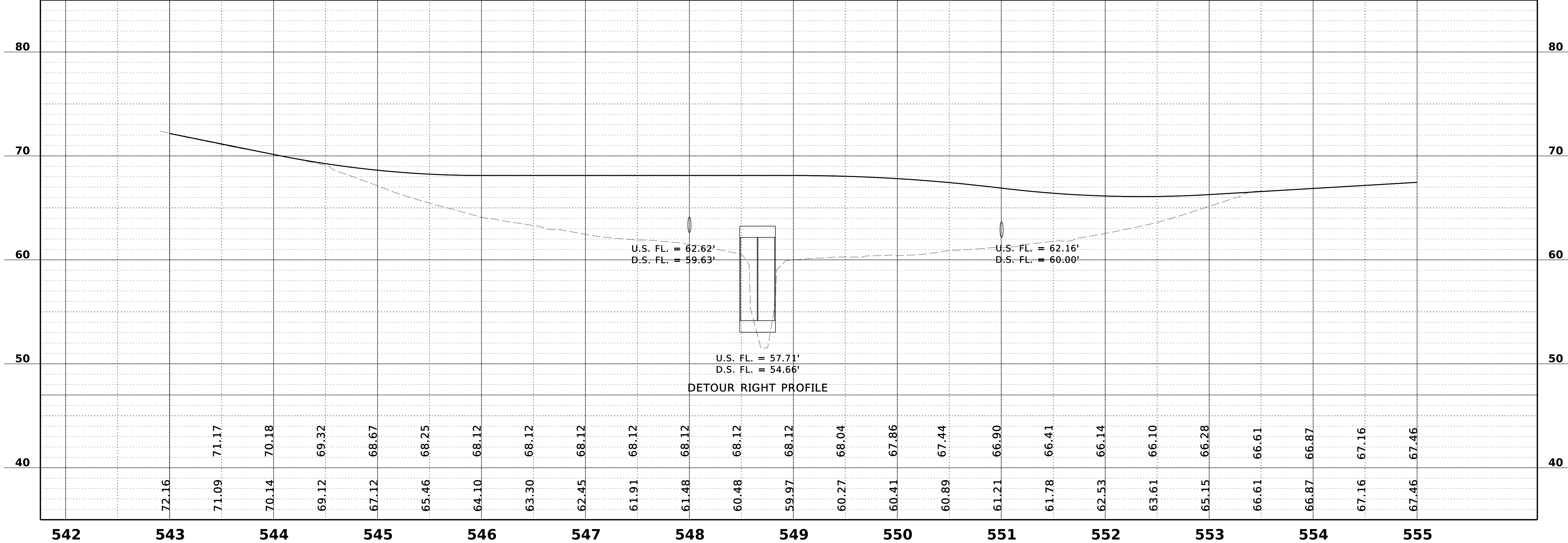

BR. NO. 15.7

P.C.M. ELEV. 64.89'
PT NAME: 15-24-2
N. 402256.94
E. 954305.23
DESC. 3/4" ALUM. DISK ON A
FENO. ROD STAMPED 15-24-2

B.M. ELEV. 68.25'
DESC. CHISELED "X" IN BRIDGE
ABUTMENT MARKED TBM1

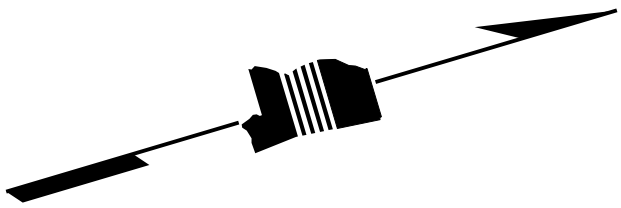

PRELIMINARY
NOT FOR
CONSTRUCTION

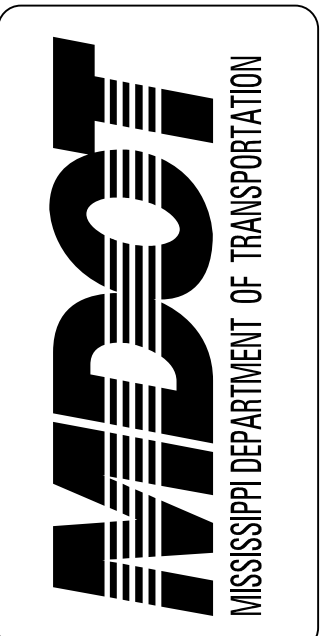

DESIGNED BY: BMA
DETAILED BY:
CHECKED BY:
DATE: 02/01/2024

FMS CON: 108392/301000
PROJECT NO.: STP-0022-01(089)
COUNTY: HARRISON

EROSION CONTROL PLAN
DETOUR RIGHT

WK. NO.
ECP-3-RT
SHEET NO.
20