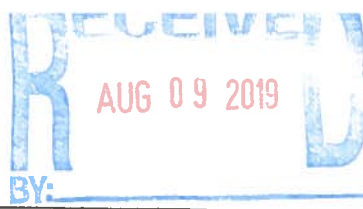

69929

MSR10 8023

(NUMBER TO BE ASSIGNED BY STATE)

APPLICANT IS THE: ☒ OWNER ☐ PRIME CONTRACTOR

OWNER CONTACT INFORMATION

OWNER CONTACT PERSON: Joseph W HaylesOWNER COMPANY LEGAL NAME: JWH Real Estate LLCOWNER STREET OR P.O. BOX: 158 caroline pointe blvdOWNER CITY: Madison STATE: MS ZIP: 39110OWNER PHONE #: (601) 5941085 OWNER EMAIL: joey@haylestowing.com

PRIME CONTRACTOR CONTACT INFORMATION

PRIME CONTRACTOR CONTACT PERSON: Joseph W hayles

PRIME CONTRACTOR COMPANY LEGAL NAME: _____

PRIME CONTRACTOR STREET OR P.O. BOX: _____

PRIME CONTRACTOR CITY: _____ STATE: _____ ZIP: _____

PRIME CONTRACTOR PHONE #: (____) _____ PRIME CONTRACTOR EMAIL: _____

FACILITY SITE INFORMATION

FACILITY SITE NAME: Elton Rd Parking Lot

FACILITY SITE ADDRESS (If the physical address is not available, please indicate the nearest named road. For linear projects indicate the beginning of the project and identify all counties the project traverses.)

STREET: Elton RdCITY: Jackson STATE: MS COUNTY: Hinds ZIP: 39212FACILITY SITE TRIBAL LAND ID (N/A If not applicable): N/ALATITUDE: ^{32.222} _____ degrees _____ minutes _____ seconds LONGITUDE: ^{-90.22} _____ degrees _____ minutes _____ seconds

LAT & LONG DATA SOURCE (GPS (Please GPS Project Entrance/Start Point) or Map Interpolation): _____

TOTAL ACREAGE THAT WILL BE DISTURBED ¹: 25.5IS THIS PART OF A LARGER COMMON PLAN OF DEVELOPMENT? YES ☐ NO ☒IF YES, NAME OF LARGER COMMON PLAN OF DEVELOPMENT: _____
AND PERMIT COVERAGE NUMBER: MSR10 _____ESTIMATED CONSTRUCTION PROJECT START DATE: 2019-09-01
YYYY-MM-DDESTIMATED CONSTRUCTION PROJECT END DATE: 2022-09-01
YYYY-MM-DDDESCRIPTION OF CONSTRUCTION ACTIVITY: Will clean up the small under brush and small tree so the land can be fill with fill dirt.PROPOSED DESCRIPTION OF PROPERTY USE AFTER CONSTRUCTION HAS BEEN COMPLETED:
Land will be use for a parking lot

SIC Code _____ NAICS Code _____

NEAREST NAMED RECEIVING STREAM: Caney Creek

IS RECEIVING STREAM ON MISSISSIPPI'S 303(d) LIST OF IMPAIRED WATER BODIES? (The 303(d) list of impaired waters and TMDL stream segments may be found on MDEQ's web site: http://www.deq.state.ms.us/MDEQ.nsf/page/TWB_Total_Maximum_Daily_Load_Section) YES ☐ NO ☒

HAS A TMDL BEEN ESTABLISHED FOR THE RECEIVING STREAM SEGMENT? YES ☐ NO ☒

ARE THERE RECREATIONAL STREAMS, PRIVATE/PUBLIC PONDS OR LAKES WITHIN ½ MILE DOWNSTREAM OF PROJECT BOUNDARY THAT MAY BE IMPACTED BY THE CONSTRUCTION ACTIVITY? YES ☐ NO ☒

EXISTING DATA DESCRIBING THE SOIL (for linear projects please describe in SWPPP):

WILL FLOCCULANTS BE USED TO TREAT TURBIDITY IN STORM WATER? YES ☐ NO ☒

IF YES, INDICATE THE TYPE OF FLOCCULANT.

- ☐ ANIONIC POLYACRYLAMIDE (PAM)
☐ OTHER _____

IF YES, DOES THE SWPPP DESCRIBE THE METHOD OF INTRODUCTION, THE LOCATION OF INTRODUCTION AND THE LOCATION OF WHERE FLOCCULATED MATERIAL WILL SETTLE? YES ☐ NO ☒

¹Acreage for subdivision development includes areas disturbed by construction of roads, utilities and drainage. Additionally, a housesite of at least 10,000 ft² per lot (entire lot, if smaller) shall be included in calculating acreage disturbed.

DOCUMENTATION OF COMPLIANCE WITH OTHER REGULATIONS/REQUIREMENTS

COVERAGE UNDER THIS PERMIT WILL NOT BE GRANTED UNTIL ALL OTHER REQUIRED
MDEQ PERMITS AND APPROVALS ARE SATISFACTORILY ADDRESSED

IS LCNOI FOR A FACILITY THAT WILL REQUIRE OTHER PERMITS?

YES ☒

NO ☐

IF YES, CHECK ALL THAT APPLY: ☐ AIR ☐ HAZARDOUS WASTE ☐ PRETREATMENT

☐ WATER STATE OPERATING ☐ INDIVIDUAL NPDES

☒ OTHER: COE

IS THE PROJECT REROUTING, FILLING OR CROSSING A WATER CONVEYANCE YES ☐ NO ☒
OF ANY KIND? (If yes, contact the U.S. Army Corps of Engineers' Regulatory Branch for permitting requirements.)

IF THE PROJECT REQUIRES A CORPS OF ENGINEER SECTION 404 PERMIT, PROVIDE APPROPRIATE DOCUMENTATION THAT:

- The project has been approved by individual permit, or
- The work will be covered by a nationwide permit and NO NOTIFICATION to the Corps is required, or
- The work will be covered by a nationwide or general permit and NOTIFICATION to the Corps is required

IS A LAKE REQUIRING THE CONSTRUCTION OF A DAM BEING PROPOSED? YES ☐ NO ☒
(If yes, provide appropriate approval documentation from MDEQ Office of Land and Water, Dam Safety.)

IF THE PROJECT IS A SUBDIVISION OR A COMMERCIAL DEVELOPMENT, HOW WILL SANITARY SEWAGE BE DISPOSED? Check one of the following and attach the pertinent documents.

- ☐ Existing Municipal or Commercial System. Please attach plans and specifications for the collection system and the associated "Information Regarding Proposed Wastewater Projects" form or approval from County Utility Authority in Hancock, Harrison, Jackson, Pearl River and Stone Counties. If the plans and specifications can not be provided at the time of LCNOI submittal, MDEQ will accept written acknowledgement from official(s) responsible for wastewater collection and treatment that the flows generated from the proposed project can and will be transported and treated properly. The letter must include the estimated flow.
- ☐ Collection and Treatment System will be Constructed. Please attach a copy of the cover of the NPDES discharge permit from MDEQ or indicate the date the application was submitted to MDEQ (Date: _____.)
- ☐ Individual Onsite Wastewater Disposal Systems for Subdivisions Less than 35 Lots. Please attach a copy of the Letter of General Acceptance from the Mississippi State Department of Health or certification from a registered professional engineer that the platted lots should support individual onsite wastewater disposal systems.
- ☐ Individual Onsite Wastewater Disposal Systems for Subdivisions Greater than 35 Lots. A determination of the feasibility of installing a central sewage collection and treatment system must be made by MDEQ. A copy of the response from MDEQ concerning the feasibility study must be attached. If a central collection and wastewater system is not feasible, then please attach a copy of the Letter of General Acceptance from the State Department of Health or certification from a registered professional engineer that the platted lots should support individual onsite wastewater disposal systems.

INDICATE ANY LOCAL STORM WATER ORDINANCE WITH WHICH THE PROJECT MUST COMPLY:

I certify under penalty of law that this document and all attachments were prepared under my direction or supervision in accordance with a system designed to assure that qualified personnel properly gathered and evaluated the information submitted. Based on my inquiry of the person or persons who manage the system, or those persons directly responsible for gathering the information, the information submitted is, to the best of my knowledge and belief, true, accurate and complete. I am aware that there are significant penalties for submitting false information, including the possibility of fine and imprisonment for knowing violations.

Signature of Applicant¹ (owner or prime contractor)

2019-08-06

Date Signed

Joseph W. Hayles

Printed Name¹

Member

Title

¹This application shall be signed as follows:

- For a corporation, by a responsible corporate officer.
- For a partnership, by a general partner.
- For a sole proprietorship, by the proprietor.

For a municipal, state or other public facility, by principal executive officer, mayor, or ranking elected official

Please submit the LCNOI form to:

Chief, Environmental Permits Division
MS Department of Environmental Quality, Office of Pollution Control
P.O. Box 2261
Jackson, Mississippi 39225

Storm Water Pollution Prevention Plan

Site Information:

Site construction is to be temporary detour of approximately 19 acres only. There is currently no existing parking or construction on this site. Existing off-site storm water comes across site from Hwy 55 and the highway road to the west and southwest of the site. All on-site storm water drains to an existing stormwater drainage ditch on the site. An existing stormwater drainage ditch carries surface water drainage from the site to the northwest of the site. All new slopes are a minimum of 2:1.

Controls:

Vegetative Controls: A 20' undisturbed riparian buffer zone will be maintained around the perimeter of the site. Existing trees will be preserved as noted. Erosion will be permanently seeded with a seed mixture of ryegrass and fescue within 7 days of final grading of new. All 2:1 slopes will be seeded by sodding prior to seeding.

Structural Controls: An existing sediment basin with surface discharge will be used at the end of the site. The sediment basin will be maintained and cleaned as needed. All cut slopes will be at or below 2:1 grade. A construction entrance with tie back and all storm water ditches will be installed at the down slope side of all storm water pipes. A 600' trench will be installed around the site perimeter to collect runoff from the site. A 600' trench will be installed around the site perimeter to collect runoff from the site. A 600' trench will be installed around the site perimeter to collect runoff from the site.

Housekeeping practices: A steel trailer will be kept at the construction entrance at Elton road to maintain materials and debris will be stored in a minimum of 4 times a day. All equipment will be maintained and repaired as needed.

Best Construction Storm Water Management Measures: The temporary sediment basin will be installed at the down slope side of all storm water pipes. A 600' trench will be installed around the site perimeter to collect runoff from the site. A 600' trench will be installed around the site perimeter to collect runoff from the site. A 600' trench will be installed around the site perimeter to collect runoff from the site.

Implementation Sequence:

1. Build construction entrance with tie back and all storm water ditches.
2. Install rip-rap at sediment basin as needed.
3. Grade site with rip-rap.
4. After site is stabilized with rip-rap remove all temporary measures and convert sediment basin to detention basin.

Maintenance Plan

Check all disturbed areas, erosion and sediment controls after each significant rainfall but not less than once per week. All sediment traps will be cleaned within 24 hours. Remove sediment from the basin and all basins within 24 hours of each rainfall event. Maintain all sediment traps and basins. Maintain all sediment traps and basins. Maintain all sediment traps and basins.

AREA OF WORK



Project Title:
**JWH REAL ESTATE, LLC
ELTON ROAD PROPERTY
LAND USE PLANNING AND DEVELOPMENT**

**J. SCOTT WILLIAMS
ARCHITECTURE, PLLC**
170 RIVER HIDE DRIVE
JACKSON, MISSISSIPPI 39201
601.355.7234
jwilliams@jwilliamsarch.com

PROJECT NO:
16-015
DATE:
07 AUGUST 2019
REVISIONS:

SHEET NO:
C-101

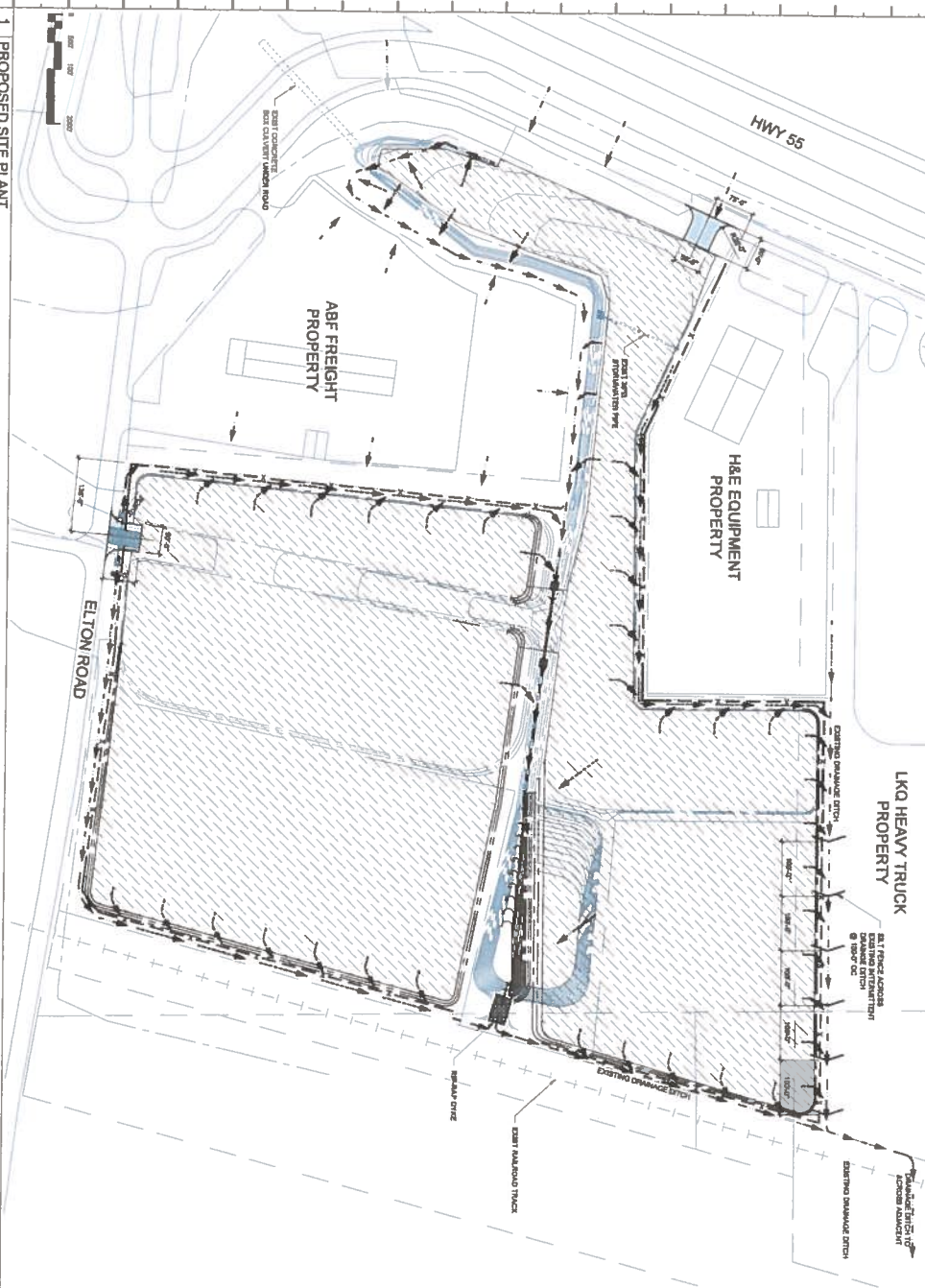

1. PROPOSED SITE PLAN

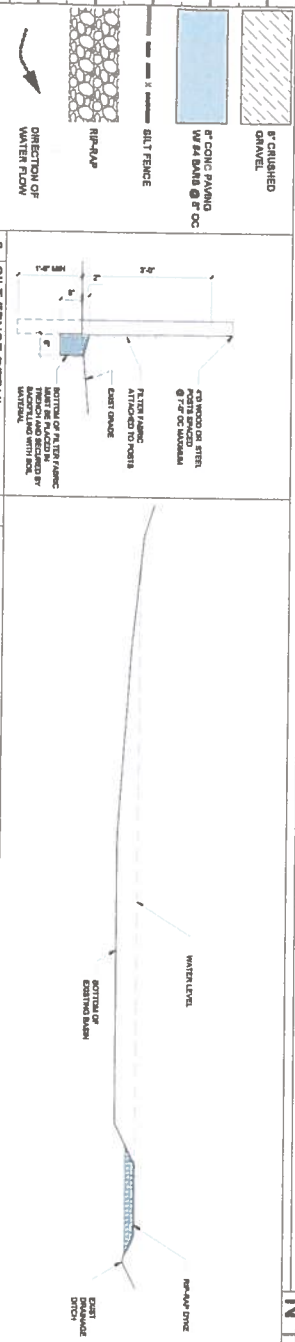

2. SILT FENCE DETAIL

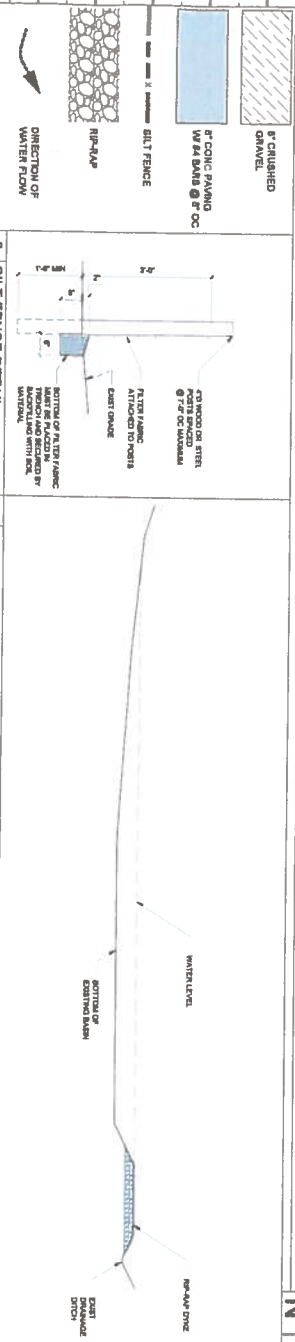

4. USGS QUAD MAP