



Rumsey Consulting Engineering, Inc.

Planning, Surveying, Design

910 Howard Avenue • Biloxi, MS 39530
Tel: (228) 432-9344 • Fax: (228) 432-1189
e-mail: rcei@rumseyengineering.com

April 21, 2020

Mississippi Department of Environmental Quality
Office of Pollution Control
P.O. Box 2261
Jackson, MS 39225

Attn: Mr. Bradley Crain, PE, Chief Municipal and Private Facilities Branch, Environmental Permits Division

Re: Emerald Lakes South – Phase III, 29 Lots, Jackson County, MS

Subject: Preliminary Plans

Dear Mr. Crain:

Please find enclosed in this email the Preliminary Plans and Specifications in PDF for the above referenced project for your review and approval. As requested, the Major Modification Form, OPC Form, Will-Serve Letter, Quad Map, Environmental Clearance Form and Drainage Calculations.

If you need any additional information or if I can be of further assistance, please contact our office at your earliest convenience.

Sincerely,

RUMSEY CONSULTING ENGINEERING, INC.

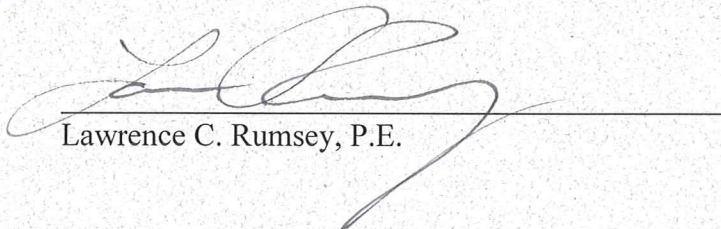

Lawrence C. Rumsey, P.E.

Attachments

**MAJOR MODIFICATION FORM
FOR LARGE CONSTRUCTION GENERAL PERMIT**
Coverage No. MSR10 7 6 7 8 County Jackson



INSTRUCTIONS

Coverage recipients shall notify the Mississippi Department of Environmental Quality at least 30 days in advance of the following activities (check all that apply). This form should be submitted with a modified Storm Water Pollution Prevention Plan (SWPPP), updated USGS topographic map, Corps of Engineers Section 404 documentation and wastewater collection and treatment information, as appropriate.

- SWPPP details have been developed and are ready for MDEQ review for subsequent phases of an existing, covered project.
- "Footprint" identified in the original LCNOI is proposed to be enlarged.

This form must be signed by the current coverage recipient under Mississippi's Large Construction General Permit. A different developer of new phases of existing subdivisions must apply for separate permit coverage through the submittal of a new complete LCNOI package. Coverage recipients are authorized to discharge storm water associated with proposed expansions of existing subdivisions or subsequent phases, under the conditions of the General Permit, only upon receipt of written notification of approval by MDEQ. All other modifications, such as changes of erosion and sediment controls used, must be in accordance with ACT6, S-1 (6) and S-2 (7) of the General Permit.

ALL INFORMATION MUST BE COMPLETED (indicate "N/A" where not applicable)

COVERAGE RECIPIENT INFORMATION

COVERAGE RECIPIENT CONTACT NAME: Robert Jackson TEL # (228) 239-3612
 COMPANY NAME: Billie Noche, LLC
 STREET OR P.O. BOX: 156 Linda Circle
 CITY: Ocean Springs STATE: MS ZIP: 39564 E-MAIL: robert67944@gmail.com

PROJECT INFORMATION

PROJECT NAME: Emerald Lakes South - Phase III
 CITY: Ocean Springs, Jackson County
 ADDITIONAL ACREAGE TO BE DISTURBED: 6.71 TOTAL PROJECT ACREAGE: 33.35

I certify under penalty of law that this document and all attachments were prepared under my direction or supervision in accordance with a system designed to assure that qualified personnel properly gathered and evaluated the information submitted. Based on my inquiry of the person or persons who manage the system, or those persons directly responsible for gathering the information, the information submitted is, to the best of my knowledge and belief, true, accurate and complete. I am aware that there are significant penalties for submitting false information, including the possibility of fine and imprisonment for knowing violations.

Robert Jackson
 Signature (must be signed by coverage recipient)

12-27-19
 Date

Robert Jackson
 Printed Name

Manager
 Title

Please submit this form to: Chief, Environmental Permits Division
 MS Department of Environmental Quality, Office of Pollution Control
 P.O. Box 2261
 Jackson, Mississippi 39225

MSR10 _____

(NUMBER TO BE ASSIGNED BY STATE)

APPLICANT IS THE: OWNER PRIME CONTRACTOR

OWNER CONTACT INFORMATION

OWNER CONTACT PERSON: Robert Jackson
OWNER COMPANY LEGAL NAME: Bille Noche LLC.
OWNER STREET OR P.O. BOX: 156 Linda Circles
OWNER CITY: Ocean Springs STATE: MS ZIP: 39564
OWNER PHONE #: (228) 239-3612 OWNER EMAIL: _____

PRIME CONTRACTOR CONTACT INFORMATION

PRIME CONTRACTOR CONTACT PERSON: _____
PRIME CONTRACTOR COMPANY LEGAL NAME: _____
PRIME CONTRACTOR STREET OR P.O. BOX: _____
PRIME CONTRACTOR CITY: _____ STATE: _____ ZIP: _____
PRIME CONTRACTOR PHONE #: (____) _____ PRIME CONTRACTOR EMAIL: _____

FACILITY SITE INFORMATION

FACILITY SITE NAME: Emerald Lakes South - Phase III
FACILITY SITE ADDRESS (If the physical address is not available, please indicate the nearest named road. For linear projects indicate the beginning of the project and identify all counties the project traverses.)
STREET: 2000 Jean Ln
CITY: Ocean Springs STATE: MS COUNTY: Jackson ZIP: 39564
FACILITY SITE TRIBAL LAND ID (N/A if not applicable): N/A
LATITUDE: 30 degrees 21 minutes 42 seconds LONGITUDE: 88 degrees 44 minutes 10 seconds
LAT & LONG DATA SOURCE (GPS (Please GPS Project Entrance/Start Point) or Map Interpolation): Google Maps
TOTAL ACREAGE THAT WILL BE DISTURBED ¹: 6.71
IS THIS PART OF A LARGER COMMON PLAN OF DEVELOPMENT? YES NO
IF YES, NAME OF LARGER COMMON PLAN OF DEVELOPMENT: Emerald Lakes South
AND PERMIT COVERAGE NUMBER: MSR10_{7 6 7 8}
ESTIMATED CONSTRUCTION PROJECT START DATE: _____
ESTIMATED CONSTRUCTION PROJECT END DATE: _____
DESCRIPTION OF CONSTRUCTION ACTIVITY: Roads, Sewer, Water, Drainage
PROPOSED DESCRIPTION OF PROPERTY USE AFTER CONSTRUCTION HAS BEEN COMPLETED:
Single Family Residential
SIC Code _____ NAICS Code _____

NEAREST NAMED RECEIVING STREAM: Mississippi Sound

IS RECEIVING STREAM ON MISSISSIPPI'S 303(d) LIST OF IMPAIRED WATER BODIES? (The 303(d) list of impaired waters and TMDL stream segments may be found on MDEQ's web site: http://www.deq.state.ms.us/MDEQ.nsf/page/TWB_Total_Maximum_Daily_Load_Section) YES NO

HAS A TMDL BEEN ESTABLISHED FOR THE RECEIVING STREAM SEGMENT? YES NO

ARE THERE RECREATIONAL STREAMS, PRIVATE/PUBLIC PONDS OR LAKES WITHIN 1/2 MILE DOWNSTREAM OF PROJECT BOUNDARY THAT MAY BE IMPACTED BY THE CONSTRUCTION ACTIVITY? YES NO

EXISTING DATA DESCRIBING THE SOIL (for linear projects please describe in SWPPP):

Duckworth Sand

WILL FLOCCULANTS BE USED TO TREAT TURBIDITY IN STORM WATER? YES NO

IF YES, INDICATE THE TYPE OF FLOCCULANT. ANIONIC POLYACRYLAMIDE (PAM)
 OTHER _____

IF YES, DOES THE SWPPP DESCRIBE THE METHOD OF INTRODUCTION, THE LOCATION OF INTRODUCTION AND THE LOCATION OF WHERE FLOCCULATED MATERIAL WILL SETTLE? YES NO

¹Acreage for subdivision development includes areas disturbed by construction of roads, utilities and drainage. Additionally, a housesite of at least 10,000 ft² per lot (entire lot, if smaller) shall be included in calculating acreage disturbed.

DOCUMENTATION OF COMPLIANCE WITH OTHER REGULATIONS/REQUIREMENTS
 COVERAGE UNDER THIS PERMIT WILL NOT BE GRANTED UNTIL ALL OTHER REQUIRED
 MDEQ PERMITS AND APPROVALS ARE SATISFACTORILY ADDRESSED

IS LCNOI FOR A FACILITY THAT WILL REQUIRE OTHER PERMITS? YES NO

IF YES, CHECK ALL THAT APPLY: AIR HAZARDOUS WASTE PRETREATMENT
 WATER STATE OPERATING INDIVIDUAL NPDES OTHER: _____

IS THE PROJECT REROUTING, FILLING OR CROSSING A WATER CONVEYANCE OF ANY KIND? (If yes, contact the U.S. Army Corps of Engineers' Regulatory Branch for permitting requirements.) YES NO

IF THE PROJECT REQUIRES A CORPS OF ENGINEER SECTION 404 PERMIT, PROVIDE APPROPRIATE DOCUMENTATION THAT:

- The project has been approved by individual permit, or
- The work will be covered by a nationwide permit and NO NOTIFICATION to the Corps is required, or
- The work will be covered by a nationwide or general permit and NOTIFICATION to the Corps is required

IS A LAKE REQUIRING THE CONSTRUCTION OF A DAM BEING PROPOSED? YES NO
 (If yes, provide appropriate approval documentation from MDEQ Office of Land and Water, Dam Safety.)

IF THE PROJECT IS A SUBDIVISION OR A COMMERCIAL DEVELOPMENT, HOW WILL SANITARY SEWAGE BE DISPOSED? Check one of the following and attach the pertinent documents.

- Existing Municipal or Commercial System. Please attach plans and specifications for the collection system and the associated "Information Regarding Proposed Wastewater Projects" form or approval from County Utility Authority in Hancock, Harrison, Jackson, Pearl River and Stone Counties. If the plans and specifications can not be provided at the time of LCNOI submittal, MDEQ will accept written acknowledgement from official(s) responsible for wastewater collection and treatment that the flows generated from the proposed project can and will be transported and treated properly. The letter must include the estimated flow.
- Collection and Treatment System will be Constructed. Please attach a copy of the cover of the NPDES discharge permit from MDEQ or indicate the date the application was submitted to MDEQ (Date: _____.)
- Individual Onsite Wastewater Disposal Systems for Subdivisions Less than 35 Lots. Please attach a copy of the Letter of General Acceptance from the Mississippi State Department of Health or certification from a registered professional engineer that the platted lots should support individual onsite wastewater disposal systems.
- Individual Onsite Wastewater Disposal Systems for Subdivisions Greater than 35 Lots. A determination of the feasibility of installing a central sewage collection and treatment system must be made by MDEQ. A copy of the response from MDEQ concerning the feasibility study must be attached. If a central collection and wastewater system is not feasible, then please attach a copy of the Letter of General Acceptance from the State Department of Health or certification from a registered professional engineer that the platted lots should support individual onsite wastewater disposal systems.

INDICATE ANY LOCAL STORM WATER ORDINANCE WITH WHICH THE PROJECT MUST COMPLY:

Jackson County Stormwater Ordinance(s)

I certify under penalty of law that this document and all attachments were prepared under my direction or supervision in accordance with a system designed to assure that qualified personnel properly gathered and evaluated the information submitted. Based on my inquiry of the person or persons who manage the system, or those persons directly responsible for gathering the information, the information submitted is, to the best of my knowledge and belief, true, accurate and complete. I am aware that there are significant penalties for submitting false information, including the possibility of fine and imprisonment for knowing violations.

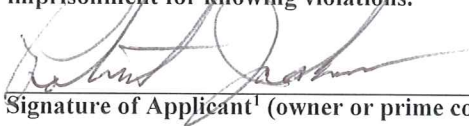

Signature of Applicant¹ (owner or prime contractor)

11/30/20

Date Signed

Robert Jackson

Printed Name¹

Manager

Title

¹This application shall be signed as follows:

- For a corporation, by a responsible corporate officer.
- For a partnership, by a general partner.
- For a sole proprietorship, by the proprietor.

For a municipal, state or other public facility, by principal executive officer, mayor, or ranking elected official

Please submit the LCNOI form to:

Chief, Environmental Permits Division
MS Department of Environmental Quality, Office of Pollution Control
P.O. Box 2261
Jackson, Mississippi 39225

FOR OPC USE ONLY AI NO. _____ PLA NO. _____
--

**INFORMATION REGARDING PROPOSED WASTEWATER PROJECTS
TO: THE MISSISSIPPI OFFICE OF POLLUTION CONTROL**

The Bille Noche LLC,
(Name of Body Making Application, i.e. Individual, Corporation, Municipality, Developer, etc.)

whose mailing address is 156 Linda Cir, Ocean Springs, MS, 39564,
(Street and Number) (City) (State) (Zip)

whose responsible official is Robert Jackson, Manager,
(Name) (Title)

and whose phone number is (228) 239-3612,

Herewith submits for consideration of the OPC plans, specifications, and other necessary data prepared by

Rumsey Consulting Engineering, Inc
(Engineer or Firm)

Lawrence C. Rumsey
(Firm's Project Contact Person, if applicable)

910 Howard Ave.
(Mailing Address)

Biloxi, MS 39530
(City, State, Zip)

(228) 432-9344
(Phone Number)

who is hereby authorized to represent the applicant in the engineering features of this project for the construction of 29 Lots (Extension)

(Clearly Describe Project: New System, Modification, Extension, Rehabilitation, Treatment, etc.)

to serve Emerald Lakes South, Phase III
(Subdivision, Plant, School, Other)

located at North of Emerald Lakes South Phase I, East of Emerald Lakes South Phase II, Section 7, Township 8 South, Range 7 West, Jackson, MS
(Approximate Location, Including Section, Township, and Range)

in or near the City of Ocean Springs in the County of Jackson, State of Mississippi, as required by the regulations of the OPC and herewith make application to the OPC for the approval of this project. We understand through the regulations of the OPC that this approval is required prior to the initiation of construction activities.

Upon construction, these facilities will be owned and maintained by Jackson County Utility Authority

(Name of Utility Company, Municipality, Owner, Developer, etc.)

whose mailing address is 11100 Highway 57, Vanceleave, MS, 39565.
(Street and Number) (City) (State) (Zip)

NOTE: IF THIS PROJECT DOES NOT ADD ANY NEW CONNECTIONS OR ADDITIONAL FLOWS TO THE COLLECTION SYSTEM, YOU MAY OMIT SECTIONS A. THROUGH E. BELOW.

A. EXISTING SEWAGE COLLECTION SYSTEM

1. The facilities collecting the sewage from this proposed project are owned by _____
Jackson County Utility Authority.
(Utility Company, Municipality, etc.)
2. The number of connections existing are 2000 +/-.
3. The length of sanitary sewers existing are 100 miles +/-.
4. The number of existing lift stations are 25.
5. Additional facilities that collect sewage from this proposed project, i.e. a regional wastewater authority, are owned by Jackson County Utility Authority.

B. CERTIFICATION(S) FROM COLLECTION ENTITIES

The official(s) responsible for the wastewater collection facilities denoted in Section A. above, that will serve the proposed project, do hereby certify that we agree to transport the wastewater flows generated from the proposed project. We also hereby certify that we have determined that our collection system(s) have the capacity available to transport properly the wastewater flows generated from the proposed project.

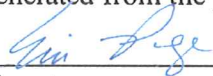
Signature

Executive Director
Title

Jackson County Utility Authority
Entity

Signature

Title

Entity

C. EXISTING SEWAGE TREATMENT WORKS

1. The facilities responsible for treatment of the sewage from this proposed project are owned by Jackson County Utility Authority.
(Utility Company, Municipality, etc.)
2. The OPC Permit Number for this wastewater facility is MS 044 5446.
3. The capacity for this wastewater treatment facility is 7mgd.
4. The treatment type of this wastewater treatment facility is Constructed Wetland Treatment.
(Activated Sludge, Aerated Lagoon, etc.)
5. The present population served by the treatment facility is 40000.
6. The operator in charge will be Brian Davis, who is a
Class 3 wastewater operator, holding certificate number 6321-111.

D. CERTIFICATION FROM WASTEWATER TREATMENT ENTITY

The official responsible for the wastewater treatment facility denoted in Section C. above, that will serve the proposed project, does hereby certify that we agree to treat the wastewater flows generated from the proposed project. We also hereby certify that we have determined that our treatment facility has the capacity available to treat properly the wastewater flows generated from the proposed project.

Signature

Executive Director
Title

Jackson County Utility Authority
Entity

E. PROPOSED PROJECT DETAILS

1. The ultimate population to be served by this proposed project is 73.
2. The number of connections to be added are 29.
3. Per capita discharge 70 gpcd: Infiltration 0 gpcd. (Estimate, if unknown)
4. Area Served in Acres 16.14 Design Population Per Acre 4.5
5. The area water is supplied by _____

JacksonCounty Utility Authority, 11100 Highway 57 , Vancleave, MS 39565.

(Name and Address of Water Utility)

6. Proposed Sewage Pumping Stations

Location or Number	Units Served	Pump Capacity (gpm)	Influent Flow (gpm)	
			Avg.	Peak

F. ADDITIONAL CLEARANCES

NOTE: APPROVAL OF THIS PROJECT SHALL NOT BE GRANTED UNTIL ALL THE MDEQ PERMITS, COVERAGES, AND APPROVALS DENOTED BELOW ARE SATISFACTORILY ADDRESSED.

1. The total area of ground disturbance by clearing, grading, and excavating for utilities, roadways, lots, etc. is 6.71 acres.
2. For construction projects disturbing five or more acres, have you applied to MDEQ or an MDEQ approved local authority for construction stormwater permit coverage?
 Yes Not applicable

If not applicable, why? _____

NOTE: IF YOU ARE DISTURBING MORE THAN ONE ACRE BUT LESS THAN FIVE ACRES AFTER MARCH 10, 2003, YOU MUST FOLLOW THE REQUIREMENTS OF MDEQ'S SMALL CONSTRUCTION STORM WATER GENERAL PERMIT. ALSO, AFTER MARCH 10, 2003, IF YOU ARE IN AN AREA THAT HAS AN MDEQ APPROVED LOCAL AUTHORITY YOU MUST APPLY FOR APPROVAL FOR 1-5 ACRE CONSTRUCTION PROJECTS. SOME LOCAL AUTHORITIES MAY REQUIRE APPROVAL FOR DISTURBANCE LESS THAN ONE ACRE.

3. Have determinations/authorizations been received from the Corps of Engineers regarding the need for a Section 404 Permit, General Permit or Nationwide Permit for stream or intermittent drain crossings, stream re-routing, or for placing fill material into wetlands?
 Yes Pending Not applicable

If not applicable, why? _____

G. ADDITIONAL CERTIFICATIONS

We hereby certify that we are the applicants for this project, that we are familiar with the information contained in this form, and that, to the best of our knowledge and belief, such information is true, complete, and accurate.

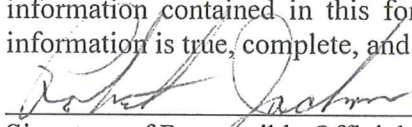

Signature of Responsible Official for Body Making Application

Robert Jackson, Manager

Printed Name and Title of Above

I hereby certify that the engineering documents for this project were prepared by myself or under my direct supervision, that I am familiar with the information contained in this form, and that, to the best of my knowledge and belief, such information is true, complete, and accurate.

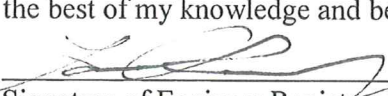

Signature of Engineer Registered Under Mississippi Laws

Lawrence C. Rumsey, #7404

Typed Name and Registration Number



THE APPLICANTS AGREE THAT NO CHANGES IN OR DEVIATION FROM THE PLANS AND SPECIFICATIONS APPROVED BY THE OPC WILL BE MADE EXCEPT WITH THE PRIOR CONSENT AND APPROVAL OF THE OPC.

COMMENTS: _____



JACKSON COUNTY UTILITY AUTHORITY

Serving the People...Protecting the Environment

Directors

Thomas Eldridge ▪ Jackson County
Andrew J. Elly ▪ Moss Point
Frank Mallette ▪ Jackson County
Guy Moore ▪ Pascagoula
Jerry Munro ▪ Ocean Springs
Marshall Smith ▪ Gautier
Tom Stennis ▪ Jackson County

March 30, 2020

Doc#42348

Mr. Larry Rumsey
Rumsey Consulting Engineering, Inc.
910 Howard Avenue
Biloxi, MS 39530

RE: Emerald Lakes, Phase III (29 Lots)
Emerald Lakes S/D, Jackson County, MS

Dear Mr. Rumsey:

The Jackson County Utility Authority (JCUA) has reviewed the referenced project plan submitted January 30, 2020, that includes the development of 29 residential lots along in Emerald Lakes S/D in Jackson County, MS. The Authority has received confirmation the stipulations in Document# 42309 have been met, therefore the Authority has no objection to the proposed water and wastewater system improvements, provided construction is completed in accordance to the requirements of the MDEQ, MSDH, and the Jackson County Utility Authority.

This approval does not relieve the owner of other permitting responsibilities as required. Should you have any questions or concerns, please do not hesitate to contact me.

Sincerely,

Jerod Martin

Digitally signed by Jerod
Martin
Date: 2020.03.30 12:20:13
-05'00'

Jerod Martin, E.I.
Engineering Intern, JCUA

Emerald Lakes South Phase III

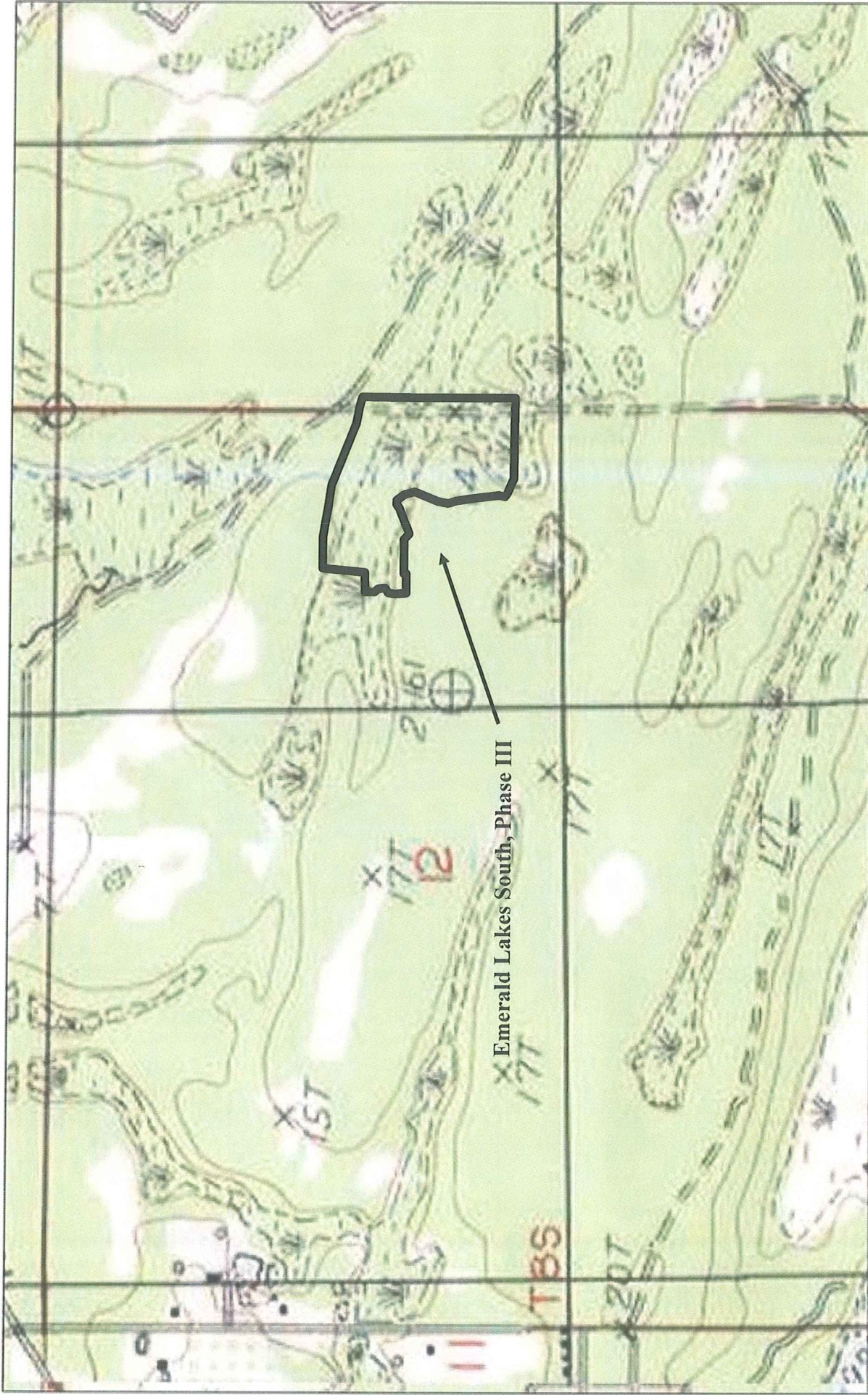

December 23, 2019

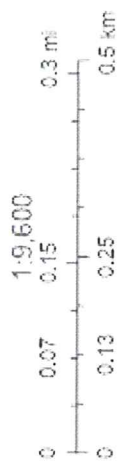

Copyright © 2013 National Geographic Society, Inc.

Web AppBuilder for ArcGIS
Jackson County, GIS | Copyright © 2013 National Geographic Society, Inc.

ENVIRONMENTAL CLEARANCE INFORMATION SHEET FOR CONNECTION TO REGIONAL FACILITIES

NOTE: IT IS RECOMMENDED THAT THE INFORMATION DENOTED BELOW BE ADEQUATELY ADDRESSED PRIOR TO SUBMITTAL TO THE COUNTY UTILITY AUTHORITY. FAILURE TO PROVIDE SUCH INFORMATION MAY RESULT IN DELAYS AND/OR NON-APPROVAL OF CONNECTIONS TO SAID FACILITIES.*

1. The name of the development is Emerald Lakes South, Phase III.

2. The following contact information should be provided:

Name of applicant: Bille Noche, LLC

If applicant is a corporation, the point of contact (agent) is Robert Jackson. The phone number for the point of contact is (228)239-3612.

For a corporation, the responsible party (owner) is Bille Noche, LLC. The phone number of the responsible party is Same as above.

The mailing address of the applicant: 156 Linda Circle
Ocean Springs, MS 39564

3. The physical address of the development: 2000 Jean Ln.
Ocean Springs, MS 39564

4. A development site plan should include the location identified on a USGS Quad Map.

5. The location of the development should be provided by the following:

County: Jackson
Section: 12
Township: 8 South
Range: 7 West
Latitude: 30°21'46.39"N
Longitude: 88°44'01.17"W

6. The development is proposing to connect to Jackson County Utility Authority (facility) through Jackson County Utility Authority (utility infrastructure).

7. The total amount of acreage of the project site is 16.14 acre(s) and the total number of lots within the development is 29.

8. Has the project been coordinated with the U.S. Fish and Wildlife Service to identify the need for a Section 7 consultation for impacts to threatened and/or endangered species?

Yes No

If yes, please provide a copy of the consultation clearance letter from the U.S. Fish and Wildlife Service with this information sheet.

If no, the County Utility Authority will not provide signature on the Wastewater Project Information Sheet required for submittal to the Department of Environmental Quality, Office of Pollution Control.

9. The total area of ground disturbance by clearing, grading, and excavating for utilities, roadways, lots, etc. is 6.71 acres.
10. For construction projects disturbing five or more acres, have you applied to MDEQ or a MDEQ approved local authority for construction storm water permit coverage?

Yes Not applicable

If not applicable, why? _____.

NOTE: IF YOU ARE DISTURBING MORE THAN ONE ACRE BUT LESS THAN FIVE ACRES, YOU MUST FOLLOW THE REQUIREMENTS OF MDEQ'S SMALL CONSTRUCTION STORM WATER GENERAL PERMIT. IF YOU ARE IN AN AREA THAT HAS A MDEQ APPROVED LOCAL AUTHORITY APPROVAL MAY BE REQUIRED FOR 1-5 ACRE CONSTRUCTION PROJECTS. SOME LOCAL AUTHORITIES MAY REQUIRE APPROVAL FOR DISTURBANCE LESS THAN ONE ACRE.

11. Have authorizations been obtained from the Corps of Engineers regarding the need for a Section 404 Permit, General Permit or Nationwide Permit for stream or intermittent drain crossings, stream re-routing, or for placing fill material into wetlands?

Yes Pending Not applicable

If not applicable, why? _____.

*Disclaimer: The above information does not alleviate the applicant/developer from complying with all regulatory requirements for construction and operation of any proposed development. Other State and/or Federal authorizations may be necessary to satisfy any additional regulatory requirements not otherwise listed on this information sheet.

FOR OPC USE ONLY
AGENCY INTEREST NO. _____
PLANS NO. _____
COVERAGE NO. _____

**COASTAL COUNTY UTILITY AUTHORITY ENVIRONMENTAL CLEARANCE
FORM TO THE MISSISSIPPI OFFICE OF POLLUTION CONTROL**

This form is required to be completed and submitted to the Mississippi Office of Pollution Control for all proposed projects applying for wastewater approval or construction stormwater coverage in the following counties: Hancock, Harrison, Jackson, Pearl River, and Stone.

PROJECT NAME: Emerald Lakes South, Phase III

ENTITY MAKING APPLICATION: Bille Noche, LLC

RESPONSIBLE OFFICIAL: Robert Jackson, Manager

COUNTY WHERE PROJECT IS LOCATED: Jackson

The portions below are to be completed by the appropriate County Utility Authority(CUA)

1. Is this project consistent with the requirements of the CUA?
 Yes No
2. Is this project connecting to a facility funded by Community Development Block Grant (CDBG) funds under the Mississippi Gulf Region Water and Wastewater Plan?
 Yes No
If yes, complete Item 3.; if no, skip Item 3.
3. Has this project been coordinated with the U.S. Fish and Wildlife Service to identify the need for a Section 7 consultation for impacts to threatened and/or endangered species?
 Yes No
If yes, a copy of the consultation clearance letter from the U.S. Fish and Wildlife Service must be attached to this form. If no, this project can not be considered by the Office of Pollution Control.

I hereby certify that I am the official responsible with the Jackson County Utility Authority in these matters, that I am familiar with the information contained in this form, and that, to the best of my knowledge and belief, such information is true, complete, and accurate.



Signature
3/30/2020

Date

Executive Director

Title
Jackson County Utility Authority

Entity



Rumsey Consulting Engineering, Inc.
 Planning, Surveying, Design
 910 Howard Avenue
 Biloxi, Mississippi 39530
 (228) 432-9344 FAX (228) 432-1189
 email: rce@rumseyengineering.com

PROJECT SHILOH LAKES SOUTH
PHASE III
 DATE: 12-17-19

DRAIN AREA CALCS.

A1EMR

A = 0.46 AC
 C = 0.50
 L = 405'
 S = 0.47%
 tc = 20 min
 i = 6.4 in/hr
 Q25 = 1.47 cfs

A2EMR

A = 0.65 AC
 C = 0.50
 L = 320'
 S = 0.55%
 tc = 19 min
 i = 6.5 in/hr
 Q25 = 2.11 cfs

A3EMR

A = 0.23 AC
 C = 0.50
 L = 230'
 S = 0.67%
 tc = 15 min
 i = 7.1 in/hr
 Q25 = 0.82 cfs

A4EMR

A = 0.53 AC
 C = 0.50
 L = 345'
 S = 0.42%
 tc = 20 min
 i = 6.4 in/hr
 Q25 = 1.70 cfs

A5EMR

A = 0.20 AC
 C = 0.60
 L = 265'
 S = 0.40%
 tc = 16 min
 i = 7.0 in/hr
 Q25 = 0.84 cfs

A6EMR

A = 0.51 AC
 C = 0.50
 L = 295'
 S = 0.44%
 tc = 19 min
 i = 6.5 in/hr
 Q25 = 1.66 cfs

A7EMR

A = 1.03 AC
 C = 0.50
 L = 453'
 S = 0.33%
 tc = 20 min
 i = 5.3 in/hr
 Q25 = 2.73 cfs

A8EMR

A = 0.82 AC
 C = 0.50
 L = 420'
 S = 0.33%
 tc = 27 min
 i = 5.6 in/hr
 Q25 = 2.30 cfs

A =
 C =
 L =
 S =
 tc =
 i =
 Q25 =

A =
 C =
 L =
 S =
 tc =
 i =
 Q25 =

A =
 C =
 L =
 S =
 tc =
 i =
 Q25 =

A =
 C =
 L =
 S =
 tc =
 i =
 Q25 =



Rumsey Consulting Engineering, Inc.
Planning, Surveying, Design -Est. 1987

910 Howard Ave.
Biloxi, MS 39530
(228)432-9344 * Fax (228)432-1189
email: rcei@rumseyengineering.com

PROJECT: EMMENTON LAKES SOUTH, PHASE III

DATE: 12-18-19

PIPE SIZE CALCULATIONS

PIPE NO.	DRAW AREAS	Q ₂₅	PIPE SIZE	SLOPE	PIPE CAP	PIPE LENGTH
P1	A2EMR	2.11 cfs	13" x 22"	0.20%	4.07	127'
P2	A1EMR, A3EMR	2.29 cfs	13" x 22"	0.30%	4.98	28'
P3	A1EMR - A4EMR	6.10 cfs	18" x 29"	0.20%	9.08	134'
P4	A1EMR - A4EMR	6.10 cfs	18" x 29"	0.20%	9.08	119'
P5	A5EMR	0.84 cfs	18" RCP	0.30%	6.19	28'
P6	A1EMR - A6EMR	8.6 cfs	18" x 29"	0.20%	9.08	144'
P7	A7EMR	2.73 cfs	13" x 22"	0.30%	4.98	28'
P8	A7EMR, A8EMR	5.03 cfs	13" x 22"	0.35%	5.38	151'