

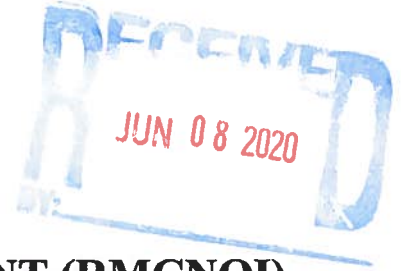

MISSISSIPPI DEPARTMENT OF  
ENVIRONMENTAL QUALITY

AI 77553



## READY-MIX CONCRETE NOTICE OF INTENT (RMCNOI)

### FOR COVERAGE UNDER MULTIMEDIA READY-MIX CONCRETE GENERAL NPDES PERMIT MSG11 0336

(NUMBER TO BE ASSIGNED BY STATE)

FILE AT LEAST 30 DAYS PRIOR TO THE COMMENCEMENT OF THE REGULATED INDUSTRIAL ACTIVITY

#### INSTRUCTIONS

Applicant must be owner or operator (legal entity that controls the facility's operation, rather than the plant/site manager or environmental consultant). The owner or operator that receives coverage is responsible for permit compliance.

Submittals with this RMCNOI must include:

- A Storm Water Pollution Prevention Plan (SWPPP) addressing storm water associated with industrial activity, developed in accordance with the requirements of ACT13 of the General Permit
- A detailed site drawing showing the property layout and indicating the features outlined in ACT4, S-2 of the General Permit
- A United States Geological Survey (USGS) quadrangle map or photocopy, extending at least one-half mile beyond the facility property boundaries with the site location and outfalls outlined or highlighted. The name of the quadrangle map must be shown on all copies. Quadrangle maps can be obtained from the MDEQ, Office of Geology at 601-961-5523
- Plans and specifications for any wastewater treatment facilities necessary to achieve compliance with the requirements of this permit

Additional submittals that may be required with the RMCNOI:

- A Storm Water Pollution Prevention Plan (SWPPP) addressing storm water associated with construction activity, developed in accordance with the requirements of ACT19 of the General Permit.
- Appropriate Section 404 documentation
- If storm water discharges associated with construction activity are proposed, a detailed site drawing showing the property layout and indicating the features outlined in ACT4, S-3 of the General Permit.
- Where previous sampling and analyses have been performed, copies of any existing laboratory data for each process wastewater outfall and each stormwater outfall. If multiple sampling has been performed, provide a summary for each parameter, including sampling dates and the minimum, average and maximum values.

**ALL QUESTIONS MUST BE ANSWERED** (Answer "NA" if not applicable)

#### OWNER INFORMATION

IS APPLICANT THE ☒ OWNER ☒ OPERATOR (Check one or both)

OWNER CONTACT NAME & POSITION: Mr. Jeff Bross, President

OWNER COMPANY NAME: Mark Twain Redi-Mix

OWNER STREET OR P.O. BOX: P.O. Box 430

OWNER CITY: Hannibal STATE: MO ZIP: 63401

OWNER PHONE NUMBER (INCLUDE AREA CODE): (573) 248-9624

CAS

### OPERATOR INFORMATION

OPERATOR CONTACT NAME & POSITION: Mr. Jeff Bross, President

OPERATOR COMPANY: Mark Twain Redi-Mix

OPERATOR STREET OR P.O. BOX: P.O. Box 430

OPERATOR CITY: Hannibal STATE: MO ZIP: 63401

OPERATOR PHONE NUMBER (INCLUDE AREA CODE): (573) 248-9624

### FACILITY INFORMATION

FACILITY NAME: Mark Twain Redi-Mix Plant (address is construction site for the Marina Commerce Center)

PHYSICAL SITE ADDRESS (IF NOT AVAILABLE INDICATE THE NEAREST NAMED ROAD):

STREET: 10480 Marina Drive CITY: Olive Branch

COUNTY: DeSoto ZIP: 38654

NATURE OF BUSINESS (INCLUDE 4 - DIGIT STANDARD INDUSTRIAL CLASSIFICATION CODE (SIC)):

Primary SIC Code: 3273 Secondary SIC Code: NAICS: 327320

LIST ANY OTHER PERMITS NEEDED FOR THIS FACILITY: Not applicable.

PLANT PRODUCTION RATE: 150 cubic yards/hr

RECEIVING STREAM: No direct discharge. Discharge under MSR108170 to Camp Creek.

### STORMWATER ASSOCIATED WITH INDUSTRIAL ACTIVITY

INDICATE ANY ASSOCIATION OR GENERIC SWPPP: \_\_\_\_\_

LIST ANY MATERIAL HANDLING EQUIPMENT, RAW MATERIALS, INTERMEDIATE PRODUCTS, FINAL PRODUCTS, WASTE MATERIALS, BY-PRODUCTS, OR INDUSTRIAL MACHINERY EXPOSED TO STORM WATER (attach additional pages, if necessary): \_\_\_\_\_

### STORMWATER ASSOCIATED WITH CONSTRUCTION ACTIVITY

(To be completed only for activities in which 1 (one) acre or greater will be disturbed)

PRIME CONTRACTOR NAME: Brent Cox

PRIME CONTRACTOR COMPANY: Hillwood Construction Services

PRIME CONTRACTOR STREET OR P.O. BOX: 3000 Turtle Creek Blvd.

PRIME CONTRACTOR CITY: Dallas STATE: TX ZIP: 75219

PRIME CONTRACTOR PHONE NUMBER (INCLUDE AREA CODE): (910) 800-5420

TOTAL ACREAGE THAT WILL BE DISTURBED: 74

ESTIMATED START DATE: July 1, 2020 ESTIMATED COMPLETION DATE: January 31, 2021

INDICATE ANY LOCAL ORDINANCE REQUIREMENTS: Not applicable.

## PROCESS WASTEWATER DISCHARGES

DESCRIBE THE TYPE OF WASTEWATER TREATMENT: Not applicable.

PROVIDE THE LATITUDE AND LONGITUDE OF EACH WASTEWATER OUTFALL (attach additional pages, if necessary):

LATITUDE: \_\_\_\_\_ degrees \_\_\_\_\_ minutes \_\_\_\_\_ seconds LONGITUDE: \_\_\_\_\_ degrees \_\_\_\_\_ minutes \_\_\_\_\_ seconds

PROVIDE THE PROPOSED FREQUENCY OF DISCHARGE PER OUTFALL: \_\_\_\_\_

PROVIDE THE PROPOSED VOLUME OF WASTEWATER DISCHARGED PER OUTFALL (gal/day): \_\_\_\_\_

PROVIDE A MATERIAL SAFETY DATA SHEET ON ALL CHEMICALS USED WHICH POTENTIALLY COULD BE FOUND IN THE WASTEWATER: \_\_\_\_\_

## AIR EMISSIONS

TYPE OF BATCHING: ☒ WET ☐ DRY ☐ CENTRAL MIX

WILL WATER SPRAYS BE USED AT THE FOLLOWING LOCATIONS? STOCKPILES: ☐ YES ☒ NO

AGGREGATE BINS: ☐ YES ☒ NO CONVEYOR TRANSFER POINTS: ☐ YES ☒ NO

CEMENT SILO INFORMATION: NUMBER OF CEMENT SILOS: 2

LOADING METHOD OF SILO: Pneumatic

VOLUME OF EACH SILO: 500 and 680 cubic yards

FACILITY ROADS WILL BE: ☐ PAVED ☒ WATER SPRINKLED ☐ OTHER (SPECIFY) \_\_\_\_\_

CUBIC YARDS OF RAW MATERIALS INPUT INTO PLANT:

SAND 17,500 ROCK 22,500 CEMENT 10,000

DOES THIS FACILITY UTILIZE ON-SITE ROCK CRUSHERS? ☐ YES ☒ NO

IF YES, ARE THEY: ☐ PERMANENT ☐ PORTABLE

**NOTE:** If this NOI includes the construction of new air emissions sources, the approval to construct will expire if construction does not begin within eighteen (18) months from the date of coverage issuance or if construction begins and is suspended for eighteen (18) months or more.

## CERTIFICATION

I certify under penalty of law that this document and all attachments were prepared under my direction or supervision in accordance with a system designed to assure that qualified personnel properly gathered and evaluated the information submitted. Based on my inquiry of the person or persons who manage the system, or those persons directly responsible for gathering the information, the information submitted is to the best of my knowledge and belief, true, accurate and complete. I am aware that there are significant penalties for submitting false information, including the possibility of fine and imprisonment for knowing violations.

Jeff Bross  
Authorized Signature<sup>1</sup>

6-5-20  
Date Signed

Jeff Bross

Printed Name<sup>1</sup>

President  
Title

<sup>1</sup>This application shall be signed according to ACT25, T-5 of the General Permit, as follows:

- For a corporation, by a responsible corporate officer.
- For a partnership, by a general partner.
- For a sole proprietorship, by the proprietor.
- For a municipal, state or other public facility, by principal executive officer, the mayor, or ranking elected official.

Please submit the RMCNOI form to:

Chief, Environmental Permits Division  
MS Department of Environmental Quality, Office of Pollution Control  
P.O. Box 2261  
Jackson, Mississippi 39225



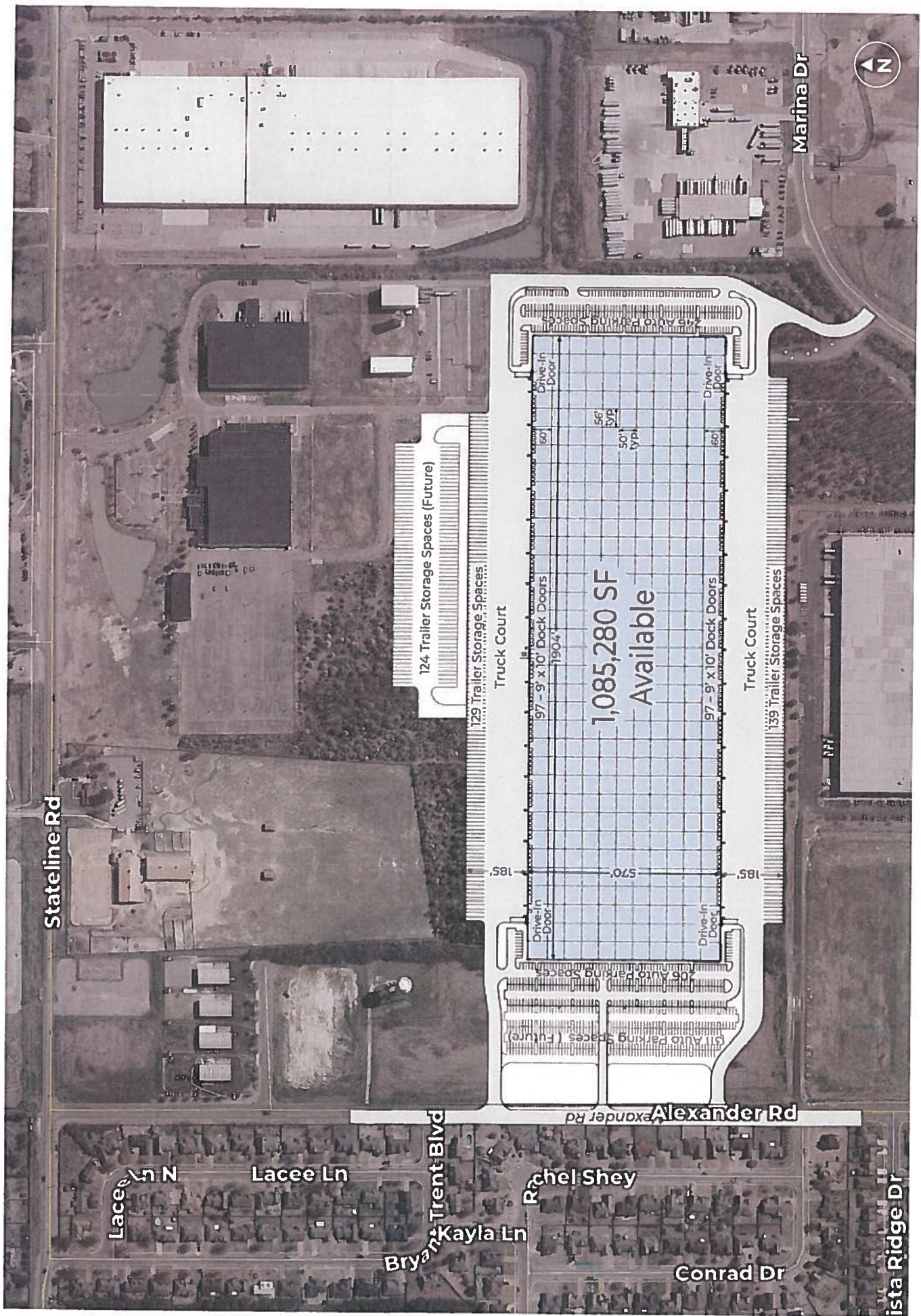

# MARINA COMMERCE CENTER

ALEXANDER RD & STATELINE RD | OLIVE BRANCH, MS 38654

SITE PLAN



AECOM Technical Services, Inc  
1600 Perimeter Park Drive, Suite 400  
Morrisville, North Carolina 27560

919 461 1100 tel  
919 461 1415 fax

June 8, 2020

Ms. Sherryl Couch  
Environmental Permits Division  
MS Department of Environmental Quality  
Office of Pollution Control  
P.O. Box 2261  
Jackson, MS 39225

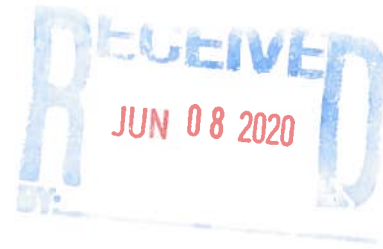

**RE: Ready-Mix Concrete General Permit Application for Mark Twain Redi-Mix,  
Olive Branch, DeSoto County, Mississippi**

Dear Ms. Couch,

AECOM has been retained by Mark Twain Redi-Mix to prepare a Ready-Mix Concrete General Permit application for the operation of a batch concrete plant in Olive Branch, DeSoto County, Mississippi. This submittal includes one (1) copy of the applicable permit application forms. Note that this package was also submitted electronically on the MDEQ NOI eSubmittals page.

The Mark Twain Redi-Mix Plant will be operating in concurrence with the construction of another facility. The location is the construction site for the Marina Commerce Center in Olive Branch and the general contractor for the site is Hillwood Construction Services. Therefore, Mark Twain Redi-Mix storm water activities on this site will be covered under the Marina Commerce Center construction storm water permit MSR108170 and associated SWPPP. General contractor information for storm water activities is included in the forms.

If you have any questions regarding the forms package for this application, please contact me via cell phone or email as noted below my signature, or Jeff Bross, President of Mark Twain Redi-Mix at (573) 248-9624.

Sincerely,

Elizabeth J. Robinson, P.E.  
Project Manager  
mobile: (919) 608-9143  
[Libby.Robinson@aecom.com](mailto:Libby.Robinson@aecom.com)

enclosures

cc: Jeff Bross, President  
Mark Twain Redi-Mix  
P.O. Box 430  
Hannibal, MO 63401