

RECEIVED
NOV 16 2020

MDEQ



MISSISSIPPI DEPARTMENT OF
ENVIRONMENTAL QUALITY

**MINING NOTICE OF INTENT (MNOI)
FOR COVERAGE UNDER
MINING STORM WATER, DEWATERING AND NO DISCHARGE
GENERAL PERMIT MSR32 _____
(Number to be assigned by State)**

File at least 30 days prior to the commencement of mining; 15 days if a Storm Water Pollution Prevention Plan (SWPPP) is already on file and mine dewatering is not proposed. Lateral expansion of an existing mine that has general permit coverage requires the submittal of the Major Modification Form, not a new MNOI. However, modification of the existing SWPPP to include the expansion is required. Discharge of storm water or impounded water associated with mining or the operation of a wastewater recirculation system with no discharge without written notification of coverage from MDEQ is a violation of State Law.

If the company seeking coverage is a corporation, a limited liability company, a partnership, or a business trust, attach proof of its registration with the Mississippi Secretary of State and/or its Certificate of Good Standing. This registration or Certificate of Good Standing must be dated within twelve (12) months of the date of the submittal of this coverage form. Coverage will be issued in the company name as it is registered with the Mississippi Secretary of State.

Please indicate the activities to be covered by this MNOI (check all that apply).

- Storm Water Discharges Associated with Mining Mine Dewatering
 Wastewater Recirculation System with No Discharge

The appropriate section of the MNOI must be completed if the applicant proposes to discharge storm water, discharge impounded mine water (dewatering) and/or operate a wastewater recirculation system with no discharge.

A site-specific Storm Water Pollution Prevention Plan (SWPPP) developed in accordance with ACT5 of the General Permit and a United States Geological Survey (USGS) quadrangle map or photocopy, indicating the site location and outfalls must be included with the MNOI submittal. The name of the quadrangle map must be shown on all copies. Quadrangle maps can be obtained from the MDEQ, Office of Geology at 601-961-5523. Additional submittals may include the following (check all that apply).

- Section 404 Documentation Notice of Exempt Operations Form
 Dam/Reservoir Safety Permit or Written Authorization

ALL INFORMATION MUST BE COMPLETED (indicate "N/A" where not applicable)

5. MDEQ Deficiency Comment:

MDEQ requests that the site map include all erosion controls and demonstrate buffer zone compliance, in accordance with ACT5 T-4 (1).

HPS Response to MDEQ comment #5:

The attached SWPPP and figures have been revised to address MDEQ comment and present storm water controls in more detail to prevent offsite migration of sediment and required buffer zone.

6. MDEQ Deficiency:

MDEQ requests additional information about the frequency of flooding of the site, to evaluate the likelihood of this area flooding and discharging stormwater or process water.

MDEQ requests additional information about previous mining operations on the site in order to have a better understanding of the overall big picture impacts of this project.

HPS Response to item #6:

Interviews with the previous property owner and aerial photography (circa 1997) indicate the property does not flood and that mining operations, access roadways, two-story house (3000 sqft) with carport, shop (2000 sqft), and other site improvements were made twenty years prior to purchase by HPS.

We appreciate your understanding and assistance in this matter. If you have questions or need additional information, please contact me at 601-798-2981 or Jay Musgrove at 601-818-3558.

Sincerely,

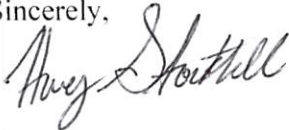

Huey Stockstill, Jr.
President

Attachments: Revised NOI, Revised SWPPP

MSR32 _____

(NUMBER TO BE ASSIGNED BY STATE)

APPLICANT IS THE: OWNER OPERATOR

OWNER CONTACT INFORMATION

OWNER CONTACT PERSON: Huey P. Stockstill Jr.

OWNER COMPANY LEGAL NAME: Huey P. Stockstill, LLC

OWNER STREET OR P. O. BOX: P.O. Box 758

OWNER CITY: Piayune STATE: MS ZIP: 39466

OWNER PHONE #: (601) 798-2981 OWNER EMAIL: hueyjr@hueystockstill.com

OPERATOR CONTACT INFORMATION

OPERATOR CONTACT PERSON: Huey P. Stockstill, Jr.

OPERATOR COMPANY LEGAL NAME: Huey P. Stockstill, LLC

OPERATOR STREET OR P. O. BOX: P.O. Box 758

OPERATOR CITY: Picayune STATE: MS ZIP: 39466

OPERATOR PHONE #: (601) 798-2981 OPERATOR EMAIL: hueyjr@hueystockstill.com

MINE INFORMATION

MINE NAME: Boone Mine

MINE SITE ADDRESS (If the physical address is not available, please indicate nearest named road.)

Street: 47 Troy Boone Road

City: Picayune State: MS County: Pearl River Zip: 39466

 /4 OF /4 OF SECTION 19.28.29 , TOWNSHIP 5S , RANGE 18W

MINE SITE TRIBAL LAND ID (N/A If not applicable): N/A

ATTACH A USGS QUAD MAP, EXTENDING ½ MILE BEYOND FACILITY, OUTLINING THE MINE BOUNDARIES
(Maps can be obtained from the Mississippi Office of Geology. For information call 601-961-5523).

LATITUDE: 30 degrees 34 minutes 37 seconds LONGITUDE: 89 degrees 47 minutes 31 seconds

LAT & LONG DATA SOURCE (GPS (Please GPS Entrance Gate) or Map Interpolation): Map Interpolation

TOTAL ACREAGE: 90 MATERIAL TO BE MINED: Sand and Gravel

WILL HYDRAULIC DREDGING BE USED? YES NO

WASHING OF SAND/GRAVEL? YES NO

ESTIMATED START DATE: 12/1/2020
YYYY-MM-DD
SIC CODE 1442

ESTIMATED END DATE: 12/1/2030
YYYY-MM-DD
NAICS CODE 212321

RECEIVING STREAM INFORMATION

NEAREST NAMED RECEIVING STREAM: Pearl River

IS RECEIVING STREAM ON MISSISSIPPI'S 303(D) LIST OF IMPAIRED WATER BODIES? (The 303(d) list of impaired waters and TMDL stream segments may be found of MDEQ's website: http://www.deq.state.ms.us/MDEQ.nsf/page/TWB_Total_Maximum_Daily_Load_Section) YES NO

HAS A TMDL BEEN ESTABLISHED FOR THE RECEIVING STREAM SEGMENT? YES NO

COMPLETE IF STORM WATER DISCHARGE IS PROPOSED

ATTACH A STORM WATER POLLUTION PREVENTION PLAN (SEE PERMIT FOR REQUIREMENTS)

IDENTIFY THE ASSOCIATION OR GENERIC SWPPP ON FILE AT MDEQ: Not applicable.

The mining operation will utilize a no discharge wastewater recirculation system.

COMPLETE IF WASTEWATER RECIRCULATION SYSTEM WITH NO DISCHARGE IS PROPOSED

DISTANCE BETWEEN RECIRCULATION POND(S) AND PROPERTY LINE: _____ (FT)
(MUST BE AT LEAST 150 FEET)

NUMBER OF RECIRCULATION POND(S): _____

STORAGE CAPACITY OF EACH RECIRCULATION POND(S): _____ (FT³)

COMPLETE IF MINE DEWATERING IS PROPOSED

ESTIMATED DEWATERING VOLUME: not applicable (GAL/DAY)

NAME AND ADDRESS OF THE RECIPIENT OF THE DISCHARGE MONITORING REPORTS (DMRs), IF DIFFERENT FROM SIGNATORY: _____

DOCUMENTATION OF COMPLIANCE WITH OTHER REGULATIONS/REQUIREMENTS

Coverage under this general permit will not be granted until all other required MDEQ permits and approvals are addressed.

WILL THE CONSTRUCTION OR OPERATION OF THIS MINE INVOLVE THE RE-ROUTING, FILLING OR CROSSING OF A WATER CONVEYANCE OF ANY KIND? YES NO

If yes, contact the U.S. Army Corps of Engineers' Regulatory Branch for permitting requirements. If the mine requires a Corps of Engineers Section 404 permit, provide appropriate documentation with this MNOI that:

- The mine has been approved by individual permit, or
- The work will be covered by a nationwide permit and NO NOTIFICATION to the Corps is required, or
- The work will be covered by a nationwide or general permit and NOTIFICATION to the Corps is required.

LIST ANY NPDES PERMIT NO(s). _____ GEOLOGY APPLICATION/PERMIT NO. _____

LIST OTHER GEOLOGY PERMIT NUMBERS THAT APPLY TO COVERAGE AREA _____

IS THE MINE LESS THAN 4 ACRES AND GREATER THAN 1320 FEET FROM ANOTHER MINE?

- YES A "Notice of Exempt Operations" Form must be included with the MNOI or proof of prior submission, if previously submitted to the Office of Geology.
- NO A "Notice of Intent to Mine Class I or Class II Materials" Form must be filed before coverage will be granted under the Mining General Permit. For information on Office of Geology requirements, call 601-961-5515.

LIST ANY LOCAL STORM WATER ORDINANCES WITH WHICH THE OPERATIONS MUST COMPLY AND SUBMIT ANY ASSOCIATED APPROVAL DOCUMENTATION. _____

IF IMPOUNDMENTS WILL BE CONSTRUCTED ABOVE NATURAL SURFACE ELEVATIONS, INDICATE WHICH, IF ANY, OF THE FOLLOWING APPLY.

- The impoundment will be constructed with a peripheral dam or levee 8 feet or greater in height, measured from the lowest elevation of its toe.
- The impoundment will have a maximum storage volume greater than 25 acre-feet.
- The impoundment will impound a watercourse with a continuous flow.
- The impoundment has the potential to threaten downstream lives or man-made structures.

If any of the impoundments meet any of the above criteria, the applicant will be required to obtain written authorization from MDEQ, Dam Safety Division before coverage will be granted under the Mining General Permit.

I certify under penalty of law that this document and all attachments were prepared under my direction or supervision in accordance with a system designed to assure that qualified personnel properly gathered and evaluated the information submitted. Based on my inquiry of the person or persons who manage the system, or those persons directly responsible for gathering the information, the information submitted is, to the best of my knowledge and belief, true, accurate and complete. I am aware that there are significant penalties for submitting false information, including the possibility of fine and imprisonment for knowing violations.

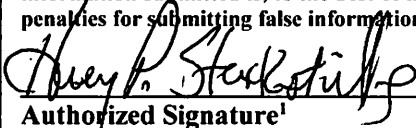

Authorized Signature¹

11/13/20

Date

Huey P. Stockstill

President

Printed Name

Title

¹This application shall be signed according to the General Permit, Act 15, T-4 as follows:

- For a corporation, by a responsible corporate officer.
- For a partnership, by a general partner.
- For a sole proprietorship, by the proprietor.
- For a municipal, state or other public facility, by either a principal executive officer, the mayor, or ranking elected official.
- Duly Authorized Representative

Please submit this form to: Chief, Environmental Permits Division
MDEQ, Office of Pollution Control
P.O. Box 2261
Jackson, Mississippi 39225

DOCUMENTATION OF COMPLIANCE WITH OTHER REGULATIONS/REQUIREMENTS

Coverage under this general permit will not be granted until all other required MDEQ permits and approvals are addressed.

WILL THE CONSTRUCTION OR OPERATION OF THIS MINE INVOLVE THE RE-ROUTING, FILLING OR CROSSING OF A WATER CONVEYANCE OF ANY KIND? YES NO

If yes, contact the U.S. Army Corps of Engineers' Regulatory Branch for permitting requirements. If the mine requires a Corps of Engineers Section 404 permit, provide appropriate documentation with this MNOI that:

- The mine has been approved by individual permit, or
- The work will be covered by a nationwide permit and NO NOTIFICATION to the Corps is required, or
- The work will be covered by a nationwide or general permit and NOTIFICATION to the Corps is required.

LIST ANY NPDES PERMIT NO(s) _____ GEOLOGY APPLICATION/PERMIT NO. _____

LIST OTHER GEOLOGY PERMIT NUMBERS THAT APPLY TO COVERAGE AREA _____

IS THE MINE LESS THAN 4 ACRES AND GREATER THAN 1320 FEET FROM ANOTHER MINE?

- YES A "Notice of Exempt Operations" Form must be included with the MNOI or proof of prior submission, if previously submitted to the Office of Geology.
- NO A "Notice of Intent to Mine Class I or Class II Materials" Form must be filed before coverage will be granted under the Mining General Permit. For information on Office of Geology requirements, call 601-961-5515.

LIST ANY LOCAL STORM WATER ORDINANCES WITH WHICH THE OPERATIONS MUST COMPLY AND SUBMIT ANY ASSOCIATED APPROVAL DOCUMENTATION. _____

IF IMPOUNDMENTS WILL BE CONSTRUCTED ABOVE NATURAL SURFACE ELEVATIONS, INDICATE WHICH, IF ANY, OF THE FOLLOWING APPLY.

- The impoundment will be constructed with a peripheral dam or levee 8 feet or greater in height, measured from the lowest elevation of its toe.
- The impoundment will have a maximum storage volume greater than 25 acre-feet.
- The impoundment will impound a watercourse with a continuous flow.
- The impoundment has the potential to threaten downstream lives or man-made structures.

If any of the impoundments meet any of the above criteria, the applicant will be required to obtain written authorization from MDEQ, Dam Safety Division before coverage will be granted under the Mining General Permit.

I certify under penalty of law that this document and all attachments were prepared under my direction or supervision in accordance with a system designed to assure that qualified personnel properly gathered and evaluated the information submitted. Based on my inquiry of the person or persons who manage the system, or those persons directly responsible for gathering the information, the information submitted is, to the best of my knowledge and belief, true, accurate and complete. I am aware that there are significant penalties for submitting false information, including the possibility of fine and imprisonment for knowing violations.

_____	11/13/20
Authorized Signature¹	Date
Huey P. Stockstill	President
_____	_____
Printed Name	Title

¹This application shall be signed according to the General Permit, Act 15, T-4 as follows:

- For a corporation, by a responsible corporate officer.
- For a partnership, by a general partner.
- For a sole proprietorship, by the proprietor.
- For a municipal, state or other public facility, by either a principal executive officer, the mayor, or ranking elected official.
- Duly Authorized Representative

Please submit this form to: Chief, Environmental Permits Division
MDEQ, Office of Pollution Control
P.O. Box 2261
Jackson, Mississippi 39225

The mine will be managed as a "No Discharge" operation. An elevated (enough foundation base for roadway integrity) earthen roadway (mine haul road) will be placed around the perimeter of the active mining area for site access. Mined and washed aggregate material stock-piles will be placed inside the perimeter of the earthen roadway (mine haul road) and active mining area to prevent sediment migrating offsite. All surface areas around the inside perimeter of the earthen roadway (mine haul road) will be sloped to direct all waters (storm water, mining waste water) into the active mining area to prevent an offsite discharge of storm water or mining waste water (aggregate wash water, dredge water). Storm water controls and a 50-foot buffer zone will be utilized around the outside perimeter of the elevated earthen roadway (mine haul road) of the mining operation to prevent impacts from sediment migrating offsite into sensitive areas (wetlands, streams). In accordance with ACT9 L-2 (3) requirement of 300-foot buffer zone, the proposed mining permit area to the south has a minimum of a 300-foot buffer zone from the Pearl River which is a navigable waterway. All mining activities will have a buffer zone greater than 300-foot as required for navigable waterway and dwellings. As a storm water control BMP will utilize existing onsite grass areas, vegetative areas, and vegetative debris windrow around the outside perimeter of the earthen roadway (mine haul road) to mitigate sediment migrating into sensitive areas. In addition, appropriate seasonal grass will be maintained in the existing grass areas around the perimeter area to prevent sediment migrating offsite (see SWPPP & figures). Vegetation & Vegetative debris windrow BMP in some areas around the outside perimeter of the earthen roadway to serve as a filter and prevent sediment migrating into sensitive areas or offsite (see SWPPP figures). The existing access road will be utilized as the entrance/exit (mine haul road) and aggregate will be placed on the road as a BMP to prevent offsite migration of sediment onto public roadways. The roadway is included in 90-acres. See figures 1C and 2 for placement of mine haul road around mining perimeter and storm water controls.

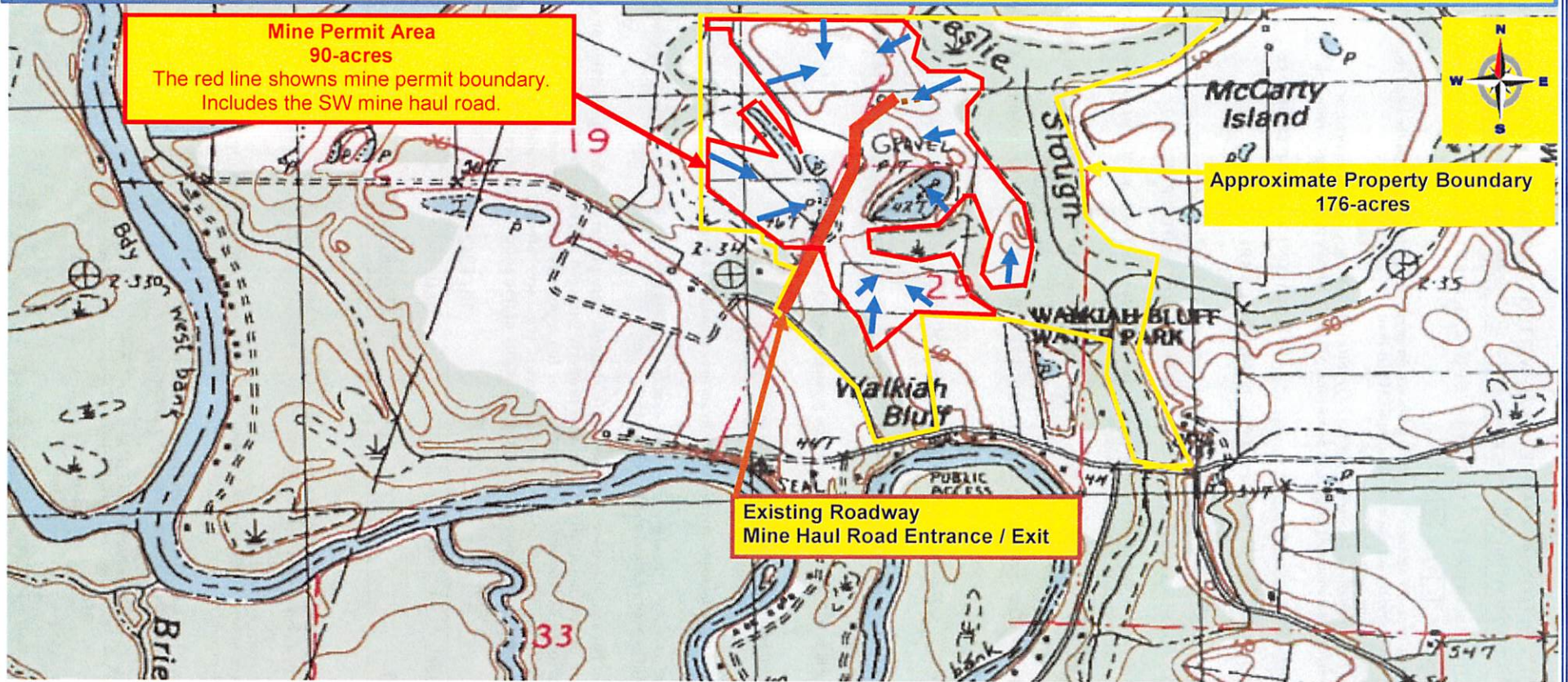

**Mine Permit Area
90-acres**
The red line shows mine permit boundary.
Includes the SW mine haul road.

**Approximate Property Boundary
176-acres**

**Existing Roadway
Mine Haul Road Entrance / Exit**

Key		→ Direction of Storm Water Flow No Discharge Operation
	Property Boundary	
	Mining Permit Boundary	
	Mine Haul Road	

Topo Map
Boone Mine
Pearl River County
Huey P. Stockstill, LLC
47 Troy Boone Rd
Picayune, MS 39466

Reference: Industrial 7.5 Minute Quadrangle
Section 19, 28, 29, Township 5 South
Range 18 West, Pearl River County, MS

Date:	11/11/2020	Project #	Boone Mine
Scale:	1" = 1100'	Figure:	1

