

AI: 80104

MSR32 2941

(NUMBER TO BE ASSIGNED BY STATE)

APPLICANT IS THE:  OWNER  OPERATOR

OWNER CONTACT INFORMATION

OWNER CONTACT PERSON: Tommy Harrison
OWNER COMPANY LEGAL NAME: N/A
OWNER STREET OR P. O. BOX: 4405 Hwy 21 North
OWNER CITY: Forest STATE: MS ZIP: 39074
OWNER PHONE #: (601) 507-1886 OWNER EMAIL:

OPERATOR CONTACT INFORMATION

OPERATOR CONTACT PERSON: Ryan Sorey
OPERATOR COMPANY LEGAL NAME: Sorey Dirt Services, Inc.
OPERATOR STREET OR P. O. BOX: 1600 McMillan Road
OPERATOR CITY: Forest STATE: MS ZIP: 39074
OPERATOR PHONE #: (601) 507-2358 OPERATOR EMAIL:

MINE INFORMATION

MINE NAME: Harrison Mine
MINE SITE ADDRESS (If the physical address is not available, please indicate nearest named road.)
Street: MS Hwy 21
City: Forest State: MS County: Scott Zip: 39074
SW 1 /4 OF SW 1 /4 OF SECTION 23 , TOWNSHIP 7 N , RANGE 8 E
MINE SITE TRIBAL LAND ID (N/A If not applicable): N/A
ATTACH A USGS QUAD MAP, EXTENDING 1/2 MILE BEYOND FACILITY, OUTLINING THE MINE BOUNDARIES
LATITUDE: 32 degrees 25 minutes 41 seconds LONGITUDE: 89 degrees 26 minutes 46 seconds
LAT & LONG DATA SOURCE (GPS (Please GPS Entrance Gate) or Map Interpolation): Map Interpolation
TOTAL ACREAGE: 4 MATERIAL TO BE MINED: Sand/Clay
WILL HYDRAULIC DREDGING BE USED? [ ] YES [X] NO
WASHING OF SAND/GRAVEL? [ ] YES [X] NO

m- received via email 9.2.21

ESTIMATED START DATE: 2021-10-01

YYYY-MM-DD

ESTIMATED END DATE: 2023-12-31

YYYY-MM-DD

SIC CODE 1442

NAICS CODE 212321

**RECEIVING STREAM INFORMATION**

NEAREST NAMED RECEIVING STREAM: Tallabogue Canal

IS RECEIVING STREAM ON MISSISSIPPI'S 303(D) LIST OF IMPAIRED WATER BODIES? (The 303(d) list of impaired waters and TMDL stream segments may be found of MDEQ's website: [http://www.deq.state.ms.us/MDEQ.nsf/page/TWB\\_Total\\_Maximum\\_Daily\\_Load\\_Section](http://www.deq.state.ms.us/MDEQ.nsf/page/TWB_Total_Maximum_Daily_Load_Section))  YES  NO

HAS A TMDL BEEN ESTABLISHED FOR THE RECEIVING STREAM SEGMENT?  YES  NO

**COMPLETE IF STORM WATER DISCHARGE IS PROPOSED**

ATTACH A STORM WATER POLLUTION PREVENTION PLAN (SEE PERMIT FOR REQUIREMENTS)

IDENTIFY THE ASSOCIATION OR GENERIC SWPPP ON FILE AT MDEQ: \_\_\_\_\_

SEE ATTACHED

\_\_\_\_\_

\_\_\_\_\_

**COMPLETE IF WASTEWATER RECIRCULATION SYSTEM WITH NO DISCHARGE IS PROPOSED**

DISTANCE BETWEEN RECIRCULATION POND(S) AND PROPERTY LINE: \_\_\_\_\_ (FT)  
(MUST BE AT LEAST 150 FEET)

NUMBER OF RECIRCULATION POND(S): \_\_\_\_\_

STORAGE CAPACITY OF EACH RECIRCULATION POND(S): \_\_\_\_\_ (FT<sup>3</sup>)

**COMPLETE IF MINE DEWATERING IS PROPOSED**

ESTIMATED DEWATERING VOLUME: \_\_\_\_\_ (GAL/DAY)

NAME AND ADDRESS OF THE RECIPIENT OF THE DISCHARGE MONITORING REPORTS (DMRs), IF DIFFERENT FROM SIGNATORY: \_\_\_\_\_

\_\_\_\_\_

**DOCUMENTATION OF COMPLIANCE WITH OTHER REGULATIONS/REQUIREMENTS**

Coverage under this general permit will not be granted until all other required MDEQ permits and approvals are addressed.

WILL THE CONSTRUCTION OR OPERATION OF THIS MINE INVOLVE THE RE-ROUTING, FILLING OR CROSSING OF A WATER CONVEYANCE OF ANY KIND?  YES  NO

If yes, contact the U.S. Army Corps of Engineers' Regulatory Branch for permitting requirements. If the mine requires a Corps of Engineers Section 404 permit, provide appropriate documentation with this MNOI that:

- The mine has been approved by individual permit, or
- The work will be covered by a nationwide permit and NO NOTIFICATION to the Corps is required, or
- The work will be covered by a nationwide or general permit and NOTIFICATION to the Corps is required.

LIST ANY NPDES PERMIT NO(s). N/A GEOLOGY APPLICATION/PERMIT NO. Exempt Operation

LIST OTHER GEOLOGY PERMIT NUMBERS THAT APPLY TO COVERAGE AREA \_\_\_\_\_

IS THE MINE LESS THAN 4 ACRES AND GREATER THAN 1320 FEET FROM ANOTHER MINE?

- YES A "Notice of Exempt Operations" Form must be included with the MNOI or proof of prior submission, if previously submitted to the Office of Geology.
- NO A "Notice of Intent to Mine Class I or Class II Materials" Form must be filed before coverage will be granted under the Mining General Permit. For information on Office of Geology requirements, call 601-961-5515.

LIST ANY LOCAL STORM WATER ORDINANCES WITH WHICH THE OPERATIONS MUST COMPLY AND SUBMIT ANY ASSOCIATED APPROVAL DOCUMENTATION. N/A

IF IMPOUNDMENTS WILL BE CONSTRUCTED ABOVE NATURAL SURFACE ELEVATIONS, INDICATE WHICH, IF ANY, OF THE FOLLOWING APPLY.

- The impoundment will be constructed with a peripheral dam or levee 8 feet or greater in height, measured from the lowest elevation of its toe.
- The impoundment will have a maximum storage volume greater than 25 acre-feet.
- The impoundment will impound a watercourse with a continuous flow.
- The impoundment has the potential to threaten downstream lives or man-made structures.

If any of the impoundments meet any of the above criteria, the applicant will be required to obtain written authorization from MDEQ, Dam Safety Division before coverage will be granted under the Mining General Permit.

I certify under penalty of law that this document and all attachments were prepared under my direction or supervision in accordance with a system designed to assure that qualified personnel properly gathered and evaluated the information submitted. Based on my inquiry of the person or persons who manage the system, or those persons directly responsible for gathering the information, the information submitted is, to the best of my knowledge and belief, true, accurate and complete. I am aware that there are significant penalties for submitting false information, including the possibility of fine and imprisonment for knowing violations.

Ryan Sorey 8/31/21  
Authorized Signature<sup>1</sup> Date  
Ryan Sorey President  
Printed Name Title

<sup>1</sup>This application shall be signed according to the General Permit, Act 15, T-4 as follows:

- For a corporation, by a responsible corporate officer.
- For a partnership, by a general partner.
- For a sole proprietorship, by the proprietor.
- For a municipal, state or other public facility, by either a principal executive officer, the mayor, or ranking elected official.
- Duly Authorized Representative

Please submit this form to: Chief, Environmental Permits Division  
MDEQ, Office of Pollution Control  
P.O. Box 2261  
Jackson, Mississippi 39225

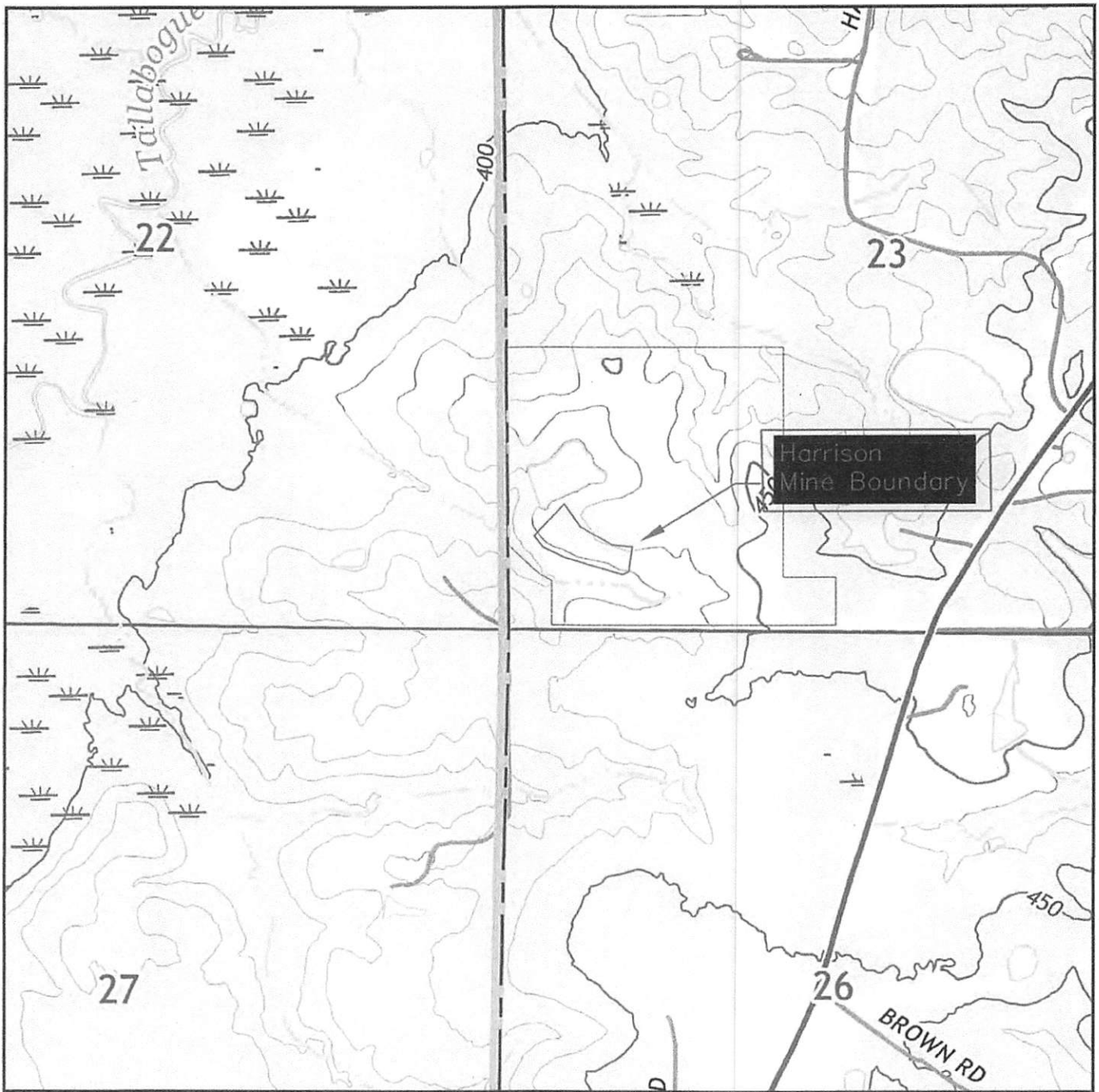

Harrison Mine is located in part of the SW 1/4 of the SW 1/4 of Section 23 Township 7 North, Range 8 East, Scott County, MS. and contains 4.0 acres more or less.

Entrance is located at:  
32° 25' 41" North, 89° 26' 46" West

Harrison Mine is located within the Harpersville Quadrangle.



SCALE: 1" = 1000'

Harrison Mine  
Topographic Mapping

for  
Sorey Dirt Services, Inc.



MISSISSIPPI DEPARTMENT OF  
ENVIRONMENTAL QUALITY

**MINING NOTICE OF INTENT (MNOI)  
FOR COVERAGE UNDER  
MINING STORM WATER, DEWATERING AND NO DISCHARGE  
GENERAL PERMIT MSR32 \_\_\_\_\_  
(Number to be assigned by State)**

**File at least 30 days prior to the commencement of mining; 15 days if a Storm Water Pollution Prevention Plan (SWPPP) is already on file and mine dewatering is not proposed. Lateral expansion of an existing mine that has general permit coverage requires the submittal of the Major Modification Form, not a new MNOI. However, modification of the existing SWPPP to include the expansion is required. Discharge of storm water or impounded water associated with mining or the operation of a wastewater recirculation system with no discharge without written notification of coverage from MDEQ is a violation of State Law.**

**If the company seeking coverage is a corporation, a limited liability company, a partnership, or a business trust, attach proof of its registration with the Mississippi Secretary of State and/or its Certificate of Good Standing. This registration or Certificate of Good Standing must be dated within twelve (12) months of the date of the submittal of this coverage form. Coverage will be issued in the company name as it is registered with the Mississippi Secretary of State.**

**Please indicate the activities to be covered by this MNOI (check all that apply).**

- Storm Water Discharges Associated with Mining       Mine Dewatering  
 Wastewater Recirculation System with No Discharge

**The appropriate section of the MNOI must be completed if the applicant proposes to discharge storm water, discharge impounded mine water (dewatering) and/or operate a wastewater recirculation system with no discharge.**

**A site-specific Storm Water Pollution Prevention Plan (SWPPP) developed in accordance with ACT5 of the General Permit and a United States Geological Survey (USGS) quadrangle map or photocopy, indicating the site location and outfalls must be included with the MNOI submittal. The name of the quadrangle map must be shown on all copies. Quadrangle maps can be obtained from the MDEQ, Office of Geology at 601-961-5523. Additional submittals may include the following (check all that apply).**

- Section 404 Documentation       Notice of Exempt Operations Form  
 Dam/Reservoir Safety Permit or Written Authorization

**ALL INFORMATION MUST BE COMPLETED (indicate "N/A" where not applicable)**