

AI: 80797

MSR10 8025

(NUMBER TO BE ASSIGNED BY STATE)

APPLICANT IS THE: OWNER PRIME CONTRACTOR

OWNER CONTACT INFORMATION

OWNER CONTACT PERSON: J.D. Hardy
OWNER COMPANY LEGAL NAME: Mississippi State University
OWNER STREET OR P.O. BOX: P.O. Box 5208
OWNER CITY: Mississippi State STATE: MS ZIP: 39762
OWNER PHONE #: (662) 325-5899 OWNER EMAIL: JHardy@physplant.msstate.edu

PRIME CONTRACTOR CONTACT INFORMATION

PRIME CONTRACTOR CONTACT PERSON:
PRIME CONTRACTOR COMPANY LEGAL NAME:
PRIME CONTRACTOR STREET OR P.O. BOX:
PRIME CONTRACTOR CITY: STATE: ZIP:
PRIME CONTRACTOR PHONE #: () PRIME CONTRACTOR EMAIL:

FACILITY SITE INFORMATION

FACILITY SITE NAME: Humphrey Coliseum
FACILITY SITE ADDRESS (If the physical address is not available, please indicate the nearest named road. For linear projects indicate the beginning of the project and identify all counties the project traverses.)
STREET: 55 Bailey Howell Drive
CITY: Mississippi State STATE: MS COUNTY: Oktibbeha ZIP: 39762
FACILITY SITE TRIBAL LAND ID (N/A If not applicable): N/A
LATITUDE: 88 degrees 47 minutes 38 seconds LONGITUDE: 33 degrees 27 minutes 41 seconds
LAT & LONG DATA SOURCE (GPS (Please GPS Project Entrance/Start Point) or Map Interpolation): Google Earth
TOTAL ACREAGE THAT WILL BE DISTURBED: 11.25
IS THIS PART OF A LARGER COMMON PLAN OF DEVELOPMENT? YES NO
IF YES, NAME OF LARGER COMMON PLAN OF DEVELOPMENT: AND PERMIT COVERAGE NUMBER: MSR10
ESTIMATED CONSTRUCTION PROJECT START DATE: 2021-02-15
ESTIMATED CONSTRUCTION PROJECT END DATE: 2024-08-01
DESCRIPTION OF CONSTRUCTION ACTIVITY: Site and building demolition and additions and site improvements
PROPOSED DESCRIPTION OF PROPERTY USE AFTER CONSTRUCTION HAS BEEN COMPLETED: New Building Additions, parking areas, and campus street
SIC Code NAICS Code

m - received via email 1.20.22

- 025439

NEAREST NAMED RECEIVING STREAM: Sand Creek

IS RECEIVING STREAM ON MISSISSIPPI'S 303(d) LIST OF IMPAIRED WATER BODIES? (The 303(d) list of impaired waters and TMDL stream segments may be found on MDEQ's web site: http://www.deq.state.ms.us/MDEQ.nsf/page/TWB_Total_Maximum_Daily_Load_Section) YES NO

HAS A TMDL BEEN ESTABLISHED FOR THE RECEIVING STREAM SEGMENT? YES NO

ARE THERE RECREATIONAL STREAMS, PRIVATE/PUBLIC PONDS OR LAKES WITHIN ½ MILE DOWNSTREAM OF PROJECT BOUNDARY THAT MAY BE IMPACTED BY THE CONSTRUCTION ACTIVITY? YES NO

EXISTING DATA DESCRIBING THE SOIL (for linear projects please describe in SWPPP):

Per NRCS Soil Survey: (1) Oklabeha Soils (2) Sumter Silty Clay Loam (3) Freestone Fine Sandy Loam (4) Kipling and Sumter Soil

WILL FLOCCULANTS BE USED TO TREAT TURBIDITY IN STORM WATER? YES NO

IF YES, INDICATE THE TYPE OF FLOCCULANT. ANIONIC POLYACRYLAMIDE (PAM)
 OTHER _____

IF YES, DOES THE SWPPP DESCRIBE THE METHOD OF INTRODUCTION, THE LOCATION OF INTRODUCTION AND THE LOCATION OF WHERE FLOCCULATED MATERIAL WILL SETTLE? YES NO

¹Acreage for subdivision development includes areas disturbed by construction of roads, utilities and drainage. Additionally, a housesite of at least 10,000 ft² per lot (entire lot, if smaller) shall be included in calculating acreage disturbed.

DOCUMENTATION OF COMPLIANCE WITH OTHER REGULATIONS/REQUIREMENTS
COVERAGE UNDER THIS PERMIT WILL NOT BE GRANTED UNTIL ALL OTHER REQUIRED
MDEQ PERMITS AND APPROVALS ARE SATISFACTORILY ADDRESSED

IS LCNOI FOR A FACILITY THAT WILL REQUIRE OTHER PERMITS?

YES NO

IF YES, CHECK ALL THAT APPLY: AIR HAZARDOUS WASTE PRETREATMENT

WATER STATE OPERATING INDIVIDUAL NPDES OTHER: _____

IS THE PROJECT REROUTING, FILLING OR CROSSING A WATER CONVEYANCE OF ANY KIND? (If yes, contact the U.S. Army Corps of Engineers' Regulatory Branch for permitting requirements.) YES NO

IF THE PROJECT REQUIRES A CORPS OF ENGINEER SECTION 404 PERMIT, PROVIDE APPROPRIATE DOCUMENTATION THAT:

- The project has been approved by individual permit, or
- The work will be covered by a nationwide permit and NO NOTIFICATION to the Corps is required, or
- The work will be covered by a nationwide or general permit and NOTIFICATION to the Corps is required

IS A LAKE REQUIRING THE CONSTRUCTION OF A DAM BEING PROPOSED? (If yes, provide appropriate approval documentation from MDEQ Office of Land and Water, Dam Safety.) YES NO

IF THE PROJECT IS A SUBDIVISION OR A COMMERCIAL DEVELOPMENT, HOW WILL SANITARY SEWAGE BE DISPOSED? Check one of the following and attach the pertinent documents.

- Existing Municipal or Commercial System. Please attach plans and specifications for the collection system and the associated "Information Regarding Proposed Wastewater Projects" form or approval from County Utility Authority in Hancock, Harrison, Jackson, Pearl River and Stone Counties. If the plans and specifications can not be provided at the time of LCNOI submittal, MDEQ will accept written acknowledgement from official(s) responsible for wastewater collection and treatment that the flows generated from the proposed project can and will be transported and treated properly. The letter must include the estimated flow.
- Collection and Treatment System will be Constructed. Please attach a copy of the cover of the NPDES discharge permit from MDEQ or indicate the date the application was submitted to MDEQ (Date: _____.)
- Individual Onsite Wastewater Disposal Systems for Subdivisions Less than 35 Lots. Please attach a copy of the Letter of General Acceptance from the Mississippi State Department of Health or certification from a registered professional engineer that the platted lots should support individual onsite wastewater disposal systems.
- Individual Onsite Wastewater Disposal Systems for Subdivisions Greater than 35 Lots. A determination of the feasibility of installing a central sewage collection and treatment system must be made by MDEQ. A copy of the response from MDEQ concerning the feasibility study must be attached. If a central collection and wastewater system is not feasible, then please attach a copy of the Letter of General Acceptance from the State Department of Health or certification from a registered professional engineer that the platted lots should support individual onsite wastewater disposal systems.

INDICATE ANY LOCAL STORM WATER ORDINANCE WITH WHICH THE PROJECT MUST COMPLY:

I certify under penalty of law that this document and all attachments were prepared under my direction or supervision in accordance with a system designed to assure that qualified personnel properly gathered and evaluated the information submitted. Based on my inquiry of the person or persons who manage the system, or those persons directly responsible for gathering the information, the information submitted is, to the best of my knowledge and belief, true, accurate and complete. I am aware that there are significant penalties for submitting false information, including the possibility of fine and imprisonment for knowing violations.

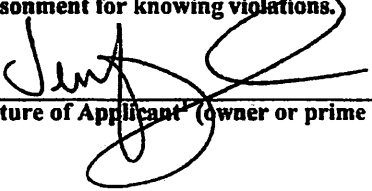

Signature of Applicant (owner or prime contractor)

1.20.22

Date Signed

Jennifer Mayfield
Purchasing Manager

Printed Name¹

Title

¹This application shall be signed as follows:

- For a corporation, by a responsible corporate officer.
- For a partnership, by a general partner.
- For a sole proprietorship, by the proprietor.

For a municipal, state or other public facility, by principal executive officer, mayor, or ranking elected official

Please submit the LCNOI form to:

Chief, Environmental Permits Division
MS Department of Environmental Quality, Office of Pollution Control
P.O. Box 2261
Jackson, Mississippi 39225

- 025439

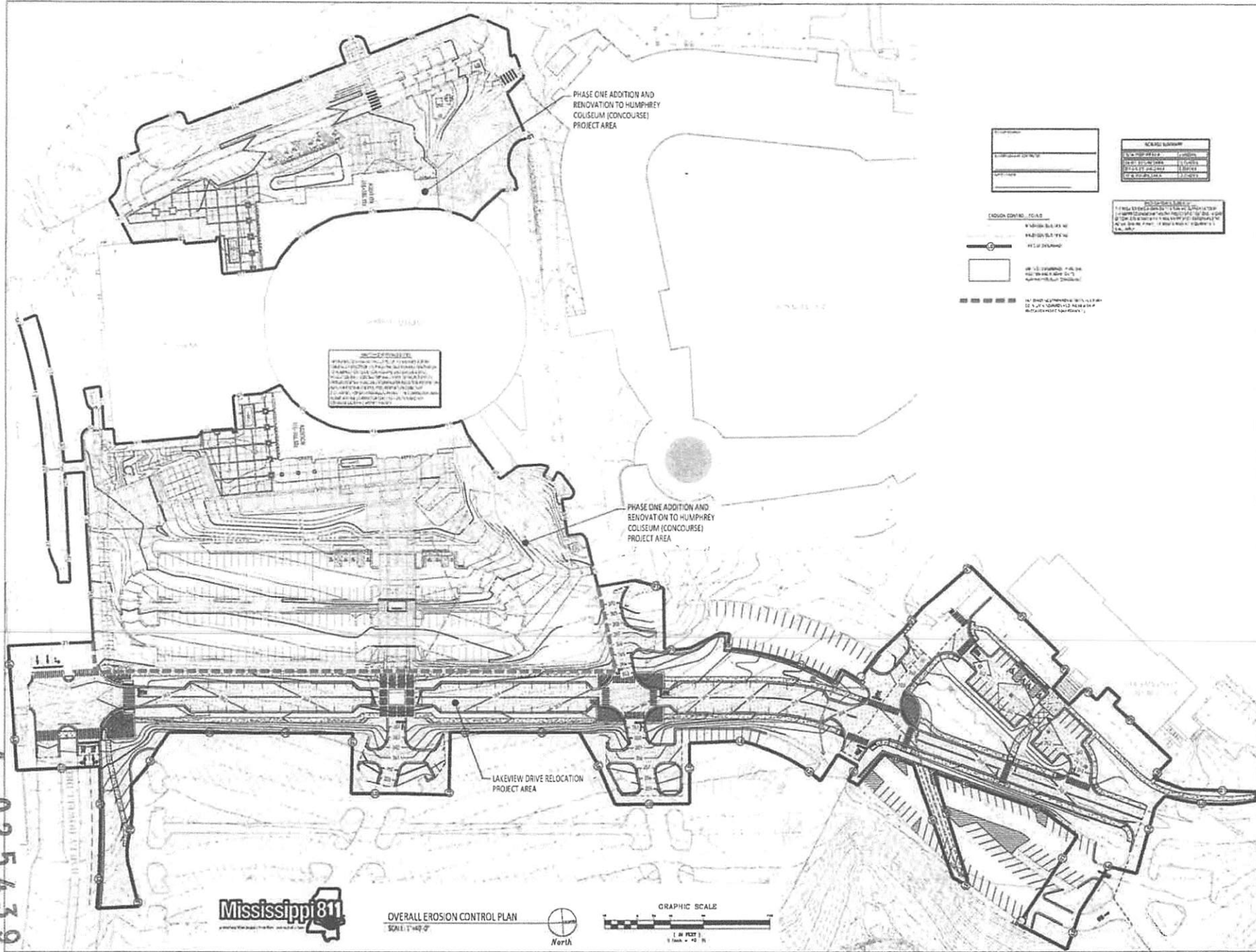

NOTICE TO CONTRACTOR
 1. ALL EROSION CONTROL MEASURES SHALL BE INSTALLED AND MAINTAINED THROUGHOUT THE CONSTRUCTION PERIOD.
 2. THE CONTRACTOR SHALL BE RESPONSIBLE FOR OBTAINING ALL NECESSARY PERMITS AND APPROVALS FROM THE MISSISSIPPI DEPARTMENT OF TRANSPORTATION AND CONSTRUCTION.
 3. THE CONTRACTOR SHALL MAINTAIN ACCESS TO ALL ADJACENT PROPERTIES AND PUBLIC ROADS AT ALL TIMES.
 4. THE CONTRACTOR SHALL BE RESPONSIBLE FOR REMOVING ALL EROSION CONTROL MEASURES AND RESTORING THE SITE TO ORIGINAL OR BETTER CONDITION UPON COMPLETION OF THE PROJECT.

DATE	DESCRIPTION

SCALE SUMMARY	
PLAN	1" = 40'
SECTION	1" = 4'

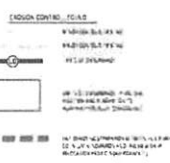

PROVISIONS
 1. ALL EROSION CONTROL MEASURES SHALL BE INSTALLED AND MAINTAINED THROUGHOUT THE CONSTRUCTION PERIOD.
 2. THE CONTRACTOR SHALL BE RESPONSIBLE FOR OBTAINING ALL NECESSARY PERMITS AND APPROVALS FROM THE MISSISSIPPI DEPARTMENT OF TRANSPORTATION AND CONSTRUCTION.
 3. THE CONTRACTOR SHALL MAINTAIN ACCESS TO ALL ADJACENT PROPERTIES AND PUBLIC ROADS AT ALL TIMES.
 4. THE CONTRACTOR SHALL BE RESPONSIBLE FOR REMOVING ALL EROSION CONTROL MEASURES AND RESTORING THE SITE TO ORIGINAL OR BETTER CONDITION UPON COMPLETION OF THE PROJECT.



OVERALL EROSION CONTROL PLAN
 SCALE: 1"=40'

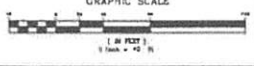

435 Katherine Drive, Suite A
 P.O. Box 321384
 Flowood, MS 39232
 Phone 769.216.3004
 smiths@smiths.com

SMITHS ENGINEERS + CONSULTANTS



LAKEVIEW DRIVE RELOCATION
 ILE #205-312
 LAKEVIEW DRIVE
 MISSISSIPPI STATE, MISSISSIPPI

Project No.	2008
Client	MSU ST. JAMES
Drawn By	WMS
Checked By	WMS
Revised	

C100
 OVERALL EROSION CONTROL PLAN

- 025439

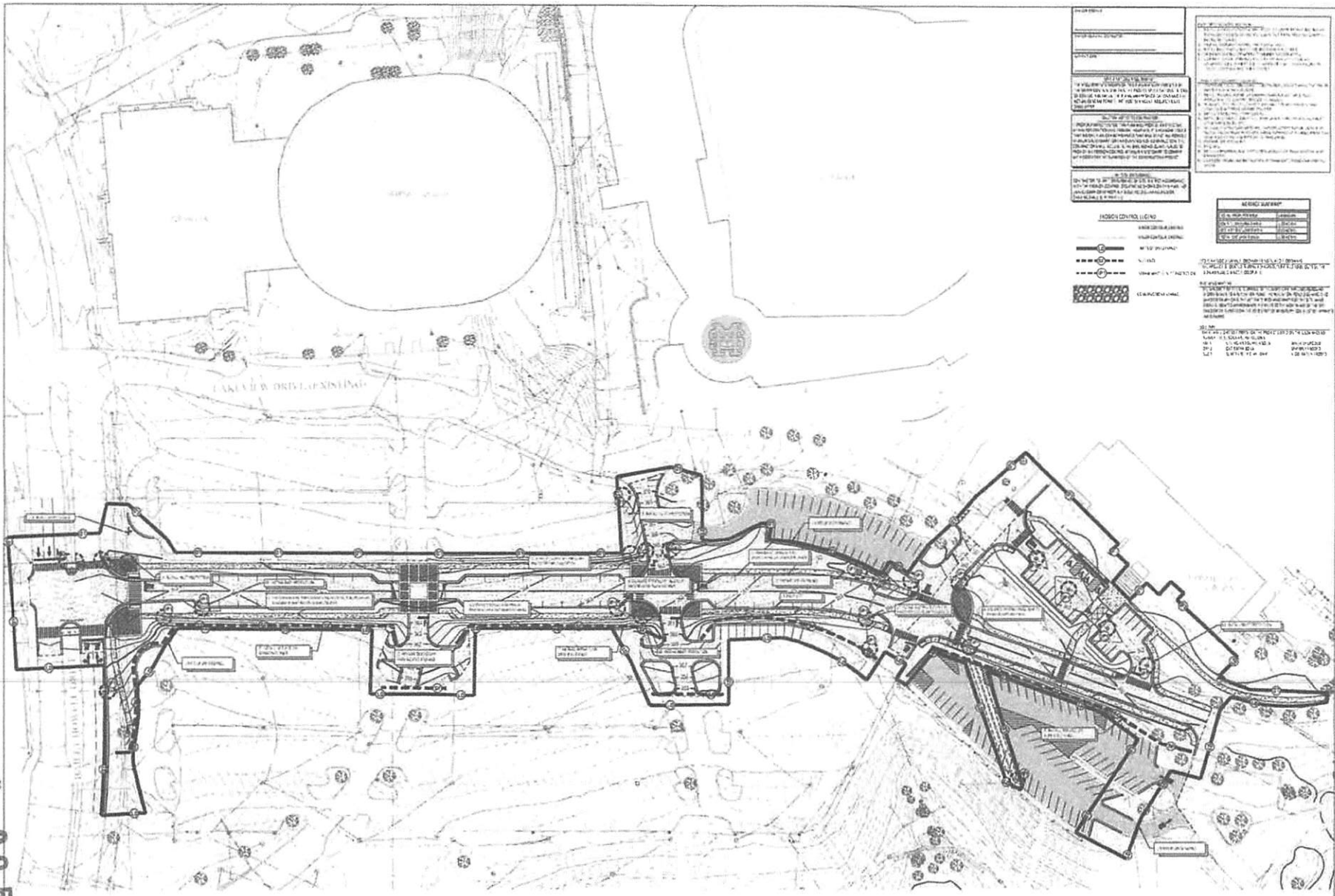

PROJECT

PROJECT NO. 21029

DATE 07/11/2011

DRAWN BY MJC

CHECKED BY WAB

REVISIONS

NO. **DATE** **DESCRIPTION**

1 **07/11/2011** **ISSUED FOR PERMIT**

2 **07/11/2011** **REVISED TO ADD NOTES**

3 **07/11/2011** **REVISED TO ADD NOTES**

4 **07/11/2011** **REVISED TO ADD NOTES**

5 **07/11/2011** **REVISED TO ADD NOTES**

6 **07/11/2011** **REVISED TO ADD NOTES**

7 **07/11/2011** **REVISED TO ADD NOTES**

8 **07/11/2011** **REVISED TO ADD NOTES**

9 **07/11/2011** **REVISED TO ADD NOTES**

10 **07/11/2011** **REVISED TO ADD NOTES**

11 **07/11/2011** **REVISED TO ADD NOTES**

12 **07/11/2011** **REVISED TO ADD NOTES**

13 **07/11/2011** **REVISED TO ADD NOTES**

14 **07/11/2011** **REVISED TO ADD NOTES**

15 **07/11/2011** **REVISED TO ADD NOTES**

16 **07/11/2011** **REVISED TO ADD NOTES**

17 **07/11/2011** **REVISED TO ADD NOTES**

18 **07/11/2011** **REVISED TO ADD NOTES**

19 **07/11/2011** **REVISED TO ADD NOTES**

20 **07/11/2011** **REVISED TO ADD NOTES**

NONION CONTROL LEGEND

	SILT FENCE
	SEDIMENT BASIN
	VEGETATIVE STRIP
	CONCRETE CURB
	SLOPE PROTECTION
	STORM DRAIN
	CULVERT
	CHECK DAM
	SWALE
	DRAINAGE CANAL
	SLOPE STABILIZATION
	ROCK RIPRAP

NOTES

1. ALL EROSION CONTROL MEASURES SHALL BE INSTALLED AND MAINTAINED IN ACCORDANCE WITH THE MISSISSIPPI EROSION CONTROL ACT AND THE MISSISSIPPI DEPARTMENT OF TRANSPORTATION (DOT) EROSION CONTROL MANUAL.

2. ALL EROSION CONTROL MEASURES SHALL BE INSTALLED AND MAINTAINED IN ACCORDANCE WITH THE MISSISSIPPI DEPARTMENT OF TRANSPORTATION (DOT) EROSION CONTROL MANUAL.

3. ALL EROSION CONTROL MEASURES SHALL BE INSTALLED AND MAINTAINED IN ACCORDANCE WITH THE MISSISSIPPI DEPARTMENT OF TRANSPORTATION (DOT) EROSION CONTROL MANUAL.

4. ALL EROSION CONTROL MEASURES SHALL BE INSTALLED AND MAINTAINED IN ACCORDANCE WITH THE MISSISSIPPI DEPARTMENT OF TRANSPORTATION (DOT) EROSION CONTROL MANUAL.

5. ALL EROSION CONTROL MEASURES SHALL BE INSTALLED AND MAINTAINED IN ACCORDANCE WITH THE MISSISSIPPI DEPARTMENT OF TRANSPORTATION (DOT) EROSION CONTROL MANUAL.

6. ALL EROSION CONTROL MEASURES SHALL BE INSTALLED AND MAINTAINED IN ACCORDANCE WITH THE MISSISSIPPI DEPARTMENT OF TRANSPORTATION (DOT) EROSION CONTROL MANUAL.

7. ALL EROSION CONTROL MEASURES SHALL BE INSTALLED AND MAINTAINED IN ACCORDANCE WITH THE MISSISSIPPI DEPARTMENT OF TRANSPORTATION (DOT) EROSION CONTROL MANUAL.

8. ALL EROSION CONTROL MEASURES SHALL BE INSTALLED AND MAINTAINED IN ACCORDANCE WITH THE MISSISSIPPI DEPARTMENT OF TRANSPORTATION (DOT) EROSION CONTROL MANUAL.

9. ALL EROSION CONTROL MEASURES SHALL BE INSTALLED AND MAINTAINED IN ACCORDANCE WITH THE MISSISSIPPI DEPARTMENT OF TRANSPORTATION (DOT) EROSION CONTROL MANUAL.

10. ALL EROSION CONTROL MEASURES SHALL BE INSTALLED AND MAINTAINED IN ACCORDANCE WITH THE MISSISSIPPI DEPARTMENT OF TRANSPORTATION (DOT) EROSION CONTROL MANUAL.

11. ALL EROSION CONTROL MEASURES SHALL BE INSTALLED AND MAINTAINED IN ACCORDANCE WITH THE MISSISSIPPI DEPARTMENT OF TRANSPORTATION (DOT) EROSION CONTROL MANUAL.

12. ALL EROSION CONTROL MEASURES SHALL BE INSTALLED AND MAINTAINED IN ACCORDANCE WITH THE MISSISSIPPI DEPARTMENT OF TRANSPORTATION (DOT) EROSION CONTROL MANUAL.

13. ALL EROSION CONTROL MEASURES SHALL BE INSTALLED AND MAINTAINED IN ACCORDANCE WITH THE MISSISSIPPI DEPARTMENT OF TRANSPORTATION (DOT) EROSION CONTROL MANUAL.

14. ALL EROSION CONTROL MEASURES SHALL BE INSTALLED AND MAINTAINED IN ACCORDANCE WITH THE MISSISSIPPI DEPARTMENT OF TRANSPORTATION (DOT) EROSION CONTROL MANUAL.

15. ALL EROSION CONTROL MEASURES SHALL BE INSTALLED AND MAINTAINED IN ACCORDANCE WITH THE MISSISSIPPI DEPARTMENT OF TRANSPORTATION (DOT) EROSION CONTROL MANUAL.

16. ALL EROSION CONTROL MEASURES SHALL BE INSTALLED AND MAINTAINED IN ACCORDANCE WITH THE MISSISSIPPI DEPARTMENT OF TRANSPORTATION (DOT) EROSION CONTROL MANUAL.

17. ALL EROSION CONTROL MEASURES SHALL BE INSTALLED AND MAINTAINED IN ACCORDANCE WITH THE MISSISSIPPI DEPARTMENT OF TRANSPORTATION (DOT) EROSION CONTROL MANUAL.

18. ALL EROSION CONTROL MEASURES SHALL BE INSTALLED AND MAINTAINED IN ACCORDANCE WITH THE MISSISSIPPI DEPARTMENT OF TRANSPORTATION (DOT) EROSION CONTROL MANUAL.

19. ALL EROSION CONTROL MEASURES SHALL BE INSTALLED AND MAINTAINED IN ACCORDANCE WITH THE MISSISSIPPI DEPARTMENT OF TRANSPORTATION (DOT) EROSION CONTROL MANUAL.

20. ALL EROSION CONTROL MEASURES SHALL BE INSTALLED AND MAINTAINED IN ACCORDANCE WITH THE MISSISSIPPI DEPARTMENT OF TRANSPORTATION (DOT) EROSION CONTROL MANUAL.



OVERALL EROSION CONTROL PLAN
SCALE: 1"=40'-0"

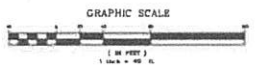

ASAC, Lakeview Drive, Suite A
P.O. Box 21029
Flowood, MS 38923
Phone 769 216 3004
smithersengineers.com

SMITHERS ENGINEERS CONSULTANTS

LAKEVIEW DRIVE RELOCATION
JUL #205 312
LAKEVIEW DRIVE
MISSISSIPPI STATE, MISSISSIPPI

Project No.	21029
Date	07/11/2011
Drawn by	MJC
Checked by	WAB
Reviewed by	

C101
EROSION CONTROL PLAN



MISSISSIPPI DEPARTMENT OF
ENVIRONMENTAL QUALITY

LARGE CONSTRUCTION NOTICE OF INTENT (LCNOI) FOR COVERAGE UNDER THE LARGE CONSTRUCTION STORM WATER GENERAL NPDES PERMIT

INSTRUCTIONS

The Large Construction Notice of Intent (LCNOI) is for coverage under the Large Construction General Permit for land disturbing activities of five (5) acres or greater; or for land disturbing activities, which are part of a larger common plan of development or sale that are initially less than five (5) acres but will ultimately disturb five (5) or more acres. Applicant must be the owner or operator. For construction activities, the operator is typically the prime contractor. The owner(s) of the property and the prime contractor associated with regulated construction activity on the property have joint and severable responsibility for compliance with the Large Construction Storm Water General Permit MSR10.

If the company seeking coverage is a corporation, a limited liability company, a partnership, or a business trust, attach proof of its registration with the Mississippi Secretary of State and/or its Certificate of Good Standing. This registration or Certificate of Good Standing must be dated within twelve (12) months of the date of the submittal of this coverage form. Coverage will be issued in the company name as it is registered with the Mississippi Secretary of State.

Completed LCNOIs should be filed at least thirty (30) days prior to the commencement of construction. Discharge of storm water from large construction activities without written notification of coverage is a violation of state law.

Submittals with this LCNOI must include:

- A site-specific Storm Water Pollution Prevention Plan (SWPPP) developed in accordance with ACT5 of the General Permit
- A detailed site-specific scaled drawing showing the property layout and the features outlined in ACT5 of the General Permit
- A United States Geological Survey (USGS) quadrangle map or photocopy, extending at least one-half mile beyond the facility property boundaries with the site location and outfalls outlined or highlighted. The name of the quadrangle map must be shown on all copies. Quadrangle maps can be obtained from the MDEQ, Office of Geology at 601-961-5523.

Additional submittals may include the following, if applicable:

- Appropriate Section 404 documentation from U.S. Army Corps of Engineers
- Appropriate documentation concerning future disposal of sanitary sewage and sewage collection system construction
- Appropriate documentation from the MDEQ Office of Land & Water concerning dam construction and low flow requirements
- Approval from County Utility Authority in Hancock, Harrison, Jackson, Pearl River and Stone Counties

ALL QUESTIONS MUST BE ANSWERED (Answer "NA" if the question is not applicable)