

AI : 83380

Coverage #
MSR108930

Rec'd via email :
04/05/2023



MISSISSIPPI DEPARTMENT OF
ENVIRONMENTAL QUALITY

LARGE CONSTRUCTION NOTICE OF INTENT (LCNOI) FOR COVERAGE UNDER THE LARGE CONSTRUCTION STORM WATER GENERAL NPDES PERMIT

INSTRUCTIONS

The Large Construction Notice of Intent (LCNOI) is for coverage under the Large Construction General Permit for land disturbing activities of five (5) acres or greater; or for land disturbing activities, which are part of a larger common plan of development or sale that are initially less than five (5) acres but will ultimately disturb five (5) or more acres. Applicant must be the owner or operator. For construction activities, the operator is typically the prime contractor. The owner(s) of the property and the prime contractor associated with regulated construction activity on the property have joint and severable responsibility for compliance with the Large Construction Storm Water General Permit MSR10.

If the company seeking coverage is a corporation, a limited liability company, a partnership, or a business trust, attach proof of its registration with the Mississippi Secretary of State and/or its Certificate of Good Standing. This registration or Certificate of Good Standing must be dated within twelve (12) months of the date of the submittal of this coverage form. Coverage will be issued in the company name as it is registered with the Mississippi Secretary of State.

Completed LCNOIs should be filed at least thirty (30) days prior to the commencement of construction. Discharge of storm water from large construction activities without written notification of coverage is a violation of state law.

Submittals with this LCNOI must include:

- A site-specific Storm Water Pollution Prevention Plan (SWPPP) developed in accordance with ACT5 of the General Permit
- A detailed site-specific scaled drawing showing the property layout and the features outlined in ACT5 of the General Permit
- A United States Geological Survey (USGS) quadrangle map or photocopy, extending at least one-half mile beyond the facility property boundaries with the site location and outfalls outlined or highlighted. The name of the quadrangle map must be shown on all copies. Quadrangle maps can be obtained from the MDEQ, Office of Geology at 601-961-5523.

Additional submittals may include the following, if applicable:

- Appropriate Section 404 documentation from U.S. Army Corps of Engineers
- Appropriate documentation concerning future disposal of sanitary sewage and sewage collection system construction
- Appropriate documentation from the MDEQ Office of Land & Water concerning dam construction and low flow requirements
- Approval from County Utility Authority in Hancock, Harrison, Jackson, Pearl River and Stone Counties
- Antidegradation report for disturbance within Waters of the State

ALL QUESTIONS MUST BE ANSWERED (Answer "NA" if the question is not applicable)

MSR10 8930

(NUMBER TO BE ASSIGNED BY STATE)

APPLICANT IS THE: OWNER PRIME CONTRACTOR

OWNER CONTACT INFORMATION

OWNER CONTACT PERSON: Corey Stidham
OWNER COMPANY LEGAL NAME: Stidham & Son
OWNER STREET OR P.O. BOX: 528 Cherry Road
OWNER CITY: Mathiston STATE: MS ZIP: 39752
OWNER PHONE #: (662) 418-6605 OWNER EMAIL: cstidham@webstercountyschools.org

PREPARER CONTACT INFORMATION

IF NOI WAS PREPARED BY SOMEONE OTHER THAN THE APPLICANT

CONTACT PERSON: Mike Brent, PE
COMPANY LEGAL NAME: Brent Engineering Service, Inc.
STREET OR P.O. BOX: 507-A M.L. King Drive
CITY: Starkville STATE: MS ZIP: 39759
PHONE # () 662-769-0808 EMAIL: mbrent39759@yahoo.com

PRIME CONTRACTOR CONTACT INFORMATION

PRIME CONTRACTOR CONTACT PERSON: _____
PRIME CONTRACTOR COMPANY LEGAL NAME: _____
PRIME CONTRACTOR STREET OR P.O. BOX: _____
PRIME CONTRACTOR CITY: _____ STATE: _____ ZIP: _____
PRIME CONTRACTOR PHONE #: () _____ PRIME CONTRACTOR EMAIL: _____

FACILITY SITE INFORMATION

FACILITY SITE NAME: Wood Estates Phase 3
FACILITY SITE ADDRESS (If the physical address is not available, please indicate the nearest named road. For linear projects indicate the beginning of the project and identify all counties the project traverses.)
STREET: Stidham Road
CITY: Mathiston STATE: MS COUNTY: Oktibbeha ZIP: 39752
FACILITY SITE TRIBAL LAND ID (N/A If not applicable): N/A
LATITUDE: 33 degrees 32 minutes 57 seconds LONGITUDE: 89 degrees 07 minutes 31 seconds
LAT & LONG DATA SOURCE (GPS (Please GPS Project Entrance/Start Point) or Map Interpolation): Google Earth
TOTAL ACREAGE THAT WILL BE DISTURBED ¹: 10.29 Acres total
Road Construction = 1.51 Ac Lots disturbance = 5.51 Ac,
Utility Construction = 2.51 Ac
Drainage Construction = 0.76 Ac

IS THIS PART OF A LARGER COMMON PLAN OF DEVELOPMENT? YES NO

IF YES, NAME OF LARGER COMMON PLAN OF DEVELOPMENT: Wood Estates Phase 1 and 2
AND PERMIT COVERAGE NUMBER: MSR10 _____

ESTIMATED CONSTRUCTION PROJECT START DATE: 4-1-23
 YYYY-MM-DD

ESTIMATED CONSTRUCTION PROJECT END DATE: 10-1-24
 YYYY-MM-DD

DESCRIPTION OF CONSTRUCTION ACTIVITY: development of 24 lots for single-family residential use.

PROPOSED DESCRIPTION OF PROPERTY USE AFTER CONSTRUCTION HAS BEEN COMPLETED:
Single family residential neighborhood

SIC Code: _____ **NAICS Code** _____

NEAREST NAMED RECEIVING STREAM: Pigeon Roost Creek

IS RECEIVING STREAM ON MISSISSIPPI'S 303(d) LIST OF IMPAIRED WATER BODIES? (The 303(d) list of impaired waters and TMDL stream segments may be found on MDEQ's web site: http://www.deq.state.ms.us/MDEQ.nsf/page/TWB_Total_Maximum_Daily_Load_Section) YES NO

HAS A TMDL BEEN ESTABLISHED FOR THE RECEIVING STREAM SEGMENT? YES NO

FOR WHICH POLLUTANT:

ARE THERE RECREATIONAL STREAMS, PRIVATE/PUBLIC PONDS OR LAKES WITHIN 1/2 MILE DOWNSTREAM OF PROJECT BOUNDARY THAT MAY BE IMPACTED BY THE CONSTRUCTION ACTIVITY? YES NO

EXISTING DATA DESCRIBING THE SOIL (for linear projects please describe in SWPPP):
Silty Clay Loam

WILL FLOCCULANTS BE USED TO TREAT TURBIDITY IN STORM WATER? YES NO

IF YES, INDICATE THE TYPE OF FLOCCULANT. ANIONIC POLYACRYLIMIDE (PAM)
 OTHER _____

IF YES, DOES THE SWPPP DESCRIBE THE METHOD OF INTRODUCTION, THE LOCATION OF INTRODUCTION AND THE LOCATION OF WHERE FLOCCULATED MATERIAL WILL SETTLE?

IS A SDS SHEET INCLUDED FOR THE FLOCCULATE? YES NO

WILL THERE BE A 50 FT BUFFER BETWEEN THE PROJECT DISTURBANCE AND THE WATERS OF THE STATE? YES NO

IF NOT, PROVIDE EQUIVALENT CONTROL MEASURES IN THE SWPPP.

¹Acreage for subdivision development includes areas disturbed by construction of roads, utilities and drainage. Additionally, a housesite of at least 10,000 ft² per lot (entire lot, if smaller) shall be included in calculating acreage disturbed.

DOCUMENTATION OF COMPLIANCE WITH OTHER REGULATIONS/REQUIREMENTS
 COVERAGE UNDER THIS PERMIT WILL NOT BE GRANTED UNTIL ALL OTHER REQUIRED
 MDEQ PERMITS AND APPROVALS ARE SATISFACTORILY ADDRESSED

IS LCNOI FOR A FACILITY THAT WILL REQUIRE OTHER PERMITS?

YES NO

IF YES, CHECK ALL THAT APPLY: AIR HAZARDOUS WASTE PRETREATMENT
 WATER STATE OPERATING INDIVIDUAL NPDES OTHER: _____

IS THE PROJECT REROUTING, FILLING OR CROSSING A WATER CONVEYANCE OF ANY KIND? (If yes, contact the U.S. Army Corps of Engineers' Regulatory Branch for permitting requirements.) YES NO

IF THE PROJECT REQUIRES A CORPS OF ENGINEER SECTION 404 PERMIT, PROVIDE APPROPRIATE DOCUMENTATION THAT:

- The project has been approved by individual permit, or
- The work will be covered by a nationwide permit and NO NOTIFICATION to the Corps is required, or
- The work will be covered by a nationwide or general permit and NOTIFICATION to the Corps is required

IS THE PROJECT REROUTING, FILLING OR CROSSING A STATE WATER CONVEYANCE OF ANY KIND? (If yes, please provide an antidegradation report.) YES NO

IS A LAKE REQUIRING THE CONSTRUCTION OF A DAM BEING PROPOSED? (If yes, provide appropriate approval documentation from MDEQ Office of Land and Water, Dam Safety.) YES NO

IF THE PROJECT IS A SUBDIVISION OR A COMMERCIAL DEVELOPMENT, HOW WILL SANITARY SEWAGE BE DISPOSED? Check one of the following and attach the pertinent documents.

- Existing Municipal or Commercial System. Please attach plans and specifications for the collection system and the associated "Information Regarding Proposed Wastewater Projects" form or approval from County Utility Authority in Hancock, Harrison, Jackson, Pearl River and Stone Counties. If the plans and specifications can not be provided at the time of LCNOI submittal, MDEQ will accept written acknowledgement from official(s) responsible for wastewater collection and treatment that the flows generated from the proposed project can and will be transported and treated properly. The letter must include the estimated flow.
- Collection and Treatment System will be Constructed. Please attach a copy of the cover of the NPDES discharge permit from MDEQ or indicate the date the application was submitted to MDEQ (Date: _____.)
- Individual Onsite Wastewater Disposal Systems for Subdivisions Less than 35 Lots. Please attach a copy of the Letter of General Acceptance from the Mississippi State Department of Health or certification from a registered professional engineer that the platted lots should support individual onsite wastewater disposal systems.
- Individual Onsite Wastewater Disposal Systems for Subdivisions Greater than 35 Lots. A determination of the feasibility of installing a central sewage collection and treatment system must be made by MDEQ. A copy of the response from MDEQ concerning the feasibility study must be attached. If a central collection and wastewater system is not feasible, then please attach a copy of the Letter of General Acceptance from the State Department of Health or certification from a registered professional engineer that the platted lots should support individual onsite wastewater disposal systems.

INDICATE ANY LOCAL STORM WATER ORDINANCE (I.E. MS4) WITH WHICH THE PROJECT MUST COMPLY:

I certify under penalty of law that this document and all attachments were prepared under my direction or supervision in accordance with a system designed to assure that qualified personnel properly gathered and evaluated the information submitted. Based on my inquiry of the person or persons who manage the system, or those persons directly responsible for gathering the information, the information submitted is, to the best of my knowledge and belief, true, accurate and complete. I am aware that there are significant penalties for submitting false information, including the possibility of fine and imprisonment for knowing violations.

* Corey Stidhan
Signature of Applicant¹ (owner or prime contractor)

* 3-30-23
Date Signed

* Corey Stidhan
Printed Name¹

Owner
Title

¹This application shall be signed as follows:

- For a corporation, by a responsible corporate officer.
- For a partnership, by a general partner.
- For a sole proprietorship, by the proprietor.

For a municipal, state or other public facility, by principal executive officer, mayor, or ranking elected official

Please submit the LCNOI form to:

Chief, Environmental Permits Division
MS Department of Environmental Quality, Office of Pollution Control
P.O. Box 2261
Jackson, Mississippi 39225

Electronically:

<https://www.mdeq.ms.gov/construction-stormwater/>

Revised 3/23/22

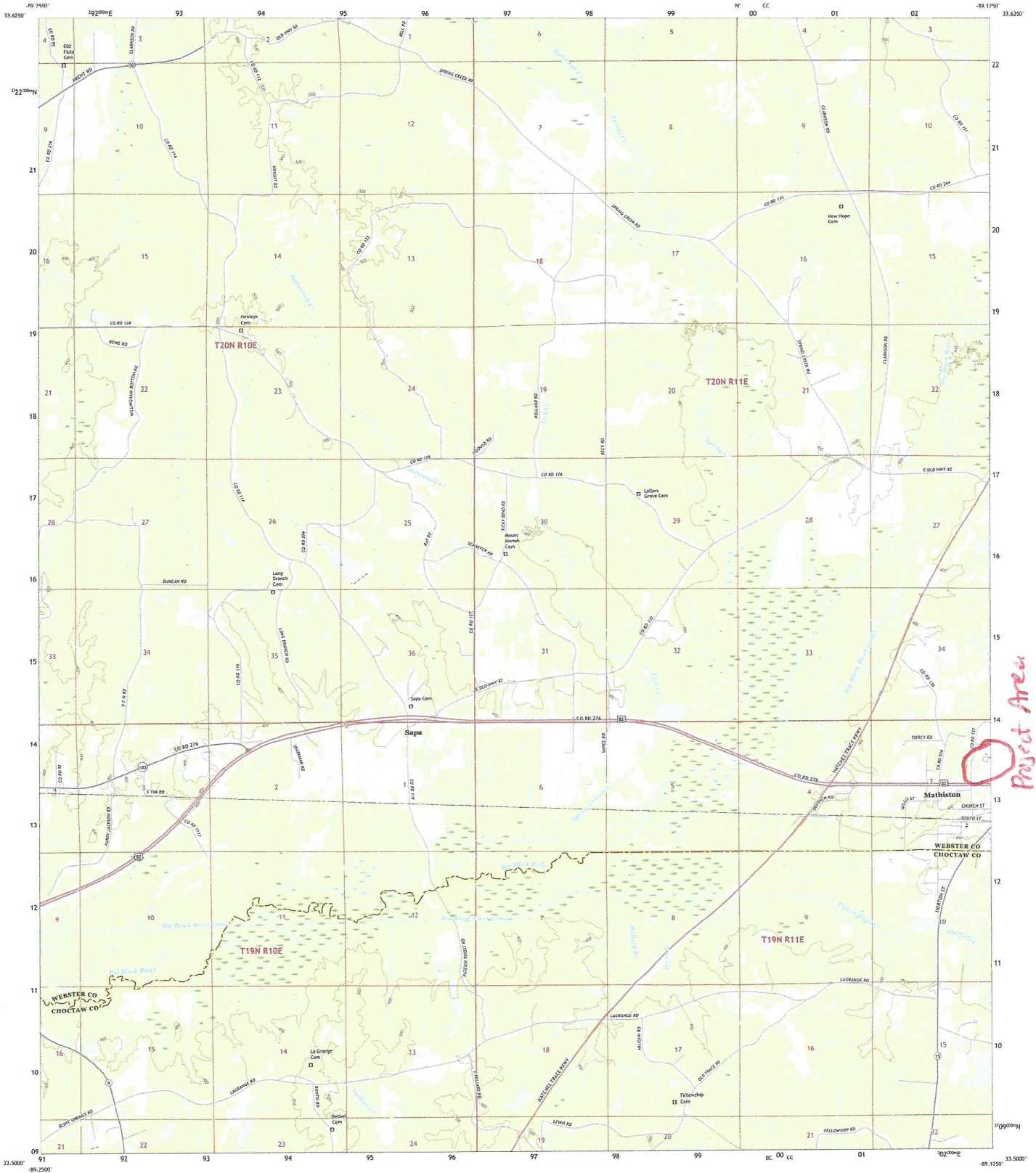

Project Area

Produced by the United States Geological Survey
North American Datum of 1983 (NAD83)
World Geodetic System of 1984 (WGS84). Projection and
1000 meter grid/Universal Transverse Mercator, Zone 16S
This map is not a legal document. Boundaries may be
generalized for this map scale. Private lands within government
reservations may not be shown. Obtain permission before
entering private lands.

UTM GRID AND 2017 MAGNETIC NORTH
DECLINATION AT CENTER OF SHEET

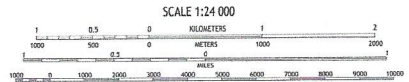

ROAD CLASSIFICATION

Expressway	Local Connector
Secondary Hwy	Local Road
Ramp	4RD
Interstate Route	US Route
	State Route

1	2	3	1
4	5	5	1
6	7	8	1

ADJOINING QUADRANGLES

CONTOUR INTERVAL 20 FEET
NORTH AMERICAN VERTICAL DATUM OF 1988
This map was produced to conform with the
National Geospatial Program US Topo Product Standard, 2011.
A metadata file associated with this product is available at dx.doi.org/10.7927/H4TJ-6168



U.S. DEPARTMENT OF THE INTERIOR
U.S. GEOLOGICAL SURVEY



MABEN QUADRANGLE
MISSISSIPPI
7.5-MINUTE SERIES

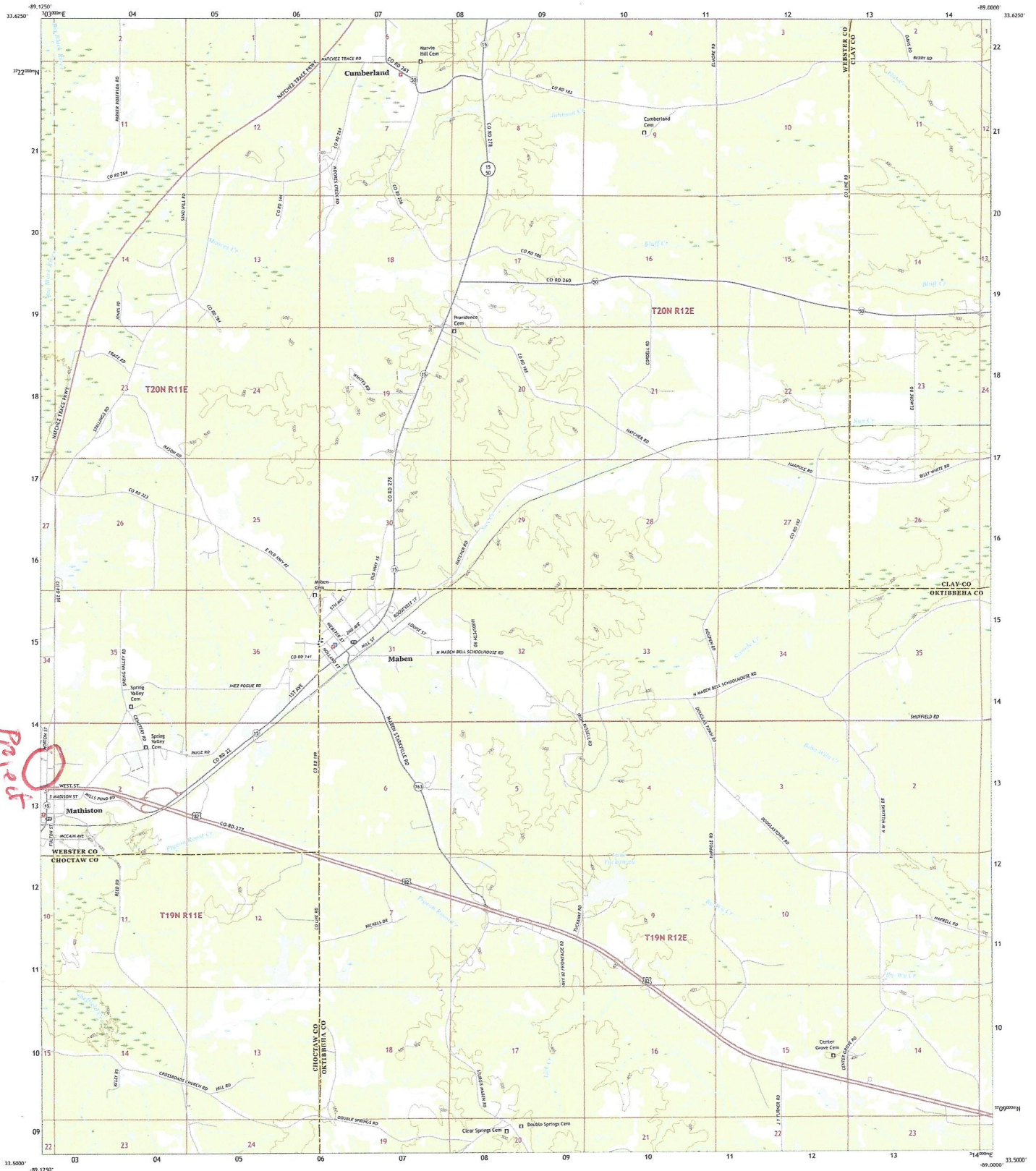

Project Area

Produced by the United States Geological Survey
North American Datum of 1983 (NAD83)
World Geodetic System of 1984 (WGS84). Projection and
1 000 meter grid (Universal Transverse Mercator, Zone 16S
This map is not a legal document. Boundaries may be
generalized for this map scale. Private lands within government
reservations may not be shown. Obtain permission before
entering private lands.

Source: NAD, September 2016 - October 2016
U.S. Census Bureau, 2017
Hydrography: National Hydrography Dataset, 2004 - 2017
Contours: National Elevation Dataset, 2011 - 2015
Boundaries: Multiple sources; see metadata file 2014-2015
Public Land Survey System, 1814 - 2017
Wetlands: FWS National Wetlands Inventory 1980 - 2004

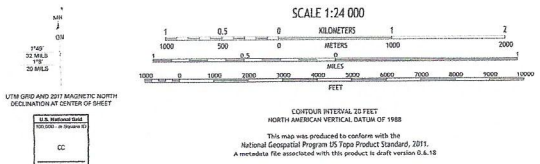



STATE OF MISSISSIPPI

PHIL BRYANT
GOVERNOR

MISSISSIPPI DEPARTMENT OF ENVIRONMENTAL QUALITY

GARY C. RIKARD, EXECUTIVE DIRECTOR

July 10, 2019

Honorable Jimmy P. Carden, Mayor
PO Box 178
Mathiston, Mississippi 39752

Dear Honorable Mayor:

Re: Wood Estates Phase 2
Lot Nos. 17-20
Mathiston, Choctaw County
Project. No. 13252-PLA20190001

Our technical review of the plans and specifications for the referenced wastewater collection project has been finalized and initial approval for construction is hereby given.

You are reminded that the owner is responsible for proper planning, design, construction, operation, maintenance, replacement, performance, and fiscal integrity of the project. The Department's approval of any document does not relieve the owner or any others of any liabilities or responsibilities. Department approval of any document is for administrative purposes only, and does not establish or convey any such liability or responsibility.

Please be reminded that it is the full responsibility of the owner to ensure all other approvals, permits, clearances, easements, agreements, etc., which may be required prior to or during construction of the project have been or will be obtained.

No later than 60 days after the completion of the project, the owner must, through a letter signed by a professional engineer, certify to the department that the project has been constructed in accordance with submitted plans and specifications. If any changes to the approved plans and specifications are made, "as-built" drawings with a list of all changes must also be submitted. We strongly encourage the submission of Final Plans and Specifications in an electronic file format such as PDF, TIFF on CD or DVD. Please note this is a change from the past procedure of requiring "hard-copy" plans. A signed and stamped cover letter should be included with any electronic files indicating that the plans and specifications submitted electronically were developed by a professional engineer who holds a valid certificate of registration as a professional engineer issued by the Mississippi State Board of Registration for Professional Engineers and Land Surveyors. Final approval will not be granted until our office has received the engineer's certification of completeness and our office has finalized review of any significant changes to the initial plans.

Should you have any questions, please contact me at (601) 961-5171.

13252 PLA20190001

OFFICE OF POLLUTION CONTROL

POST OFFICE BOX 2261 • JACKSON, MISSISSIPPI 39225-2261 • TEL: (601) 961-5171 • FAX: (601) 354-6612 • www.deq.state.ms.us

AN EQUAL OPPORTUNITY EMPLOYER

Sincerely,

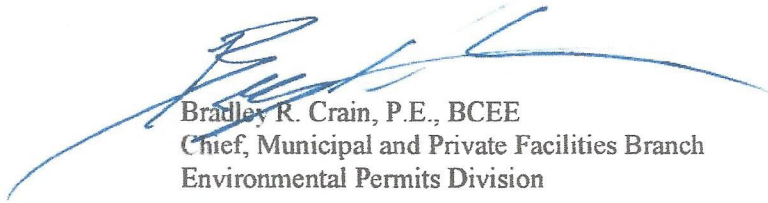

Bradley R. Crain, P.E., BCEE
Chief, Municipal and Private Facilities Branch
Environmental Permits Division

cc: William F. Moody, P.E., BCEE, MSDH
Mike Brent, P.E., Brent Engineering Service